

Approved by REGIONAL TRANSPORTATION COMMISSION

MATCH LINE: SEE SHEET 2

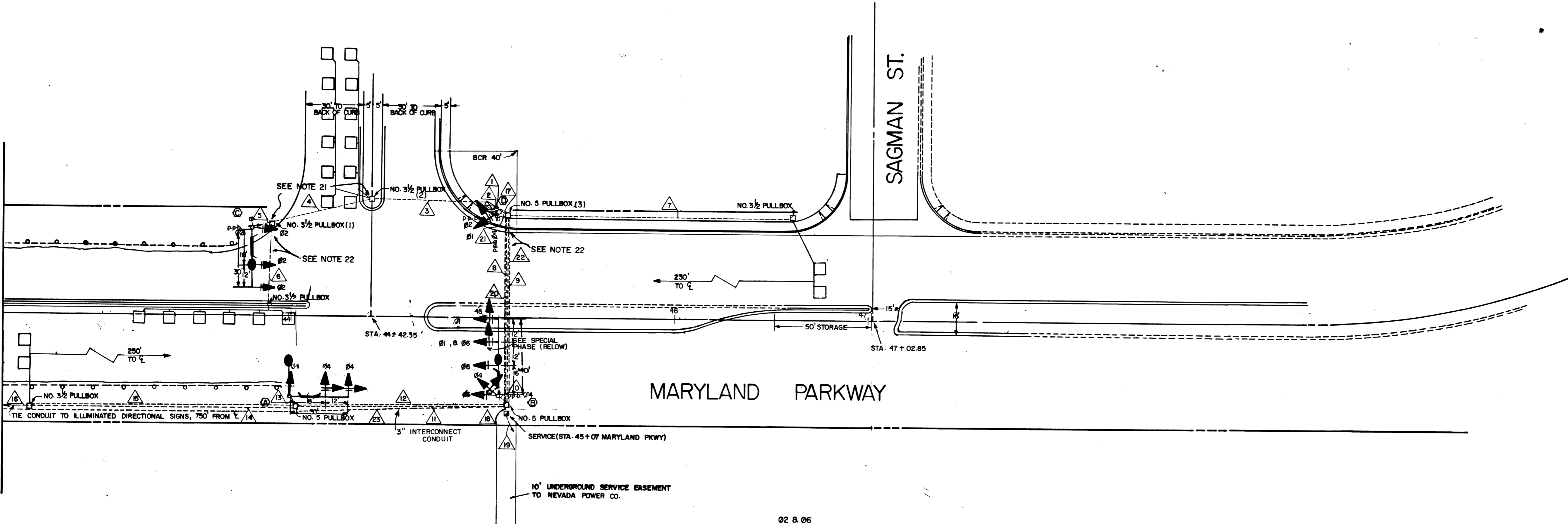

CONDUIT & CABLE SCHEDULE

RUN NO.	FROM	TO	CONDUIT SIZE	SERIAL CABLE			LIGHTING WIR.			INTERCONNECT	SERVICE
				10 CON. 14 AWG	2 CON. 12 AWG	3 CON. 14 AWG	1 CON. 14 AWG	2 CON. 12 AWG	3 CON. 14 AWG		
1	CONTROLLER	PULLBOX	2"	X	X	X					
2	CONTROLLER	POLE "D"	2"	X							
3	CONTROLLER	PULLBOX (EXISTING)	2"	X	XXX	X					
4	PULLBOX	PULLBOX (EXISTING)	2"	X	X	X					
5	PULLBOX	POLE "C"	2"	X	X	X					
6	PULLBOX	PULLBOX	2"		X						
7	PULLBOX	PULLBOX	1"		X						
8	PULLBOX	PULLBOX	2"	X	X	X					
9	PULLBOX	PULLBOX	2"	X	X	X					
10	PULLBOX	POLE "B"	2"	X	X	X					
11	PULLBOX	PULLBOX	2"	X	X	X			X		
12	PULLBOX	PULLBOX	2"	X	X	X			X		
13	PULLBOX	POLE "A"	2"	X	X	X			X		
14	PULLBOX	PULLBOX	2"	X	X	X			X		
15	PULLBOX	PULLBOX	1"		X				X		
16	PULLBOX	PULLBOX	2"	X	X	X			X		
17	CONTROLLER	PULLBOX	2"	X	X	X					
18	PULLBOX	PADMOUNT	2"							X	
19	PADMOUNT	SERVICE	2"							X	
20	PULLBOX	PULLBOX	2"							X	
21	CONTROLLER	PULLBOX	2"				X			X	
22	CONTROLLER	PULLBOX	3"						X		
23	PULLBOX (SHOWN ON DRAWING 22-18-1034)	PULLBOX	3"						X		
24	PULLBOX (SHOWN ON DRAWING 22-18-1034)	PULLBOX	3"						X		
25	PULLBOX (SHOWN ON DRAWING 22-18-1034)	PULLBOX	3"						X		

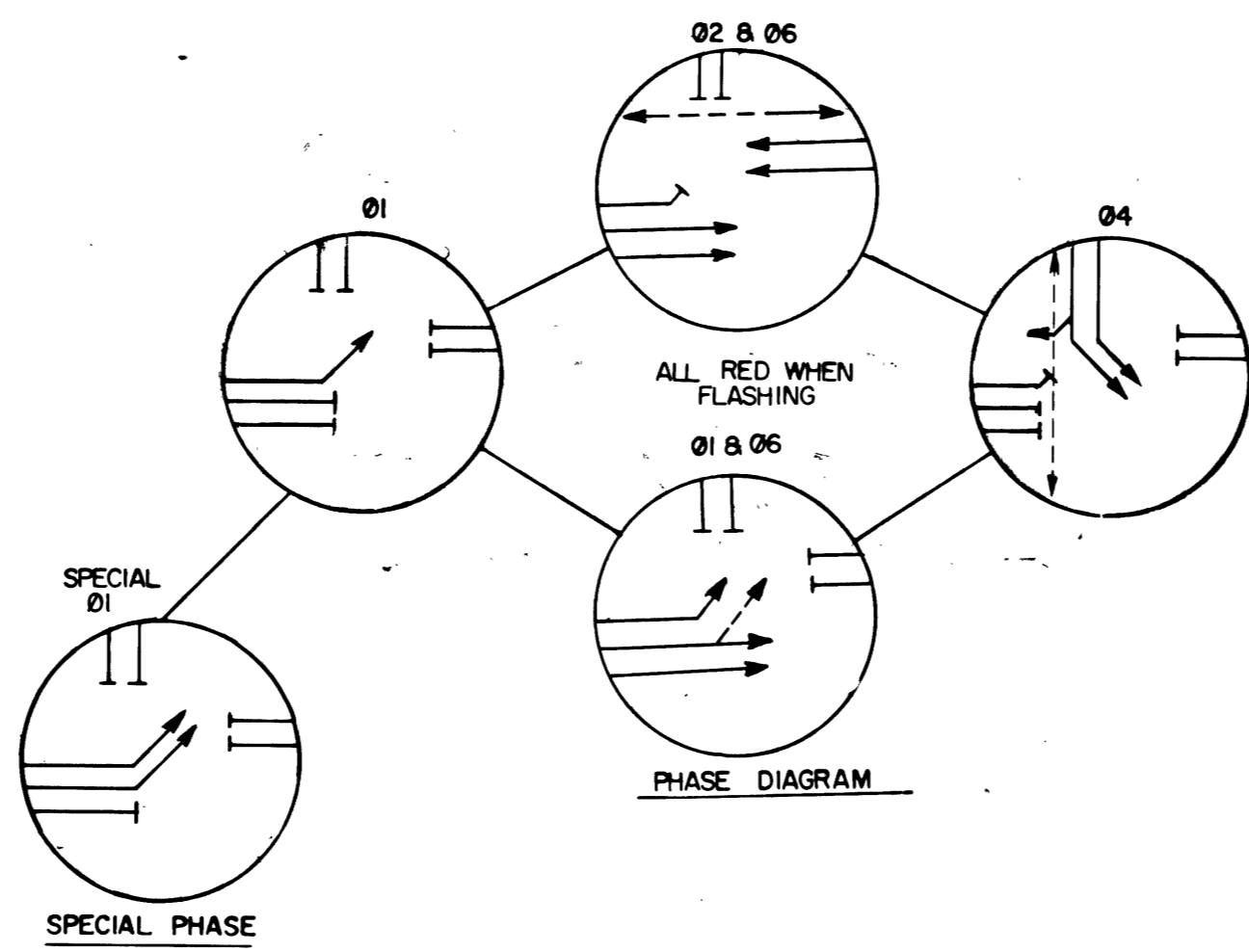

POLE SCHEDULE											
NO.	STATION	GA.	TYPE	SIGNAL ARM		LUM. ARM		SIGNALS (VEH)		SIGNALS (PED)	PED. PUSH BUTTON
				QUAD.	LENGTH	QUAD.	LENGTH	QUADRANT	TYPE		
(A)	44+0000		XX	2	30'	1	15'	MA	M-2(2)		
(B)	45+0833		XX	1	40'	1	15'	MA	M-3M-3AMP2 B-3T	4	W-OT 2 RT
(C)	43+7900		XX	3	30'	3	15'	MA	M-2(2)	1	W-OT 1 LT
(D)	45+0800		IA					TOP	A-BT		W-3T 4 RT 3 LT

- NOTES:
- CHECK CONDUIT & CABLE SCHEDULE FOR CONDUIT, CABLE, & WIRE SIZE.
  - LINE SIDE OF METER TO BE WIRED WITH THREE #10 A.W.G. LOAD SIDE SHALL BE WIRED WITH FOUR #4 A.W.G. (THREE BLACK & ONE WHITE)
  - THE ROUTING AND TERMINATION OF CONDUITS AND THE PLACING OF POLES AND CABINETS SHALL BE AS INDICATED ON PLANS. ALL CHANGES SHALL BE APPROVED BY THE TRAFFIC ENGINEER.
  - SIGNAL CABLE SHALL BE A 10 & 20 CONDUCTOR #14 A.W.G. CABLE I.M.S.A. SPEC 20-1.
  - LOOP CABLE SHALL BE ONE TWISTED PAIR OF #12 A.W.G. CABLE I.M.S.A. SPEC 19-2.
  - ALL SIGNAL LENSES SHALL BE 12".
  - CONTROLLER SHALL BE HOUSED IN A TYPE "R" CABINET WITH EXHAUST FAN AND THERMOSTAT CONTROL.
  - CABINET SHALL BE PAINTED WHITE INSIDE AND OUT.
  - EACH LOOP DETECTOR LEAD-IN REPRESENTS A SEPARATE AMPLIFIER UNIT REQUIRED. (FIVE REQUIRED)
  - ALL NECESSARY AMPLIFIER UNITS, MODULES, LIGHT CONTROL UNITS, SWITCHES, FLASHERS, ETC. SHALL BE WIRED IN CABINET TO ACTIVATE THE FOUR PHASE OPERATION AS SHOWN IN DIAGRAM.
  - SERVICE SHALL HAVE 1-60 AMP SINGLE POLE BREAKER FOR SIGNAL AND 2-40 AMP SINGLE POLE BREAKERS FOR STREET LIGHTS PLUS 2 POLE 60 AMP BREAKER. SERVICE SHALL BE A 200 AMP PADMOUNT.
  - EACH STREETLIGHT LUMINAIRE SHALL BE FUSED IN CABINET USING IN-LINE FUSE-HOLDERS.
  - ALL PEDESTRIAN PUSH BUTTON SIGNS SHALL BE 8" X 12" WITH FULL MOUNTING BRACKET.
  - ALL CABLE & WIRING SHALL BE INSTALLED TERMINAL TO TERMINAL, NO SPLICES ALLOWED.
  - POLES "A", "B", & "C" SHALL HAVE INTERNALLY ILLUMINATED STREET NAME SIGNS INSTALLED. SIGNS SHALL BE WIRED TO THE LUMINAIRE PHOTO CELL FOR CONTROL.
  - STREET NAME SIGNS ON POLES "B" & "C" SHALL READ "CASHMAN FIELD", AND NAME SIGN ON POLE "A" SHALL READ "MARYLAND PARKWAY".
  - ALL SIGNAL POLES SHALL CONFORM TO C.L.V. STANDARD SPEC. 404.402 & 404.406.
  - LOOP DETECTORS TO BE LOCATED BY C.L.V. IN THE FIELD.
  - THE NAME SIGNS ON POLES "B" & "C" READING "CASHMAN FIELD" SHALL BE 8' IN LENGTH AND BE DOUBLE FACED.
  - LUMINAIRE SHALL BE 400 WATTS HIGH PRESSURE SODIUM WITH MC11 DISTRIBUTION AND INDIVIDUAL P.E. CONTROL AND BUILT IN BALLAST. (120 V.A.C.)
  - PULLBOXES (1), (2), (3) ARE EXISTING. PULLBOXES (4), (5), (6), (7), (8), (9), (10), (11), (12), (13) ARE STUBBED OUT.
  - CONDUIT RUNS NUMBER 1, 2, 3, 4, 5, 6, 7, 8, 9, 10, 11, 12, 13, 14, 15, 16, 17, 18, 19, 20, 21, 22, 23, 24, 25, 26, 27, 28, 29, 30, 31, 32, 33, 34, 35, 36, 37, 38, 39, 40, 41, 42, 43, 44, 45, 46, 47, 48, 49, 50, 51, 52, 53, 54, 55, 56, 57, 58, 59, 60, 61, 62, 63, 64, 65, 66, 67, 68, 69, 70, 71, 72, 73, 74, 75, 76, 77, 78, 79, 80, 81, 82, 83, 84, 85, 86, 87, 88, 89, 90, 91, 92, 93, 94, 95, 96, 97, 98, 99, 100.

Department of Public Services Traffic Engineering Division  
 MARYLAND PARKWAY & CASHMAN FIELD  
 TRAFFIC SIGNAL

Scale 1" = 30'  
 Date 7/9/81  
 W.U. no. 2671  
 Design by GEORGE DAMMEER  
 Drawn by GARY PHILLIPS  
 Approved by Supervisor of Traffic Date 10-1-81  
 Approved by the City Engineer Date 10-5-81

Revisions  
 Date