

20-5-125

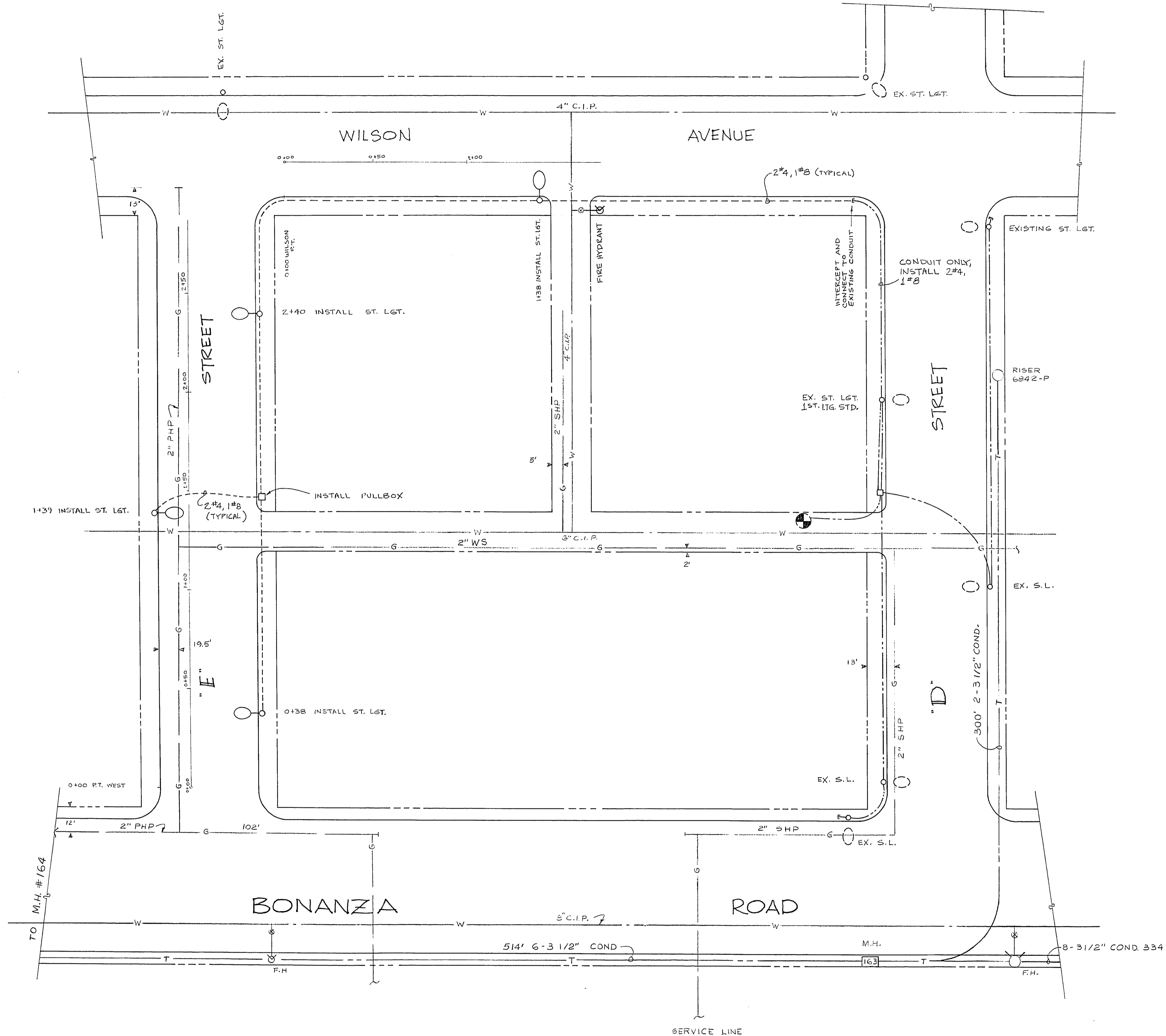
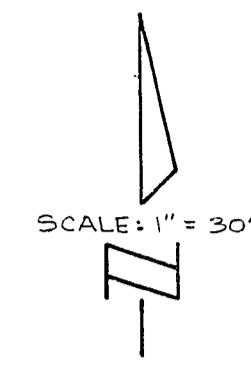

APPROXIMATE QUANTITIES

ITEM No.	DESCRIPTION	QUANTITY	UNIT
623 G.02.0235	No. 3/2 PULL BOX	1	EA.
623 G.03.0424	24" DEEP TRENCH/BACKFILL AND CONDUIT	655	L.F.
623 G.03.0648	48" DEEP FOUNDATION	4	EA.
623 L.02.0315	150W H.P.S. LUMINAIRE AND POLE ASSEMBLY	4	EA.
623 L.02.0504	No. 4 THW CONDUCTOR	1,668	L.F.
623 L.02.0508	No. 8 THW CONDUCTOR	834	L.F.
626.00.00	CLEANING AND FINAL CLEAN UP	LUMP SUM	L.S.

NOTES

1. THE CONTRACTOR SHALL NOT WORK ON ANY ENERGIZED CIRCUITS. THE EXISTING CIRCUITRY SHALL BE CONNECTED AND DISCONNECTED BY CLV FORCES.
2. ALL GENERAL NOTES ON SHEET 2 OF THIS CONTRACT SHALL APPLY TO THIS SHEET ALSO.
3. THE CONTRACTOR SHALL NOTIFY THE INSPECTION DEPARTMENT OF THE LAS VEGAS VALLEY WATER DISTRICT 48 HOURS PRIOR TO EXCAVATION IN ORDER THAT WATER FACILITIES MAY BE LOCATED AND MARKED.

LEGEND

- 150W H.P.S. LUMINAIRE AND POLE ASSEMBLY
- EXISTING STREET LIGHT
- INSTALL UNDERGROUND CONDUIT
- EXISTING CONDUIT
- PULL BOX

Revisions	Date

Scale (h) 1" = 30'	Scale (v) —	W.A. 2043
File. bk. no.	Date 9-12-80	Drawn by P.L.L.
Design by P.L.L.		

Department of Public Services
Engineering Design Division

STREET LIGHTING
NSA II
"C" AND "E" STREETS

"E" STREET
AND
WILSON AVENUE



Drawing no. 207-V221 5A/5

CONTRACT DRAWING

CENTEL *Nick Jankovic* DATE 9-24-80
 LVVWD *Henry J. Van der ...* 9-24-80
 NEW POWER Co. *P. ...* 9/29/80
 SOUTHWEST GAS Co. *Larry W. Rick* 9/18/80