

SCALE 1" = 20'

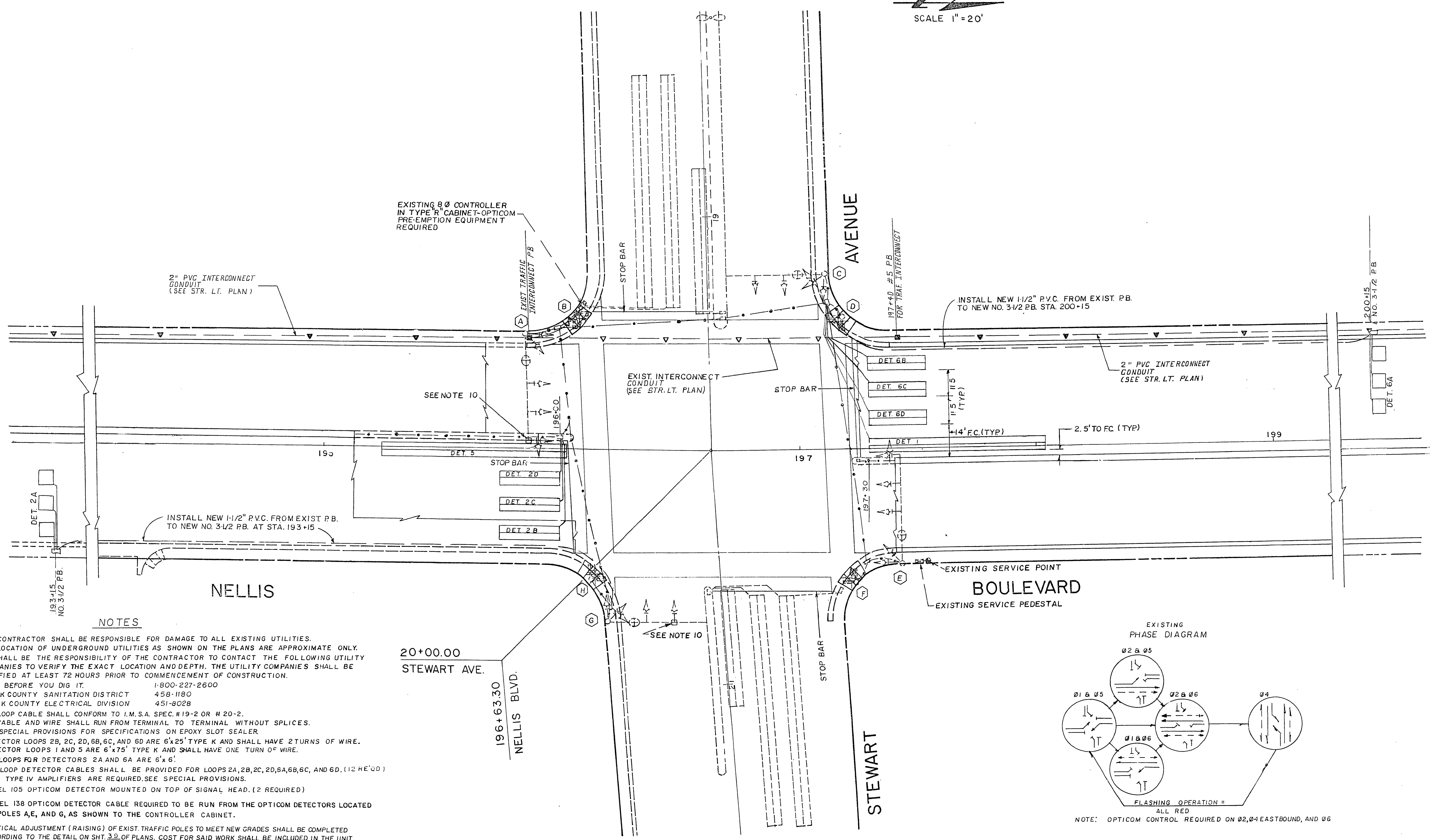

NOTES

1. THE CONTRACTOR SHALL BE RESPONSIBLE FOR DAMAGE TO ALL EXISTING UTILITIES.
2. THE LOCATION OF UNDERGROUND UTILITIES AS SHOWN ON THE PLANS ARE APPROXIMATE ONLY. IT SHALL BE THE RESPONSIBILITY OF THE CONTRACTOR TO CONTACT THE FOLLOWING UTILITY COMPANIES TO VERIFY THE EXACT LOCATION AND DEPTH. THE UTILITY COMPANIES SHALL BE NOTIFIED AT LEAST 72 HOURS PRIOR TO COMMENCEMENT OF CONSTRUCTION.
CALL BEFORE YOU DIG IT. 1-800-227-2600
CLARK COUNTY SANITATION DISTRICT 458-1180
CLARK COUNTY ELECTRICAL DIVISION 451-8028
3. ALL LOOP CABLE SHALL CONFORM TO I.M.S.A. SPEC. #19-2 OR #20-2.
4. ALL CABLE AND WIRE SHALL RUN FROM TERMINAL TO TERMINAL WITHOUT SPLICES.
5. SEE SPECIAL PROVISIONS FOR SPECIFICATIONS ON EPOXY SLOT SEALER.
6. DETECTOR LOOPS 2B, 2C, 2D, 6B, 6C, AND 6D ARE 6'x25' TYPE K AND SHALL HAVE 2 TURNS OF WIRE. DETECTOR LOOPS 1 AND 5 ARE 6'x75' TYPE K AND SHALL HAVE ONE TURN OF WIRE.
7. THE LOOPS FOR DETECTORS 2A AND 6A ARE 6'x6'.
8. NEW LOOP DETECTOR CABLES SHALL BE PROVIDED FOR LOOPS 2A, 2B, 2C, 2D, 6A, 6B, 6C, AND 6D. (12 RE' QD)
9. FOUR TYPE IV AMPLIFIERS ARE REQUIRED. SEE SPECIAL PROVISIONS.
10. MODEL 105 OPTICOM DETECTOR MOUNTED ON TOP OF SIGNAL HEAD. (2 REQUIRED)
11. MODEL 138 OPTICOM DETECTOR CABLE REQUIRED TO BE RUN FROM THE OPTICOM DETECTORS LOCATED ON POLES A, E, AND G, AS SHOWN TO THE CONTROLLER CABINET.
12. VERTICAL ADJUSTMENT (RAISING) OF EXIST. TRAFFIC POLES TO MEET NEW GRADES SHALL BE COMPLETED ACCORDING TO THE DETAIL ON SHT. 39 OF PLANS. COST FOR SAID WORK SHALL BE INCLUDED IN THE UNIT PRICE BID FOR THE SIGNAL SYSTEM MODIFICATIONS AND LOOP DETECTOR PLACEMENT AT THIS INTERSECTION. (SEE ADDENDUM)

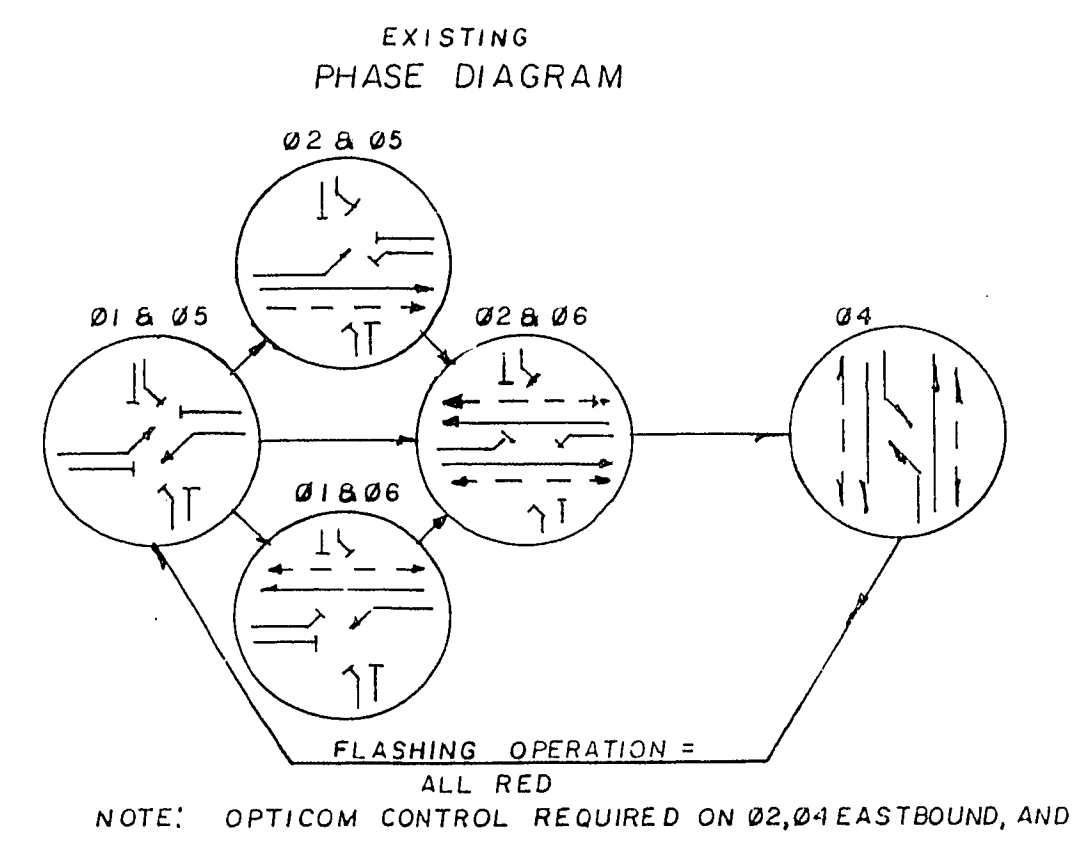

REV. NO.	DATE	DESCRIPTION	APPROVED
1	11-25-83	REVISE NOTES TO LOOP DETECTORS	

DESIGNED BY: A. SINGER
 DRAWN BY: H. O'SULLIVAN, G. HEATER
 CHECKED BY: K. WEINRICH 11/24/83

CLARK COUNTY NEVADA
 DEPARTMENT OF PUBLIC WORKS

NELLIS BOULEVARD PHASE II
 TRAFFIC CONTROL PLAN
 STEWART AVE. AT NELLIS BLVD.

SCALE	HORZ. 1" = 20'	DRAWING NO.	L-1014
	VERT. ---	PROJECT NO.	B810232
FIELD		SHT.	28 OF 42
BOOK			

107-V1800
 23-3-83