

CURVE DATA				
NO.	Δ	R	L	T
1	92° 11' 43"	25.00' BSW	40.23'	25.98'
2	89° 37' 54"	25.00' BSW	39.11'	24.84'
3	92° 37' 25"	24.00' BSW	38.80'	25.12'

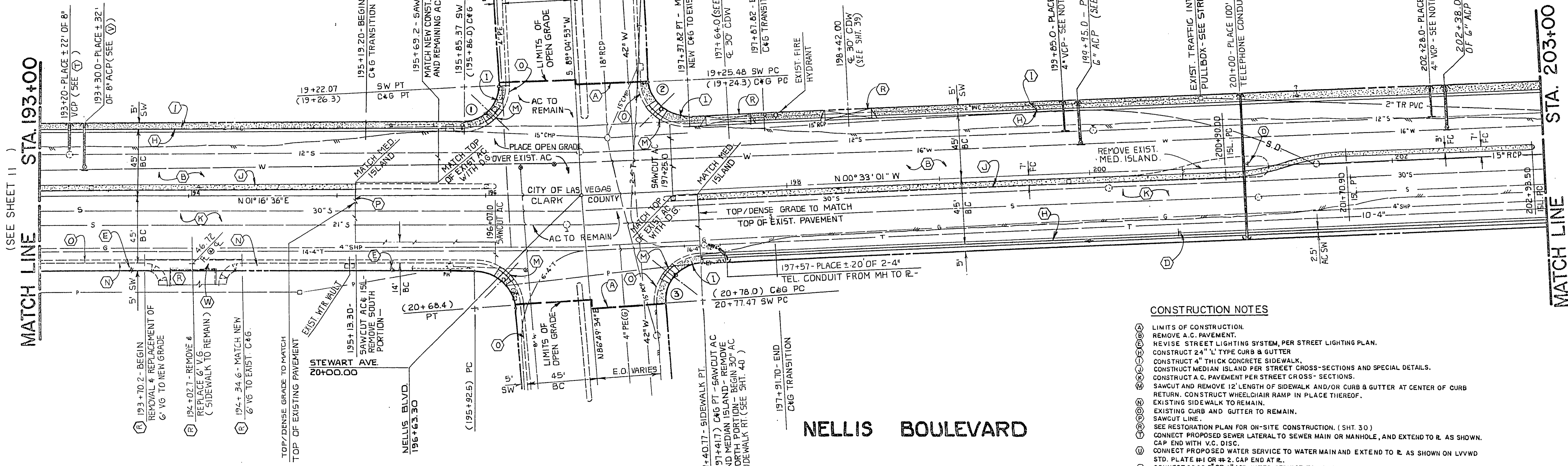

- CONSTRUCTION NOTES**
- ① LIMITS OF CONSTRUCTION REMOVE A.C. PAVEMENT.
 - ② REVERSE STREET LIGHTING SYSTEM, PER STREET LIGHTING PLAN.
 - ③ CONSTRUCT 24" L TYPE CURB & GUTTER.
 - ④ CONSTRUCT 4" THICK CONCRETE SIDEWALK.
 - ⑤ CONSTRUCT MEDIAN ISLAND PER STREET CROSS-SECTIONS AND SPECIAL DETAILS.
 - ⑥ CONSTRUCT A.C. PAVEMENT PER STREET CROSS-SECTIONS.
 - ⑦ SAWCUT AND REMOVE 12' LENGTH OF SIDEWALK AND/OR CURB & GUTTER AT CENTER OF CURB RETURN. CONSTRUCT WHEEL CHAIR RAMP IN PLACE THEREOF.
 - ⑧ EXISTING SIDEWALK TO REMAIN.
 - ⑨ EXISTING CURB AND GUTTER TO REMAIN.
 - ⑩ SAWCUT LINE.
 - ⑪ SEE RESTORATION PLAN FOR ON-SITE CONSTRUCTION. (SHT. 30)
 - ⑫ CONNECT PROPOSED SEWER LATERAL TO SEWER MAIN OR MANHOLE, AND EXTEND TO R. AS SHOWN. CAP END WITH W.C. DISC.
 - ⑬ CONNECT PROPOSED WATER SERVICE TO WATER MAIN AND EXTEND TO R. AS SHOWN ON LVVWD STD. PLATE #1 OR #2. CAP END AT R.
 - ⑭ CONNECT PROP. 6" OR 8" ADP WATER SERVICE TO WATER MAIN WITH TAPPING SLEEVE AND VALVE. CAP AT R. AND PLACE BLOW OFF VALVE AND THRUST BLOCK ACCORDING TO LVVWD STD. PLATES # 4 AND #5.
 - ⑮ CONSTRUCT VALLEY GUTTER. SEE DETAIL ON SHT. 33.

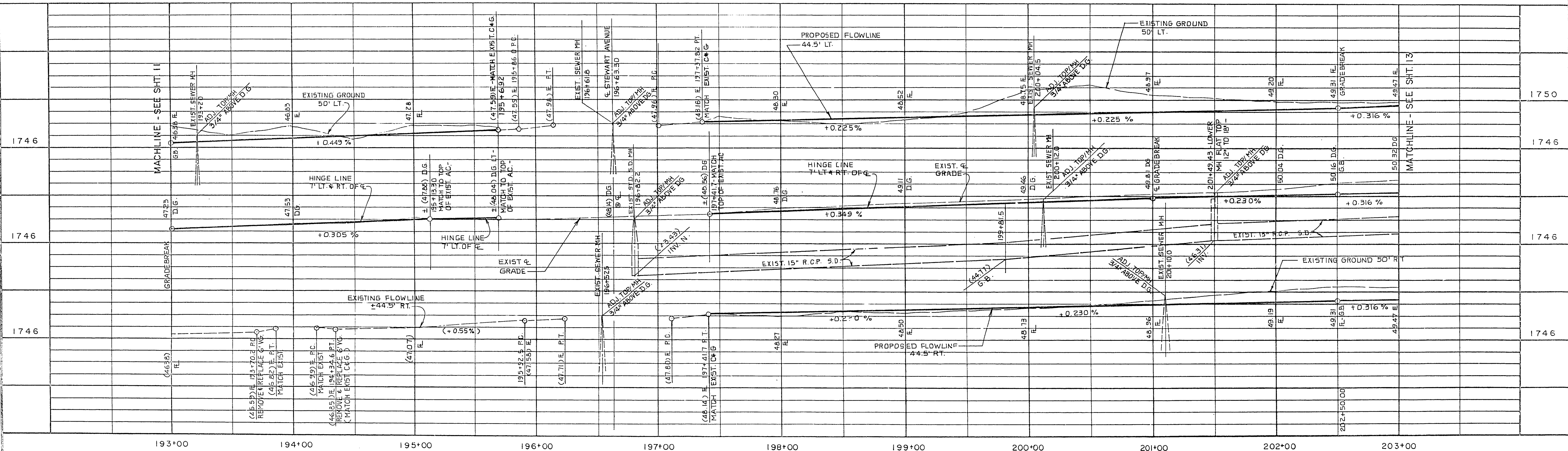

REV. NO.	DATE	DESCRIPTION	APPROVED

DESIGNED BY: R. MENDENHALL
 DRAWN BY: L.L. MILLER, H.O. SULLIVAN
 CHECKED BY: STAFF

CLARK COUNTY NEVADA
DEPARTMENT OF PUBLIC WORKS

NELLIS BOULEVARD - PHASE II
 PLAN & PROFILE
 STA. 193+00 TO STA. 203+00

SCALE	HORIZ: 1" = 40' VERT: 1" = 4'	DRAWING NO.
PROJECT NO.	8810232	L-1014
FIELD BOOK	780.732 796	
SHT. 12		OF 42

107-V1800
23-3-203