

CONSTRUCTION NOTES

- ① LIMITS OF CONSTRUCTION.
- ② REMOVE A.C. PAVEMENT.
- ③ REVISE TRAFFIC SIGNAL SYSTEM PER TRAFFIC SIGNAL PLAN.
- ④ REVISE STREET LIGHTING SYSTEM, PER STREET LIGHTING PLAN.
- ⑤ CONSTRUCT 24" L TYPE CURB & GUTTER.
- ⑥ CONSTRUCT 4" THICK CONCRETE SIDEWALK.
- ⑦ CONSTRUCT MEDIAN ISLAND PER STREET CROSS-SECTIONS AND SPECIAL DETAILS.
- ⑧ CONSTRUCT A.C. PAVEMENT PER STREET CROSS-SECTIONS.
- ⑨ SAWCUT AND REMOVE 12' LENGTH OF SIDEWALK AND/OR CURB & GUTTER AT CENTER OF CURB RETURN. CONSTRUCT WHEELCHAIR RAMP IN PLACE THEREOF.
- ⑩ EXISTING SIDEWALK TO REMAIN.
- ⑪ EXISTING CURB AND GUTTER TO REMAIN.
- ⑫ SAWCUT LINE.
- ⑬ LIMITS OF OPEN GRADE AND 7" AC STRUCTURAL SECTION.
- ⑭ SEE RESTORATION PLAN FOR ON-SITE CONSTRUCTION. (SHT. 30)
- ⑮ CONNECT PROPOSED SEWER LATERAL TO SEWER MAIN OR MANHOLE, AND EXTEND TO R. AS SHOWN. CAP END WITH V.C. DISC.
- ⑯ CONNECT PROPOSED WATER SERVICE TO WATER MAIN AND EXTEND TO R. AS SHOWN ON LVWD STD. PLATE #1 OR #2. CAP END AT R.
- ⑰ CONNECT PROPOSED 6" OR 8" ACP WATER SERVICE TO WATER MAIN WITH TAPPING SLEEVE AND VALVE. CAP AT R., AND PLACE BLOW OFF VALVE AND THRUST BLOCK ACCORDING TO LVWD STD. PLATES #1-4 AND #4-5.

NOTE: SEE SHEET 32
FOR ALTERNATE CONCRETE
INTERSECTION DESIGN -
(NELLIS @ CHARLESTON)

(SEE SHEET 8)
MATCH LINE STA. 163+00

MATCH LINE STA. 173+00
(SEE SHEET 10)

CURVE DATA					CURVE DATA				
No.	Δ	R	L	T	No.	Δ	R	L	T
1	7° 04' 49"	2591.91' BC	320.29'	160.35'	7	2° 46' 41"	2629.91' FC	127.51'	63.77'
2	7° 04' 49"	2681.91' BC	331.41'	165.92'	8	2° 46' 41"	2632.91' FC	127.66'	63.84'
3	15° 39' 37"	154.204' FC	4.215'	21.21'	9	90° 53' 52"	25.00' BS	39.66'	25.39'
4	13° 48' 48"	181.472' FC	43.75'	21.98'	10	86° 28' 16"	25.00' BS	37.73'	23.51'
5	15° 39' 37"	157.204' FC	4.297'	21.62'	11	88° 24' 00"	25.00' BS	38.57'	24.31'
6	13° 48' 48"	176.472' FC	43.03'	21.62'	12	7° 04' 49"	2636.31' FC	325.85'	163.13'

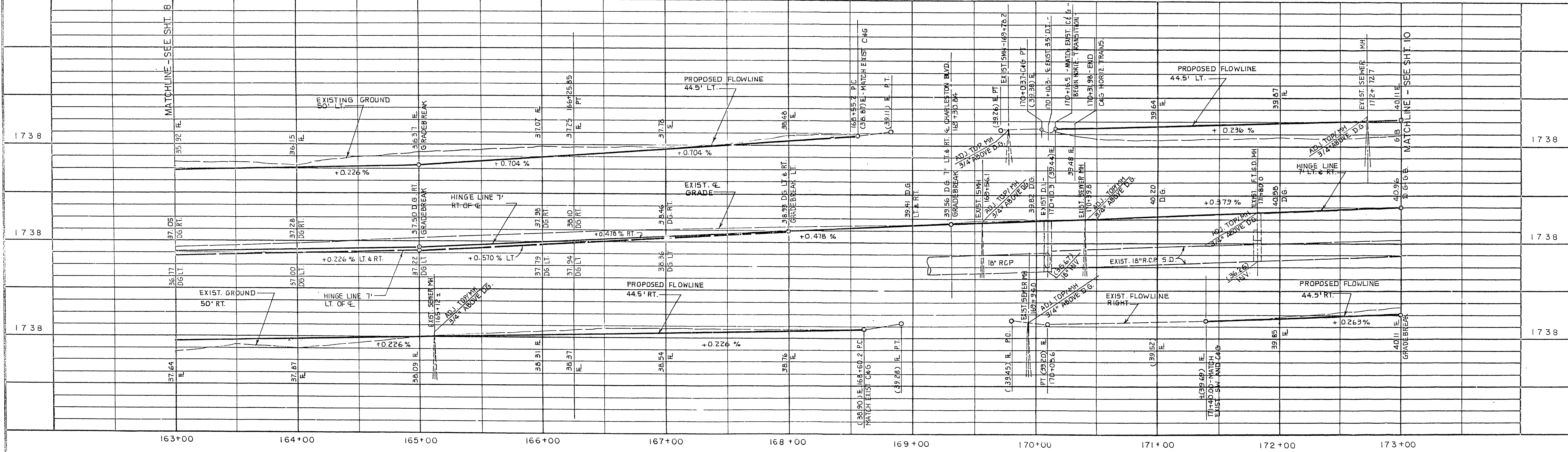
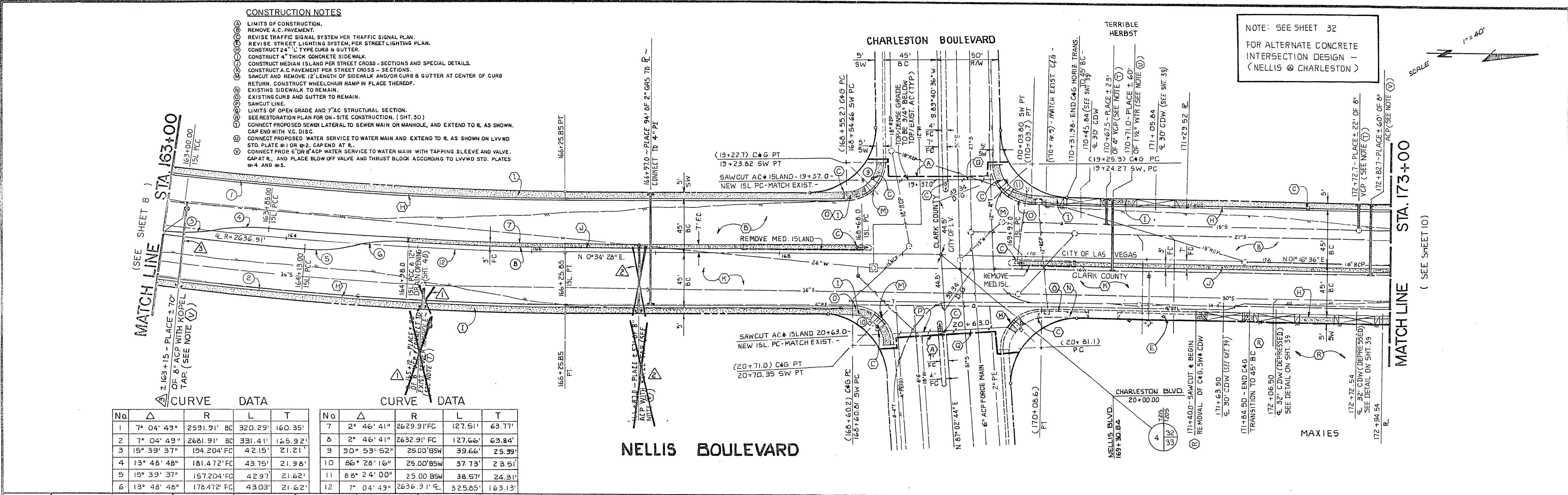

REV. NO.	DATE	DESCRIPTION
12-15-86		8" ACP PLACED @ 163+15 (NOT IN ORIGINAL CONTRACT).
12-15-86		8" ACP DELETED FROM CONTRACT @ STA. 166+87.
12-15-86		8" VCP DELETED FROM CONTRACT @ STA. 165+12.

DESIGNED BY: R. MENDENHALL
 DRAWN BY: L.L. MILLER, H.O. SULLIVAN
 CHECKED BY: STAFF
 APPROVED

CLARK COUNTY NEVADA
 DEPARTMENT OF PUBLIC WORKS

NELLIS BOULEVARD - PHASE II
 PLAN & PROFILE
 STA. 163+00 TO STA. 173+00

SCALE	HORIZ.: 1" = 40'	DRAWING NO.	L-1014
	VERT.: 1" = 4'	PROJECT NO.:	B810232
FIELD BOOK	780,788		
	794	SHT.	9 OF 42

107-V1800
23-3-90