

NOTE: STRUCTURAL SECTION WITHIN SHADED AREA.
INCREASE DEPTH OF TYPE 2 AGGREGATE 2"
OR DEPTH OF CEMENT TREATED BASE 1".

NOTE: FOR STREETLIGHTING, SEE SHEET 78
FOR TRAFFIC SIGNAL, SEE SHEET 86
FOR STORM DRAIN, SEE SHEET 46

B.C. CURVE DATA				
N#	Δ	RADIUS	LENGTH	TANGENT
3	91° 44' 55"	30.00'	48.04'	30.93'
4	87° 51' 46"	30.00'	46.00'	28.90'
5	90° 13' 05"	31.00'	48.81'	31.12'
6	90° 10' 14"	36.00'	56.66'	36.11'

- CONSTRUCTION NOTES
- (A) SAWCUT & JOIN
 - (B) LIMITS OF OPEN GRADE
 - (C) CONST. WHEELCHAIR RAMP
 - (D) CONST. WITH 2" BIT. SURF. & 6" TYPE 2 AGG.
 - (E) REMOVE CONC. CURB OR CURB & GUTTER
 - (F) REMOVE CONC. SIDEWALK

CONSTRUCTION REVISION
SEE SHEETS 32A-32C

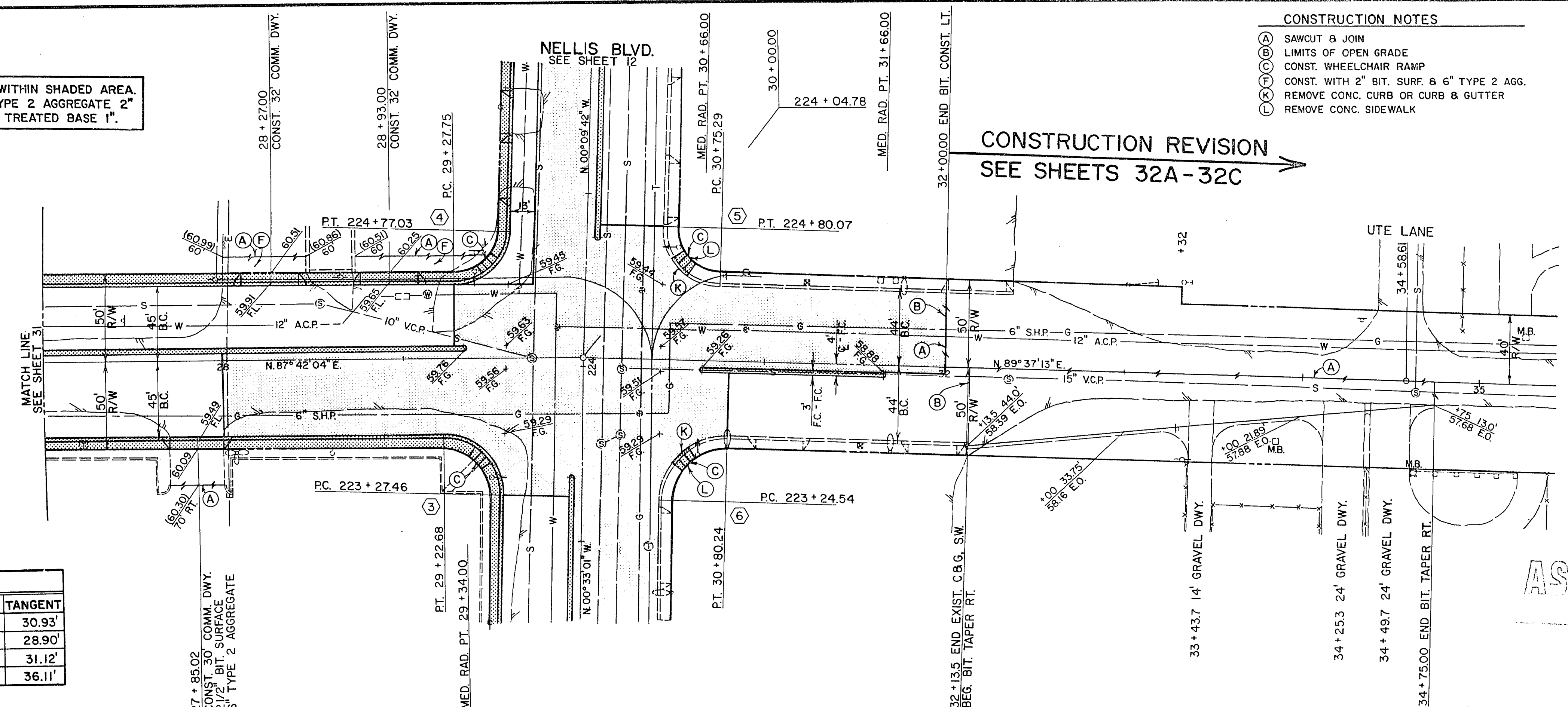

AS-BUILT

4-18-86
(Pmr)

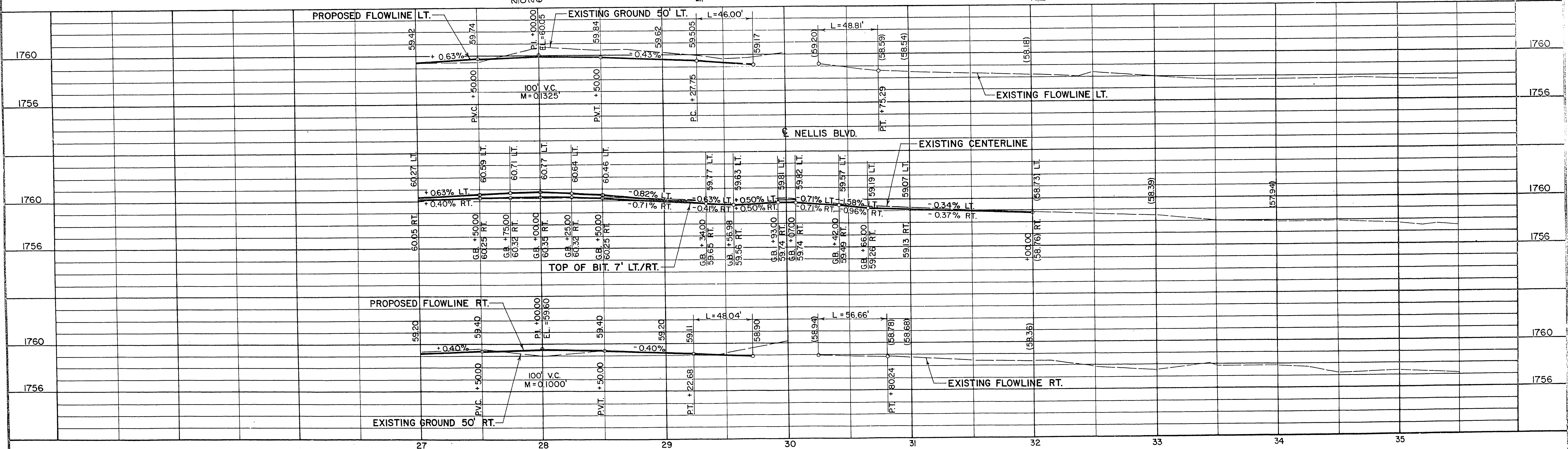

DESIGNED BY: *Paula Kelly*
DRAWN BY: *Sal Gre*
CHECKED BY: *A. [Signature]*

CLARK COUNTY NEVADA
DEPARTMENT OF PUBLIC WORKS

BONANZA ROAD
PLAN AND PROFILE
STA. 27+00 TO STA. 33+00

SCALE	HORIZ.: 1"=40'	DRAWING NO.	L-1017
	VERT.: 1"=4'		
PROJECT NO.	B810233	SHT. 32	OF 92

107-V1789

51-3-24