

FIRE FLOW CALCULATIONS

THE FIRE FLOW REQUIREMENT IS: 1,500 GALLONS PER MINUTE 20 PSI RESIDUAL PRESSURE.

BASED ON:
 SQUARE FOOTAGE: 1,927 SQUARE FEET
 LARGEST AREA BETWEEN 4-HOUR AREA SEPARATION WALLS: N/A SQUARE FEET
 BUILDING HEIGHT: 35 FEET
 NUMBER OF STORES: 2 FLOORS
 TYPE OF CONSTRUCTION: V-NON RATED
 OCCUPANCY: RESIDENTIAL
 FULL AUTOMATIC FIRE SPRINKLER SYSTEM: NO

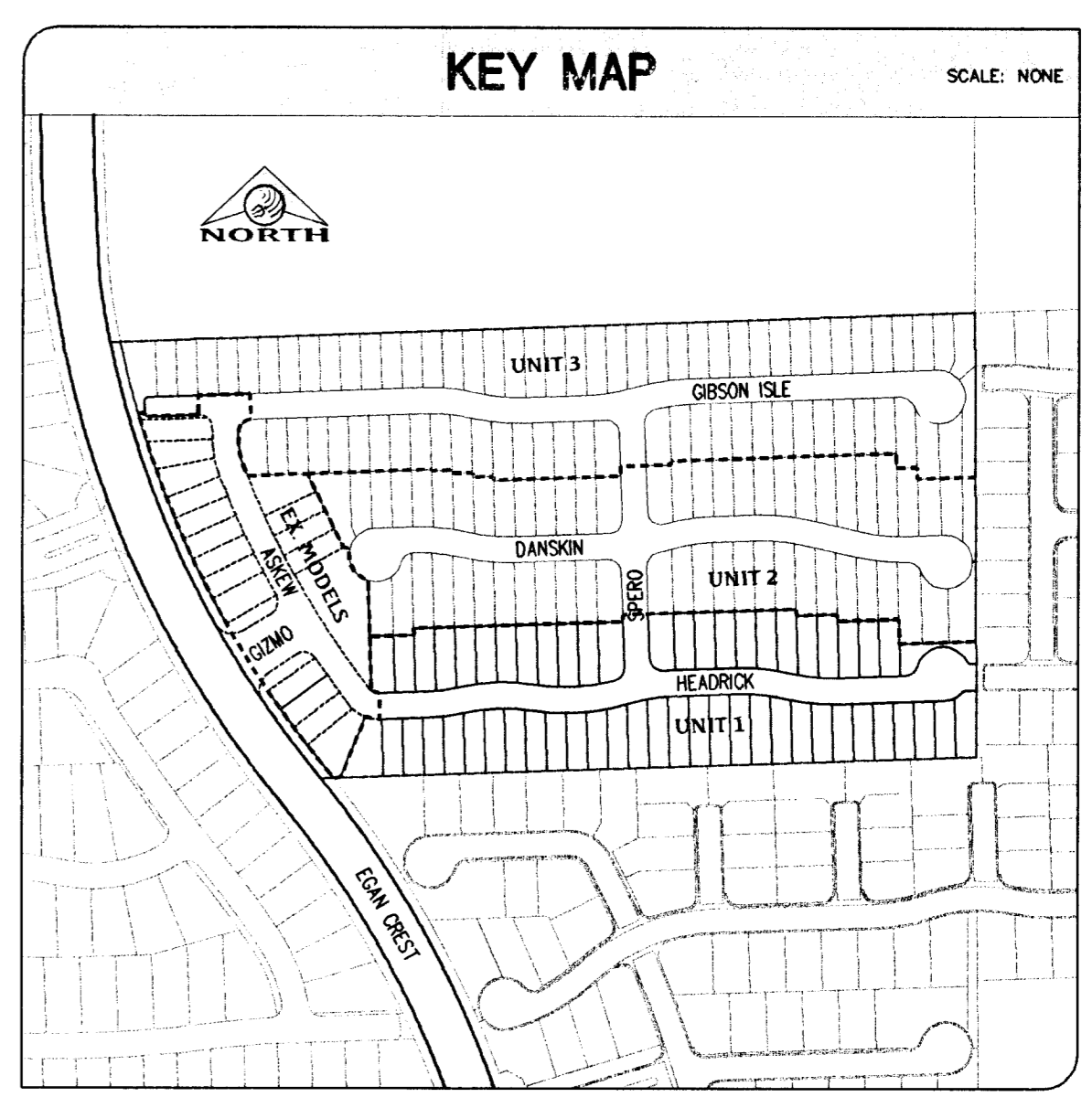
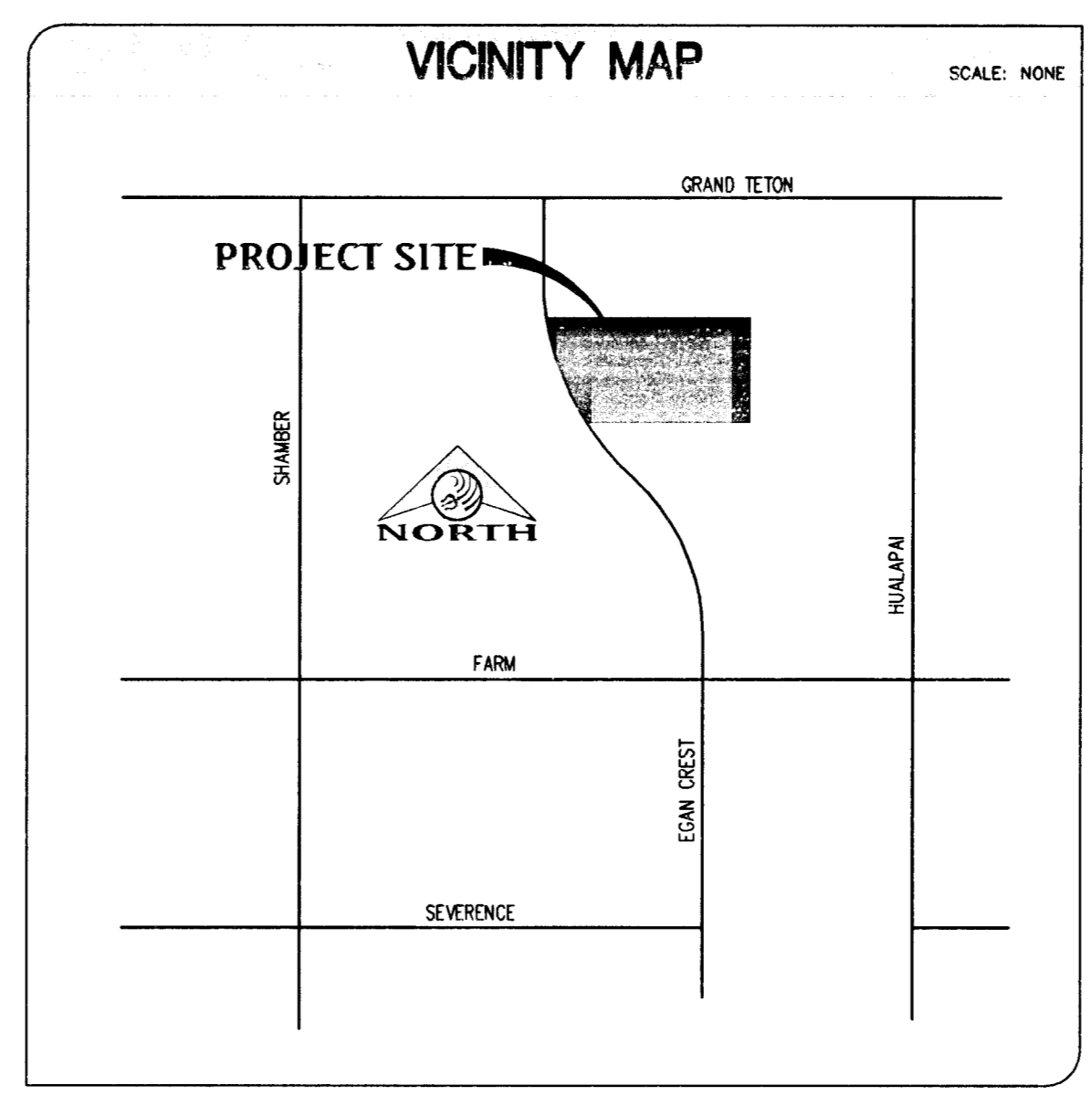
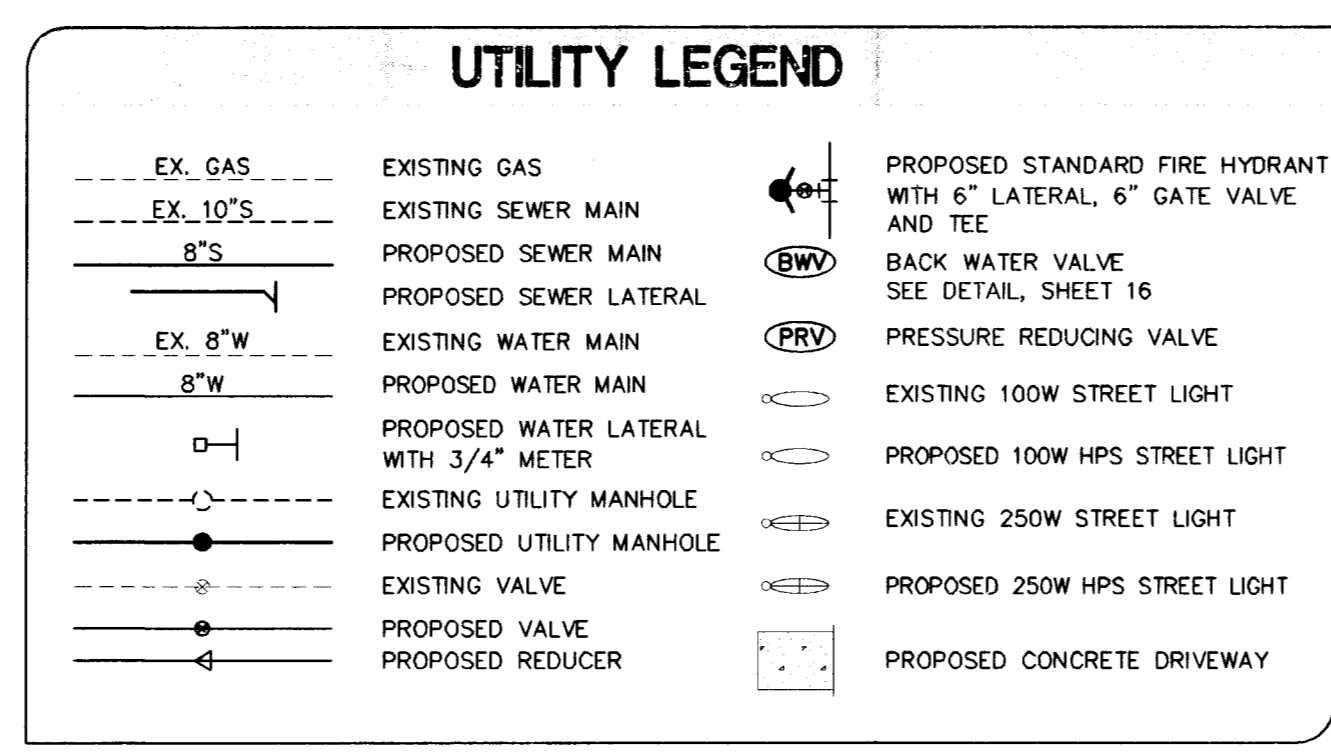
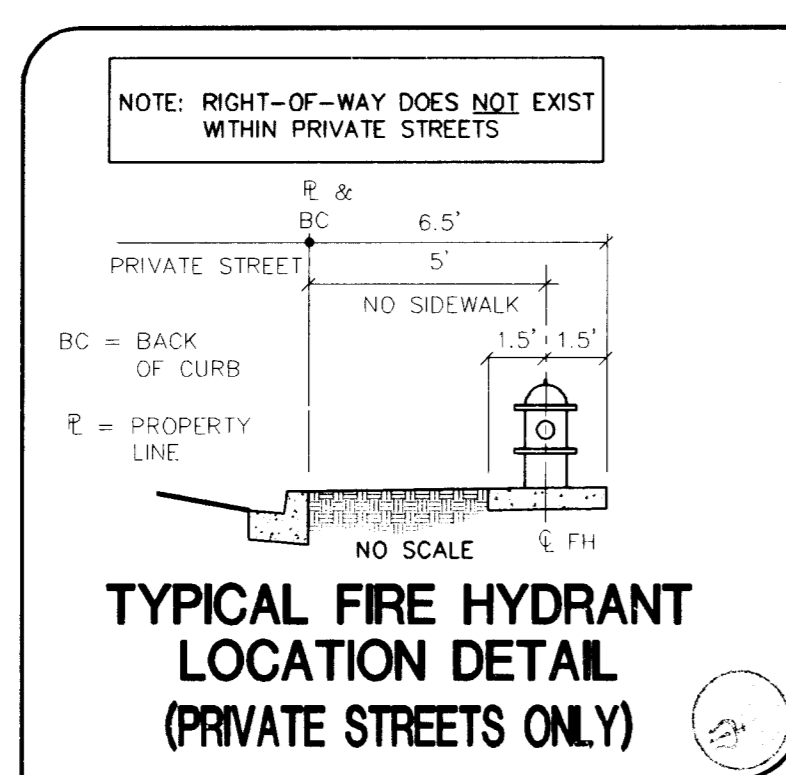

UTILITY NOTES

FIRE, WATER AND SEWER SERVICES, AS APPROVED ON THIS PLAN, ARE INTENDED SPECIFICALLY FOR THE LOT AND USE SHOWN AND ARE NOT INTENDED TO SERVE ADDITIONAL PARCELS OR STRUCTURES WHICH MAY BE CREATED IN THE FUTURE. IN THE EVENT THAT THE PARCELS AND/OR LOTS SHOWN ON THIS PLAN ARE FURTHER DIVIDED TO CREATE ADDITIONAL PARCELS OR LOTS, THE OWNER IS REQUIRED TO PROVIDE SEPARATE FIRE, WATER AND SEWER SERVICES TO EACH.

ALL WATER FACILITIES CONSTRUCTION SHALL BE IN ACCORDANCE WITH THE "UNIFORM DESIGN AND CONSTRUCTION STANDARDS FOR WATER DISTRIBUTION SYSTEMS" (UDACS), LATEST EDITION.

IF THE PROJECT OVERLAYS AN AREA INVOLVING SNWS FACILITIES, THE DEVELOPER'S ENGINEER SHALL SUBMIT THE PLANS TO SNWS FOR THEIR REVIEW PARALLEL TO THE AGENCY'S REVIEW. SNWS APPROVAL MUST BE OBTAINED PRIOR TO AGENCY WATER PLAN APPROVAL. THE SNWS MAY BE CONTACTED BY TELEPHONE AT (702) 486-6741, BY FAX AT 486-6742, OR BY MAIL AT 243 LAKE SHORE ROAD, BOULDER CITY, NEVADA, 89005.

PRV PRESSURE REDUCING VALVE

This property may have static water pressure in excess of 80 psi. The Uniform Plumbing Code requires that individual, on-site (private), pressure reducing valves be installed whenever the pressure exceeds 80 psi. PRVs are the Developer's responsibility and will not be inspected or included in the acceptance of LVWD facilities.

LOTS WITHIN 3000' ZONE WITH A FINISH FLOOR ELEVATION LESS THAN 2000.4 WILL REQUIRE A PRV.
 (LOTS 18 - 46 & IRRIGATION METER WILL REQUIRE PRVS)

REDUCED PRESSURE PRINCIPLE ASSEMBLY (1) T

APPROVED REDUCED PRESSURE PRINCIPLE ASSEMBLY(S) SHALL BE INSTALLED PER THE UDACS PLATE NO. 11A. NO WATER SHALL BE TAKEN FROM A SERVICE REQUIRING BACKFLOW PREVENTION UNTIL THE REDUCED PRESSURE PRINCIPLE ASSEMBLY HAS BEEN SUCCESSFULLY TESTED BY THE LVWD. ANY BLOCK WALL OR OTHER FENCE MATERIAL SHALL BE DESIGNED AND CONSTRUCTED AROUND THE OUTSIDE OF THE ASSEMBLY(S) TO ALLOW THE DISTRICT DIRECT ACCESS FROM THE ADJACENT RIGHT-OF-WAY. EASEMENT SHALL BE CLEARLY MARKED OR STAKED PRIOR TO THE START OF CONSTRUCTION.

BWV BACK WATER VALVE

BACKWATER VALVES REQUIRED PER U.P.C., LATEST EDITION, SECTION 710.0.

THE FOLLOWING LOTS REQUIRE A BWV:
 6, 7, 9, 10, 13, 14, 17, 18, 19, 22, 25, 26, 27, 30, 31, 32, 35, 38, 39, 40, 42, 43, 46, 47, 50, 53, 54, AND 57

TOTAL LOTS REQUIRING BACKWATER VALVES = 28

Avoid cutting underground utility lines. It's costly.
Call before you Dig.
 1-800-227-2600
 UNDERGROUND SERVICE ALERT (USA)

Avoid hitting overhead power lines. It's costly.
Call before you do Overhead
 1-702-227-2929

BENCHMARK

CITY OF LAS VEGAS BENCHMARK: 8LV99-1355S BEING A RIVET AND PLATE IN CONCRETE CYLINDER NW CORNER OF HUALAPAI AND ELAVORN.

ELEVATION: 2853.03 (FEET)
 869.606 (METERS)

BASED ON THE NORTH AMERICAN VERTICAL DATUM OF 1988 (NAVD 88).

BASIS OF BEARING

THE BASIS OF BEARINGS FOR THIS SURVEY IS NORTH 00°06'16" EAST BEING THE EAST LINE OF THE NORTHWEST QUARTER (NW 1/4) OF SECTION 24, TOWNSHIP 19 SOUTH, RANGE 59 EAST, M.D.W. CLARK COUNTY, NEVADA, AS SHOWN ON A RECORD OF SURVEY ON FILE IN THE CLARK COUNTY, NEVADA, RECORDER'S OFFICE IN FILE 123 PAGE 32. 184524

