

TRAFFIC LEGEND & QUANTITIES

SHEETS 10 & 11

○ 30" STOP SIGN SEE SHEET 11 FOR GRAPHICAL DEPICTION	1 EA
— D-3 9" STREET NAME SIGN PER UDS 250	2 EA
— "NO PARKING BEYOND THIS POINT" SEE SHEET 11 FOR GRAPHICAL DEPICTION	0 EA
■ BLUE REFLECTOR MARKER	
Ⓢ SIGHT DISTANCE NOTHING OVER 24" IN HEIGHT ALLOWED IN SIGHT VISIBILITY ZONE EXCEPT TRAFFIC CONTROL DEVICES. (SEE SHEET 13 FOR BEARINGS AND DISTANCES)	

TRAFFIC NOTE LEGEND

① INSTALL BLUE COLORED REFLECTIVE RAISED PAVEMENT MARKERS 16 FEET FROM THE FACE OF THE CURB ON THE HYDRANT SIDE.

NEVADA POWER APPROVAL

NEVADA POWER COMPANY ACKNOWLEDGES THAT WE HAVE RECEIVED YOUR PLANS AND WILL PROVIDE SERVICE TO ALL ELECTRICAL NEEDS ASSOCIATED WITH THIS PROJECT. NEVADA POWER COMPANY RESERVES THE RIGHT TO ADDRESS ANY EXISTING OR FUTURE CONFLICTS ONCE THE FINAL DESIGN IS COMPLETED. THE NEW SERVICE AND THE RESOLUTION OF ANY CONFLICTS WILL BE ACCOMPLISHED PURSUANT TO THE NEVADA PUBLIC UTILITY COMMISSION'S RULES AND REGULATIONS.

J. Calabrese 7-10-07
NEVADA POWER COMPANY DATE

CURVE TABLE

CURVE	LENGTH	RADIUS	DELTA	TANGENT
C1	58.41	319.50	107°31'	29.29
C2	51.28	280.50	107°31'	25.71
C3	51.28	280.50	107°31'	25.71
C4	58.41	319.50	107°31'	29.29
C5	116.83	319.50	207°02'	59.07
C6	102.57	280.50	207°02'	51.86
C7	82.97	319.50	145°45'	41.72
C8	72.87	280.50	145°30'	36.84
C9	82.73	319.50	145°00'	41.80
C10	72.83	280.50	145°00'	36.52
C11	82.92	319.50	145°11'	41.69
C12	27.02	20.00	77°24'37"	16.03
C13	61.83	280.50	123°45'	31.04
C14	32.47	20.00	53°04'45"	21.09
C15	16.87	319.50	370°13'	8.44
C16	72.70	280.50	145°01'	36.56
C17	25.20	20.00	72°14'	14.58
C18	5.67	5.00	64°56'52"	3.18
C19	98.02	40.50	132°32'36"	107.37
C20	4.15	5.00	47°03'30"	2.20
C21	32.58	40.50	46°05'48"	17.23

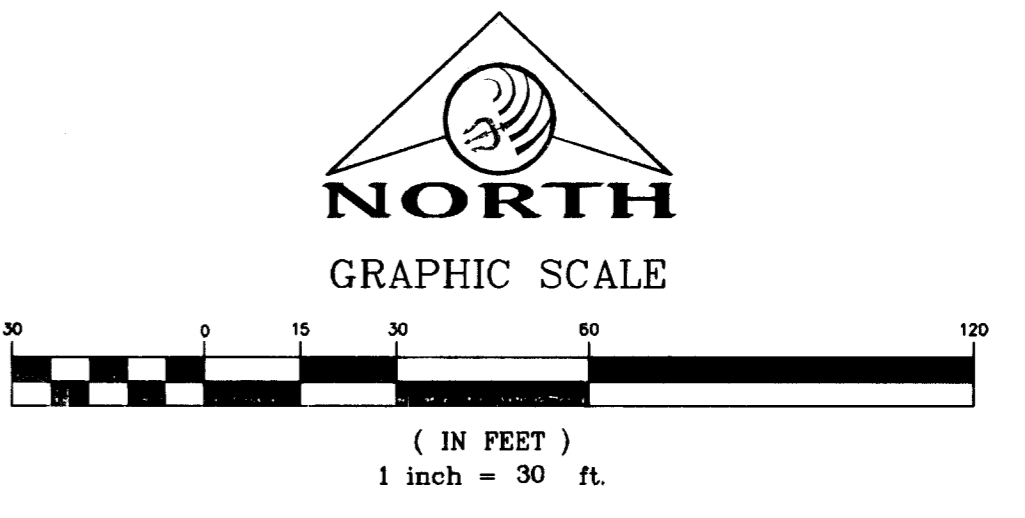
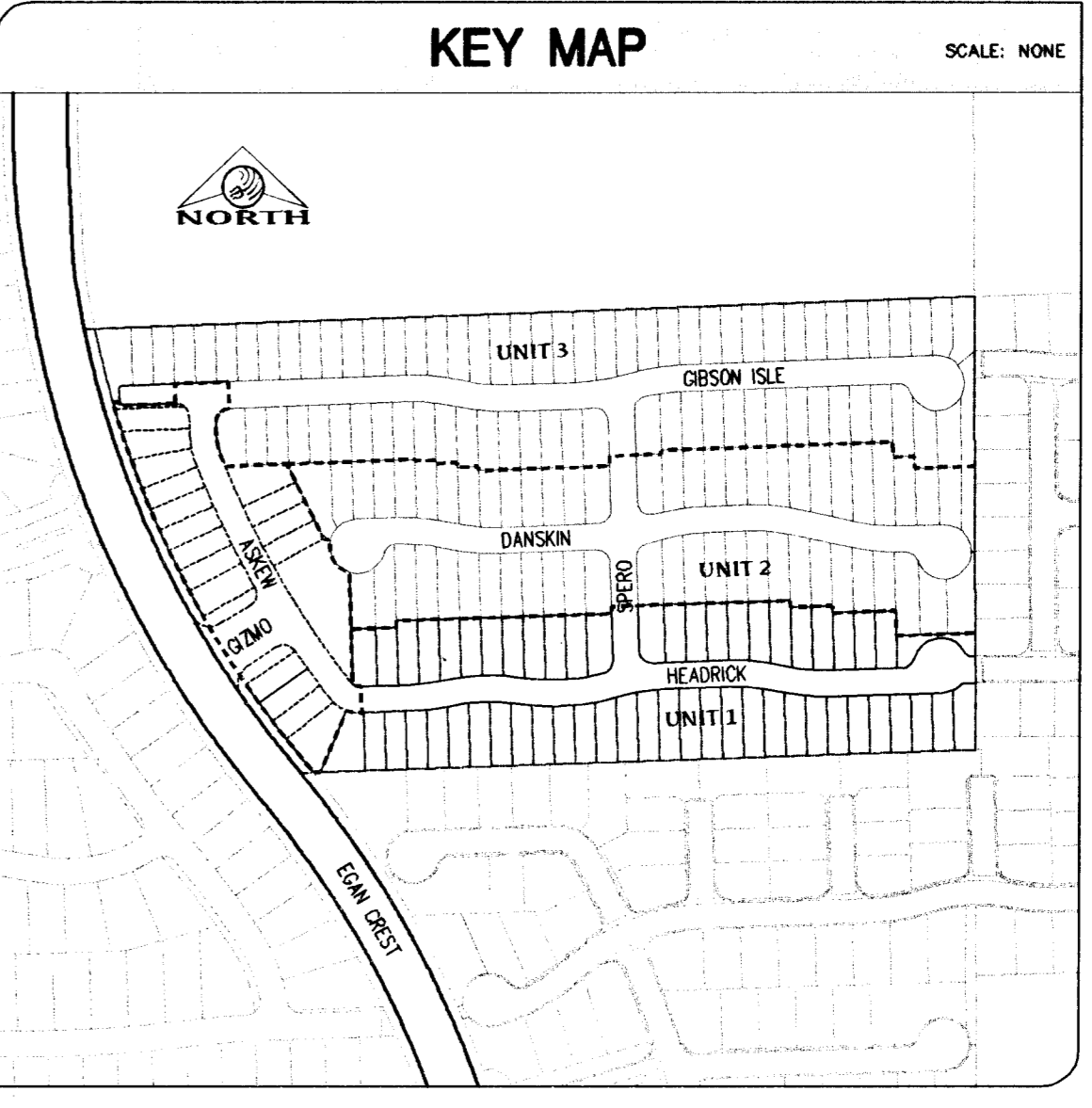

Avoid cutting underground utility lines. It's costly.

Call before you Dig.
1-800-227-2600
UNDERGROUND SERVICE ALERT (USA)

Avoid hitting overhead power lines. It's costly.

Call before you Overhead
1-702-227-2929

BENCHMARK

CITY OF LAS VEGAS BENCHMARK 8LV99-135E5 BEING A RIVET AND PLATE IN CONCRETE CYLINDER NW CORNER OF HUALAPAI AND ELKHORN.

ELEVATION: 2853.03 (FEET)
869.606 (METERS)

BASED ON THE NORTH AMERICAN VERTICAL DATUM OF 1988 (NAVD 88)

BASIS OF BEARING

THE BASIS OF BEARINGS FOR THIS SURVEY IS NORTH 00°08'16" EAST BEING THE EAST LINE OF THE NORTHWEST QUARTER (NW 1/4) OF SECTION 24, TOWNSHIP 19 SOUTH, RANGE 59 EAST, M.D.M. CLARK COUNTY, NEVADA, AS SHOWN ON A RECORD OF SURVEY ON FILE IN THE CLARK COUNTY, NEVADA, RECORDER'S OFFICE IN FILE 123 PAGE 32.

104526

DATE: MARCH 15, 2007
DRAWN BY: J. PEARCE
DESIGNED BY:
CHECKED BY:
SCALE: 1" = 30' FT.

Triton Engineering
6797 W. Charleston Blvd.
Suite B
Las Vegas, Nevada 89146
Office: (702) 254-1480
Fax: (702) 254-3062
www.tritoneng.com

WOODSIDE HOMES OF NEVADA
MADISON COLONY - UNIT 1
TRAFFIC PLAN 1

PROFESSIONAL ENGINEER
JAMES M. PEARCE
Exp. 12-31-07
CIVIL
No. 9552

SHEET 10 OF 11
C.L.V. DWG.# 10744953-1