

FOR EX. SHAUMBER ROAD IMP'S, SEE CLIFFS EDGE / PROVIDENCE SHAUMBER ROAD, CENTENNIAL TO GRAND TETON BY VTN, CLV #107Y4816-SHB 107Y4816-OS-7

FOR EXISTING IMPROVEMENTS SEE NORTHERN TERRACE UNIT 4 IMPROVEMENT PLANS by GC WALLACE, INC JOB NO. 819.002.X11 CLV DWG NO. 107Y-4891-4

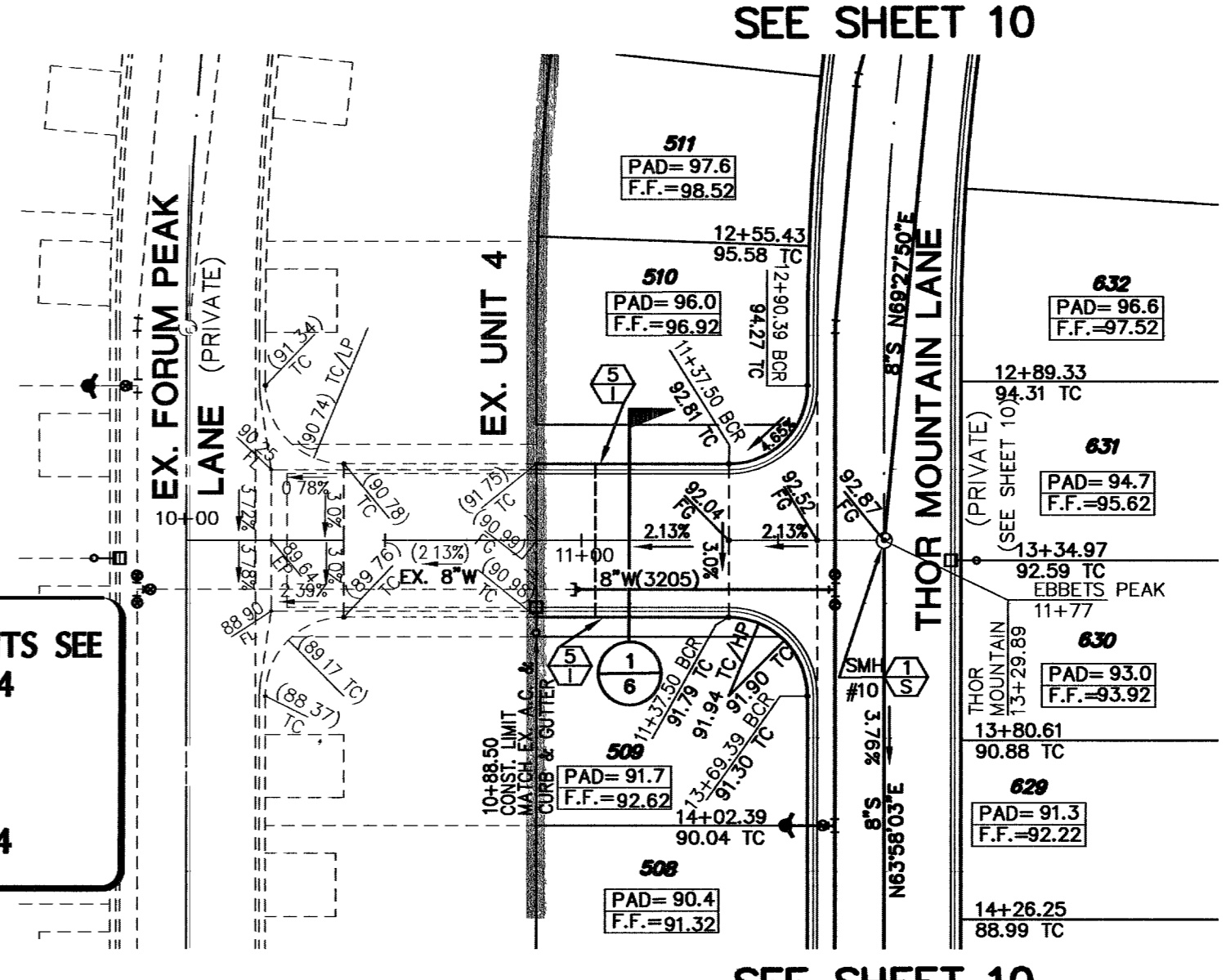

SEE SHEET 10

SEE SHEET 12 BARTLETT PEAK STREET (PRIVATE)

SEE SHEET 12

SEE SHEET 10 EBBETS PEAK STREET (PRIVATE)

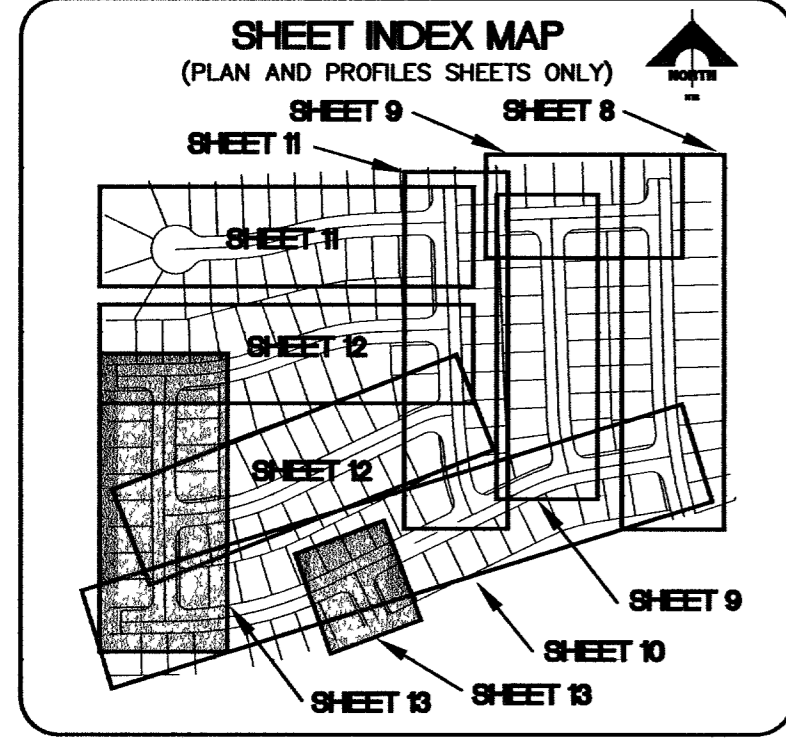

**BASIS OF BEARINGS**  
N 88°21'18" E BEING THE SOUTH LINE OF THE SOUTHWEST QUARTER (SW 1/4) OF THE NORTHEAST QUARTER (NE 1/4) OF SECTION 13, T19S, R59E, M.D.M., AS SHOWN BY RECORD OF SURVEY ON FILE IN THE CLARK COUNTY, NEVADA RECORDER'S OFFICE IN FILE 124 OF SURVEYS AT PAGE 94.

**BENCHMARK**

DESC.	NAVD 88 DATUM	NAVD 88 DATUM
BLV99 RIVET AND PLATE IN CONCRETE CYLINDER AT THE NORTHWEST CORNER OF HUALAPAI WAY AND FARM ROAD.	2860.79 (FEET)	871.971 (METERS)

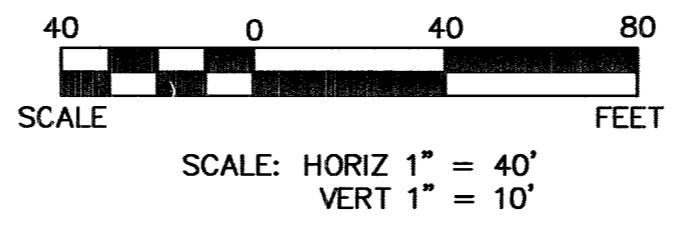
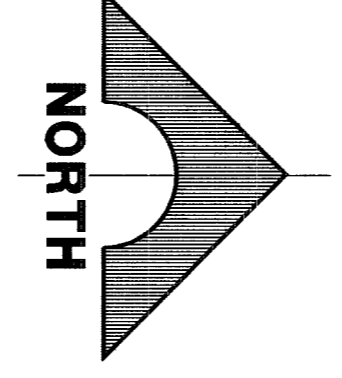

**NOTE**  
1. ALL PRIVATE STREETS ARE P.U.E., PUBLIC SEWER EASEMENTS, AND PUBLIC DRAINAGE EASEMENTS TO BE PRIVATELY MAINTAINED BY HOA.

Call before you Dig. 1-702-455-7511 1-702-229-6611

Call before you Dig. 1-800-227-2600 UNDERGROUND SERVICE ALERT (USA)

CALL BEFORE YOU DO OVERHEAD. 1-702-227-2929

APPROVAL: [Signature] LVVWD NO. 111714 DATE: 8-02-06 LAS VEGAS VALLEY WATER DISTRICT

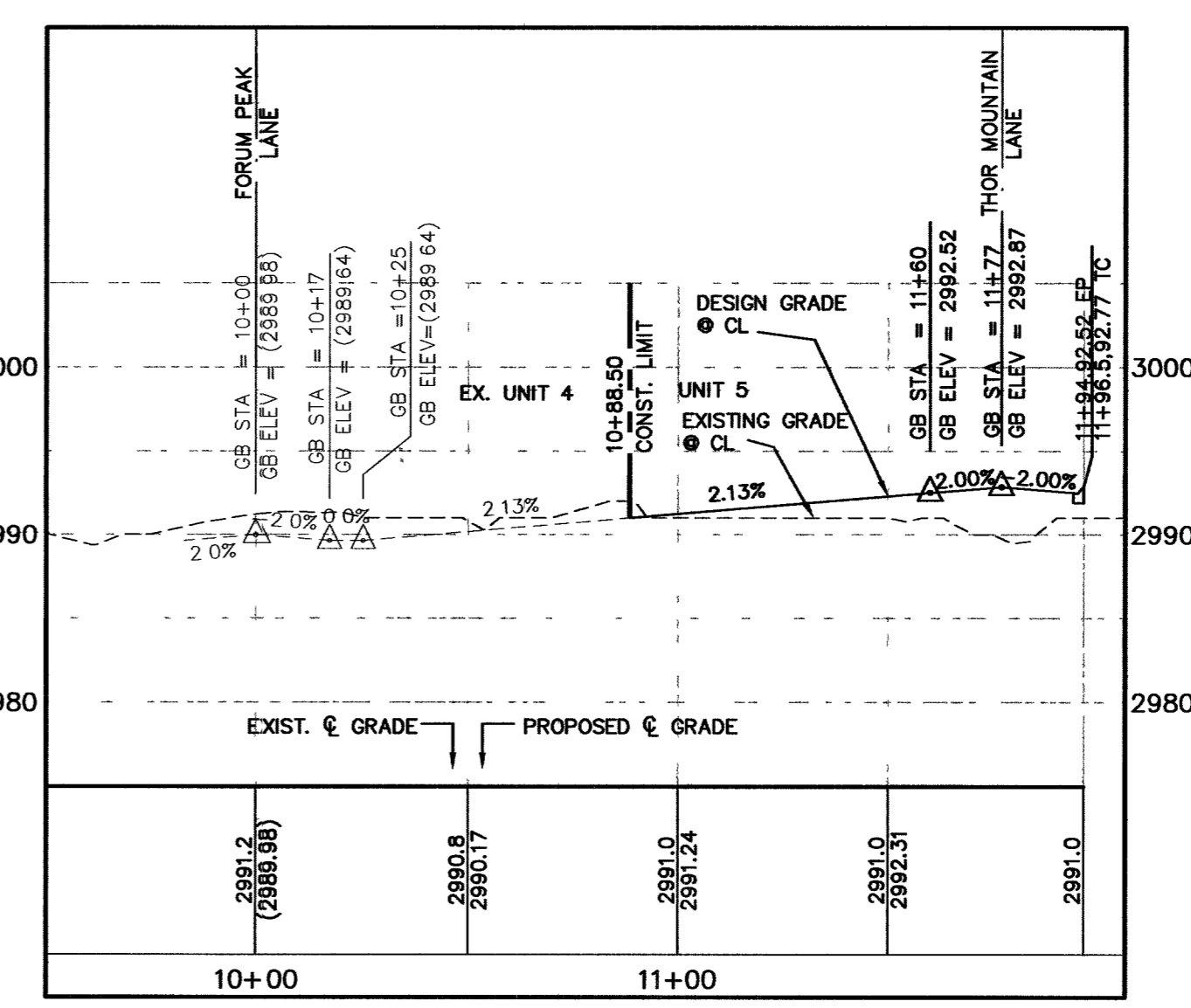
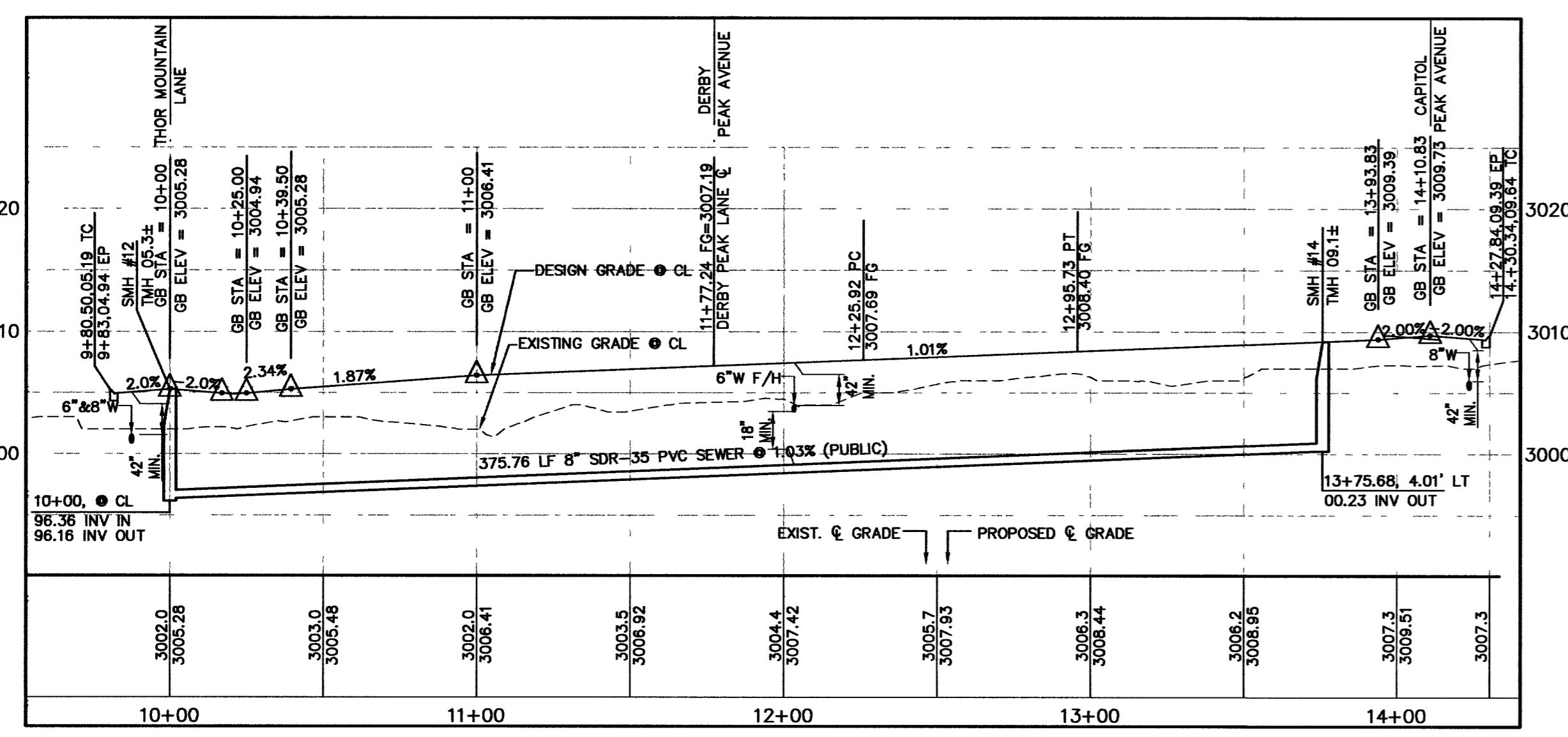

93124 95263

CLV DRAWING NO. 107Y4891-5

DRAWING C-13 15 OF 17 SHEETS

MERTAGE CORPORATION NORTH-TERRACE - UNIT 5 BARTLETT PEAK STREET AND EBBETS PEAK STREET PLAN AND PROFILE JOB NO. 819.002.X12

DESIGN: G.C. WALLACE, INC. ENGINEERS/PLANNERS/SURVEYORS  
DRAWN: [Name] CHECK: [Name] ISSUE DATE: [Date]  
ISSUE EDITOR: [Name] PLOT DATE: 06-08-06  
PLOT TIME: 08:26:07  
DATE: 06/06