

DATE: 7/11/06

7/11/06 149
DATE: 7/11/06
APP: DATE: 7/11/06
REV: DATE: 7/11/06

DESIGN: _____
DRAWN: _____
CHECK: _____
ISSUE DATE: _____
PLOT DATE: 07-11-06
PLOT TIME: 15:21:28

G.C. WALLACE, INC.
Engineers/Planners/Surveyors
1555 SOUTH RAINBOW BLVD., LAS VEGAS, NEVADA 89146
TELEPHONE: (702) 844-2000 • FAX: (702) 844-2299
E-Mail: gwallace@wallaceinc.com
www.wallaceinc.com

MERITAGE HOMES
NORTHERN TERRACE - UNIT 1
RECREATION CENTER
GRADING PLAN
DRAWING
39B
39B OF 39 SHEETS

JOB NO. 819.002.X08

FOR EXISTING IMPROVEMENTS
SEE NORTHERN TERRACE UNIT 1
IMPROVEMENT PLANS
by GCW WALLACE, INC
JOB NO. 819.002.X08
CLV DWG NO. 107Y4891-1

FOR EXISTING IMPROVEMENTS
SEE NORTHERN TERRACE UNIT 3
IMPROVEMENT PLANS
by GCW WALLACE, INC
JOB NO. 819.002.X08
CLV DWG NO. 107Y-4891-3

FOR EXISTING IMPROVEMENTS
SEE NORTHERN TERRACE UNIT 2
IMPROVEMENT PLANS
by GCW WALLACE, INC
JOB NO. 819.002.X08
CLV DWG NO. 107Y-4891

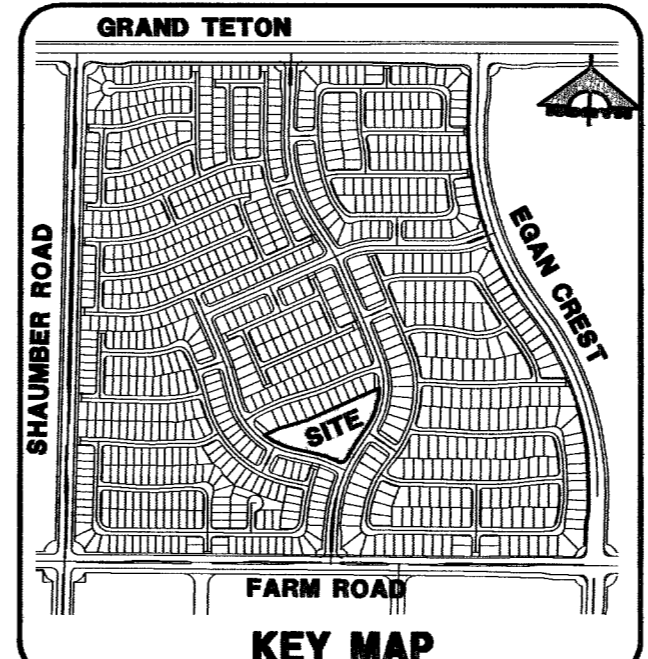
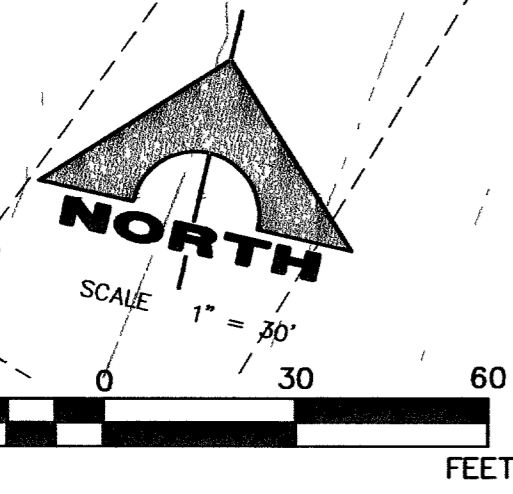

- CONSTRUCTION NOTES**
- IMPROVEMENTS**
- 1 CONTRACTOR TO VERIFY LOCATION OF EXISTING IMPROVEMENT AND PROTECT IN PLACE
 - 2 VERIFY LOCATION AND ELEVATION OF EX. ROADWAY IMPROVEMENT
 - 3 CONSTRUCT "A" TYPE CURB & GUTTER (218 USD)
 - 4 CONSTRUCT CONCRETE SIDEWALK (234 USD)
 - 5 CONSTRUCT SIDEWALK DRAIN (236 USD)
 - 6 INSTALL CROSS GUTTER (228 USD)
 - 7 CONSTRUCT DEPRESSED CURB FOR SIDEWALK RAMP (235 USD)
 - 8 INSTALL A.C. PAVEMENT PER TYPICAL PARKING PAVEMENT SECTIONS (F 380)
 - 9 SAWCUT AND MATCH EXISTING IMPROVEMENTS.
 - 10 CONSTRUCT CURB OPENING PER DETAIL (G/H 380)
 - 11 CONSTRUCT "L" TYPE CURB AND GUTTER (216 USD)
 - 12 INSTALL WHEEL STOPS

- LEGEND & ABBREVIATION**
- (A 390) DRAWING NUMBER FOR DETAIL WITH REFERENCE TO THE SHEET IT IS DRAWN ON
 - (I) INDICATES CONSTRUCTION NOTE
 - ===== EXISTING CURB AND GUTTER
 - EX 60"50 EXISTING STORM DRAIN
 - 60.50 PROPOSED SPOT ELEVATION
 - TC TOP OF CURB
 - (80.5) EXIST. SPOT ELEVATION
 - TC FINISH GRADE
 - PROPERTY LINE
 - FUTURE BACK OF CURB
 - CENTERLINE
 - EXISTING SLOPE
 - I = IMPROVEMENTS
 - TC = TOP OF CURB
 - FG = FINISH GRADE
 - FL = FLOW LINE
 - FF = FINISH FLOOR
 - HP = HIGH POINT
 - LP = LOW POINT
 - DG = DESIGN GRADE
 - C&G = CURB AND GUTTER
 - EX = EXISTING
 - SD = STORM DRAIN
 - DI = DROP INLET
 - SDMH = STORM DRAIN MANHOLE

BENCHMARK

STA.	DESC.	NAVD 88 DATUM	NAVD 88 DATUM
BLV99 13E4	RIVET AND PLATE IN CONCRETE CYLINDER AT THE NORTHWEST CORNER OF HUALAPAI WAY AND FARM ROAD.	2860.79 (FEET)	871.971 (METERS)

BASIS OF BEARINGS

N 88°21'18" E BEING THE SOUTH LINE OF THE SOUTHWEST QUARTER (SW 1/4) OF THE NORTHEAST QUARTER (NE 1/4) OF SECTION 13, T19S, R56E, W4DM., AS SHOWN BY RECORD OF SURVEY ON FILE IN THE CLARK COUNTY, NEVADA RECORDER'S OFFICE IN FILE 124 OF SURVEYS AT PAGE 94.

DRAINAGE CERTIFICATION

I CERTIFY THAT THIS GRADING PLAN IS IN CONFORMANCE WITH THE APPROVED DRAINAGE STUDY ON FILE AT THE CITY OF LAS VEGAS FOR THIS PROJECT (DS3927).

Joshua Johnson 15789 *Julia*
JOSHUA JOHNSON P.E. NO. DATE

Avoid cutting underground utility lines. It's costly.
Call before you Dig.
1-800-227-2600
UNDERGROUND SERVICE ALERT (USA)

Avoid hitting overhead power lines. It's costly.
CALL BEFORE YOU DO OVERHEAD
1-702-227-2929

Call before you UnderGround
1-702-455-7511
1-702-229-6611

93760

107Y4891-1
NFW