

APPROXIMATE QUANTITIES—THIS SHEET				
ITEM	DESCRIPTION	QUANTITY	UNIT	
201.1	ROADWAY EXCAVATION	450	CU. YD.	
340.1	CONSTRUCT CONCRETE CURB & GUTTER	400	LN. FT.	
302.1	TYPE I GRAVEL BASE	213	CU. YD.	
302.2	TYPE II GRAVEL BASE	91	CU. YD.	
334.4	2 INCH ASPHALTIC CONCRETE PAVEMENT	822	SQ. YD.	
333.1	BITUMINOUS T&G SEAL	822	SQ. YD.	
123.204	INSTALL 4" V.C.P. (EXIST.)	36	LN. FT.	
512.51	ADJUST MANHOLE TO GRADE	7	EACH	

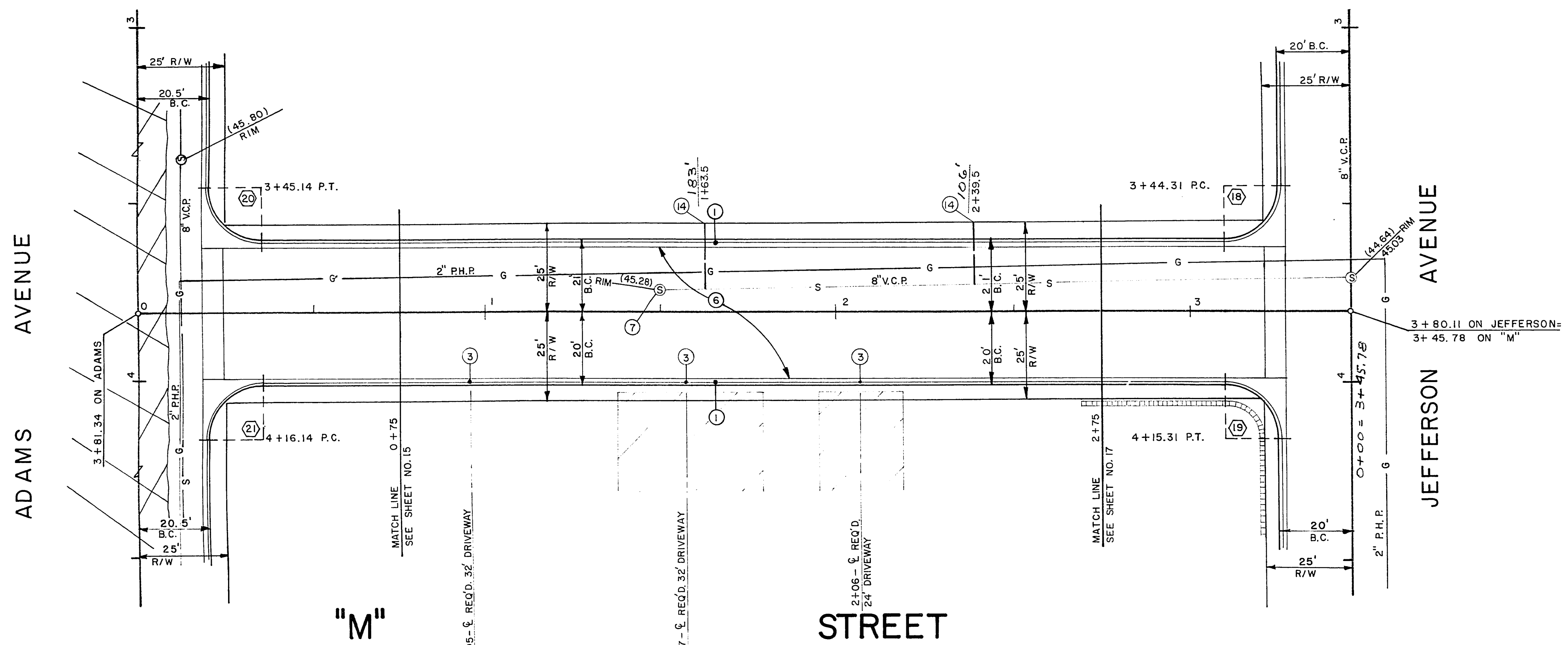

CURVE NO.	Δ	R	T	L
20	90°19'36"	15.00	15.09	23.65
21	89°40'24"	15.00	14.91	23.48
18	89°39'59"	15.00	14.91	23.47
19	90°20'01"	15.00	15.09	23.65

BENCH MARK: GUARD STAKE ON POWER POLE AT NORTH EAST CORNER OF IVY STREET AND MADISON AVENUE. ELEVATION 2042.48

DATE	BY	DATE	BY
10/15/68	RBH	9-5-68	KSA
9-27-68	RBH	9-27-68	RBH
9-27-68	RBH	9-27-68	RBH
9-27-68	RBH	9-27-68	RBH

CONTRACT DRAWING  
FEB 3, 1969

WEST FLOW LINE

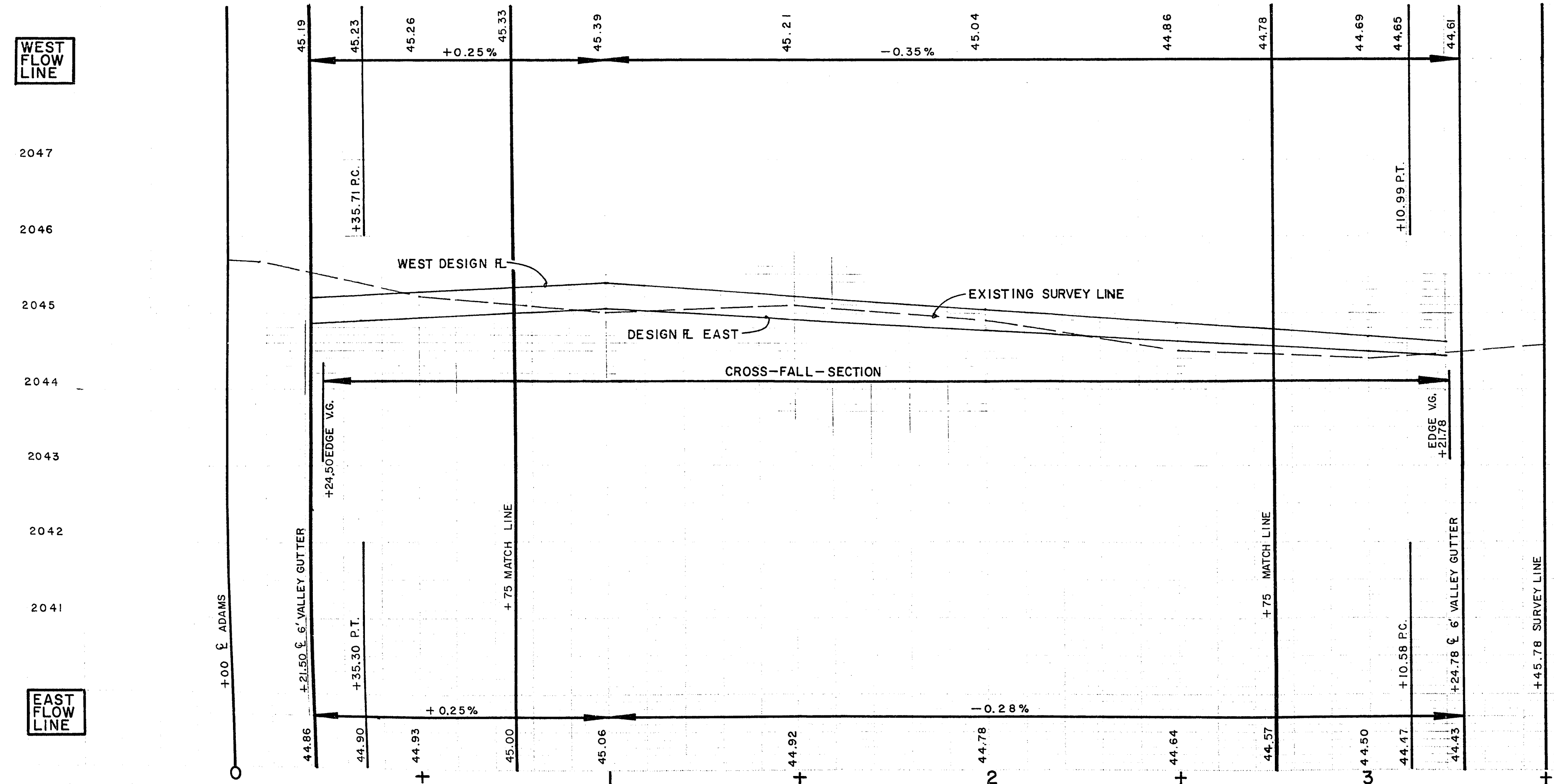

EAST FLOW LINE

AS BUILT SEWER

**CITY OF LAS VEGAS NEVADA**  
ENGINEERING DEPT.

"M" STREET  
ADAMS AVENUE TO JEFFERSON AVENUE  
STATION 0+75 TO STATION 2+75

S.A.D. 486 UNIT I-II	DATE	SC. NO.	" = 20'
DES. K. ANDERSON	4-25-68	SC. 10	" = 1'
DR. AL ARMSTRONG	6-26-67	F. BK. NO.	66-6X
CKD.		P.L.O. NO.	

APPROVED BY CITY ENGR.  
*[Signature]*

DRAWING NO. **486**

134-37 107-V 781