

SCALE - 1" = 20'

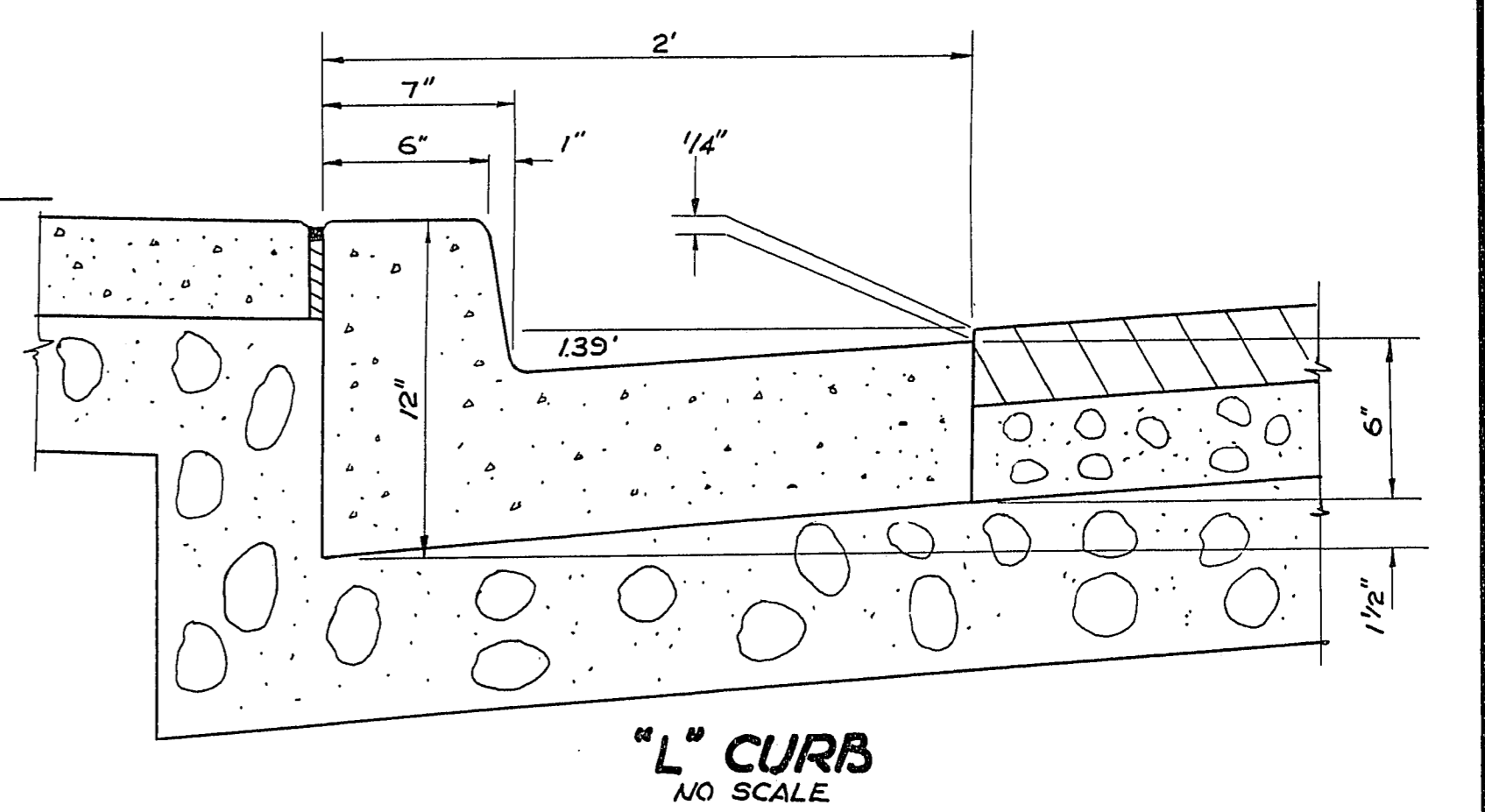
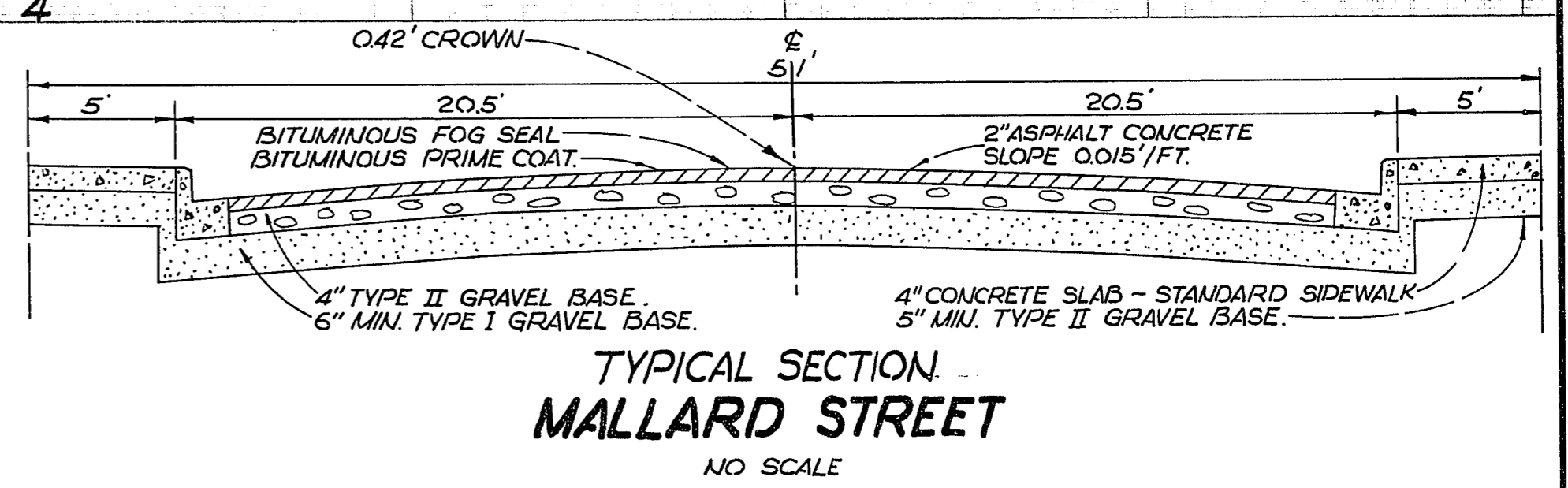
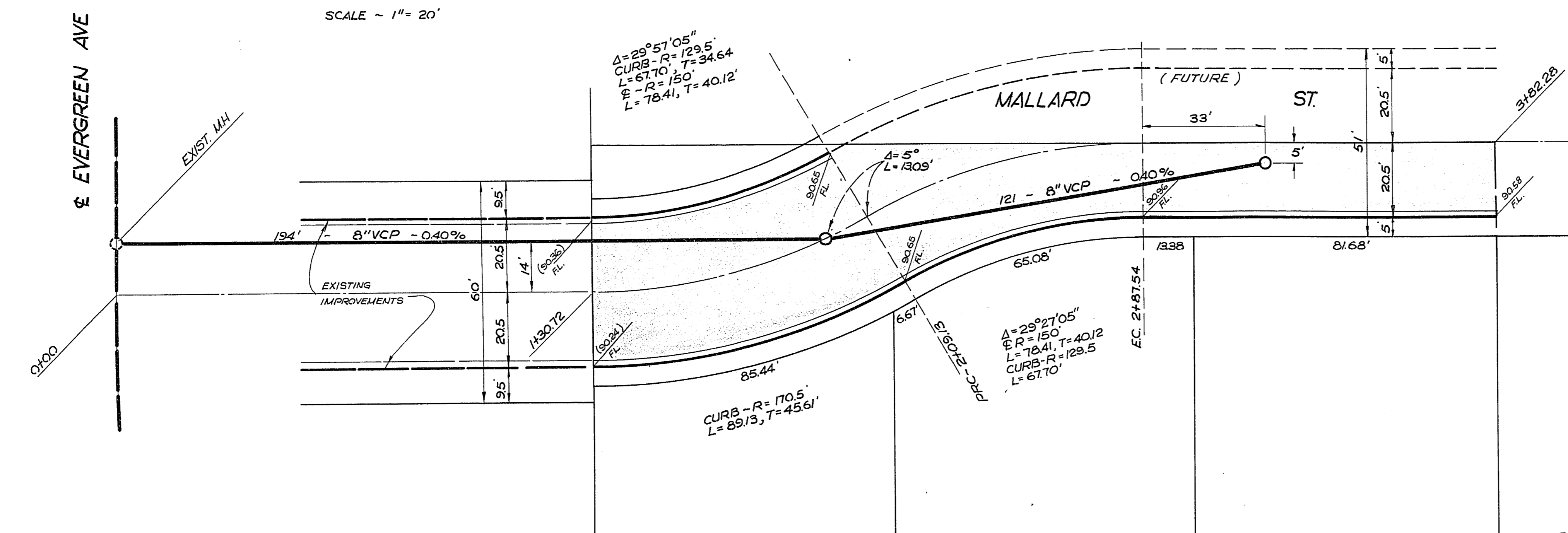

MALLARD STREET

PREPARED BY
ROY L. KLEMA ENGINEERS INC.
 2929 INDUSTRIAL RD
 LAS VEGAS, NEVADA
 R. L. Klema
 ROY L. KLEMA R.C.E. 859

-NOTES-
 REFER TO ORDINANCE 886, SEC.13
- BENCH MARK -
 SPIKE IN POWER POLE NO 18279 @ 1/16
 SEC. LINE # UPLAND, 100'± SOUTH OF
 EVERGREEN AVE.
 CITY OF LAS VEGAS DATUM
 ELEV. 2283.81

CITY OF LAS VEGAS NEVADA		
ENGINEERING DEPT.		
MALLARD STREET		
SLY OF EVERGREEN AVE		
DES.	DATE	SC. (H)
DR.		SC. (V)
DR.		F.B.K. NO.
CKD		P.I. O. NO.
APPROVED BY CITY ENGR.		DRAWING NO.
L.B. Whiting	2/11/63	107-V495