

QUANTITIES

2" WATER METER	2 EA
1 1/2" WATER METER	1 EA
2" SERVICE SADDLE	2 EA
1 1/2" SERVICE SADDLE	1 EA
10" DCDA	2 EA
8" PVC C-900 WL	21 LF
10"x8" REDUCER	2 EA
8" 22.5° ELBOW	1 EA

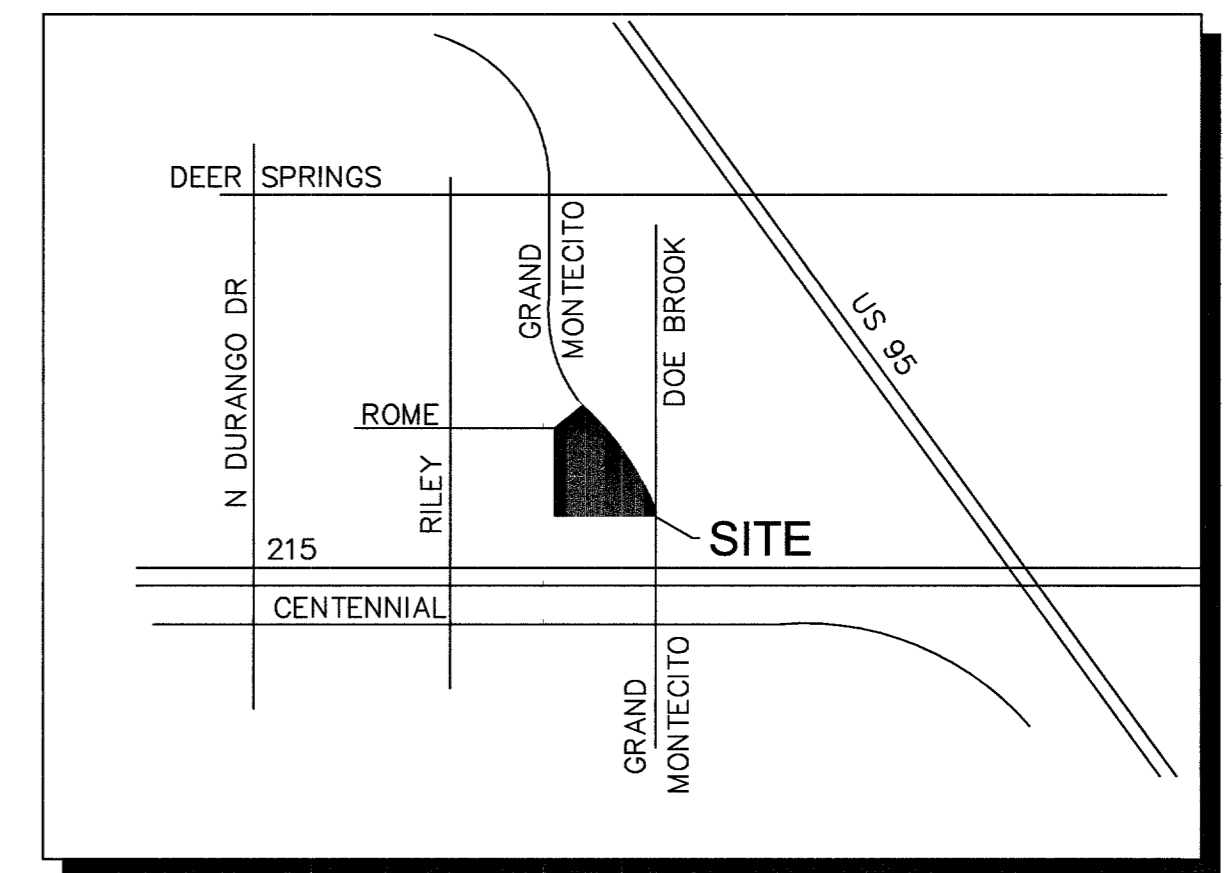

AREA MAP
N.T.S.

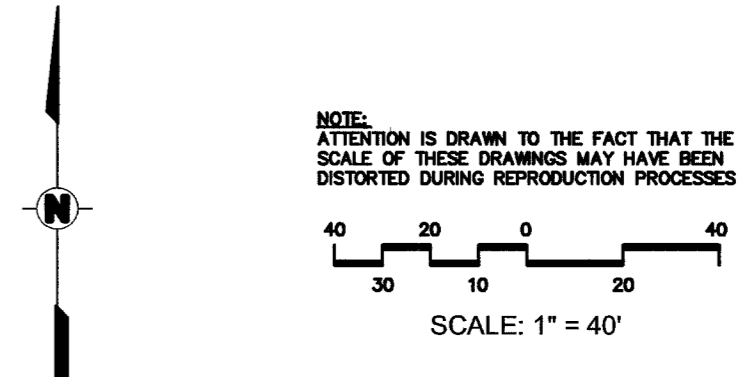

BASIS OF BEARING
NORTH 00°05'12" EAST, BEING THE BEARING OF THE WEST LINE OF THE SOUTHEAST QUARTER (SE 1/4) OF THE SOUTHWEST QUARTER (SE 1/4) OF SECTION 20, TOWNSHIP 19 SOUTH, RANGE 60 EAST, M.D.M., AS SHOWN IN BOOK 113, PAGE 38 OF PLATS ON FILE AT THE CLARK COUNTY, NEVADA RECORDER'S OFFICE.

BENCHMARK
CITY OF LAS VEGAS VERTICAL CONTROL POINT "0C90 21W6", BEING A RIVET PLATE IN TOP OF HEADWALL ON THE WEST SIDE OF U.S. 95 @ MP 88.70. ELEVATION: 2481.65 (FEET) 756.4077 (METERS)
CITY OF LAS VEGAS VERTICAL CONTROL v.2002 BASED ON NORTH AMERICAN VERTICAL DATUM OF 1988 (NAVD 88).

LEGEND

FIRE ACCESS ROUTE	
FIRE HYDRANT	

FIRE FLOW DATA CALCULATIONS

FIRE FLOW REQUIREMENT IS 3,375 GALLONS PER MINUTE AT 20 PSI RESIDUAL PRESSURE
BASED ON:

SQUARE FOOTAGE (TOTAL):	187,410	SQUARE FEET
LARGEST AREA BETWEEN 4 HR AREA SEPARATION WALLS:	187,410	SQUARE FEET
AREA OF THREE LARGEST SUCCESSIVE FLOORS:	93,705	SQUARE FEET
BUILDING HEIGHT:	94.6	FEET
NUMBER OF STORIES:	6	FLOORS
TYPE OF CONSTRUCTION:	II-A	
OCCUPANCY:	B	
FULL AUTOMATIC FIRE SPRINKLER SYSTEM:	<input checked="" type="checkbox"/> YES <input type="checkbox"/> NO	

REVIEWED BY: DATE: 2/10/07
LAS VEGAS FIRE DEPT.

APPROVED FOR CONSTRUCTION
Las Vegas Valley Water District Date: 03/01/08
PROJECT 112503

SAFETY ALERT
Call Before You Overhead
1-702-593-6111

Avoid cutting underground utility lines. It's costly.
Call before you Dig
1-800-227-2600

Call before you UnderGround
1-702-455-7511
1-702-229-6611
LAS VEGAS AREA COMPUTERIZED TRAFFIC SYSTEM



LAUTH PROPERTY GROUP
7687 E. Bellevue Ave., Suite 900
Englewood, CO 80111
PROJECT: MOB
CONTACT: R. Kelly
TELEPHONE: 720-279-5400
720-279-5341
FAX: 720-279-5341
E-MAIL: RKELLEY@LAUTH.NET
PROJECT NUMBER: 7894
STATE NUMBER:

Kimley-Horn and Associates, Inc.
Engineering, Planning, and Environmental Consultants
2080 East Flamingo Road, Suite 210
Las Vegas, Nevada 89119
Lic. No. (702) 735-4949

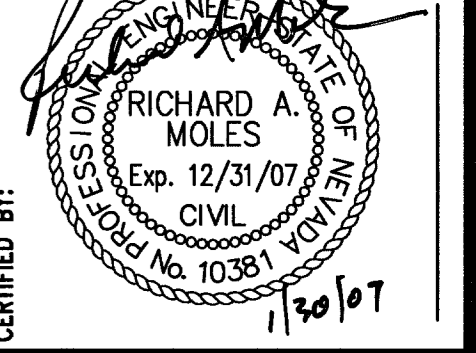

FIRE ACCESS PLAN
PROJECT: MONTECITO POINT Core and Shell
6605 Grand Montecito Parkway
Las Vegas, Nevada 89149

DATE (YYYY-MM-DD)	REVISION	DESCRIPTION
2007-01-08	1	PLAN REVIEW REVISIONS

CONSULTANT: [Signature]
JOB NUMBER: 032461003

DRAWING NO. SHEET 8 OF 21
C4.0
CLV # 107V4839

221062