

TRENCH DETAIL
1-1' x 1-1'

NOTES:
1. BASE AGGREGATE (AS PER MOST SPECIFICATIONS SECTION 504) A MINIMUM OF 18 INCHES TO BE LAID IN MAXIMUM 4\"/>

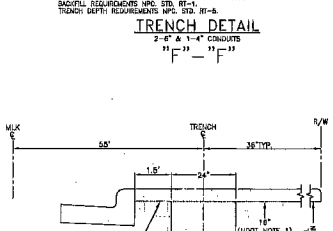

TRENCH DETAIL
2-2' x 1-4'

NOTES:
1. BASE AGGREGATE (AS PER MOST SPECIFICATIONS SECTION 504) A MINIMUM OF 18 INCHES TO BE LAID IN MAXIMUM 4\"/>

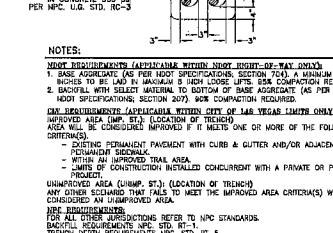

TRENCH DETAIL
3-3' x 1-4'

NOTES:
1. BASE AGGREGATE (AS PER MOST SPECIFICATIONS SECTION 504) A MINIMUM OF 18 INCHES TO BE LAID IN MAXIMUM 4\"/>

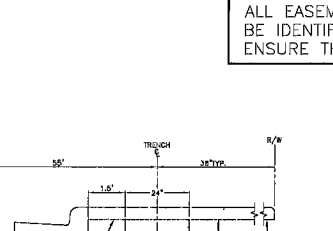

TRENCH DETAIL
4-4' x 1-4'

NOTES:
1. BASE AGGREGATE (AS PER MOST SPECIFICATIONS SECTION 504) A MINIMUM OF 18 INCHES TO BE LAID IN MAXIMUM 4\"/>

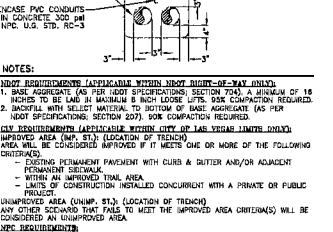

TRENCH DETAIL
5-5' x 1-4'

NOTES:
1. BASE AGGREGATE (AS PER MOST SPECIFICATIONS SECTION 504) A MINIMUM OF 18 INCHES TO BE LAID IN MAXIMUM 4\"/>

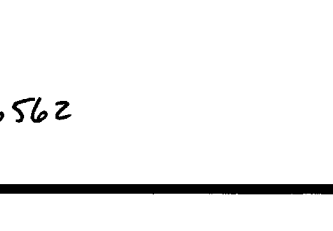

TRENCH DETAIL
6-6' x 1-4'

NOTES:
1. BASE AGGREGATE (AS PER MOST SPECIFICATIONS SECTION 504) A MINIMUM OF 18 INCHES TO BE LAID IN MAXIMUM 4\"/>

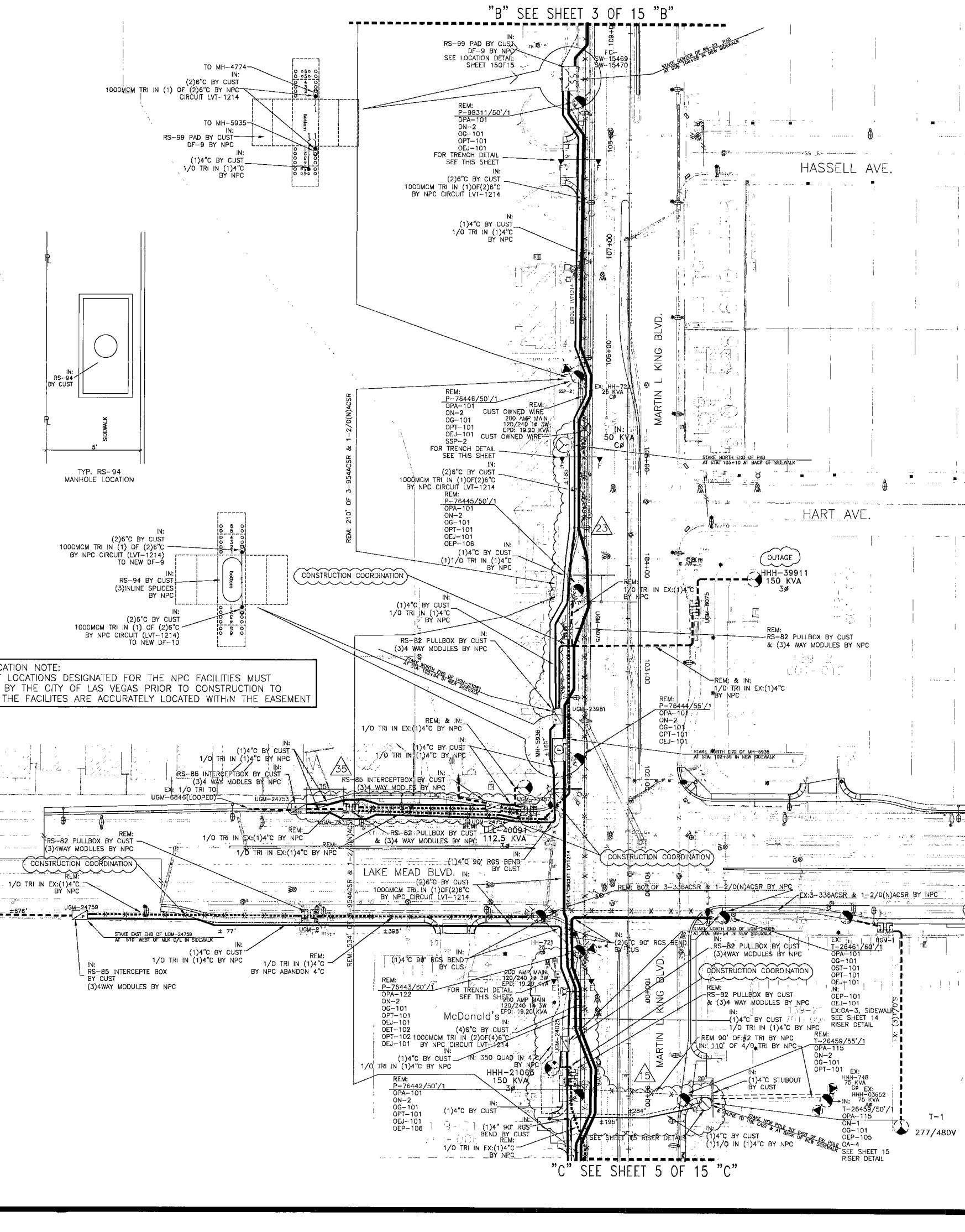

T,R,S: 2061-20
APN: 139

GENERAL NOTES:
ANY NOTES LOCATED IN DRAWING AREA TAKE PRECEDENCE OVER STANDARD NOTES.
ALL WORK SHALL BE ACCOMPLISHED IN STRICT ACCORDANCE WITH THE SPECIFICATIONS SET FORTH IN THE ELECTRIC SERVICE REQUIREMENTS HANDBOOK, AS CURRENTLY ADOPTED BY NPC. THE CONTRACTOR SHALL SECURE COPIES OF THE AFORESAID CONSTRUCTION SPECIFICATIONS ON HIS OR HER OWN BEHALF. REFER TO A CURRENT NEVADA POWER ELECTRIC SERVICE REQUIREMENTS HANDBOOK FOR FURTHER CLARIFICATION OF NPC STANDARDS.
THE APPLICANT SHALL INFORM THE INSPECTOR AT LEAST 48 HOURS BEFORE COMMENCING ANY ITEM OF CONSTRUCTION OR INSTALLATION OF MATERIAL TO ENABLE PROPER INSPECTION OF MATERIALS AND WORKMANSHIP. MAIN TRENCH WORK SHALL BE SCHEDULED 72 HOURS IN ADVANCE OF INSTALLATION. APPLICANT'S PROJECT WILL NOT BE SCHEDULED UNTIL FINAL APPROVAL FROM NPC UNDERGROUND & ELECTRICAL INSPECTORS. STAKES ARE NOT TO SCALE AND DO NOT NECESSARILY REPRESENT ACTUAL LOCATIONS OF FACILITIES.
THIS DRAWING ILLUSTRATES DATA COLLECTED FROM VARIOUS SOURCES AND MAY NOT REPRESENT A SURVEY OF THE PREMISES. APPLICANT SHALL FIELD DETERMINE POSITION AND DEPTH OF EXISTING UTILITY EQUIPMENT PRIOR TO COMMENCING CONSTRUCTION. USE CAUTION PRIOR TO EXCAVATION. CHECK TO ENSURE ADDITIONAL DEPTH IS NOT REQUIRED TO ACCOMMODATE GAS AND/OR WATER FACILITIES AND DRAINAGE CHANNELS.
CALL NEVADA POWER UNDERGROUND INSPECTORS 48 HOURS PRIOR TO START OF CONSTRUCTION FOR TRENCH INSPECTION BEFORE COVERING TRENCH.
ALL NPC CABLE TO BE INSTALLED BEHIND CURB, UNLESS OTHERWISE NOTED.
APPLICANT IS RESPONSIBLE FOR STAKING OF PROPERTY CORNERS & ELEVATIONS.
ALL HANDHOLES AND PULLBOXES SHALL BE INSTALLED TO FINISHED GRADE OR 6\"/>

COMMERCIAL NPC WORK AND SERVICES TO CONSIST OF:
1/0 TRIPLEX 15 KV AL PRIMARY CABLE IN 4\"/>

APPLICANT TO FURNISH AND INSTALL:
ALL TRENCHING & BACKFILL, MEETING APPLICABLE NPC STANDARD (R-7 OR R-12).
4\"/>

CITY OF LAS VEGAS PERMIT REQUIRED*
CONTACT CLV LAND DEVELOPMENT (229-6371)
CLV CONSTRUCTION SERVICES MUST BE NOTIFIED 24 HOURS PRIOR TO COMMENCING CONSTRUCTION (229-6337)
*NPC INSPECTOR MUST BE NOTIFIED BY FAX 48 HOURS PRIOR TO COMMENCING CONSTRUCTION & WILL VERIFY CITY PERMIT FOR WORK DONE IN STREETS OR SIDEWALK.
LAS VEGAS NORTH: 857-4354
LAS VEGAS SOUTH (HENDERSON): 538-4740
LAS VEGAS SOUTH (SPRING VALLEY): 252-4828

CIVIL LINETYPE LEGEND

	PROPOSED	EXISTING
CENTERLINE	---	---
PROPERTY LINE/ROW	---	---
CURB	---	---
EDGE OF PAVEMENT	---	---
EDGE OF SIDEWALK	---	---
SEWER LINE	---	---
WATER LINE	---	---
GAS LINE	---	---
TELEPHONE LINE	---	---
CABLE TV LINE	---	---
STORM DRAIN LINE	---	---
FIRE HYDRANT	---	---
STREET LIGHT	---	---
STREET LIGHT SERVICE	---	---

* LINETYPES UTILIZED WHERE CONFLICT OCCURS WITH NPC FACILITIES.

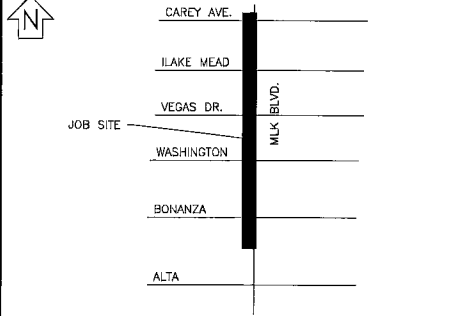

VICINITY MAP (NOT TO SCALE)
EVERY EFFORT HAS BEEN MADE TO IDENTIFY ALL NPC FACILITIES. THE CUSTOMER SHALL CONFIRM THE EXISTENCE AND LOCATION OF THESE FACILITIES.

AVOID HITTING OVERHEAD POWER LINES. IT'S COSTLY.
CALL BEFORE YOU DO OVERHEAD

AVOID CUTTING UNDERGROUND UTILITY LINES. IT'S COSTLY.
Call before you Dig.

CALL 1-702-227-2929 1-800-227-2600 UNDERGROUND SERVICE (USA)

REVISIONS

NO.	DESCRIPTION	DATE	G.A.
6	NEED TEMP STEEL POLE FOR O.H. TO U.G. CONVERSION	10/5/07	
7	NEW CITY SERVICES	10/20/07	
8	CLV REQUEST NO U.G. AT BONANZA WALL	10/20/07	
9	CONDUCT RELOCATING NPC FACILITIES TO VARIOUS LOCATIONS	11/6/07	
10	MOVE NPC FACILITIES TO 139-28 304-005 DRIVE WAY TO BE NORTH OF PROPERTY PER CITY	12/5/07	
11	MOVES SOME NPC FACILITIES DUE TO EASEMENTS LOCATIONS	1/2/08	
12	CHANGED RS-99 NOTE TO RS-101 SHEET 12	2/13/08	
13	MISSING FEED TO UGM-25855 & EX: CCG-170N & HHH-1970BF & MOVED NEW XFMR 10' SOUTH	4/22/08	
14	PER TERRY(CLV) NO ADDITIONAL 3' BUFFER NEED AT NEW XFMR AND SWITCH PAD LOCATION	4/2/08	
15	SHOW EX: XFMR RE-READ AT PAIR	4/28/08	

TYPE OF EASEMENT:

AERIAL STANDARD	<input type="checkbox"/>	JPA NOTES:
R/W-31 UNDERGROUND	<input type="checkbox"/>	SPRINT CONTACT: LEN B.
AS BUILT UNDERGROUND	<input type="checkbox"/>	PHONE NUMBER: 244-7839
R.O.E./R/W-5-COM	<input type="checkbox"/>	DATE OF CONTACT: 5/23/07
3rd PARTY UNDERGROUND BY EXHIBIT (N-DOT) PERMIT	<input type="checkbox"/>	NPC TO SET NEW POLES
BLM PERMIT	<input type="checkbox"/>	NPC TO STAKE NEW POLES
RAILROAD-UPRR-PERMIT	<input type="checkbox"/>	TO PROVIDE POLES
SD, NEVADA WATER PERMIT	<input type="checkbox"/>	FT. CLASS
NOT REQUIRED	<input type="checkbox"/>	FT. CLASS
Misc. Info.	<input type="checkbox"/>	NPC TO DIG POLE HOLES
	<input type="checkbox"/>	SPRINT TO REMOVE EX. POLES
	<input type="checkbox"/>	NPC TO RELOCATE POLE FROM CAREY TO ALTA
	<input type="checkbox"/>	JPA#: P200700125

NPC INFORMATION:
COORDINATOR: PRISCILLA LAUDENBUSH
PHONE: 657-4349
DESIGNER: DOUG GIBSON
DCA: N/A
INSPECTOR: 378-3712
SCHEDULING: 402-4117, 402-4116, 402-4118

CUSTOMER INFORMATION:
APPLICANT: CITY OF LAS VEGAS
ENGINEER: VTN
CONTACT:
APPROVAL DATE: 04-04-2007

NEVADA POWER COMPANY

MARTIN LUTHER KING WIDENING O.H. TO U.G.

107V4655.Awr

PROJ. ID: 176093 SCALE: 1" = 50'
SHEET #: 4 OF 15 DATE: 1/4/07

15-REVISION(S)

116562