

CONSTRUCTION NOTES:

- 1 LOCATE ALL UNDERGROUND UTILITIES BEFORE DIGGING. 1-800-227-2600
- 2 INSTALL PULL BOXES AT EXISTING FINISH GRADE.
- 3 MAINTAIN 18" MINIMUM COVER OVER DUCT IN DIRT BEHIND SIDEWALK. MAINTAIN 24" MINIMUM COVER OVER DUCT UNDER PROPOSED SIDEWALK. MAINTAIN 36" MINIMUM COVER OVER DUCT UNDER STREET.
- 4 COMPACT BACKFILL IN THE STREET TO 95% AND COMPLY TO ALL CITY OF LAS VEGAS, COUNTY STANDARDS.
- 5 PULL BOX - 15-3/4" x 25-1/4" x 12" OR 22-1/4" x 35-1/4" x 12"
- 6 CONDUIT - PVC SCHEDULE 40
- 7 REMOVE ONE SECTION OF SIDEWALK WHERE REQUIRED.
- 8 PLACE TV PEDESTAL AT LOCATION SHOWN, TV-2400, CPH-1230, 1730 OR 2000 AS NOTED.
- 9 REPLACE SIDEWALK AT EXISTING FINISH GRADE WHERE REQUIRED.
- 10 BORE UNDER ALL CROSS CUTTERS.
- 11 ALL LONGITUDINAL CUTS SHALL BE PER ESTABLISHED RTC GUIDELINES

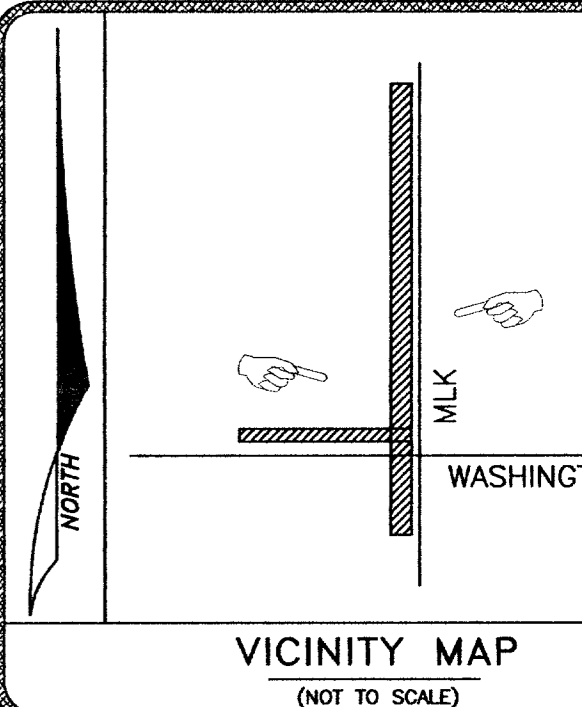

LEGEND:

- R&R SLAB OR POTHOLE
 - ▣ EXISTING B-36 PULL BOX (17'x30'x24')
 - PROPOSED B-36 PULL BOX (17'x30'x24')
 - ▤ EXISTING T-200 CATV VAULT (30"x48"x36")
 - ▥ PROPOSED T-200 CATV VAULT (30"x48"x36")
 - ▧ EXISTING T-400 CATV VAULT (36"x60"x36")
 - ▨ PROPOSED T-400 CATV VAULT (36"x60"x36")
 - ▩ EXISTING T-600 CATV VAULT (RS) (36"x84"x48")
 - PROPOSED T-600 CATV VAULT (RS) (36"x84"x48")
 - △ EXISTING PEDESTAL
 - ▲ PROPOSED PEDESTAL
 - C-C- PROPOSED CONDUIT TRENCH
 - X-X- EXISTING CONDUIT
 - B-B- PROPOSED BORE
 - - - RIGHT-OF-WAY OR PROPERTY LINE
 - BACK OF CURB OR CURB FACE
 - ⊕ INTERSECTING CENTERLINE
- *OTHER ITEMS WILL BE CALLED OUT

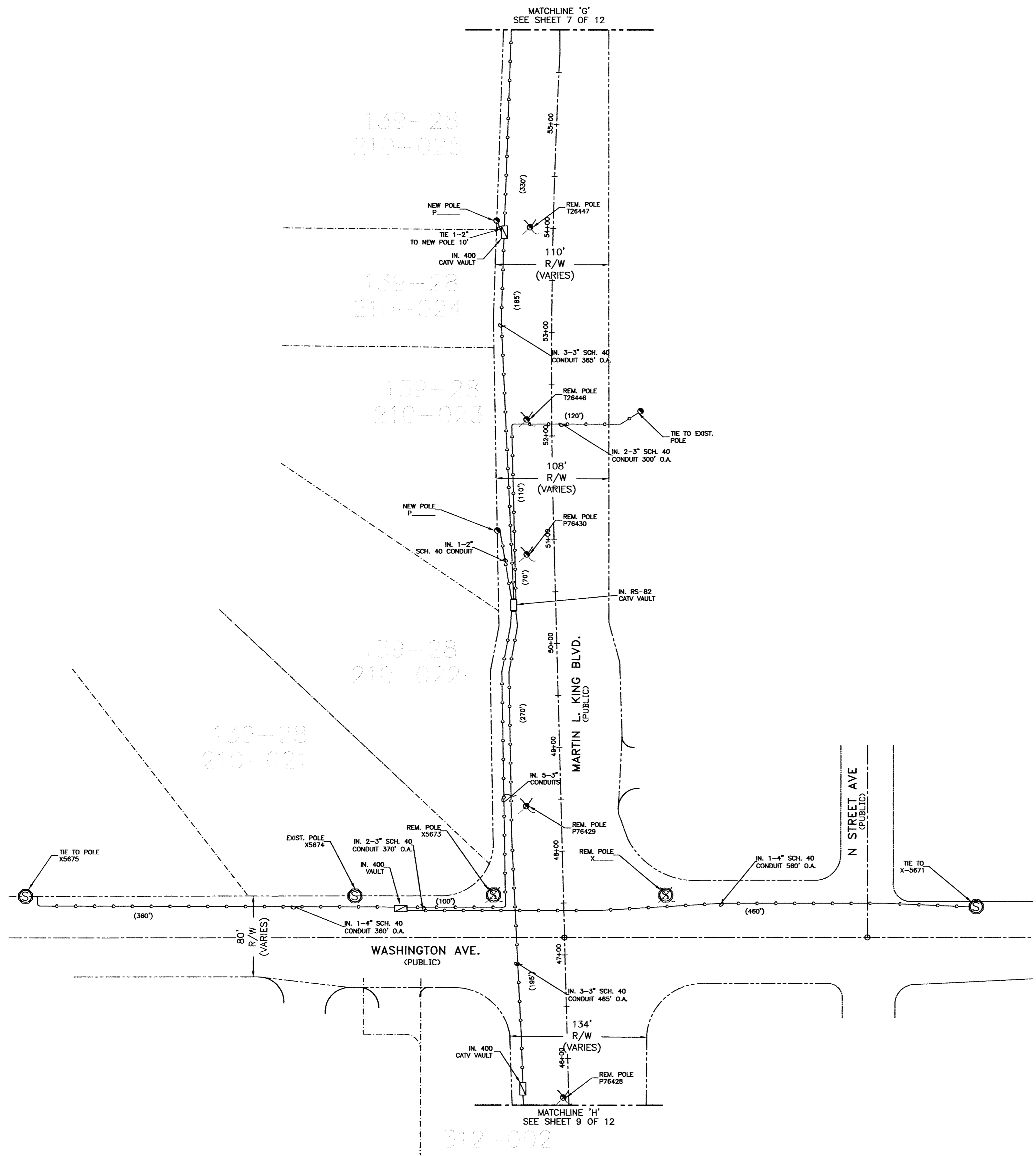
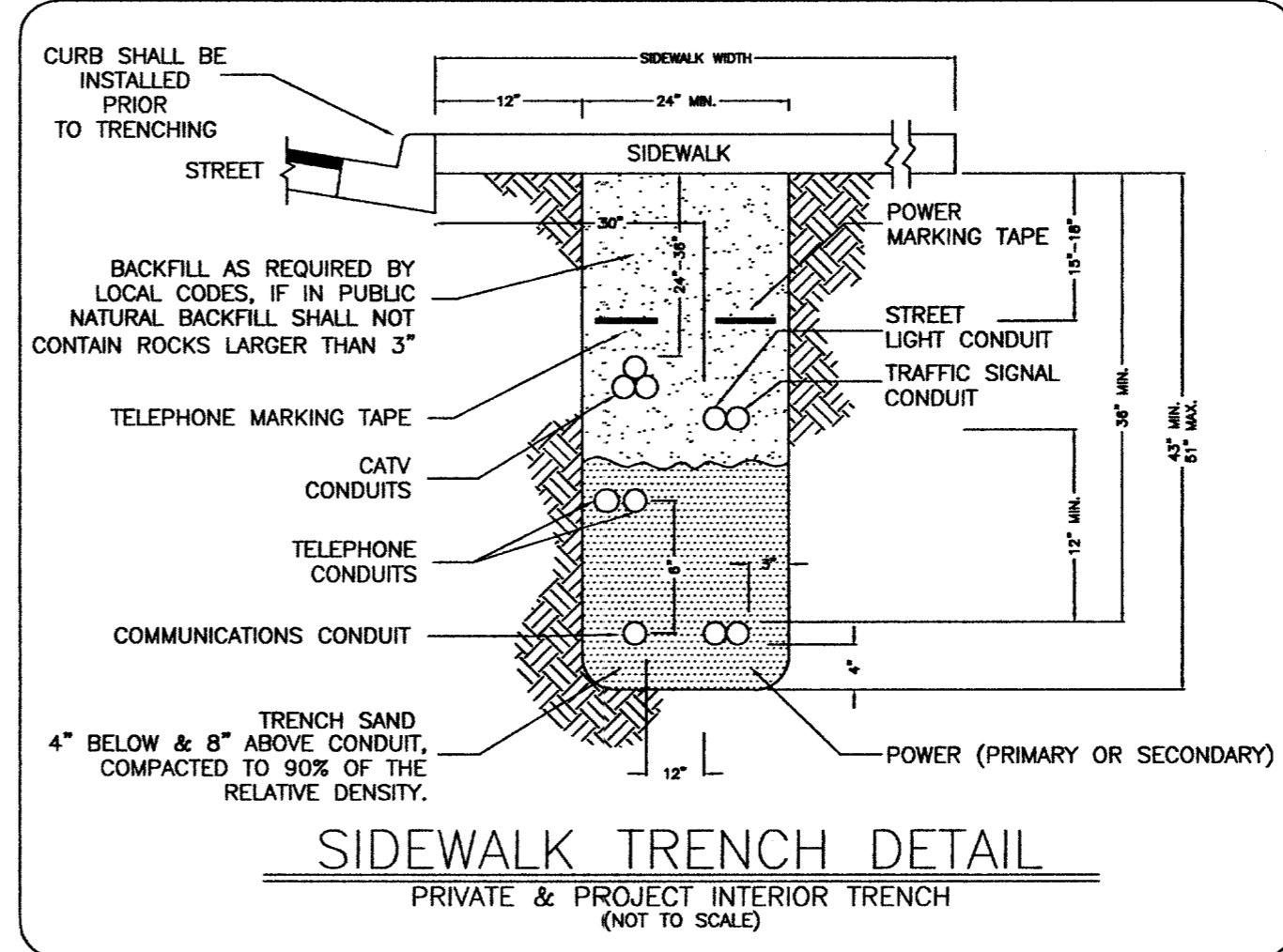

NOTE
EXISTING UTILITY LOCATIONS SHOWN HEREIN ARE APPROXIMATE ONLY. IT SHALL BE THE CONTRACTOR'S RESPONSIBILITY TO DETERMINE THE EXACT VERTICAL AND HORIZONTAL LOCATION OF ALL EXISTING UNDERGROUND UTILITIES PRIOR TO COMMENCING CONSTRUCTION. NO REPRESENTATION IS MADE THAT ALL EXISTING UTILITIES ARE SHOWN HEREON. THE ENGINEER ASSUMES NO RESPONSIBILITY FOR UTILITIES NOT SHOWN OR UTILITIES NOT SHOWN IN THEIR PROPER LOCATION.

Approved for Construction
THIS APPROVAL IS FOR WORK IN CLV R/W OR CLV EASEMENTS ONLY. OBTAINING PERMISSIONS OR EASEMENTS FOR WORK SHOWN ON PRIVATE PROPERTY IS THE RESPONSIBILITY OF THE UTILITY.

APPROVAL _____ DATE _____

CONTACT: COX COMMUNICATIONS
GENE SIEGEL (702) 545-1677
(702) 210-7024 CELL

SHEET 8 OF

PROJECT LOCATION/DESCRIPTION:
MLK & CAREY ~ DISCOVERY

AREA:
CITY OF LAS VEGAS

SCALE: 1:60

DATE: 06/01/07 BY: H-G

TECH.# 509

F.B.#

APPROVED BY:
GENE SIEGEL

DATE: 06/01/07

BY: H-G

REVISIONS:
10/08/07 HG UPDATED ROUTE 187V4655-COX 4

CONTRACTOR:
COX COMMUNICATIONS

Avoid cutting underground utility lines. It's costly.
Call before you Dig.
1-800-227-2600
UNDERGROUND SERVICE ALERT (USA)