

**22 Flood Curb Detail**  
Not to Scale

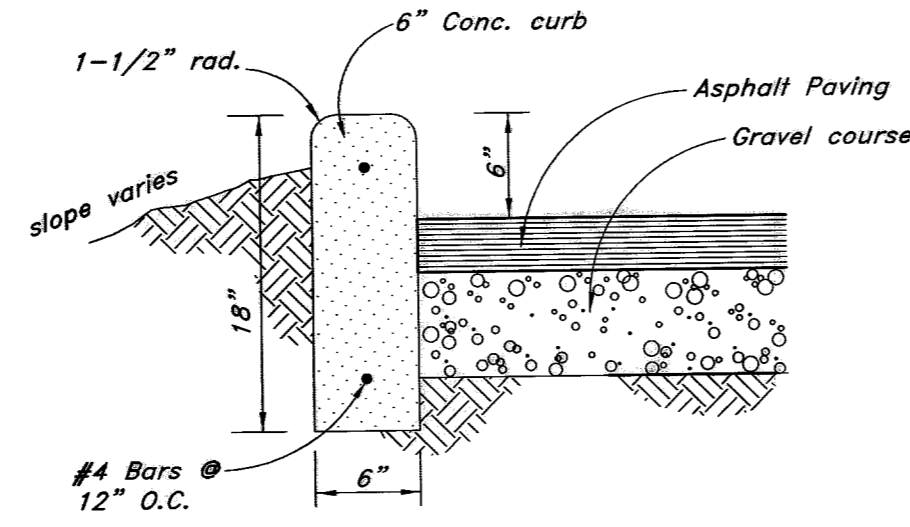

**20 Typical Curb Wall Detail**  
Not to Scale

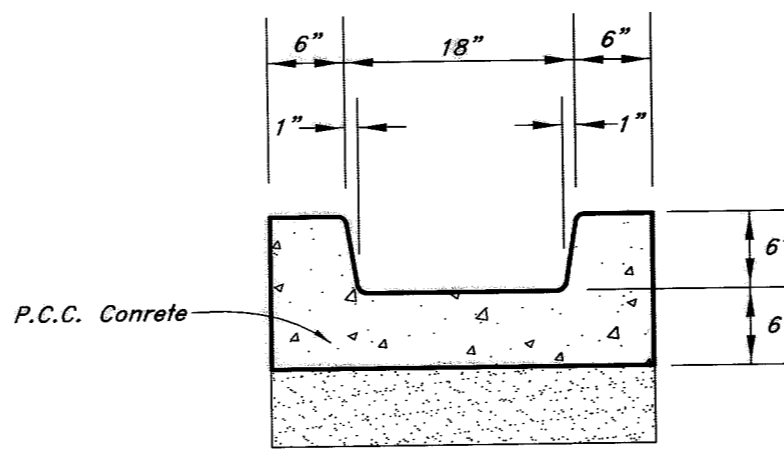

**17 Drainage Channel Detail**  
Not to Scale

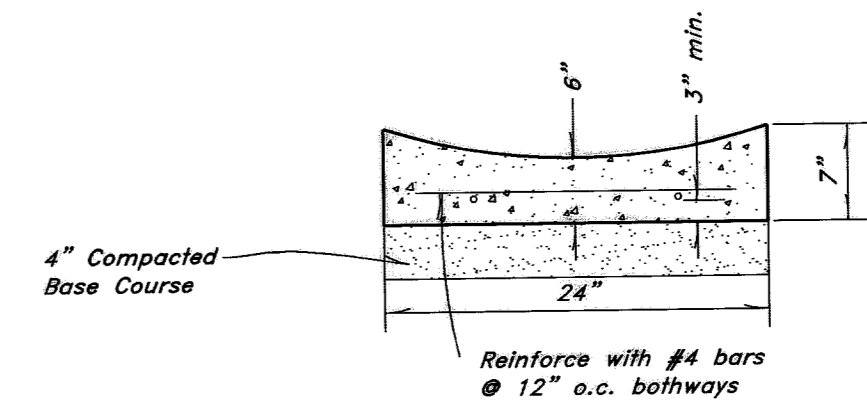

**13 Typical Waterway Detail**  
Not to Scale

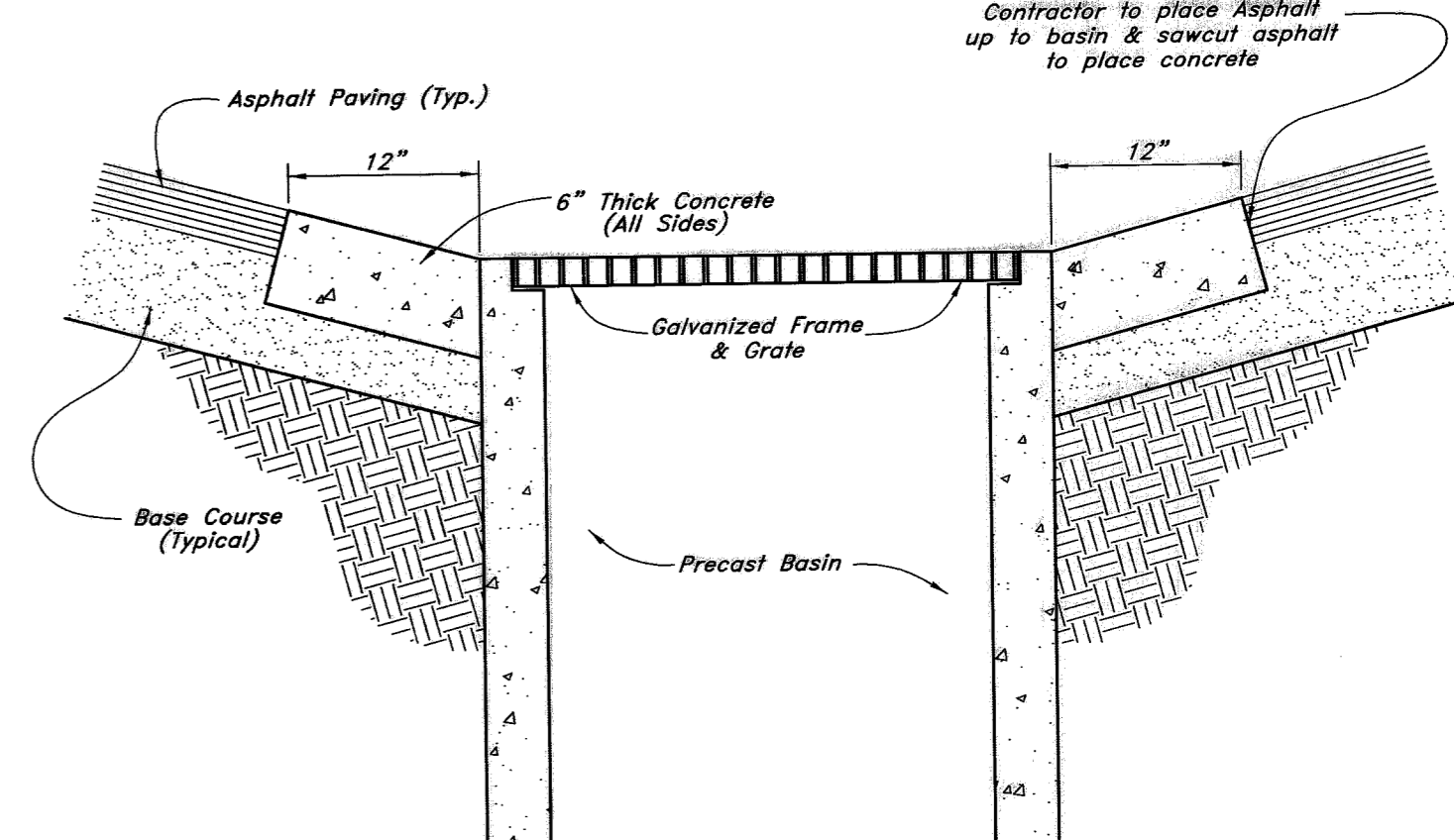

**12 12" Concrete Collar**  
Not to Scale

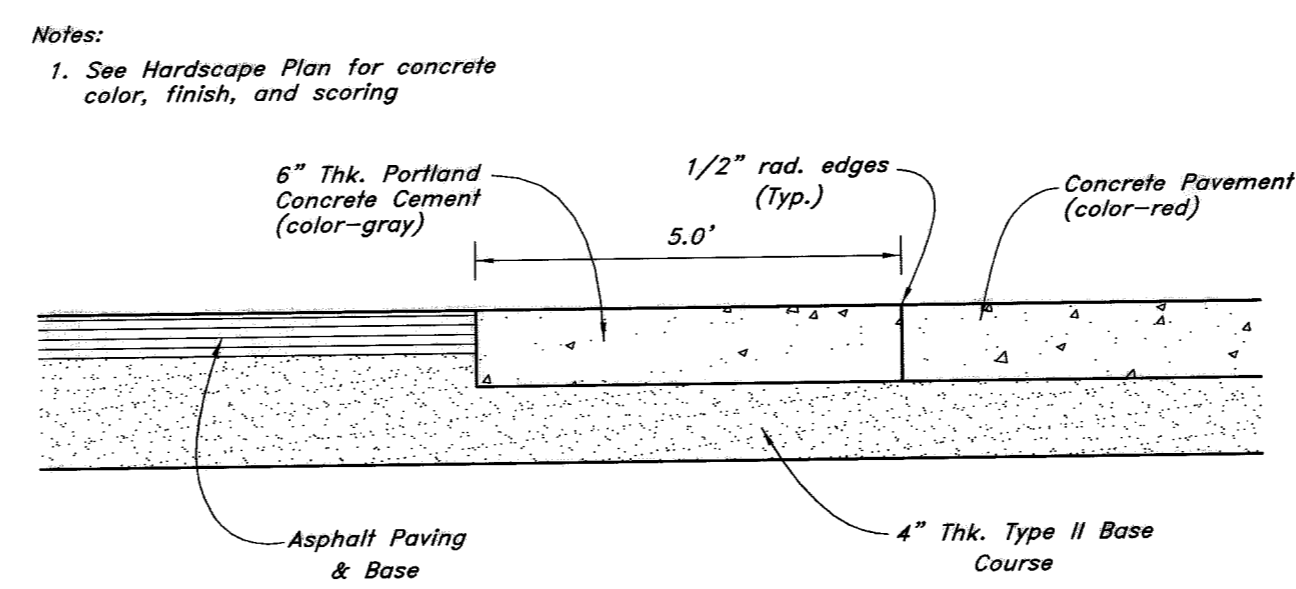

**16 Concrete Pavement Band**  
Not to Scale

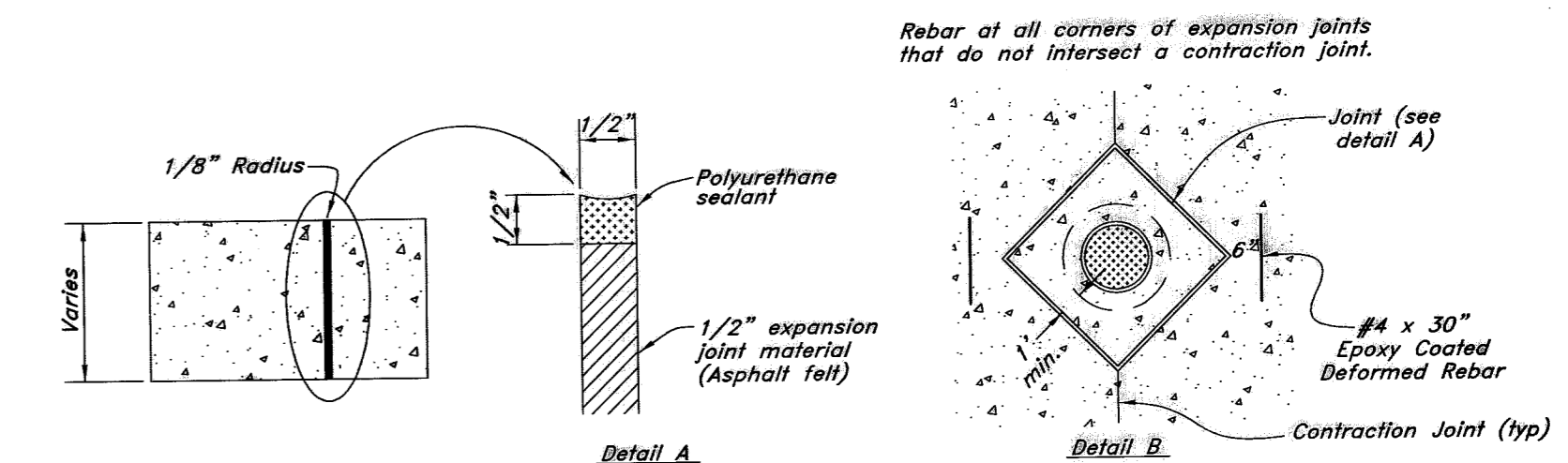

**11 Expansion Joint**  
Not to Scale

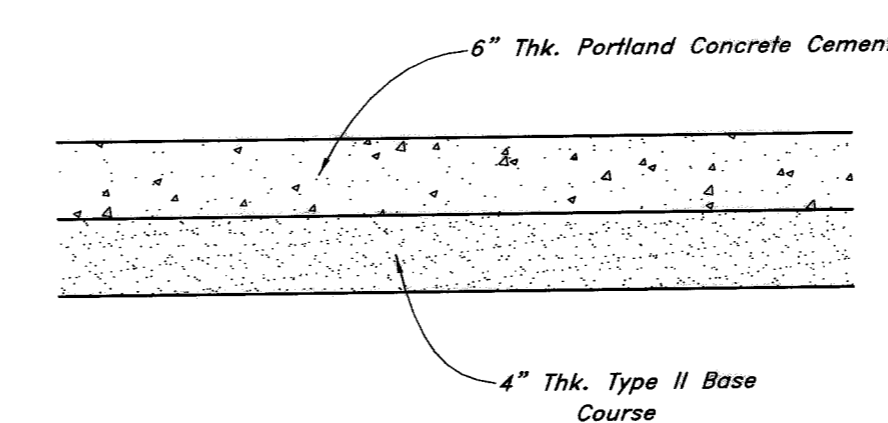

**15 Concrete Pavement Detail**  
Not to Scale

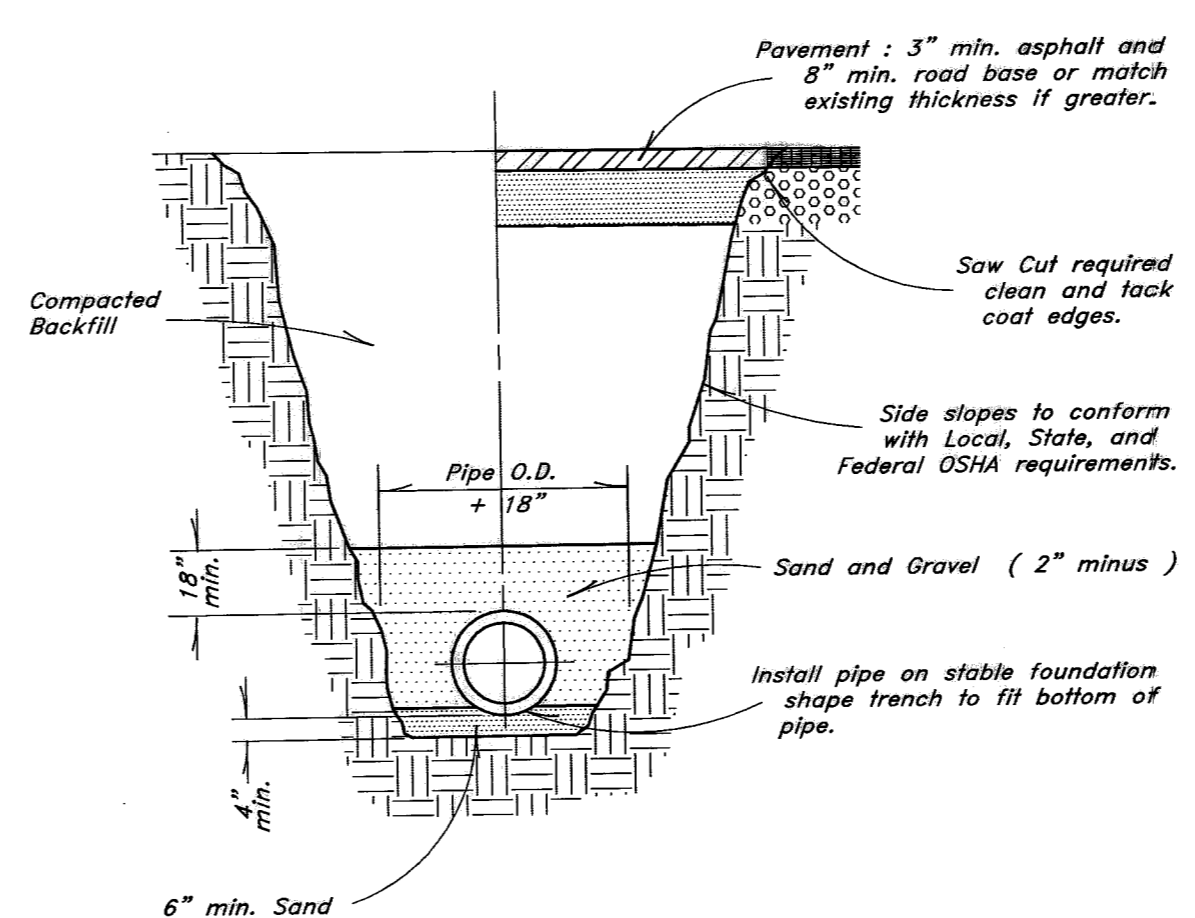

**14 Typical Trench Detail**  
Not to Scale

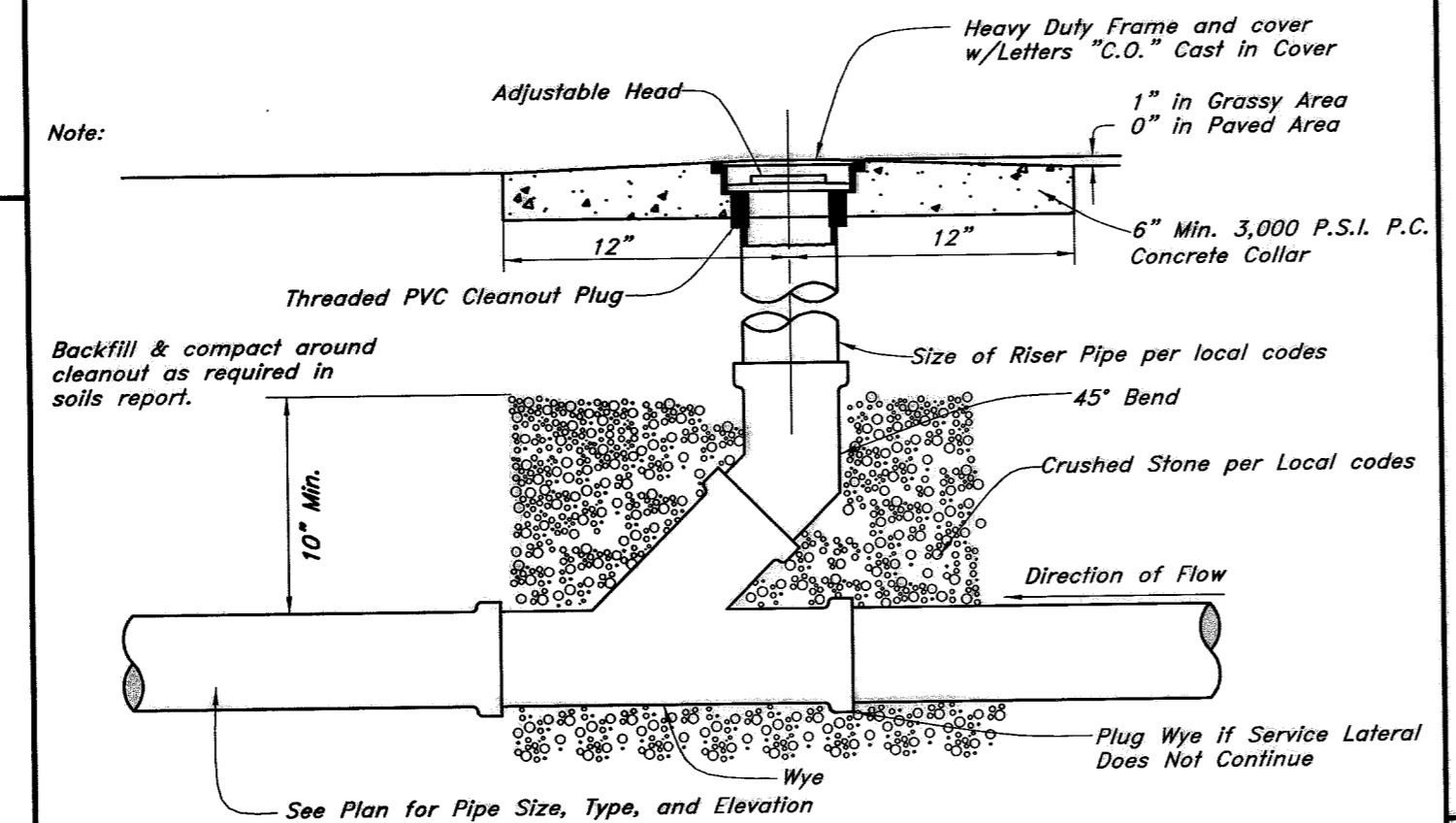

**19 Cleanout Detail**  
Not to Scale

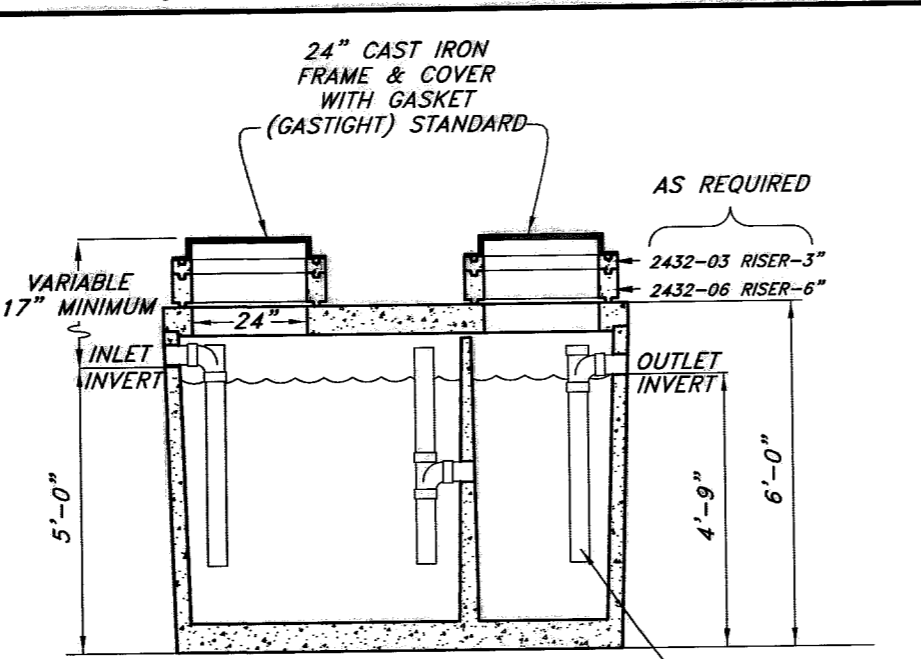

**18 750 Gallon Grease Interceptor**  
Not to Scale

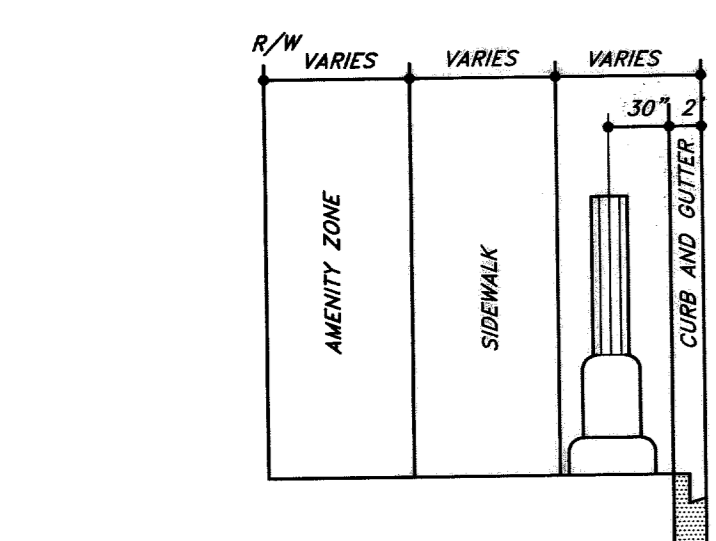

- NOTES:
1. PROVIDE (1) IN-LINE TWO POLE FUSEHOLDER WITH 10A FUSES PER POLE LOCATED AT THE HANDHOLE.
  2. WIRING TO LUMINAIRES SHALL INCLUDE GROUND.
  3. 2" CONDUIT WITH 2-#4, 1-#3 THW WIRE (TYP.).
  4. COORDINATE ALL WORK WITH CLV ELECTRICAL SHOP PHONE # 229-6331.

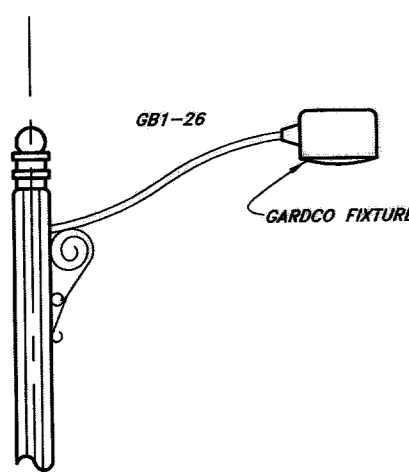

**STREETLIGHT-SINGLE ARM**

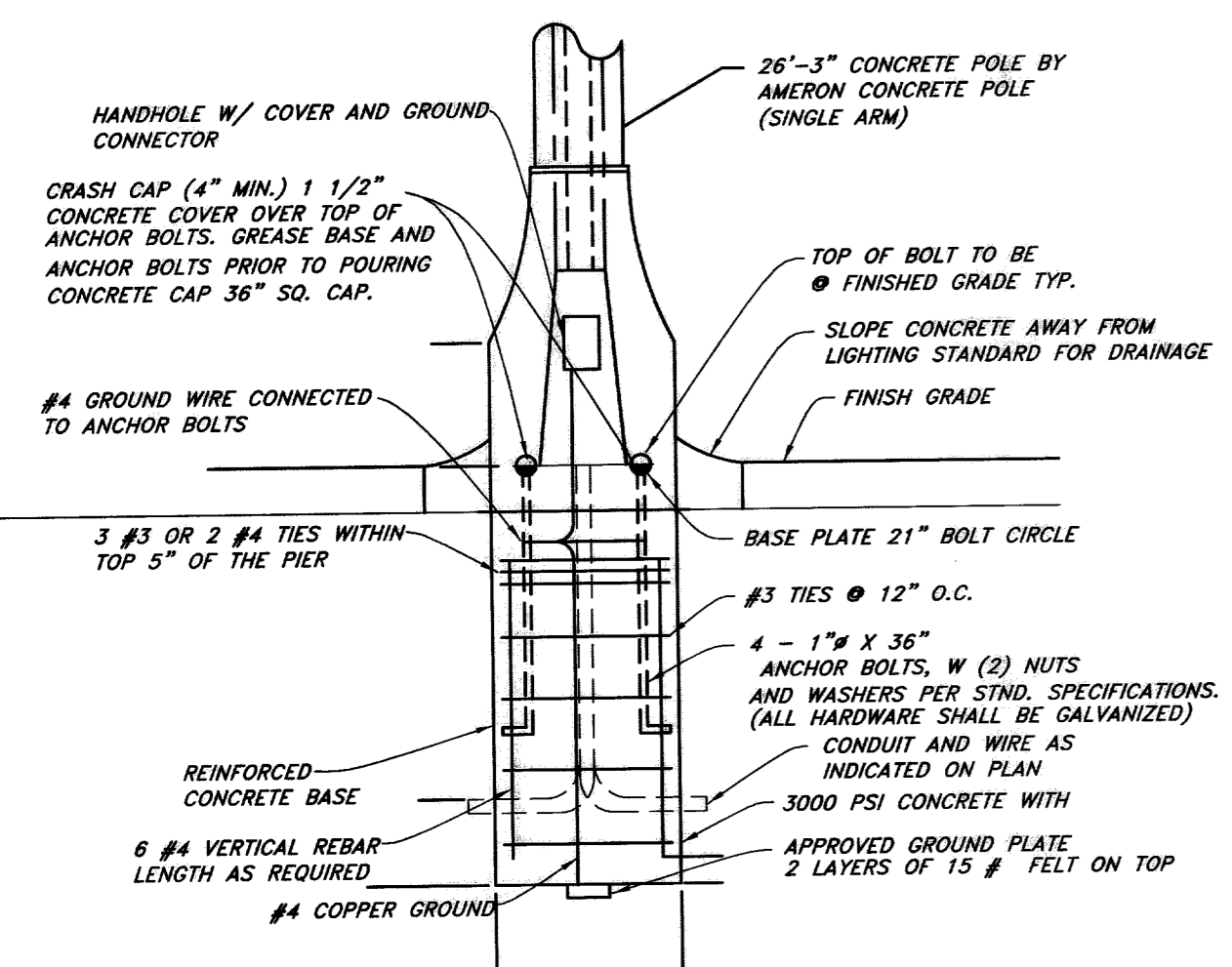

**21 Street Light Pole Detail**  
Not to Scale

**GREAT BASIN ENGINEERING - SOUTH**  
CONSULTING ENGINEERS and LAND SURVEYORS  
2010 North Redwood Road, P.O. Box 16747  
Salt Lake City, Utah 84116  
Phone: (801)394-7888 Fax: (801)321-8851

**Montecito Marketplace - Phase 1**  
SE Corner of Durango Drive & Elkhorn Road  
Las Vegas, Nevada

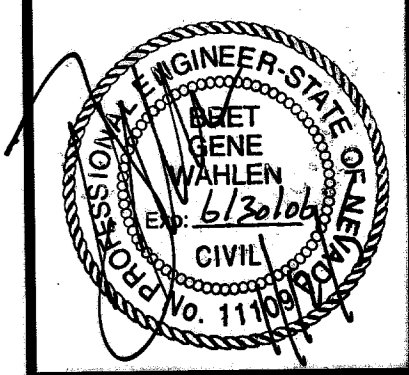

11 Jan, 2005  
SHEET NO. **17** of 24  
SMC3320T  
107V4300