

Jones Boulevard (Elkhorn Rd to Horse Dr) and Grand Teton Drive (Maverick St to Decatur Blvd) Special Improvement District No. 1507

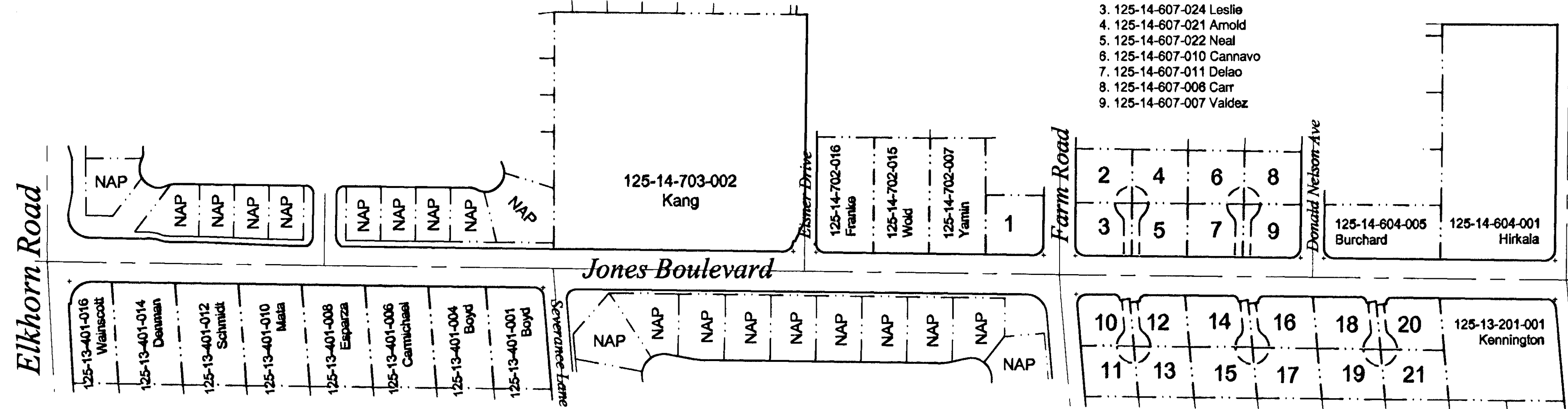
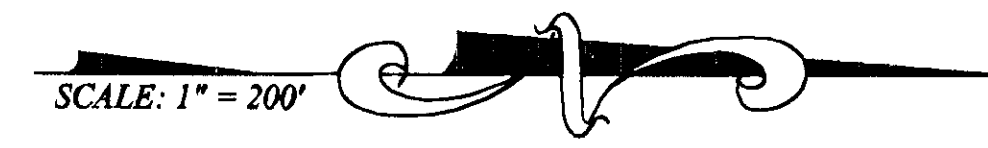
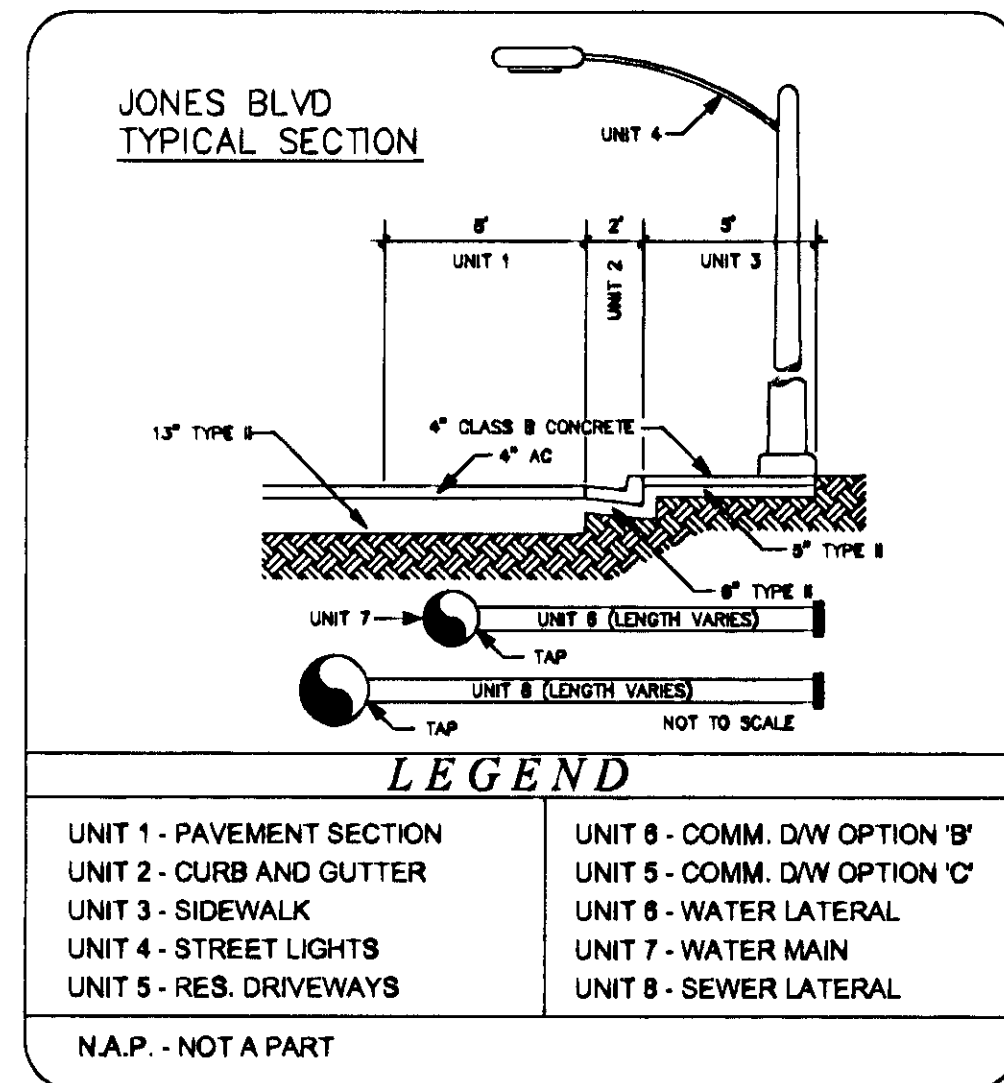

1. 125-14-702-008 Williams
2. 125-14-607-023 Picotte
3. 125-14-607-024 Leslie
4. 125-14-607-021 Arnold
5. 125-14-607-022 Neal
6. 125-14-607-010 Cannavo
7. 125-14-607-011 Delao
8. 125-14-607-008 Carr
9. 125-14-607-007 Valdez

10. 125-13-201-024 Black
11. 125-13-201-025 Aultman
12. 125-13-201-022 Wittwer
13. 125-13-201-023 Evans
14. 125-13-201-018 Brown
15. 125-13-201-017 Sims-Weaver
16. 125-13-201-014 Silveryra
17. 125-13-201-015 Blouin
18. 125-13-201-008 Hoeft
19. 125-13-201-009 Eruchalu
20. 125-13-201-006 Maupin
21. 125-13-201-007 Micell

UNITS	125-13-201-001	125-13-201-006	125-13-201-007	125-13-201-008	125-13-201-009	125-13-201-014	125-13-201-015	125-13-201-016	125-13-201-017	125-13-202-022	125-13-202-023	125-13-202-024	125-13-202-025	125-13-401-001	125-13-401-004	125-13-401-008	125-13-401-008	125-13-401-010	125-13-401-012	125-13-401-014	125-13-401-016	125-14-604-001	125-14-604-005	125-14-607-008	125-14-607-007	125-14-607-010	125-14-607-011	125-14-607-022	125-14-607-021	125-14-607-023	125-14-607-024	125-14-702-008	125-14-702-007	125-14-702-015	125-14-702-016	125-14-703-002					
UNIT 1 - 8" PAVEMENT SECTION	298'	328'	328'	288'	149'	149'	164'	164'	164'	164'	164'	164'	114'	323'	323'	298'		295'	146'	146'	146'	146'	828'																		
UNIT 2 - CURB AND GUTTER	298'	248'	248'	208'	149'	149'	164'	164'	164'	164'	164'	164'	114'	323'	323'	248'		244'	146'	146'	146'	146'	828'																		
UNIT 3 - SIDEWALK	298'	248'	248'	208'	149'	149'	137'	109'	118'	117'	120'	94'	323'	323'	248'		39'	183'	114'	148'	90'	148'	828'																		
UNIT 4 - STREETLIGHTS	298'	328'	328'	288'	149'	149'	164'	164'	164'	164'	164'	164'	114'	323'	323'	298'		295'	146'	146'	146'	146'	828'																		
UNIT 5 - RES. DRIVEWAYS																27'	25'	24'	24'	20'																					
UNIT 5 - COMM. D/W OPTION 'B'		908 SF	908 SF	908 SF																																					
UNIT 5 - COMM. D/W OPTION 'C'																																									
UNIT 6 - WATER LATERALS																																									
UNIT 7 - WATER MAIN																																									
UNIT 8 - SEWER LATERALS	68'-8"															69'-8"	69'-8"	69'-8"	69'-8"	69'-8"	69'-8"	69'-8"	69'-8"	69'-8"	69'-8"	69'-8"	69'-8"	69'-8"	69'-8"	69'-8"	69'-8"	69'-8"	69'-8"	69'-8"	69'-8"	69'-8"	69'-8"	69'-8"	69'-8"	69'-8"	

FINAL ASSESSMENT MAP
REFERENCE FINAL ASSESSMENT ROLL
INST: 2012032202439 DATE: 01-22-12

Scale (N)	1"=200'	Scale (V)	Not to Scale	W.A.	
File. bk. no.		Date:	10/10/2005	Drawn by:	TPM
Design by:		Approved by:		Date:	
Revisions					
Date					

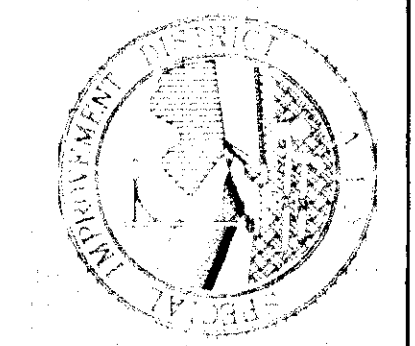

Department of Public Works

Jones / Grand Teton
Elkhorn Rd to Horse Dr and
Maverick St to Decatur Blvd

SPECIAL IMPROVEMENT DISTRICT 1507

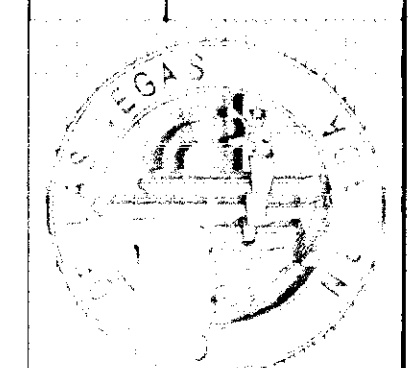

2012

SDD 1507

Jones Boulevard (Elkhorn Rd to Horse Dr) and Grand Teton Drive (Maverick St to Decatur Blvd) Special Improvement District No. 1507

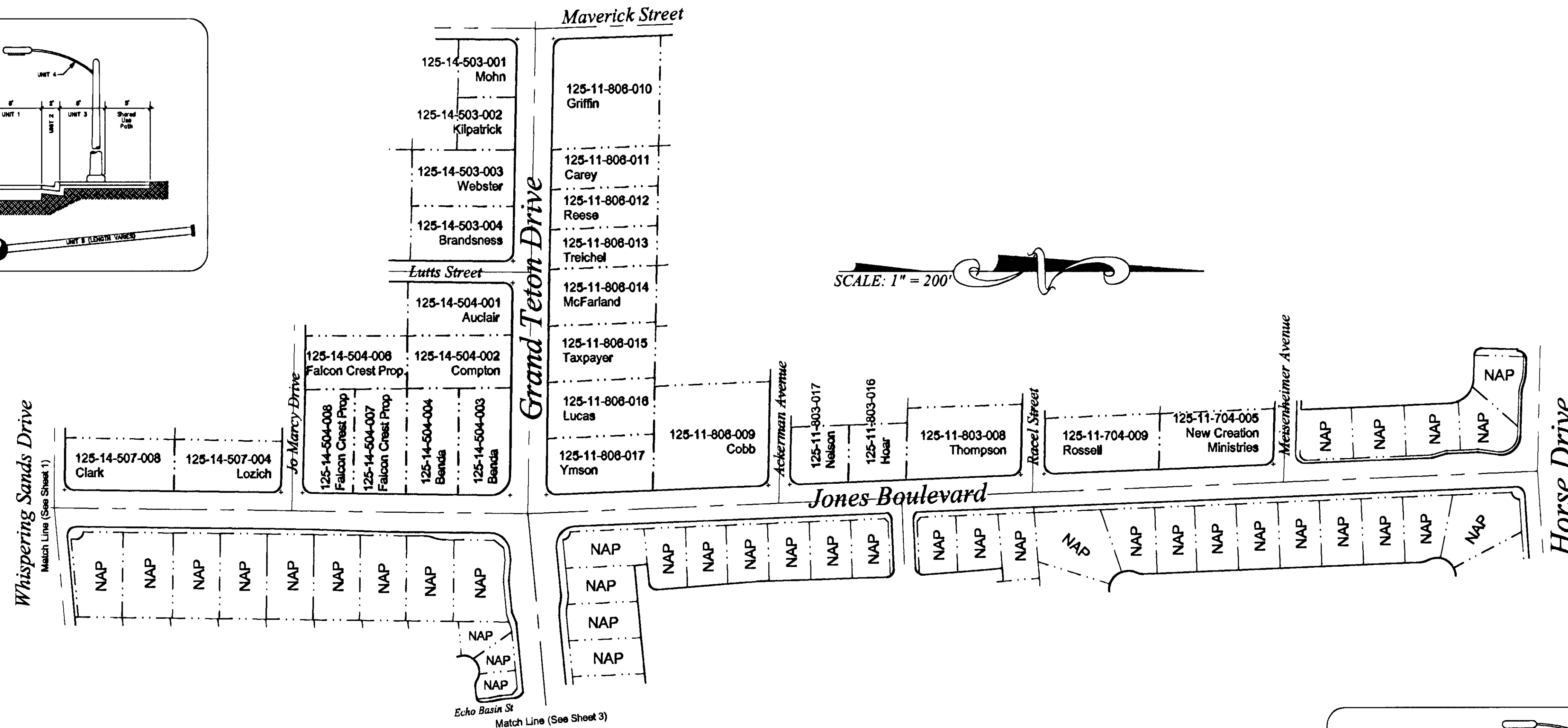
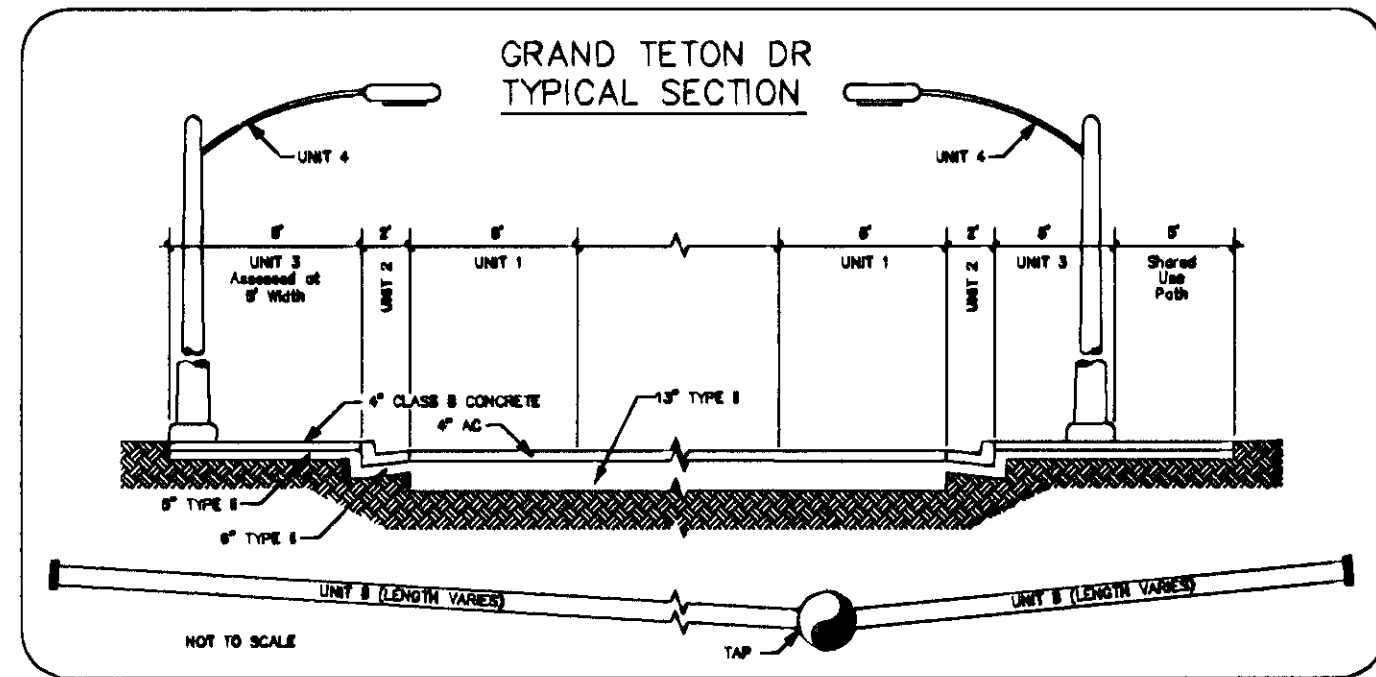

UNITS	125-11-704-005	125-11-704-009	125-11-803-008	125-14-803-016	125-11-803-017	125-11-806-009	125-11-806-010	125-11-806-011	125-11-806-012	125-11-806-013	125-11-806-014	125-11-806-015	125-11-806-016	125-11-806-017	125-14-503-001	125-14-503-002	125-14-503-003	125-14-503-004	125-14-504-001	125-14-504-002	125-14-504-003	125-14-504-004	125-14-504-005	125-14-504-006	125-14-504-007	125-14-504-008	125-14-507-004	
UNIT 1 - 8" PAVEMENT SECTION	160'	160'	160'	160'	319'	304'	111'	111'	111'	155'	155'	155'	288'	160'	145'	152'	153'	147'	147'	292'	144'	288'	149'	149'				
UNIT 2 - CURB AND GUTTER	160'	160'	160'	160'	319'	304'	111'	111'	111'	155'	155'	155'	288'	160'	145'	152'	153'	147'	147'	292'	144'	288'	149'	149'				
UNIT 3 - SIDEWALK	160'	160'	131'	98'	136'	263'	272'	69'	63'	111'	71'	83'	83'	288'	118'	91'	64'	127'	111'	103'	241'	98'	288'	149'	149'			
UNIT 4 - STREETLIGHTS	160'	160'	160'	160'	319'	304'	111'	111'	111'	155'	155'	155'	288'	160'	145'	152'	153'	147'	147'	292'	144'	288'	149'	149'				
UNIT 5 - RES. DRIVEWAYS			29'	35'	24'	28'	32'	42'	48'		24'	36'	24'		22'	32'	54'	28'	36'	20'	23'	23'						
UNIT 5 - COMM. D/W OPTION "B"																												
UNIT 5 - COMM. D/W OPTION "C"																												
UNIT 6 - WATER LATERALS							31'-6"																					
UNIT 7 - WATER MAIN							34'-12"																102'-0"					
UNIT 8 - SEWER LATERALS	48'-6"	47'-6"	47'-6"	48'-6"	52'-6"	30'-6"			30'-6"		30'-6"	30'-6"			82'-6"	82'-6"	86'-6"			41'-6"	48'-6"						45'-6"	

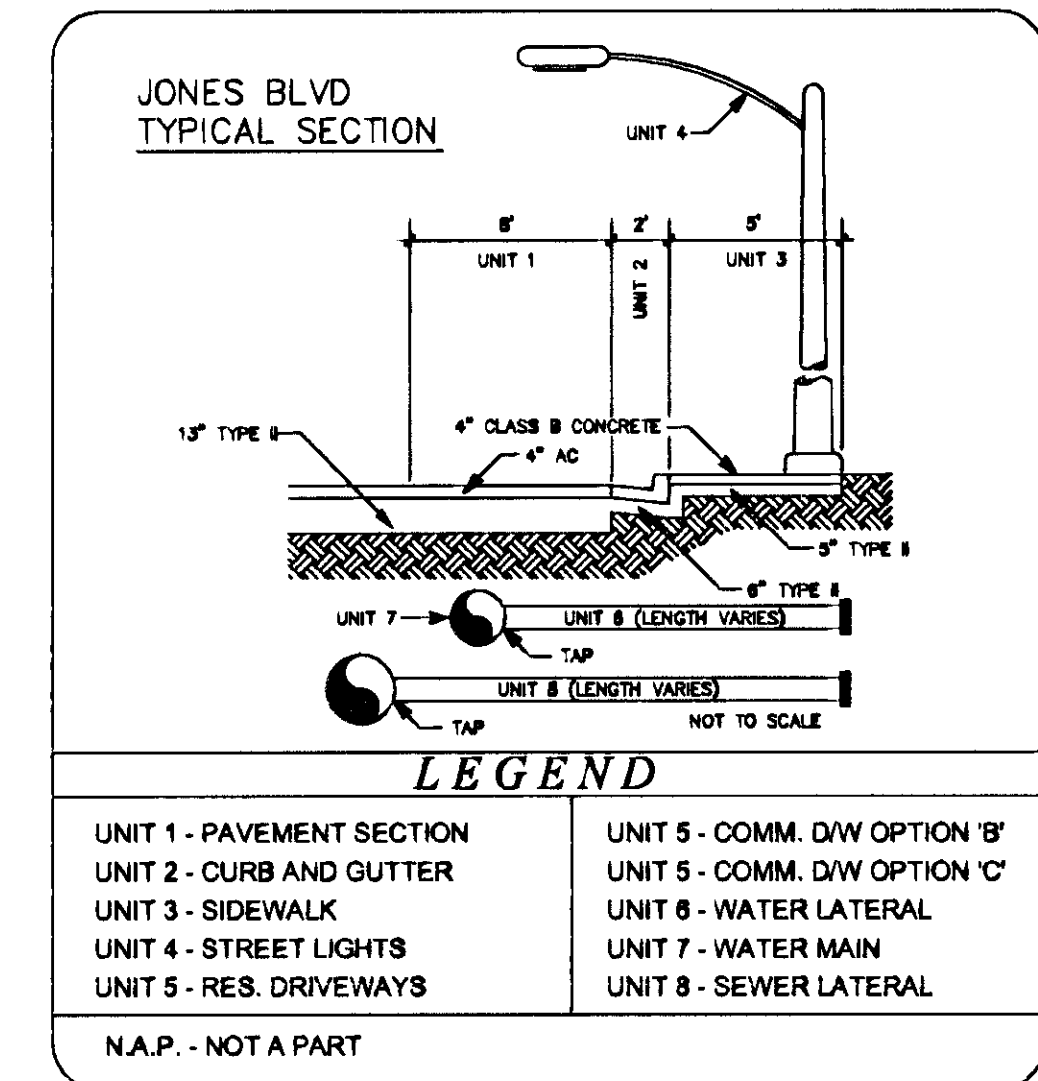

FINAL
ASSESSMENT
MAP
REFERENCE FINAL ASSESSMENT ROLL
INST: 201203202239 DATE: 01-22-12

Scale (N) 1"=200'

Scale (V) Not to Scale

Scale (H) Not to Scale

File No. 10/10/2005

Design by: TPM

Approved by:

Date:

Revisions

Date

Department of Public Works

Jones / Grand Teton
Elkhorn Rd to Horse Dr and
Maverick St to Decatur Blvd

SPECIAL
IMPROVEMENT
DISTRICT
1507

2
3

Jones Boulevard (Elkhorn Rd to Horse Dr) and Grand Teton Drive (Maverick St to Decatur Blvd) Special Improvement District No. 1507

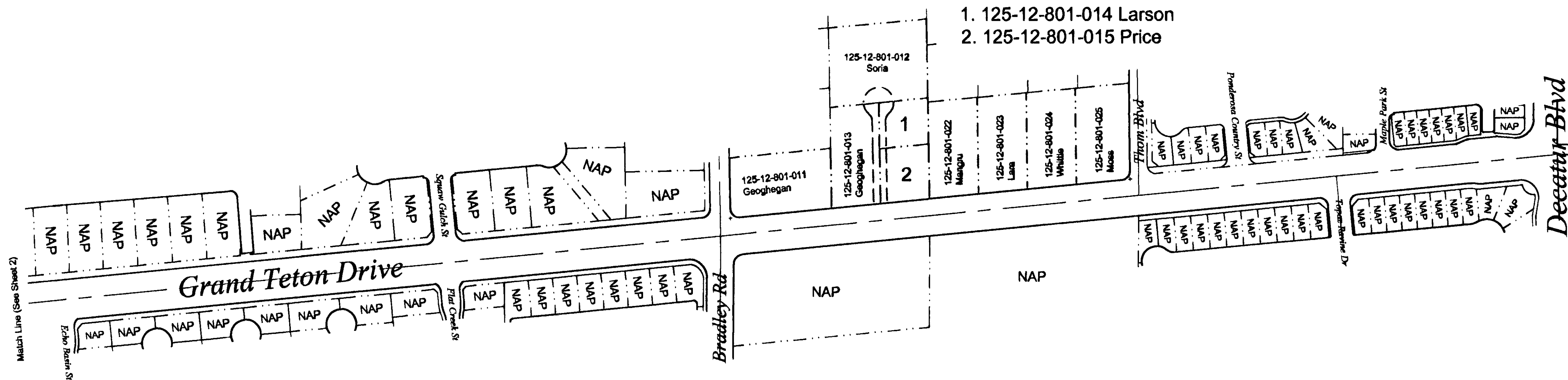

1. 125-12-801-014 Larson
2. 125-12-801-015 Price

FINAL ASSESSMENT MAP
 REFERENCE FINAL ASSESSMENT ROLL
 INST: 2012032202239 DATE: 01-22-12

UNITS	125-12-801-011	125-12-801-012	125-12-801-013	125-12-801-014	125-12-801-015	125-12-801-022	125-12-801-023	125-12-801-024	125-12-801-025
UNIT 1 - 8" PAVEMENT SECTION	151'	292'			148'	148'	148'	161'	
UNIT 2 - CURB AND GUTTER	151'	244'			148'	148'	148'	161'	
UNIT 3 - SIDEWALK	139'	244'			117'	90'	92'	103'	
UNIT 4 - STREETLIGHTS	151'	292'			148'	148'	148'	161'	
UNIT 5 - RES. DRIVEWAYS	24'				29'	28'	27'	29'	
UNIT 5 - COMM. D/W OPTION 'B'						28'	27'	29'	
UNIT 5 - COMM. D/W OPTION 'C'		338 SF							
UNIT 6 - WATER LATERALS									
UNIT 7 - WATER MAIN									
UNIT 8 - SEWER LATERALS					18'-8"	18'-8"	18'-8"	21'-8"	

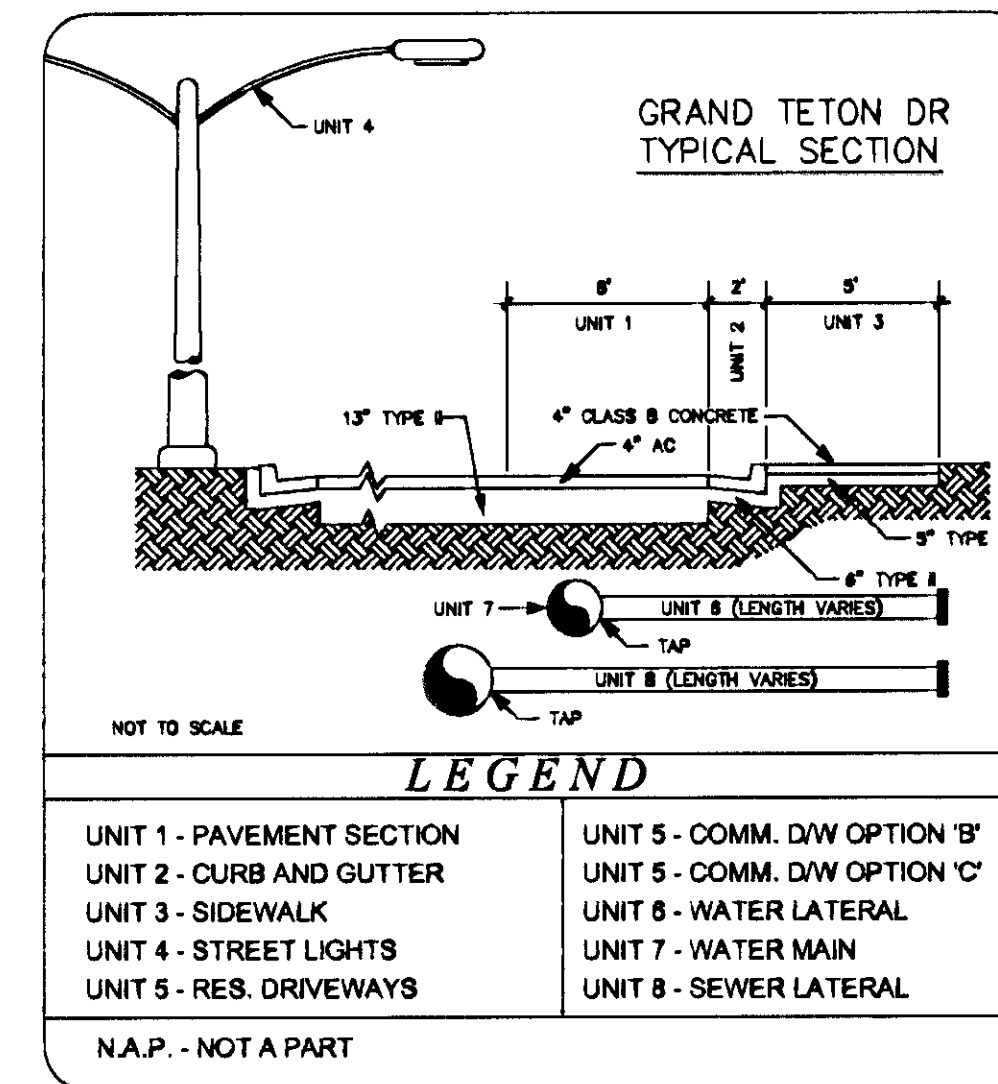

SCALE: 1" = 200'

Scale (1)	1"=200'	Scale (2)	Not to Scale	W.A.
File. bk. no.		Date:	10/10/2005	
Design by:		Drawn by:	TPM	
Approved by:		Date:		
				Revision
				Date

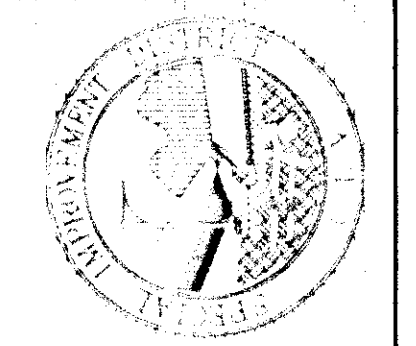

Department of Public Works
 Jones / Grand Teton
 Elkhorn Rd to Horse Dr and
 Maverick St to Decatur Blvd

SPECIAL
 IMPROVEMENT
 DISTRICT
 1507

