

JONES BOULEVARD MANHOLE SCHEDULE

MANHOLE NO.	APPROXIMATE LOCATION	INSIDE DIAMETER (2)	AVG DEPTH (1)	Material Type	REQUIRED REPAIRS
1	377+20	32	5'	PRECAST CONCRETE	NO REPAIR
2	374+30	48	7'	PRECAST CONCRETE	FILL HOLES/FRACTURES AND COAT MANHOLE INTERIOR AND REMOVE DEPOSITS IN FLOWLINE
3	371+40	48	9.5'	PRECAST CONCRETE	FILL HOLES/FRACTURES AND COAT MANHOLE INTERIOR
4	370+40	48	10'	PRECAST CONCRETE	NO REPAIR
5	368+90	48	10'	PRECAST CONCRETE	FILL HOLES/FRACTURES AND COAT MANHOLE INTERIOR AND REMOVE DEPOSITS IN FLOWLINE
6	366+35	48	10'	PRECAST CONCRETE	SPOT REPAIR EXPOSED REINFORCEMENT AND COAT MANHOLE INTERIOR AND REMOVE DEPOSITS IN FLOW LINE
7	364+05	48	10'	PRECAST CONCRETE	SPOT REPAIR EXPOSED REINFORCEMENT AND COAT MANHOLE INTERIOR
8	362+40	48	10'	PRECAST CONCRETE	SPOT REPAIR EXPOSED REINFORCEMENT AND COAT MANHOLE INTERIOR
9	361+45	48	10'	PRECAST CONCRETE	FILL HOLES/FRACTURES AND COAT MANHOLE INTERIOR
10	358+40	48	10.5'	PRECAST CONCRETE	SPOT REPAIR EXPOSED REINFORCEMENT AND COAT MANHOLE INTERIOR
11	342+30	48	13.5'	PRECAST CONCRETE	FILL HOLES/FRACTURES AND COAT MANHOLE INTERIOR
12	340+80	48	13.5'	PRECAST CONCRETE	FILL HOLES/FRACTURES AND COAT MANHOLE INTERIOR
13	337+90	48	14'	PRECAST CONCRETE	NO REPAIR
14	334+70	48	13'	PRECAST CONCRETE	FILL HOLES/FRACTURES AND COAT MANHOLE INTERIOR

(1) FROM AS-BUILTS
(2) FROM PIPE INSPECTION

VALLEY VIEW BOULEVARD MANHOLE SCHEDULE

MANHOLE NO.	APPROXIMATE LOCATION	DIAMETER (2)	AVG DEPTH (1)	MATERIAL TYPE	REHAB REQUIREMENTS
7	90+50	48	11'	PRECAST CONCRETE	SPOT REPAIR EXPOSED REINFORCEMENT AND COAT MANHOLE
8	87+95	48	9'	PRECAST CONCRETE	SPOT REPAIR EXPOSED REINFORCEMENT AND COAT MANHOLE
9	85+25	48	9.5'	PRECAST CONCRETE	REMOVE DEPOSITS FROM FLOWLINE AND COAT MANHOLE
10	82+60	48	9.5'	PRECAST CONCRETE	REMOVE DEPOSITS FROM FLOWLINE AND COAT MANHOLE
11	76+95	48	11'	PRECAST CONCRETE	APPLY STRUCTURAL LINING AND COAT MANHOLE
12	75+20	48	16'	PRECAST CONCRETE	COAT MANHOLE
13	72+90	48	13.5'	PRECAST CONCRETE	SPOT REPAIR EXPOSED REINFORCEMENT AND COAT MANHOLE
14	71+40	48	13'	PRECAST CONCRETE	SPOT REPAIR EXPOSED REINFORCEMENT AND COAT MANHOLE
15	68+90	48	10'	PRECAST CONCRETE	REMOVE DEPOSITS FROM FLOWLINE AND COAT MANHOLE

(1) FROM AS-BUILTS
(2) FROM PIPE INSPECTION

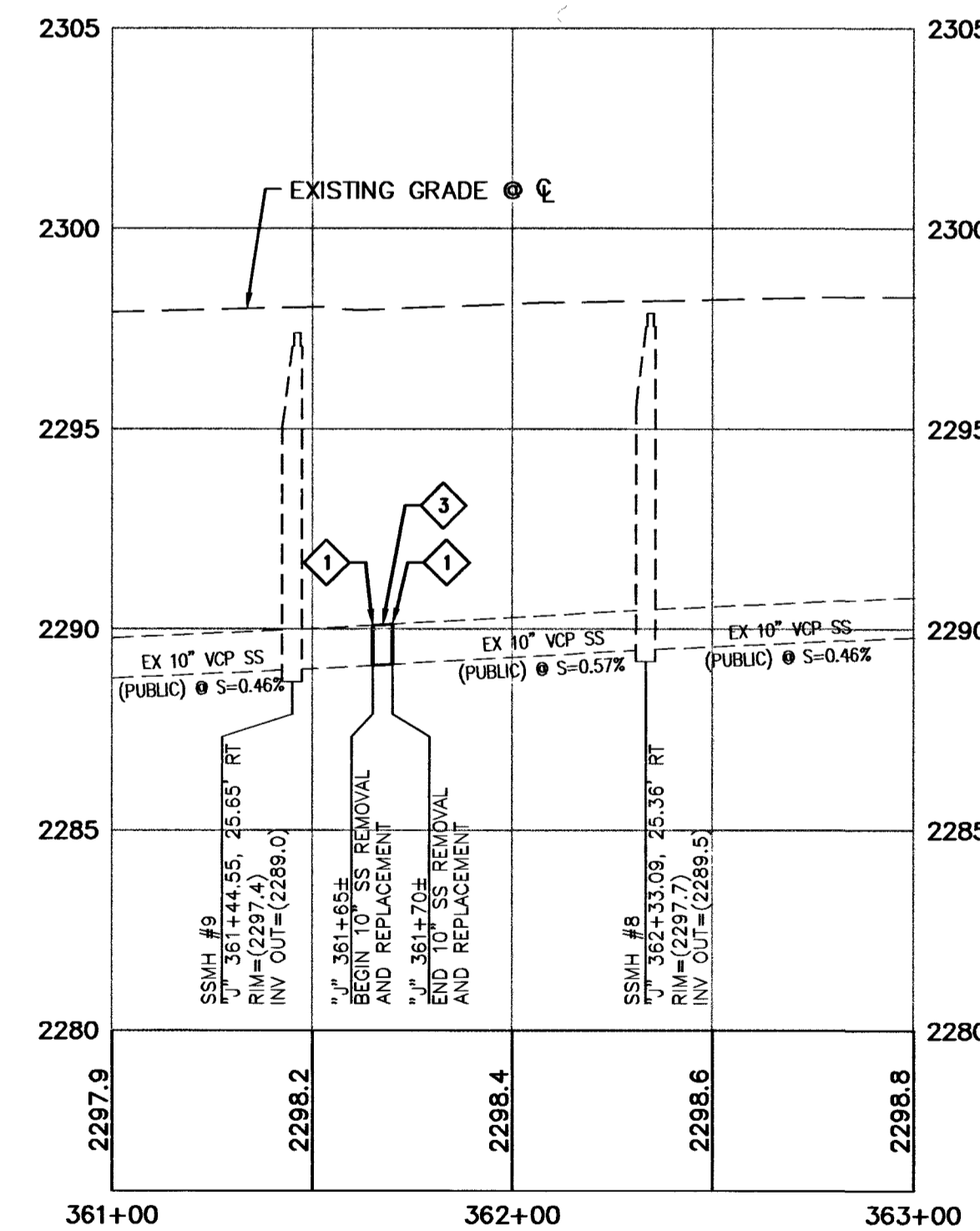
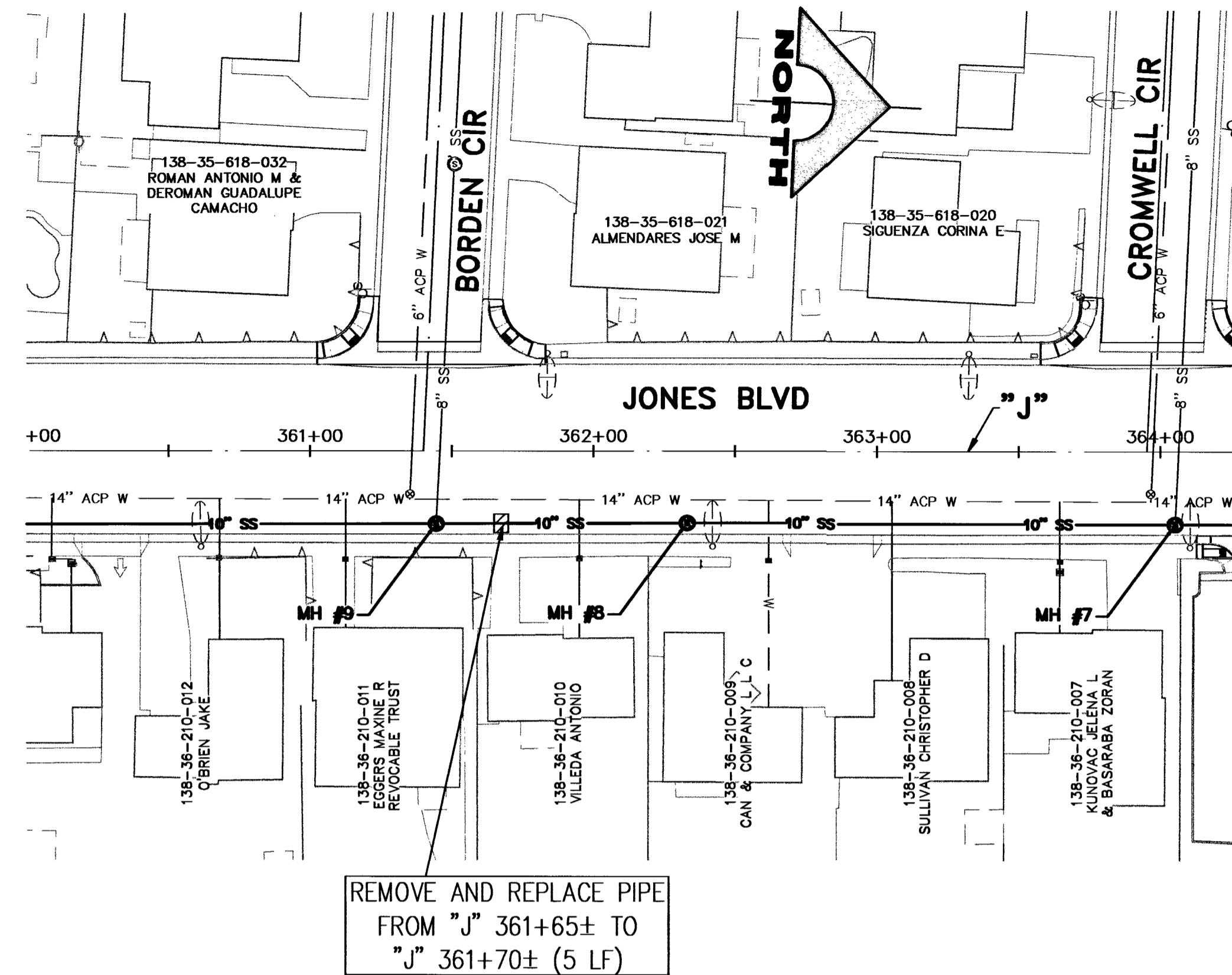

UTILITY NOTES

- EXISTING UTILITY LOCATIONS SHOWN HEREON ARE APPROXIMATE ONLY. IT SHALL BE THE CONTRACTOR'S RESPONSIBILITY TO DETERMINE THE EXACT VERTICAL AND HORIZONTAL LOCATION OF ALL EXISTING UNDERGROUND UTILITIES PRIOR TO COMMENCING CONSTRUCTION. NO REPRESENTATION IS MADE THAT ALL EXISTING UTILITIES ARE SHOWN HEREON. THE ENGINEER ASSUMES NO RESPONSIBILITY FOR UTILITIES NOT SHOWN IN THEIR PROPER LOCATION.
- SEE SPECIFICATIONS FOR PIPE REPLACEMENT REQUIREMENTS.
- CONTRACTOR TO MAINTAIN AND BYPASS SEWER FLOWS IN ACCORDANCE WITH SPECIFICATIONS.
- CONTRACTOR TO VERIFY LOCATION OF SERVICE LATERALS.
- LIMITS OF PIPE REMOVAL TO BE VERIFIED IN FIELD BY ENGINEER.

SEWER CONSTRUCTION NOTES

- CONNECT TO EXISTING VCP SS PER DCSWCS STD. DWG. NO. SD-33
- INSTALL 10" C900 SS MAIN (PUBLIC)
- INSTALL 10" SDR35 SS MAIN (PUBLIC)
- CONNECT EXISTING SANITARY SEWER LATERAL
- CONNECT TO EXISTING SANITARY SEWER MANHOLE PER CLV STANDARDS

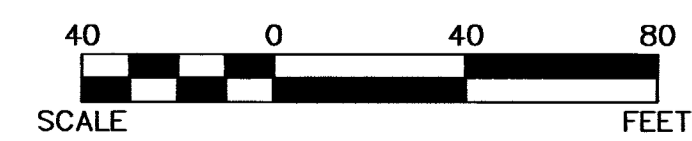

NO.	DATE	DESCRIPTION	APP'D

DEPARTMENT OF PUBLIC WORKS
CAPITAL PROJECT MANAGEMENT

CITY ENGINEER: DAVID BOWERS, PE, PTOE
PROGRAM MANAGER: JEREMY LEVITT, P.E.

DESIGNED BY: MDW
DRAWN BY: DSP
CHECKED BY: TAM

DATE: 9/21/11

TITLE: JONES BOULEVARD IMPROVEMENTS
SAHARA AVENUE TO US 95

SHEET: SANITARY SEWER REPAIR PLAN I

SEAL: MATTHEW D MEYER, CIVIL ENGINEER, STATE OF NEVADA, LICENSE NO. 15790

Sheet: UT-12
73A of 101
DRAWING NO. 107V5627

JONES BOULEVARD - SAHARA AVENUE TO US 95