

1
C5.04 SD LATERAL-STA.103+92.86
H: 1"=40'
V: 1"=8'

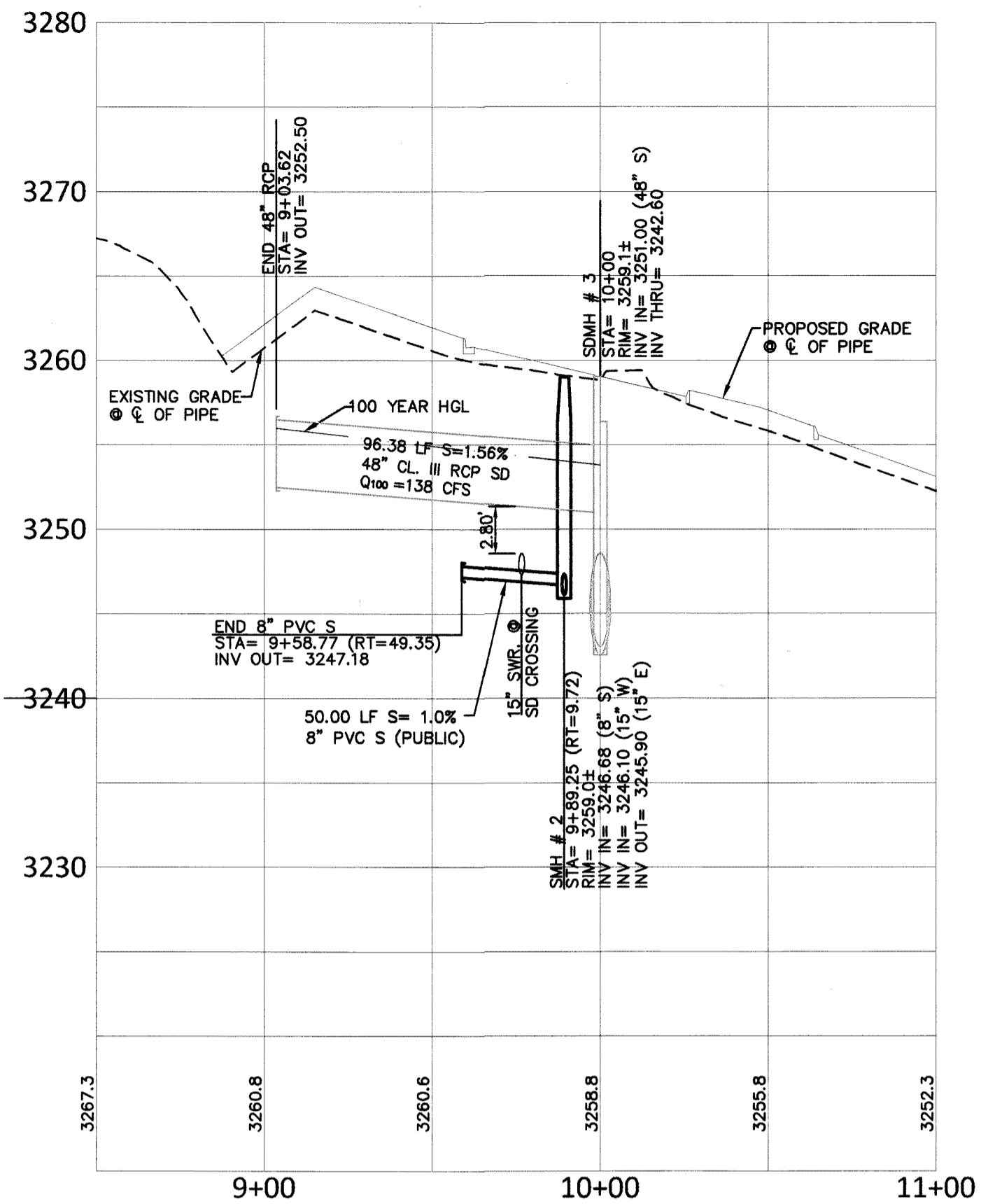

2
C5.04 SD LATERAL-STA.107+54.41
H: 1"=40'
V: 1"=8'

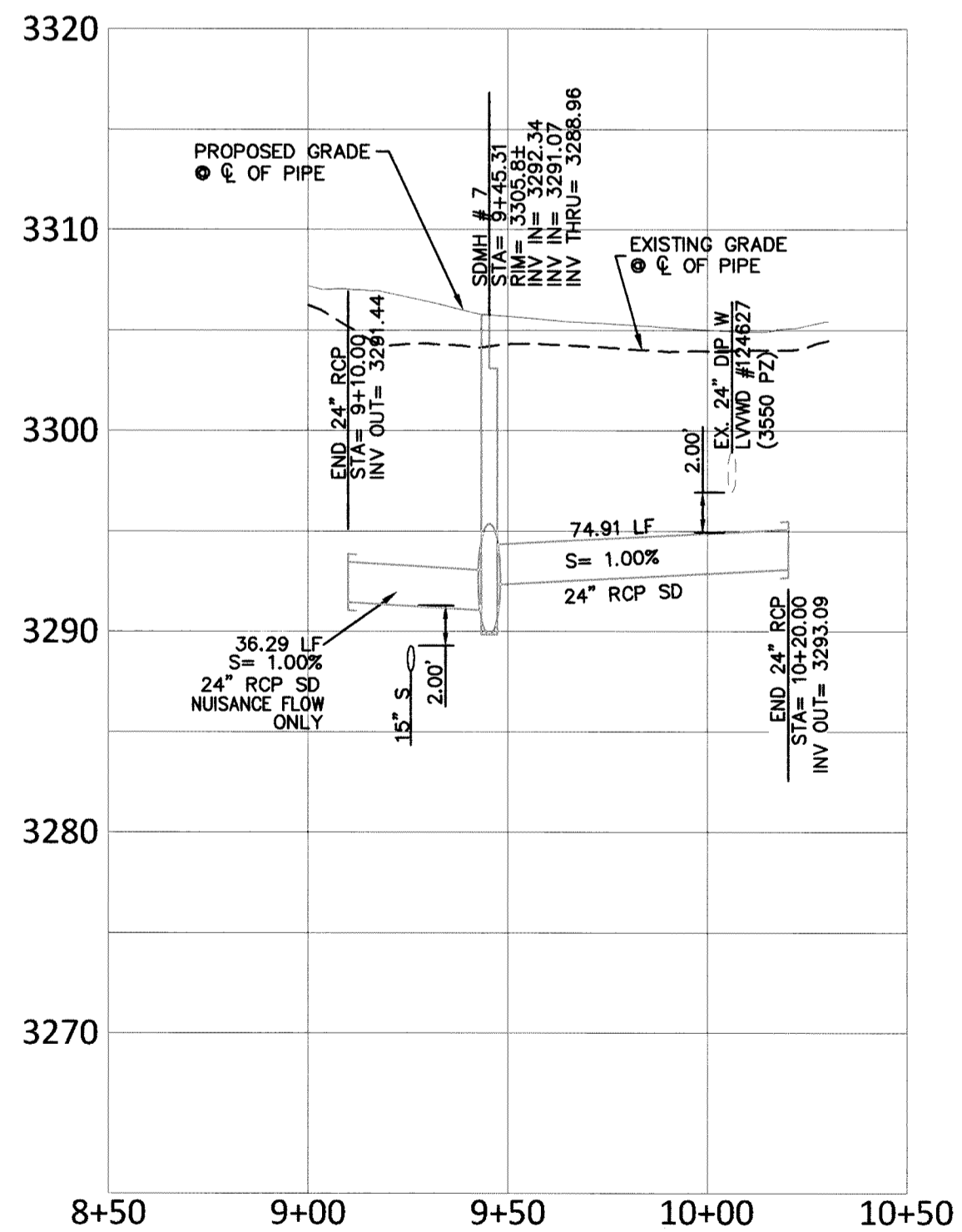

3
C5.04 SD LATERAL-STA.116+22.36
H: 1"=40'
V: 1"=8'

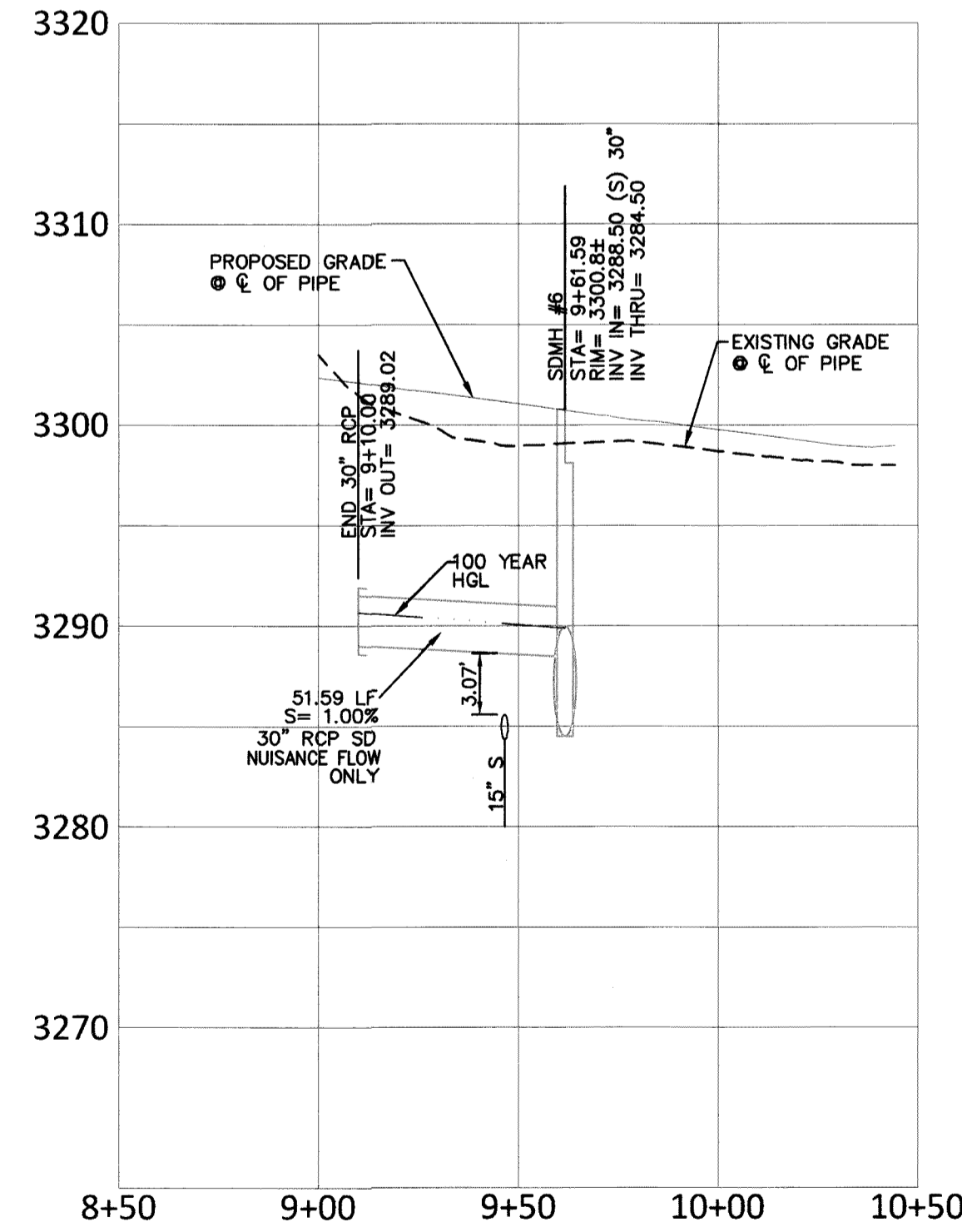

4
C5.04 SD LATERAL-STA.115+13.19
H: 1"=40'
V: 1"=8'

APPROVED FOR CONSTRUCTION
LAS VEGAS VALLEY WATER DISTRICT ENGINEERING SERVICES MANAGER
DATE: _____ PROJECT NO: 124803

COLLINS ENGINEERS
3130 S. DURANGO DR., SUITE 404
LAS VEGAS, NV 89117
PHONE: (702) 248-8000
FAX: (702) 248-8070
WWW.COLLINSENG.COM

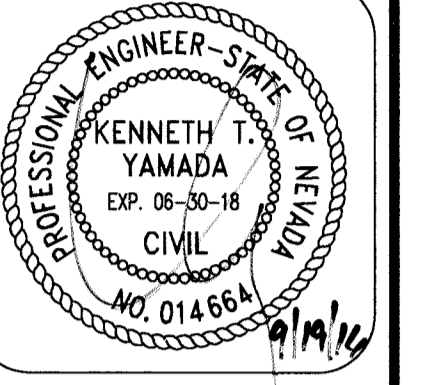

**LAKE MEAD BLVD STREET IMPROVEMENTS
(I-215 TO DESERT FOOTHILLS)
STORM DRAIN LATERALS**

LAKE MEAD BLVD
CITY OF LAS VEGAS

NO.	DATE	DESIGN BY	DESCRIPTION

CEI PROJECT: 9346
DESIGN BY: J. SALDIVAR
DRAWN BY: J. SALDIVAR
CHECKED BY: K. YAMADA
DATE: 09/01/16
SCALE: N/A

SHEET NUMBER
C5.04
SHEET 9 OF 15
H# 65667
18786673