

# SOUTHWEST GAS CORPORATION

## SI-CLV-LORENZI & ALTA PVC REPLACEMENT CITY OF LAS VEGAS, NV WR# 1531932

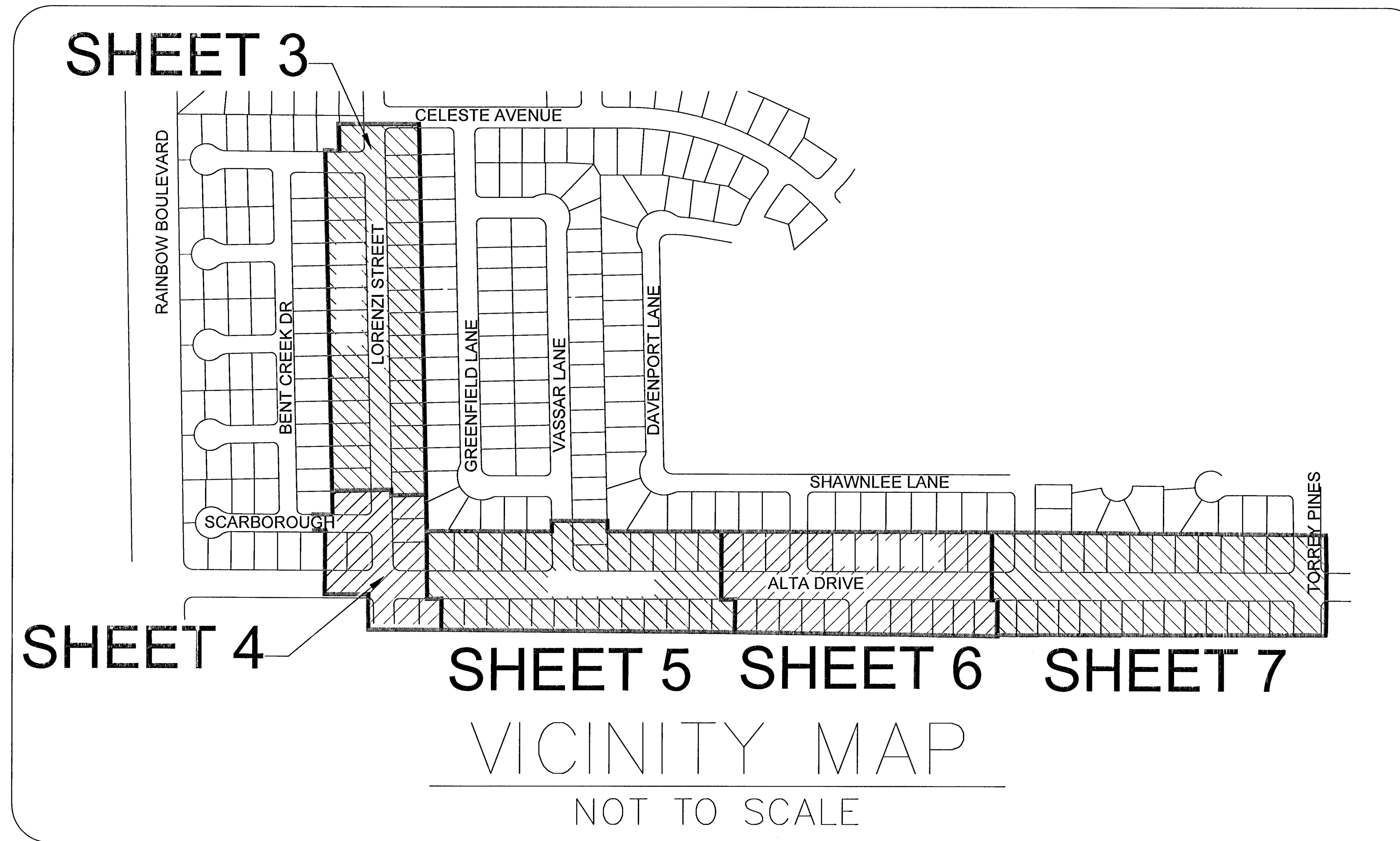
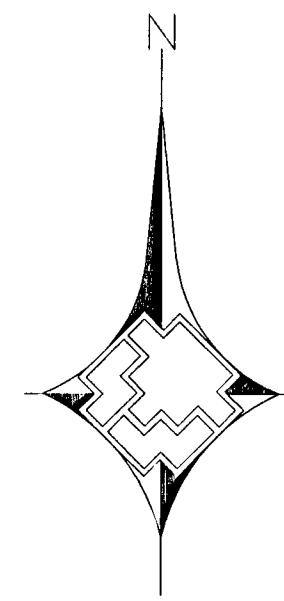

**LEGEND:**

	EXISTING GAS LINE
	GAS LINE TO BE ABANDONED
	EXISTING GAS SERVICE
	PROPOSED MAIN GAS LINE (NEW)
	PROPOSED SERVICE LATERAL (NEW)
	PROPOSED SERVICE LINE (NEW)
	RIGHT OF WAY LINE
	STREET CENTERLINE
	PROPERTY LINE
	BACK OF CURB
	MATCHLINE
	EXISTING ANODELESS RISER
	EXISTING ANODE RISER

**SHEET INDEX**

- COVER SHEET
- MATERIALS & SIGNATURE SHEET
- DESIGN PLAN
- DESIGN PLAN
- DESIGN PLAN
- DESIGN PLAN
- DESIGN PLAN
- DETAIL SHEET - A, B & C
- DETAIL SHEET - D, E & F
- DETAIL SHEET - G & H

City of Las Vegas

Total footage located in Public ROW 4,012'

**APPROVED FOR CONSTRUCTION**  
THIS APPROVAL IS FOR WORK IN CLV R/W OR CLV EASEMENTS ONLY. OBTAINING PERMISSION OR EASEMENTS FOR WORK SHOWN ON PRIVATE PROPERTY IS THE RESPONSIBILITY OF THE UTILITY.

Approval: Date: 12-17-13  
51826 107V 6103-671  
51979

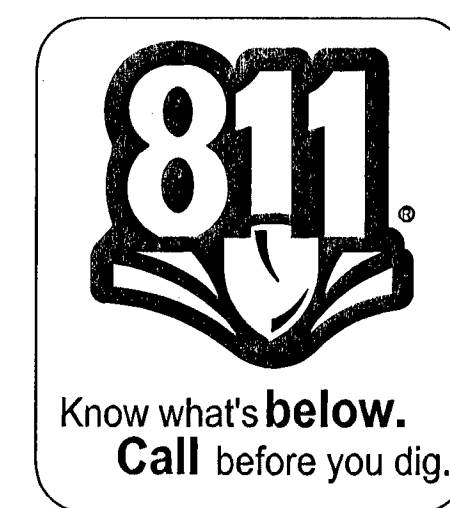

NO.	REVISION	BY	DATE	APPVD
1.	REVISION			
2.				
3.				
4.				

REVISIONS

TAX CODES	UNIT NO.	UNIT TYPE	INSTL. PROPOSED	RETIRED	INSTL. COMPLETED	RETIRED

PROPERTY UNITS

**AS-BUILT DRAWING-PRESSURE TEST DATA**

PIPE DIA.	PIPE LENGTH	PIPE TYPE	MIN DURATION	TEST MEDIUM	TEST METHOD
				<input type="checkbox"/> AIR <input type="checkbox"/> WATER	<input type="checkbox"/> GAUGE <input type="checkbox"/> CHART
				<input type="checkbox"/> SOAP	<input type="checkbox"/> GAUGE/PRESS REC SN#

TEST PRES. (PSIG) \_\_\_\_\_ DATE \_\_\_\_\_ PERFORMED BY \_\_\_\_\_

**VISUAL INSPECTION CERTIFICATION**

I HAVE VISUALLY INSPECTED ALL HEATED FUSIONS, SOLVENT CEMENT, MECHANICAL JOINTS, AND WELDS THAT HAVE BEEN PERFORMED

NAME \_\_\_\_\_ DATE \_\_\_\_\_

INSPECTOR \_\_\_\_\_ FOREMAN \_\_\_\_\_ REVIEWER BY \_\_\_\_\_

AS-BUILTS ACCEPTED BY \_\_\_\_\_ DATE \_\_\_\_\_ POSTED BY \_\_\_\_\_ DATE \_\_\_\_\_ POSTING QC'D BY \_\_\_\_\_ DATE \_\_\_\_\_

**CONSTRUCTION**

PERMIT INFORMATION

CLV TAX CODE 02-0200

ISOLATION AREA	W.R. NO.
46	1531932
LOCATION	ATLAS #/TITLE #
T-20S R-60E Sec. 35 M.D.M.	x600y516 x600y514 x603y514

ENGINEER/TECH: HECTOR INIGUEZ	PHONE: (702)365-2204
ACCOUNT REP:	PHONE:
PROJECT CONTACT:	PHONE:
SHEET NO: 1 OF 10	SCALE: N.T.S
DWN. BY: MFS	CHKD. BY: BMH
DATE: 8/21/13	APPVD. BY: PD

**SI-CLV-LORENZI & ALTA PVC REPLACEMENT**

1531932a.dwg