

SEE SHEET L-02

MATCHLINE

"X" 325+00.00

SEE ABOVE RIGHT

MATCHLINE

"X" 334+50.00

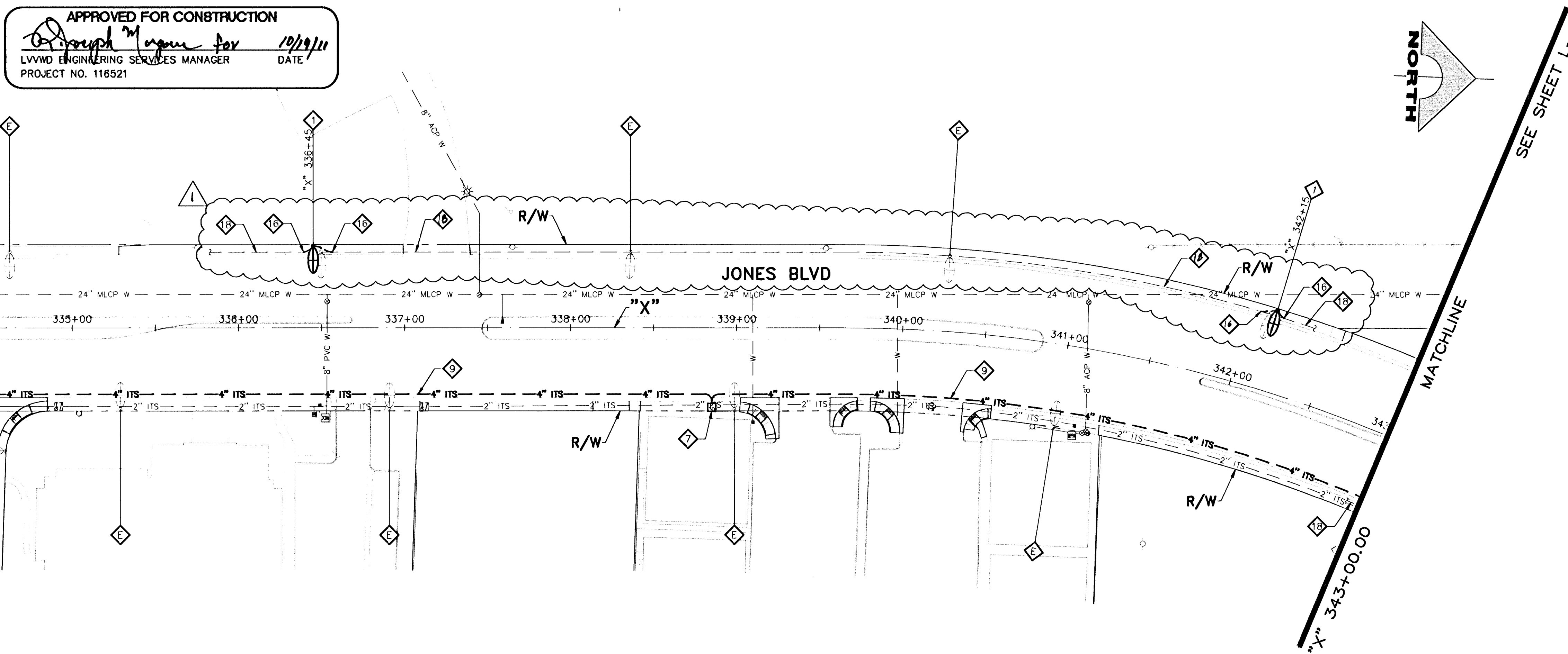
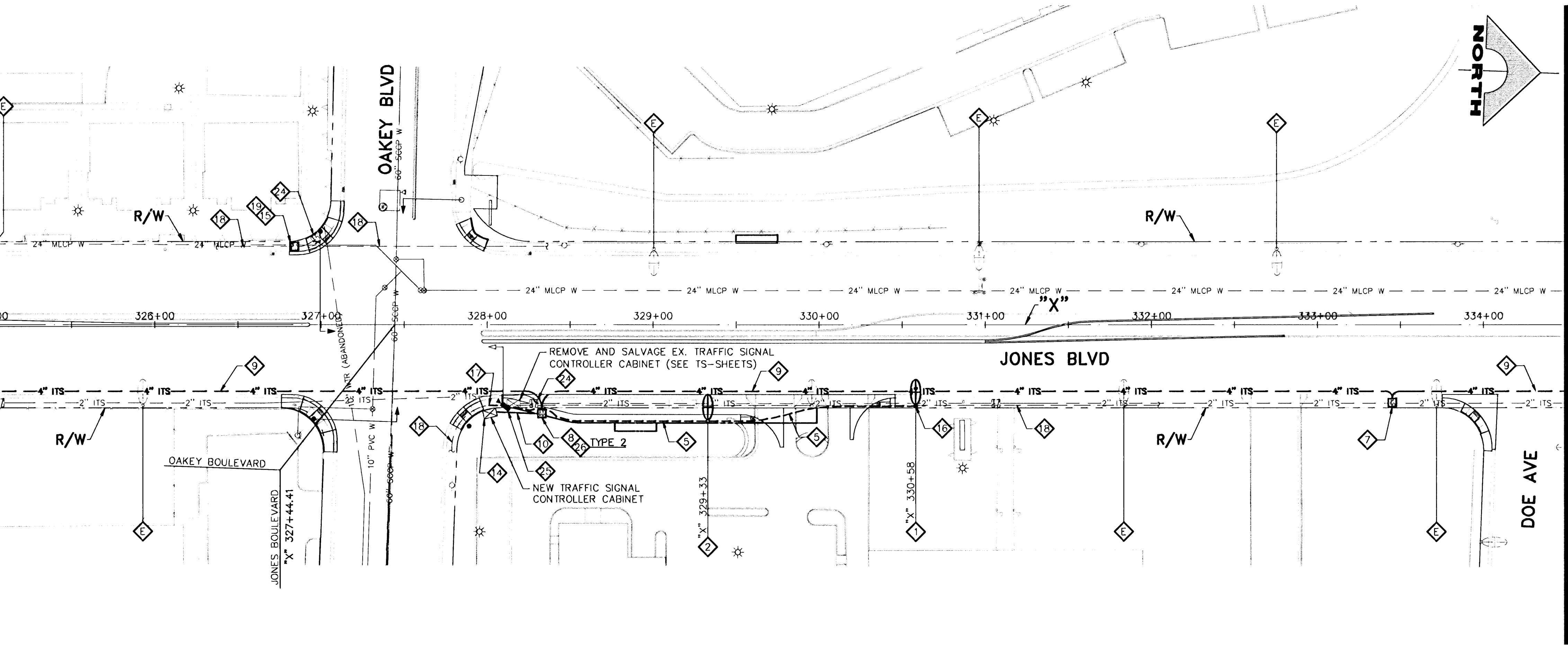

APPROVED FOR CONSTRUCTION
Joseph M. Magan for 10/19/11
 LVVMD ENGINEERING SERVICES MANAGER DATE
 PROJECT NO. 118521

- LIGHTING AND ITS NOTES**
- 1. INSTALL 11-GAUGE STREET LIGHT ASSEMBLY WITH AN 8-FT LUMINAIRE ARM ON NEW FOUNDATION IN BACK PORTION OF SIDEWALK (USDCCA STD. DWG. NOS. 316, 320, & 321)
 - 2. INSTALL EXISTING LED LUMINAIRE FROM REMOVED STREET LIGHT ON NEW LUMINAIRE ARM
 - 3. INSTALL 11-GAUGE STREET LIGHT ASSEMBLY WITH A 15-FT LUMINAIRE ARM ON NEW FOUNDATION IN BACK PORTION OF SIDEWALK (USDCCA STD. DWG. NOS. 316, 320, & 321)
 - 4. INSTALL EXISTING LED LUMINAIRE FROM REMOVED STREET LIGHT ON NEW LUMINAIRE ARM
 - 5. 200 AMP PADMOUNTED SERVICE PEDESTAL (USDCCA STD. DWG. NOS. 330, 331, & 332.1)
 - 6. 1-3" CONDUIT W/3-#3/0 THW (ELECTRICAL SERVICE CONDUIT)
 - 7. 1-2" CONDUIT WITH 2-#4, 1-#8 GND.
 - 8. 2-2" CONDUIT WITH 4-#4, 2-#8 GND.
 - 9. P30 PULL BOX (USDCCA STD. DWG. NOS. 404.132 & 404.142)
 - 10. TYPE 200 SPLICE VAULT (USDCCA STD. DWG. NOS. 404.133 & 404.142)
 - 11. 1-4" PVC CONDUIT WITH 1-72-STRAND FO CABLE & 1-6 PR PE 39 #22 AWG INTERCONNECT CABLE
 - 12. 1-2" PVC CONDUIT WITH 1-CDCA & 1-6 PR PE 39 #22 AWG INTERCONNECT CABLE
 - 13. EXISTING CONDUIT WITH NEW 1-CDCA & 1-6 PR PE 39 #22 AWG INTERCONNECT CABLE
 - 14. 1-2" PVC CONDUIT WITH 25 PR PE 39 #22 AWG INTERCONNECT CABLE
 - 15. 1-2" PVC CONDUIT WITH 1-72-STRAND FO CABLE & 1-6 PR PE 39 #22 AWG INTERCONNECT CABLE
 - 16. FURNISH A LAYER 2 FIELD-HARDENED ETHERNET SWITCH AND ALL ASSOCIATED CABLES AND DELIVER TO FAST FOR INSTALLATION BY FAST STAFF
 - 17. INTERCEPT & EXTEND EXISTING CONDUIT TO PULL BOX
 - 18. INTERCEPT & EXTEND EXISTING CONDUIT TO NEW STREET LIGHT LOCATION
 - 19. INTERCEPT & CONNECT TO EXISTING CONDUIT
 - 20. INSTALL 2-#4, 1-#8 GND. IN EXISTING CONDUIT TO NEAREST STREET LIGHT; SPLICE TO EX. CONDUCTORS
 - 21. NO. 3 1/2 PULL BOX (STREET LIGHTING) (NDOT STD. PLAN T-30.1.18)
 - 22. INSTALL 11-GAGE 250-WATT HPS STREET LIGHT ASSEMBLY WITH A 15-FT LUMINAIRE ARM ON NEW FOUNDATION IN BACK PORTION OF SIDEWALK (USDCCA STD. DWG. NOS. 316, 320, & 321)
 - 23. 1-2" CONDUIT WITH 1-#8 GND.
 - 24. RECONSTRUCT STREET LIGHT CRASH CAP
 - 25. INSTALL 1-72-STRAND FO CABLE & 1-6 PR PE 39 #22 AWG INTERCONNECT CABLE IN EXISTING CONDUIT
 - 26. REMOVE PULL BOX
 - 27. INSTALL CCTV CAMERA AND EXTENSION ON POLE (USDCCA STD. DWG. NO. 404.1500) INSTALL NEW COHU MODEL CA295H CABLE FROM CAMERA TO CONTROLLER CABINET USING SIGNAL CONDUIT
 - 28. INSTALL SPLICE ENCLOSURE, PERFORM FIBER OPTIC SPLICE, TYPE AS NOTED. (SEE SHEET L-11 FOR SPLICE DIAGRAM)
 - 29. EXISTING TO REMAIN

- NOTES:**
1. SEE SHEET G-03 FOR FIBER OPTIC NOTES.
 2. SEE SHEET L-10 FOR SERVICE PEDESTAL LOCATION TABLE
 3. REMOVE AND SALVAGE JONES BOULEVARD INTERCONNECT CABLE FROM SAHARA AVENUE TRAFFIC SIGNAL CABINET TO CLARICE AVENUE AFTER NEW FO COMMUNICATION SYSTEM IS OPERATIONAL.
 4. SEE TS-SHEETS FOR TRAFFIC SIGNAL IMPROVEMENTS
 5. SEE R-SHEETS FOR STREET LIGHT REMOVALS
 6. SEE UT-SHEETS FOR EXISTING UTILITIES
 7. CONTRACTOR SHALL MAINTAIN A MINIMUM OF 12" VERTICAL CLEARANCE AT ALL WATER LINE CROSSINGS AND A MINIMUM OF 3" PARALLEL SEPARATION TO WATER LINES.

FAST
 Call before you UnderGround.
 1-702-432-5300

AVOID HITTING OVERHEAD POWER LINES. IT'S COSTLY.
CALL BEFORE YOU DO OVERHEAD
 1-702-227-2929

Call before you Dig
 Avoid hitting underground utility lines. It's costly.
Call 811
 1-800-227-2600

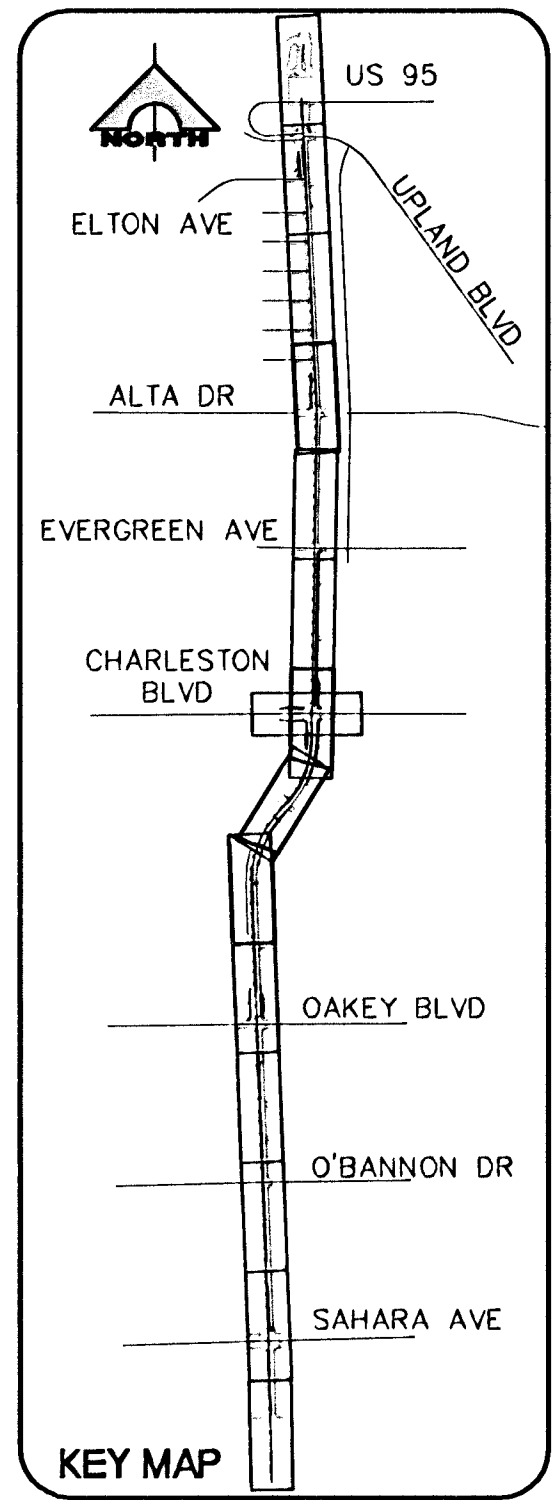

REVISIONS

NO.	DATE	DESCRIPTION	APP'D
1	11/14/11	USE 2-#4, 1-#8 GND.	Matthew D. Meyer

DEPARTMENT OF PUBLIC WORKS
CAPITAL PROJECT MANAGEMENT
 CITY ENGINEER: DAVID BOWERS, PE, PTOE
 PROGRAM MANAGER: JEREMY LEAVITT, P.E.
 DESIGNED BY: MDM
 DRAWN BY: DSP
 CHECKED BY: TAM
 DATE: 9/21/11

JONES BOULEVARD IMPROVEMENTS
SAHARA AVENUE TO US 95
ITS AND LIGHTING PLAN
 "X" 325+00.00 TO "X" 343+00.00

SEAL
 MATTHEW D. MEYER
 CIVIL ENGINEER
 Exp. 12/31/2011
 No. 15790
 11/17/11

Sheet
L-03
 84 of 101
 DRAWING NO.
 107V5627

JONES BOULEVARD - SAHARA AVENUE TO US 95
 HANSEN NO. 38800
 BID NO. 11173005