

WATER NOTES

No.	ITEM
1	INSTALL 2" CORP STOP & 2" WATER LATERAL W/2" METER PER UDACS STD. 1D
2	INSTALL 2" R.P.P.A. PER UDACS STD. 11A
3	INSTALL 2" P.V.C. WATER LATERAL
4	INSTALL STUB & CAP

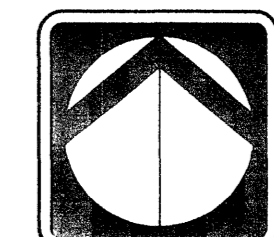

NORTH

GRAPHIC SCALE

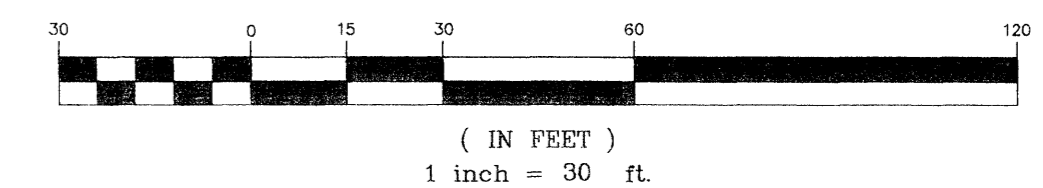

DATE	
BY	
REVISIONS	

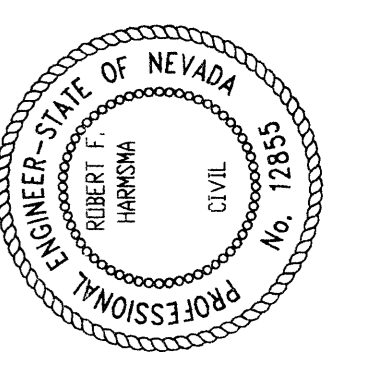

APPROVAL LOG #	
DRAWN BY	THE KEITH COMPANIES
SCALE	1" = 30'
DATE	MARCH 11, 2001
FILE	51512

CLARK COUNTY DEPARTMENT OF REAL PROPERTY MANAGEMENT
500 GRAND CENTRAL PKWY
Las Vegas, NV 89155-1733
(702) 455-4617



JOSEPH M. NEAL PARK
PARK
6851 WEST AZULE AVENUE
LAS VEGAS, NEVADA
WATER AND SEWER PLAN

SHEET
90457
OF
650728

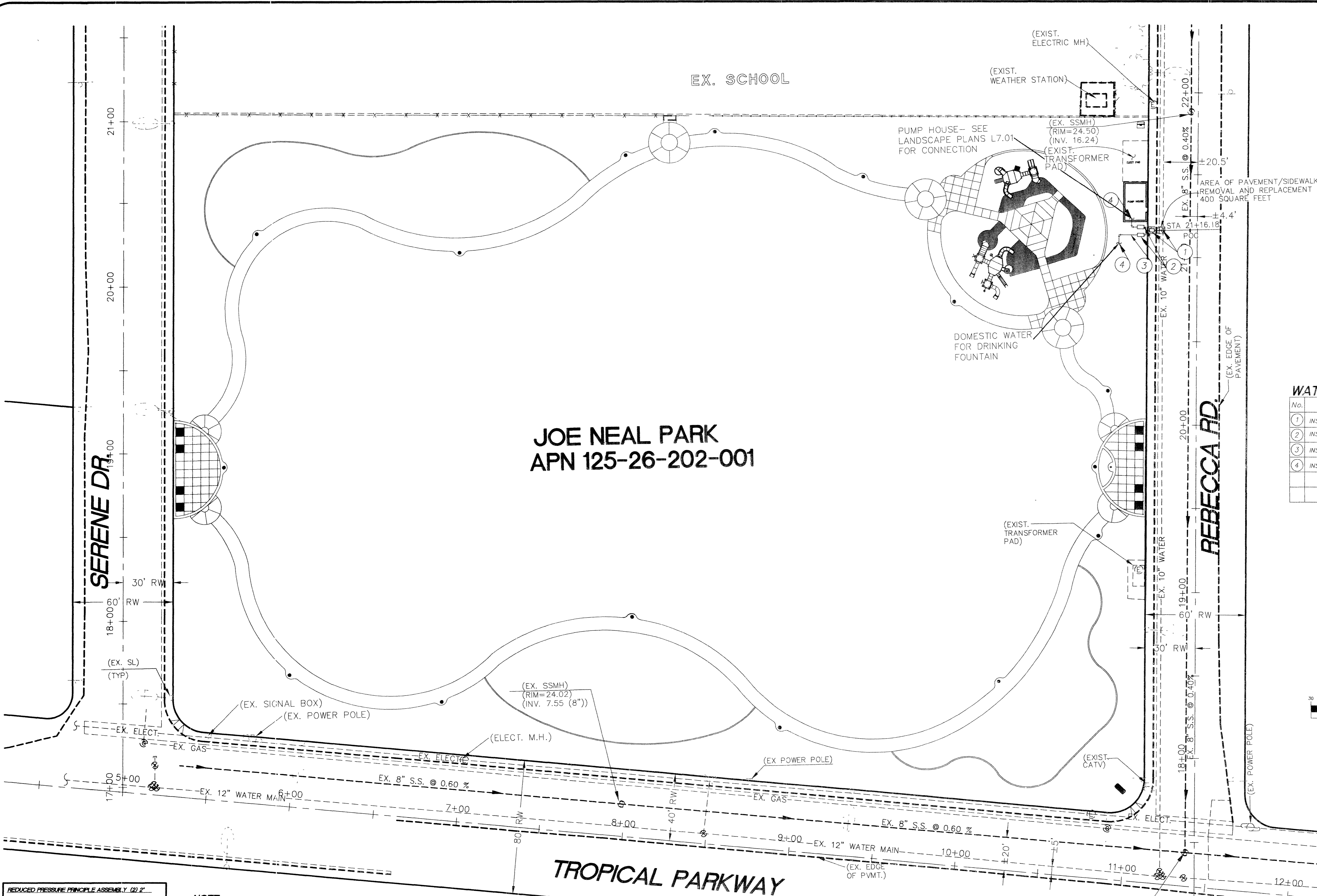

JOE NEAL PARK
APN 125-26-202-001

REDUCED PRESSURE PRINCIPLE ASSEMBLY (2) 2"
APPROVED REDUCED PRESSURE PRINCIPLE ASSEMBLY(S) SHALL BE INSTALLED PER UDACS PLATE NO. 11A OR 11B. NO WATER SHALL BE TAKEN FROM A SERVICE REQUIRING BACKFLOW PREVENTION UNTIL THE REDUCED PRESSURE PRINCIPLE ASSEMBLY HAS BEEN SUCCESSFULLY TESTED BY THE LVWWD.

NOTE
ALL DIMENSIONS TO UTILITIES ARE TO CENTERLINE OF PIPE UNLESS INDICATED OTHERWISE.
CONTRACTOR SHALL VERIFY HORIZONTAL AND VERTICAL ALIGNMENT OF EXISTING UTILITIES AND TO NOTIFY THE DESIGN ENGINEER IMMEDIATELY ON ANY DISCREPANCIES PRIOR TO CONSTRUCTION.

CONSTRUCTION NOTE
ALL EXISTING UTILITY STRUCTURES WITHIN CONSTRUCTION AREA SHALL BE ADJUSTED TO MATCH FINISH GRADE (I.E. W.V. BOX, WMH, ANNODE BOX, FH, TEL BOX, ETC.)

WATER CROSSING NOTE:
WHEN PROTECTION OF THE WATER LINE IS CONSIDERED, THE MINIMUM VERTICAL DISTANCE OF EIGHTEEN INCHES (18") MUST BE MAINTAINED WHEN THE WATER LINE IS INSTALLED OVER THE SEWER/STORM LINE. IF THIS DISTANCE CANNOT BE MAINTAINED BECAUSE OF PHYSICAL OBSTRUCTIONS OR THE WATER LINE MUST BE PLACED UNDER THE STORM/SEWER LINE, THE STORM/SEWER LINE MUST BE CONSTRUCTED WITH ANY OF THE FOLLOWING:
A. EXTRA HEAVY CAST IRON OR DUCTILE IRON PIPE
B. WATER SUPPLY QUALITY
C. ENCASEMENT WITH 4 INCHES MINIMUM OF CONCRETE OR SLEEVING WITH WATER QUALITY PIPE.
EACH OF THESE PROVISIONS MUST BE EXTENDED FOR TEN FEET (10') ON BOTH SIDES OF THE WATER LINE AT 90 DEGREES TO THE CROSSING.

INSTALLATION OF METER AND VAULT
THE METER(S) AND VAULT(S) WITH NON-TRAFFIC-BEARING COVER(S) SHALL BE INSTALLED IN ACCORDANCE WITH THE ATTACHED DETAIL AND WITH ADCs STANDARD VAULT DRAWING C-475, LATEST VERSION.
ANY BLOCK WALL OR OTHER FENCE MATERIAL SHALL BE DESIGNED AND CONSTRUCTED AROUND THE OUTSIDE OF THE EASEMENTS TO ALLOW THE DISTRICT DIRECT ACCESS FROM THE ADJACENT RIGHT-OF-WAY.

BASIS OF BEARINGS
THE BASIS OF BEARINGS IS THE EAST LINE OF THE SOUTHWEST QUARTER (1/4) OF THE NORTHWEST QUARTER (NW 1/4) OF SECTION 26, TOWNSHIP 19 SOUTH, RANGE 60 EAST, M.D.M., CLARK COUNTY, NEVADA, BEING SOUTH 01°37'43" WEST, AS SHOWN BY MAP ON FILE IN FILE 26 PAGE 48 OF PARCEL MAPS IN THE CLARK COUNTY, NEVADA RECORDER'S OFFICE.
BENCHMARK
CITY OF LAS VEGAS STATION 1LV90-35N4
RIVET & PLATE IN TOP OF CEMENT POWER VAULT AT 6400 ANN ROAD, 200' WEST OF TORREY PINES DRIVE
NAVD '88 ELEV=704.633 METERS (2309.373 FEET)

SEWER CONTRIBUTION
AVERAGE FLOW
PEAK FLOW
QUANTITIES
SEE SHEET 4 OF 8 FOR QUANTITIES
NOTE:
SEE LANDSCAPE PLANS FOR ALL CONNECTION DETAILS.

NOTE
PLEASE REFER TO DUNHAM'S PLANS FOR TELEPHONE AND ELECTRICAL CONNECTIONS AND SERVICE.

Call before you Dig.
1-800-227-2600
Call before you Overhead.
1-702-593-6111

APPROVED FOR CONSTRUCTION
LAS VEGAS VALLEY WATER DISTRICT DATE