

GENERAL NOTES

- ALL CONSTRUCTION AND MATERIALS SHALL BE IN ACCORDANCE WITH THE "UNIFORM STANDARD SPECIFICATIONS FOR PUBLIC WORKS CONSTRUCTION OFF-SITE IMPROVEMENTS CLARK COUNTY NEVADA", ISSUED 1987, THE "UNIFORM STANDARD DRAWINGS FOR PUBLIC WORKS CONSTRUCTION, CLARK COUNTY AREA"; ANY OTHER APPLICABLE APPROVED STANDARDS ISSUED BY THE CONTROLLING AGENCY; THE UNIFORM BUILDING CODE; AND ALL LOCAL COUNTY CODES AND ORDINANCES APPLICABLE.
 - THE EXISTENCE AND LOCATION OF ANY UNDERGROUND UTILITY PIPES OR STRUCTURES SHOWN ON THESE PLANS ARE OBTAINED BY A SEARCH OF THE AVAILABLE RECORDS. TO THE BEST OF OUR KNOWLEDGE THERE ARE NO EXISTING UTILITIES EXCEPT AS SHOWN ON THESE DRAWINGS. THE CONTRACTOR IS REQUIRED TO TAKE PRECAUTIONARY MEASURES TO PROTECT THE UTILITY LINES SHOWN AND ANY OTHER LINES NOT OF RECORD OR NOT SHOWN ON THESE DRAWINGS.
 - ALL GRADES ARE REFERENCED TO THE TOP OF THE CONSTRUCTION GRADE STAKES OR NAILS AND THIS RULE SHALL BE OBSERVED: THREE CONSECUTIVE CONSTRUCTION GRADE STAKES OR NAILS CORRESPONDING TO THREE CONSECUTIVE POINTS SHOWN ON THE APPROVED PLANS AS A STRAIGHT GRADE SHALL BE USED IN COMMON AND ANY VARIATION SHALL BE REPORTED IN WRITING TO BEN LEWIS ENGINEERING BEFORE WORK PROCEEDS. CONTRACTORS DOING OTHERWISE SHALL PROCEED AT THEIR TOTAL RISK AND RESPONSIBILITY.
 - THE QUANTITY ESTIMATES SHOWN HEREON ARE APPROXIMATE AND NO ONE IS TO RELY UPON THEM FOR PAY QUANTITIES. EACH AND EVERY CONTRACTOR SHALL HAVE A SET OF APPROVED PLANS AND SPECIFICATIONS ON THE JOB SITE AT ALL TIMES AND SHALL RELY UPON THEM TO A HIGHER DEGREE THAN THE CONSTRUCTION STAKES IN PROSECUTING THE WORK.
 - ALL CONSTRUCTION SHALL BE AS SHOWN ON THESE PLANS, ANY ALTERATIONS SHALL HAVE THE PRIOR APPROVAL OF THE CITY ENGINEER.
 - CONTRACTOR SHALL PROVIDE ALL NECESSARY HORIZONTAL AND VERTICAL TRANSITIONS FOR PROPER DRAINAGE, EXTENT OF TRANSITIONS SHALL BE AS SHOWN OR AS DETERMINED BY CITY ENGINEER OR INSPECTOR.
 - IF ANY CURB GRADES ARE SHOWN ON PLAN @ LESS THAN 0.40%, IT IS REQUIRED BY THIS OFFICE THAT THE FORMS BE CHECKED BY A SURVEY CREW PRIOR TO CONCRETE PLACEMENT. A 48 HOUR NOTIFICATION OF WORK IS REQUIRED. AND IF THIS OFFICE IS NOT NOTIFIED, IT WILL ASSUME NO RESPONSIBILITY FOR FINISHED PRODUCT. EACH JOINT SHALL BE WATER TESTED AS SOON AS POSSIBLE AFTER CONSTRUCTION.
 - ALL CURB AND GUTTER GRADES ARE FIGURED ON CENTERLINE STATIONING UNLESS OTHERWISE SHOWN.
 - ALL POWER POLES TO BE RELOCATED AT NO EXPENSE TO CITY OF LAS VEGAS.
 - EXACT LOCATION OF ALL SAWCUT LINES SHALL BE DETERMINED IN THE FIELD BY A CITY OF LAS VEGAS INSPECTOR.
 - WHEELCHAIR RAMPS SHALL BE CONSTRUCTED IN EACH QUADRANT OF AN INTERSECTION PER STANDARD DRAWING D22A. EXACT LOCATION OF RAMPS SHALL BE DETERMINED IN THE FIELD BY A CITY OF LAS VEGAS INSPECTOR.
 - ALL WORK DONE WITHIN THE PUBLIC RIGHT OF WAY AND OUTSIDE OF THE PROJECT BOUNDARIES WILL REQUIRE A SEPARATE ENCROACHMENT PERMIT ISSUED BY CITY OF LAS VEGAS DEPARTMENT OF PUBLIC WORKS. TRENCH AND PAVEMENT REPLACEMENT CONDITIONS WILL BE AS PER PERMIT.
 - TYPE V CEMENT SHALL BE USED IN ALL OFF-SITE CONCRETE WORK.
- CONCRETE TO BE DESIGNED FOR A 5.5 SACK MIX WITH A MAXIMUM WATER/CEMENT RATIO OF 0.45 (OR AS DESIGNED BY THE SOILS ENGINEER). MIX DESIGN TO BE APPROVED BY THE QUALITY CONTROL DIVISION PRIOR TO USE ON THE PROJECT.

GENERAL NOTES (L.V.V.W.D.)

- ALL WORK TO CONFORM TO LAS VEGAS VALLEY WATER DISTRICT STANDARD PLATES.
- ALL WORK, EXCEPT AS MODIFIED HEREON OR BY NOTE NO. 1 SHALL BE DONE IN ACCORDANCE WITH THE MOST CURRENT DRAFT OR EDITION OF UNIFORM STANDARD SPECIFICATIONS FOR PUBLIC WORKS CONSTRUCTION OFF-SITE IMPROVEMENTS CLARK COUNTY AREA.
- NOTICE TO BE GIVEN ENGINEERING DEPARTMENT OF THE LAS VEGAS VALLEY WATER DISTRICT 48 HOURS PRIOR TO ACTUAL CONSTRUCTION.
- SERVICE SADDLES OR TAPPED COLLARS WILL BE REQUIRED ON ALL 3/4" AND 1" SERVICE LATERALS. SERVICE SADDLES ONLY WILL BE PERMITTED ON 1 1/2" AND 2" SERVICE LATERALS. DOUBLE TAP COLLARS ARE NOT PERMITTED.
- ALL LINES TO BE PRESSURE TESTED TO 200 PSI.
- ALL VALVE BOXES SHALL HAVE CONCRETE COLLARS AT SURFACE OF PAVED AREAS.
- DEFLECTION ANGLE SHALL NOT EXCEED 2 1/2 DEGREES PER 13 FOOT SECTION OF PIPE FOR PIPE SIZES SMALLER THAN 14 INCHES AND SHALL NOT EXCEED 2 DEGREES FOR PIPE SIZES BETWEEN 14" AND 16".
- ALL METERS SHALL BE LOCATED OUTSIDE OF DRIVEWAYS.
- SERVICE LATERALS FOR LOTS WILL BE TAPPED ON EXISTING MAIN BY OWNER'S CONTRACTOR UNDER DIRECTION OF THE LAS VEGAS VALLEY WATER DISTRICT.
- DETECTOR TAPE REQUIRED IN ACCORDANCE WITH STANDARD PLATE NO. 27 WHERE INDICATED AND AS FOLLOWS:
 - OVER ALL MAINS NOT INSTALLED AT 6 FEET FROM BACK OF CURB.
 - OVER ALL SERVICE LATERALS NOT INSTALLED AT RIGHT ANGLES TO MAINS.

NOTE:

STREET SIGNS AND STOP SIGNS SHALL BE INSTALLED PER CITY OF LAS VEGAS STANDARD SPECIFICATIONS FOR PLACEMENT OF STREET NAME SIGNS.

CITY OF LAS VEGAS SEWER NOTES

- ALL CONSTRUCTION AND MATERIALS SHALL BE IN ACCORDANCE WITH THE LATEST EDITION OF THE DESIGN AND CONSTRUCTION STANDARDS OF THE CITY OF LAS VEGAS AND THE UNIFORM STANDARD SPECIFICATIONS FOR PUBLIC WORKS CONSTRUCTION OFF-SITE IMPROVEMENTS, CLARK COUNTY AREA, NEVADA 1978, AS AMENDED. IN ALL CASES, THE CITY'S CRITERIA SHALL SUPERSEDE THE UNIFORM STANDARD SPECIFICATIONS. IT WILL BE THE RESPONSIBILITY OF THE CONTRACTOR TO BE AWARE OF THE CONTENTS OF THE ABOVE SPECIFICATION BOOKS.
- CITY OF LAS VEGAS STANDARD DRAWINGS SHALL APPLY TO ALL CONSTRUCTION.
- SEWER MAINS ONLY TO BE LAID IN SEWER TRENCHES.
- ALL 4" HOUSE LATERALS TO BE LAID AT NOT LESS THAN MINIMUM SLOPES AS SHOWN IN THE C.L.V. STANDARDS.
- IT SHALL BE THE CONTRACTOR'S RESPONSIBILITY TO PERFORM CONSTRUCTION AS PER PLANS. ANY ADDITIONS, DELETIONS, OR CHANGES SHALL FIRST MEET WITH THE APPROVAL OF THE CITY OF LAS VEGAS.
- IF A LATERAL IS UNDER A DRIVEWAY, CONCRETE SLAB, OR A.C. AREA, A CLEANOUT SHALL BE INSTALLED AND RAISED TO GRADE WITH A SLOTTED BRASS CAP OR WITHIN A WATER METER BOX WHICH HAS A METAL COVER MARKED "SEW. C.O." PER CITY OF LAS VEGAS STANDARD DRAWINGS. ALL COMPONENTS OF CLEANOUTS SHALL BE THE SAME SIZE AS THE LATERAL.
- SOIL TESTING SHALL BE IN ACCORDANCE WITH CITY OF LAS VEGAS REQUIREMENTS.
- ALL EXFILTRATION, INFILTRATION, AND AIR TESTING OF LINES SHALL BE IN ACCORDANCE WITH THE CITY OF LAS VEGAS DESIGN AND CONSTRUCTION STANDARDS.
- CUT SHEETS MUST BE SUBMITTED TO THE CITY OF LAS VEGAS BEFORE CONSTRUCTION WILL BE PERMITTED TO START.

STREET AND TRAFFIC NOTES

- STREET SIGN CONTRACTOR SHALL OBTAIN STREET NAMES AND BLOCK NUMBERING FROM THE PLANNING DEPARTMENT PRIOR TO CONSTRUCTION.
- BEFORE ANY WORK IS STARTED IN THE RIGHT-OF-WAY, THE CONTRACTOR SHALL INSTALL ALL ADVANCE WARNING SIGNS FOR THE CONSTRUCTION ZONE. THE CONTRACTOR SHALL INSTALL TEMPORARY STOP SIGNS AT ALL NEW STREET ENCROACHMENTS INTO EXISTING CITY STREETS IMMEDIATELY AFTER FIRST GRADING WORK IS ACCOMPLISHED, AND SHALL MAINTAIN SAID SIGNS UNTIL PERMANENT SIGNS ARE INSTALLED.
- ALL CONSTRUCTION SIGNING, BARRICADING, AND TRAFFIC DELINEATION SHALL CONFORM TO THE "NEVADA TRAFFIC CONTROL MANUAL - 1980" AND TO THE "NEVADA WORK ZONE TRAFFIC CONTROL HANDBOOK - 1988".
- IF THE IMPROVEMENTS NECESSITATE THE OBLITERATION, TEMPORARY OBSTRUCTION, TEMPORARY REMOVAL, OR RELOCATION OF ANY EXISTING TRAFFIC PAVEMENT MARKING, SUCH PAVEMENT MARKING SHALL BE RESTORED OR REPLACED WITH LIKE MATERIALS TO THE SATISFACTION OF THE CITY TRAFFIC ENGINEER.
- THE DEVELOPER SHALL BE RESPONSIBLE TO PROVIDE AND INSTALL ALL PERMANENT SIGNS SHOWN ON THE PLANS. STREET NAME SIGNS SHALL CONFORM IN THEIR ENTIRETY TO CITY STANDARDS. ALL OTHER SIGNS SHALL BE STANDARD SIZE UNLESS OTHERWISE SPECIFIED ON THE PLANS. ALL SIGN POSTS SHALL BE INSTALLED IN ACCORDANCE WITH CITY STANDARDS.
- IF A PROPOSED STREET LIGHT STANDARD IS FIELD LOCATED TO WITHIN FIVE (5) FEET OF ANY SIGN SHOWN HEREON TO BE MOUNTED ON A SIGN POST, THEN CHANGE SIGN MOUNTING TO ONE ON THE STREET LIGHT STANDARD.

STANDARD NOTES FOR STREET LIGHT INSTALLATIONS

- SERVICE POINT SHALL BE DESIGNATED BY NEVADA POWER COMPANY, AND WHEREVER POSSIBLE, BELOCATED NEAR THE CENTER OF THE CIRCUIT. NEVADA POWER SIGNATURE NECESSARY ON ALL PRINTS.
- ALL STREET LIGHT STANDARDS SHALL BE PLACED 12" IN FRONT OF BACK OF SIDEWALK TO THE CENTER OF THE POLE.
- IT SHALL BE ASSUMED THAT IN THE ABSENCE OF AN EXISTING, WORKABLE CIRCUIT TO ATTACH TO, ALL INSTALLATIONS SHALL REQUIRE A NEW SERVICE FOR OPERATION OF THE CIRCUIT.
- ANY PLACE THERE IS AN OVERHEAD UTILITY THAT MAY CONFLICT WITH THE INSTALLATION OF THE STREET LIGHTING CIRCUITS AND/OR POLES, THESE CONFLICTS MUST BE RESOLVED BETWEEN THE DEVELOPER AND THE UTILITIES INVOLVED, AT NO EXPENSE TO THE CITY.
- THE CONTRACTOR SHALL FURNISH COMPLETE SERVICE TO TRANSFORMERS AND CONTROL SYSTEMS IF REQUIRED.
- ANY STRUCTURES SUCH AS BLOCK WALLS, CHAIN LINK FENCES, RETAINING WALLS, ETC. SHALL LEAVE A MINIMUM CLEARANCE OF TWO (2) FEET TO THE CENTER OF THE STREET LIGHTING POLE ON ALL SIDES, AND SHALL AT NO TIME COMPLETELY ENCLOSE THE STREET LIGHTING POLE.

STREET LIGHT SPECIFICATIONS

ALL STREET LIGHTING INSTALLATIONS, EXCEPT AS NOTED ON THE STREET LIGHTING PLANS SHALL CONFORM TO THE STANDARD DETAILS FOR STREET LIGHTING (INCLUDING STANDARD STREET LIGHTING NOTES). THESE INSTALLATIONS SHALL ALSO CONFORM TO THE UNIFORM STANDARD SPECIFICATIONS FOR PUBLIC WORKS CONSTRUCTION OF OFF-SITE IMPROVEMENTS CLARK COUNTY AREA, NEVADA AND THE UNIFORM STANDARD DRAWINGS FOR PUBLIC WORKS CONSTRUCTION, CLARK COUNTY AREA, WHERE APPLICABLE. SERVICE POINT REQUIRED.

QUANTITIES

OFFSITE

NO.	DESCRIPTION	QUANTITY	UNIT
1.	CLEANING & GRUBBING	1.49	ACRES
2.	3" A.C. PAVEMENT	10,102	SQ. FT.
3.	TYPE I GRAVEL BASE	320	CU. YDS.
4.	TYPE II GRAVEL BASE	124	CU. YDS.
5.	4" CONCRETE SIDEWALK	1,507	SQ. FT.
6.	"L" TYPE CURB & GUTTER	301	LIN. FT.
7.	A.C. PAVEMENT REMOVAL	330	SQ. FT.
8.	SAWCUT PAVEMENT	330	LIN. FT.
9.	STREET LIGHTS-250 W. HPS	3	EACH
10.	1 1/4" PVC CONDUIT	302	LIN. FT.
11.	1 1/2" WATER SERVICE	70	LIN. FT.
12.	1" WATER SERVICE	70	LIN. FT.
13.	1 1/2" METER	1	EACH
14.	4" METER	1	EACH
15.	FIRE HYDRANT ASSEMBLY	1	EACH
16.	SEWER MANHOLES (48")	3	EACH
17.	8" PVC SEWER	537	LIN. FT.
18.	6" SEWER LATERAL	33	LIN. FT.

ONSITE

1.	2" A.C. PAVEMENT	42,331	SQ. FT.
2.	TYPE II GRAVEL BASE	1,301	CU. YDS.
3.	"A" TYPE CURB	355	LIN. FT.

(FOR ONSITE WATER & SEWER QUANTITIES SEE SHEET 4 OF 4.)
ONSITE SIDEWALK NOT INCLUDED IN THIS QUANTITY.

INDEX OF SHEETS

SHEET	DESCRIPTION
1.	GENERAL NOTES, QUANTITIES & DETAILS
2.	ROUGH GRADING PLAN
3.	LAMB BLVD. IMPROVEMENT PLAN
4.	WATER & SEWER PLAN

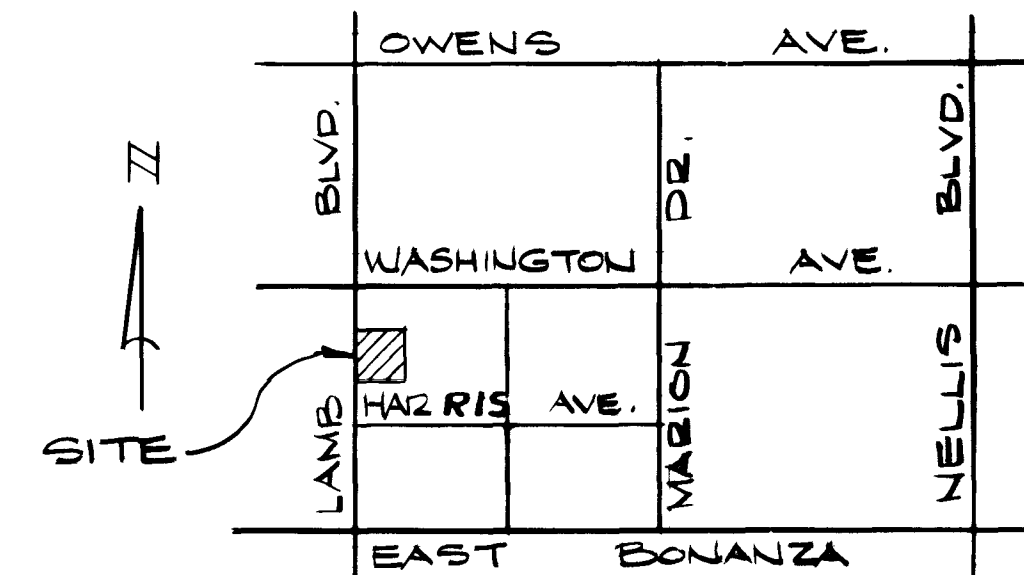

VICINITY MAP

NO SCALE
GENERAL NOTES

CLARK COUNTY FIRE DEPARTMENT

THE FOLLOWING "GENERAL NOTES" ARE REQUIRED TO BE ON WATER PLANS SUBMITTED TO THE CLARK COUNTY FIRE DEPARTMENT FOR APPROVAL.

- ALL WORK SHALL BE DONE IN STRICT ACCORDANCE WITH CLARK COUNTY STANDARD SPECIFICATIONS.
- ALL WORK SHALL BE DONE IN STRICT ACCORDANCE WITH THE CLARK COUNTY FIRE DEPARTMENT "HYDRANT SPECIFICATIONS", "HYDRANT INSTALLATION SPECIFICATIONS" AND "WATER RESOLUTION REQUIREMENTS".
- ON ANY NEW HOME OR BUILDING CONSTRUCTION, ACCESSIBLE FIRE HYDRANTS SHALL BE INSTALLED BEFORE ACTUAL CONSTRUCTION COMMENCES AND SAID FIRE HYDRANTS SHALL BE IN GOOD WORKING ORDER WITH AN ADEQUATE WATER SUPPLY.
- PAINTING OF CURBS AND/OR STRIPING OF ASPHALT AREAS AND PROTECTION OF HYDRANTS FROM PHYSICAL INJURY... PER CLARK COUNTY FIRE DEPARTMENT "HYDRANT INSTALLATION SPECIFICATIONS"... SHALL BE COMPLETED BEFORE APPROVAL OF THE HYDRANTS BY THE CLARK COUNTY FIRE DEPARTMENT CAN BE OBTAINED.
- NO FIRE HYDRANT SHALL BE LOCATED WITHIN FIFTEEN (15) FEET OF ANY DRIVEWAY, SIX FEET OF A POWER POLE, LIGHT STANDARD OR OTHER OBSTRUCTION... FOR WALL, FENCE AND PLANTER LOCATIONS, DRAWING 44.0 "B" SHALL BE USED.

"IN THE ABOVE NOTES, ALL REFERENCES TO CLARK COUNTY FIRE DEPARTMENT WILL BE CONSIDERED TO MEAN CITY OF LAS VEGAS FIRE DEPARTMENT."

APPROVALS

<i>[Signature]</i> CLV CITY ENGINEER	9-11-87 DATE
<i>[Signature]</i> CLV TRAFFIC ENGINEER	9/10/87 DATE
LAS VEGAS VALLEY WATER DISTRICT	DATE
<i>[Signature]</i> CITY OF LAS VEGAS FIRE DEPARTMENT	7-16-87 DATE
<i>[Signature]</i> CITY OF LAS VEGAS SANITATION CHIEF	7-29 DATE
<i>[Signature]</i> SOUTHWEST GAS COMPANY	8/22/87 DATE
<i>[Signature]</i> NEVADA POWER COMPANY	5/22/87 DATE
<i>[Signature]</i> CITY OF LAS VEGAS LAND DEVELOPMENT	7-21-87 DATE
<i>[Signature]</i> CLV ELECTRICAL SUPERVISOR	7-8-87 DATE

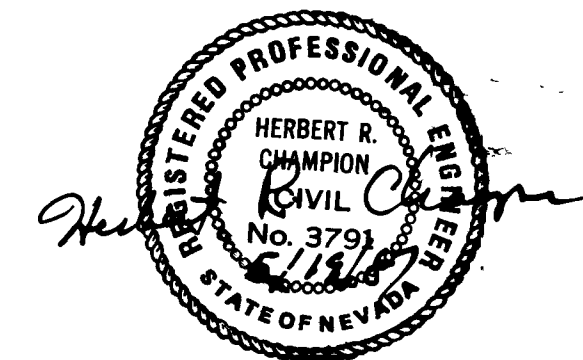
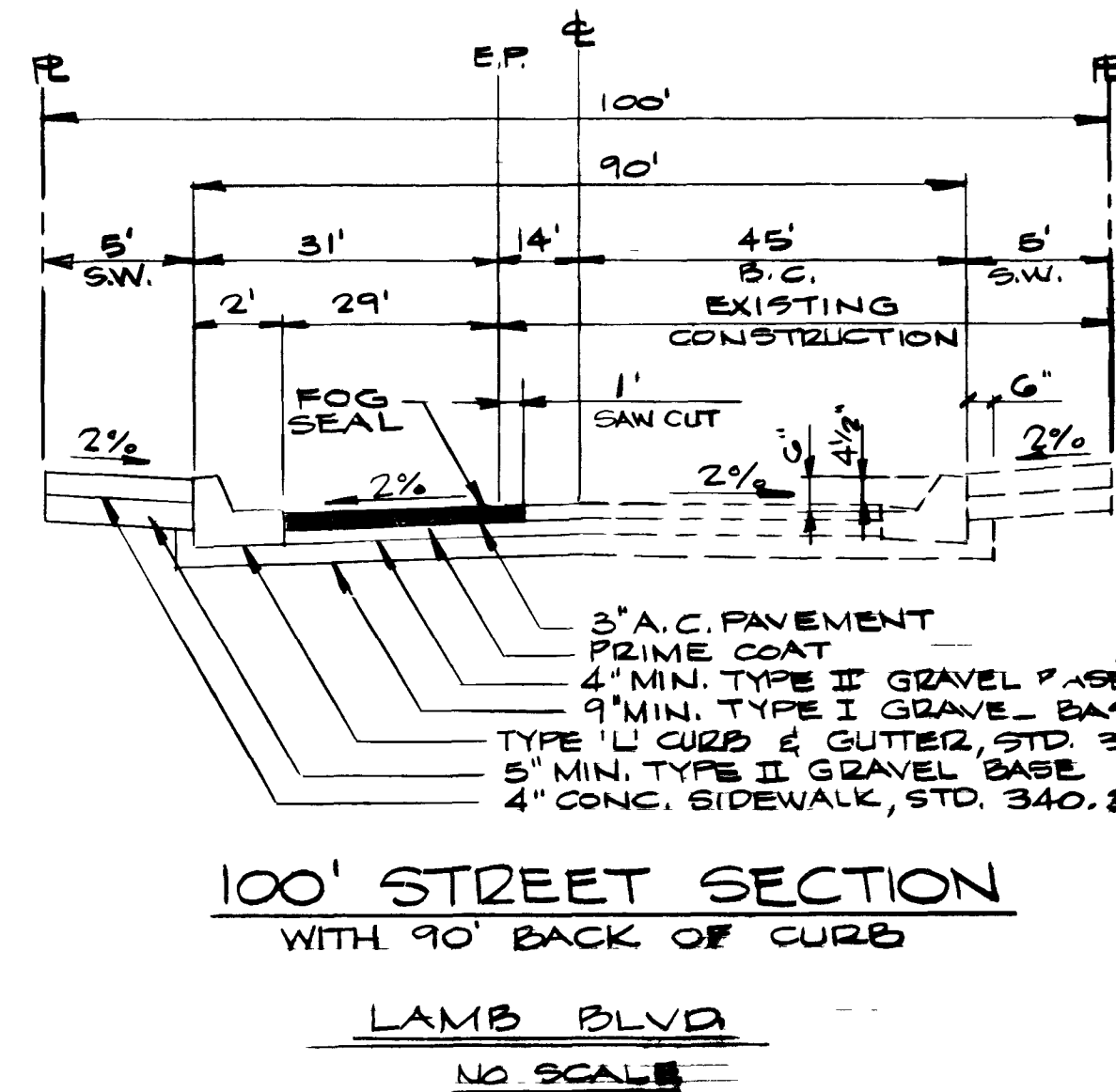

GENERAL NOTES, QUANTITIES & DETAILS

SHAUNA PLAZA 821 North LAMB BLVD
BEN LEWIS ENGINEERING
745 WEST SUNSET ROAD #3
HENDERSON, NEVADA 89015
PHONE (702) 564-1553, (702) 577-1958

