

Call before you dig
1-800-227-2600

HIDDEN CANYON LANE

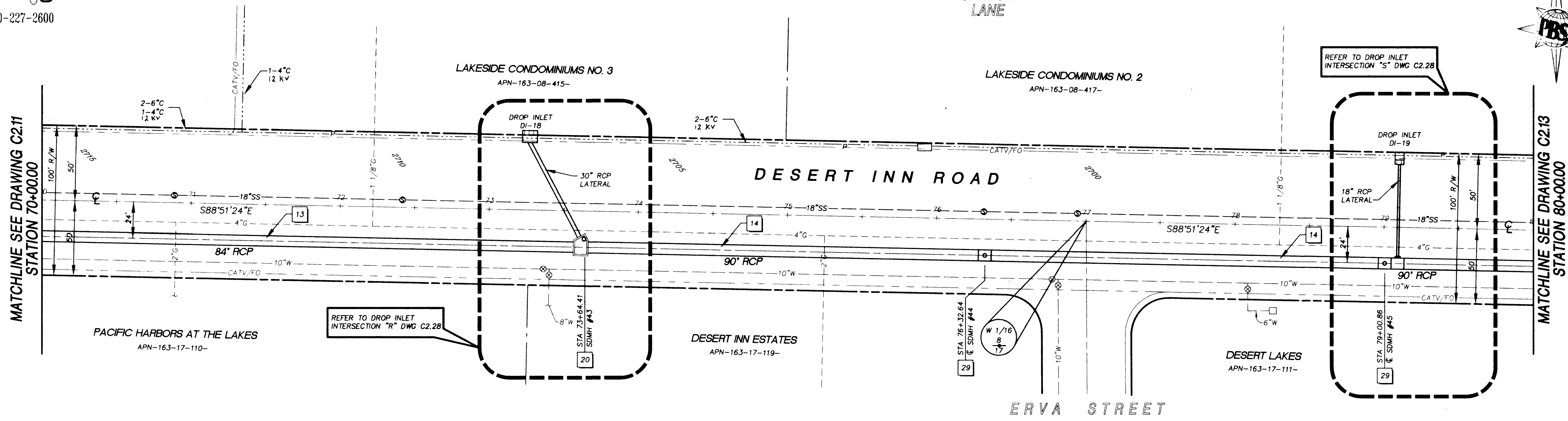

KEY NOTES

- 1) INSTALL 45"x28" HE RCP SD PER TRENCH SECTION 2 DWG C2.35
- 2) INSTALL 18" RCP SD PER TRENCH SECTION 2 DWG C2.35
- 3) INSTALL 24" RCP SD PER TRENCH SECTION 2 DWG C2.35
- 4) INSTALL 30" RCP SD PER TRENCH SECTION 2 DWG C2.35
- 5) INSTALL 36" RCP SD PER TRENCH SECTION 2 DWG C2.35
- 6) INSTALL 42" RCP SD PER TRENCH SECTION 2 DWG C2.35
- 7) INSTALL 48" RCP SD PER TRENCH SECTION 2 DWG C2.35
- 8) INSTALL 54" RCP SD PER TRENCH SECTION 2 DWG C2.35
- 9) INSTALL 60" RCP SD PER TRENCH SECTION 2 DWG C2.35
- 10) INSTALL 66" RCP SD PER TRENCH SECTION 2 DWG C2.35
- 11) INSTALL 72" RCP SD PER TRENCH SECTION 2 DWG C2.35
- 12) INSTALL 78" RCP SD PER TRENCH SECTION 2 DWG C2.35
- 13) INSTALL 84" RCP SD PER TRENCH SECTION 2 DWG C2.35
- 14) INSTALL 90" RCP SD PER TRENCH SECTION 2 DWG C2.35
- 15) INSTALL 96" RCP SD PER TRENCH SECTION 2 DWG C2.35
- 16) INSTALL 106"x68" HE RCP SD PER TRENCH SECTION 2 DWG C2.35
- 17) INSTALL 9"x6" RCB'S SD PER TRENCH SEC. 3 DWG C2.35 & SEC. C DWG S1.03
- 18) INSTALL TYPE I JUNCTION STRUCTURE PER DWG S1.02
- 19) INSTALL TYPE II JUNCTION STRUCTURE PER DWG S1.03
- 20) INSTALL TYPE III JUNCTION STRUCTURE PER DWG S1.04
- 21) INSTALL TYPE IV JUNCTION STRUCTURE PER DWG S1.05
- 22) INSTALL TYPE V JUNCTION STRUCTURE PER DWG S1.06
- 23) INSTALL TYPE VI JUNCTION STRUCTURE PER DWG S1.07
- 24) INSTALL TYPE VII JUNCTION STRUCTURE PER DWG S1.08
- 25) INSTALL TYPE I (60") SDMH PER USD #403
- 26) INSTALL TYPE II (48") SDMH PER USD #405
- 27) INSTALL TYPE III (60") SDMH PER USD #406
- 28) NOT USED
- 29) INSTALL PRECAST MANHOLE TEE W/48" RISER PER USD #407 (W/30" MIN. ACCESS)
- 30) INSTALL (48") ACCESS MANHOLE W/STEPS PER DETAIL 3 DWG S1.01 (IN EACH RCB)
- 31) INSTALL TYPE "CM" DROP INLET PER DETAIL 1 DWG C2.33
- 32) INSTALL TYPE "DM" DROP INLET PER DETAIL 2 DWG C2.33
- 33) INSTALL TYPE "A" DROP INLET PER USD #411
- 34) INSTALL MODIFIED TYPE "D" DROP INLET PER DETAIL 5 DWG C2.35
- 35) INSTALL 60"x18" PRECAST TEE
- 36) INSTALL 90"x18" PRECAST TEE
- 37) INSTALL 96"x18" PRECAST TEE
- 38) INSTALL 66" 45" PRECAST BEND & BACKFILL W/CONC. PER USD #407 (SIMILAR)
- 39) INSTALL 90" 45" PRECAST BEND & BACKFILL W/CONC. PER USD #407 (SIMILAR)
- 40) INSTALL 106"x68" 45" PRECAST BEND & BACKFILL W/CONC. PER USD #407 (SIMILAR)
- 41) INSTALL NEW RCP & PLUG EXISTING RCP PER DETAIL 5 & 6 DWG S1.01
- 42) INSTALL MODIFIED TYPE "A" DROP INLET W/SIDEWALK DRAIN PER DETAIL 3 DWG C2.33

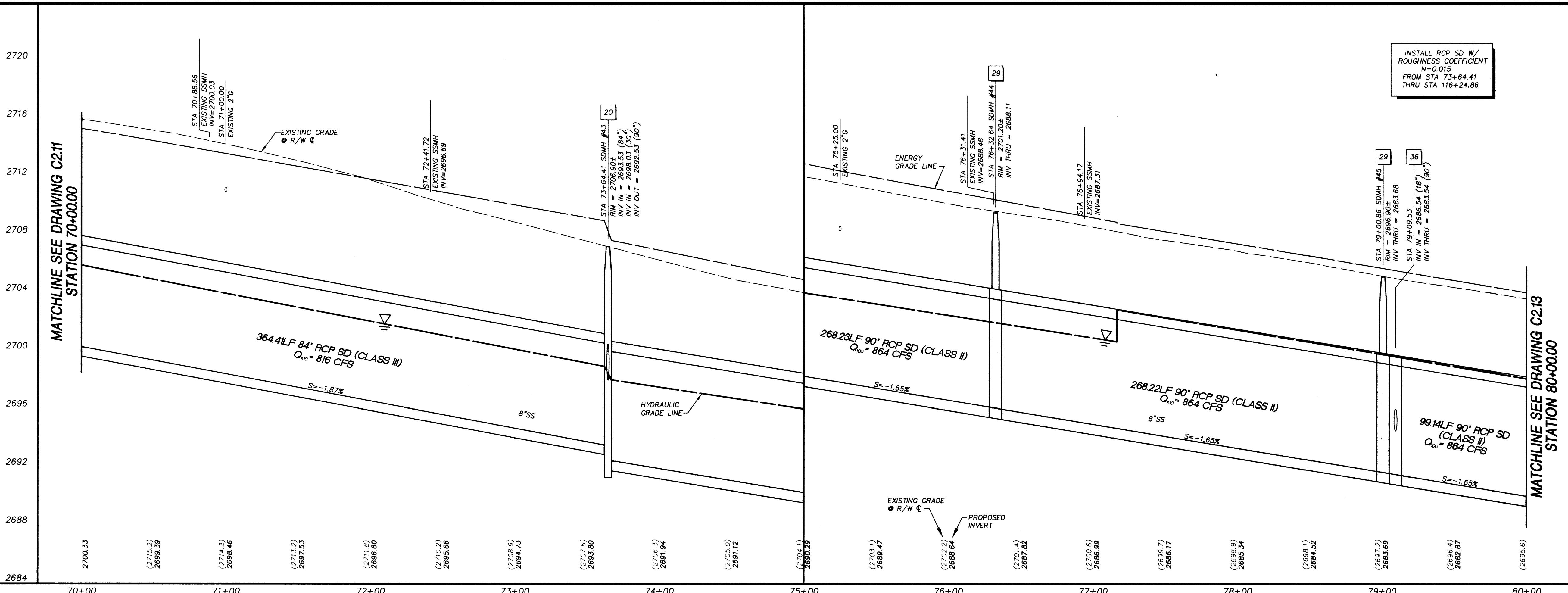

BASIS OF BEARING
THE BASIS OF BEARINGS FOR THIS PROJECT IS GRID NORTH AS DEFINED BY THE NEVADA COORDINATE SYSTEM OF 1983, EAST ZONE (2701), BASED UPON CLARK COUNTY GIS STATIONS 822, 838, AND 939, AS SHOWN ON A RECORD OF SURVEY ON FILE IN THE CLARK COUNTY, NEVADA RECORDER'S OFFICE, IN FILE 88 OF SURVEYS, AT PAGE 53.

BENCHMARK
CLARK COUNTY BENCHMARK 7C10 21NES
ELEVATION=747.125 METERS (2451.19 FEET) NAVD 1988.
RIVET AND SQUARE ALUMINUM PLATE IN CONCRETE FOUNDATION OF ELECTRICAL CABINET AT THE SOUTHWEST CORNER OF BUFFALO DRIVE AND FLAMINGO ROAD.

CAUTION:
EXISTING UTILITIES ARE LOCATED ON THE PLANS FROM A SEARCH OF AVAILABLE RECORDS. CONTRACTOR TO VERIFY LOCATIONS AND DEPTHS PRIOR TO CONSTRUCTION.

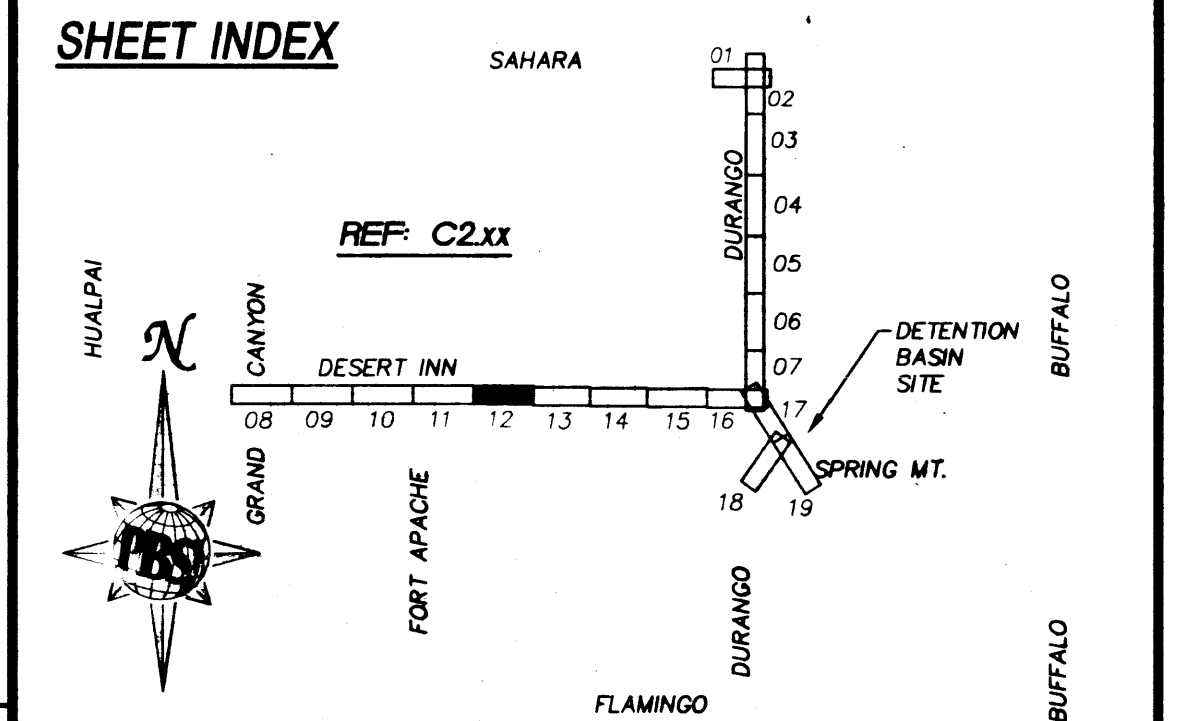

REVISIONS				
REV.	DESCRIPTION	BY	DATE	APPROVAL

DESIGNED BY: A. SPATA
DRAWN BY: A. SPATA
CHECKED BY: D. DAVIS
DATE: JULY 28, 1999

JOB NO.: 51516
DRAWING NO.: 516-3212
SCALE: HORIZ.: 1"=40'
VERT.: 1"=4'

PBS&J
ENGINEERING · PLANNING · SURVEYING · CONSTRUCTION SERVICES

901 North Green Valley Pkwy.
Suite 100
Henderson, Nevada 89014
Telephone: 702/263-7275
Fax: 702/263-7200

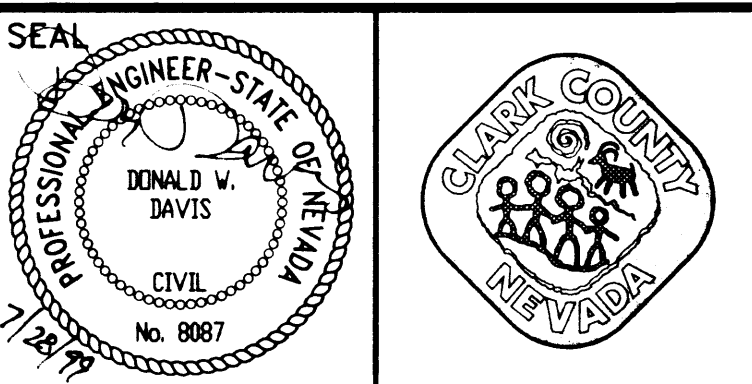

Department of Public Works

LAKES DETENTION BASIN & ASSOCIATED COLLECTION FACILITIES - PHASE 3

DESERT INN COLLECTION SYSTEM

PLAN AND PROFILE STA 70+00.00 TO STA 80+00.00

L-1583

DRAWING NO. 19
C2.12
77