

Call before you Dig  
1-800-227-2600

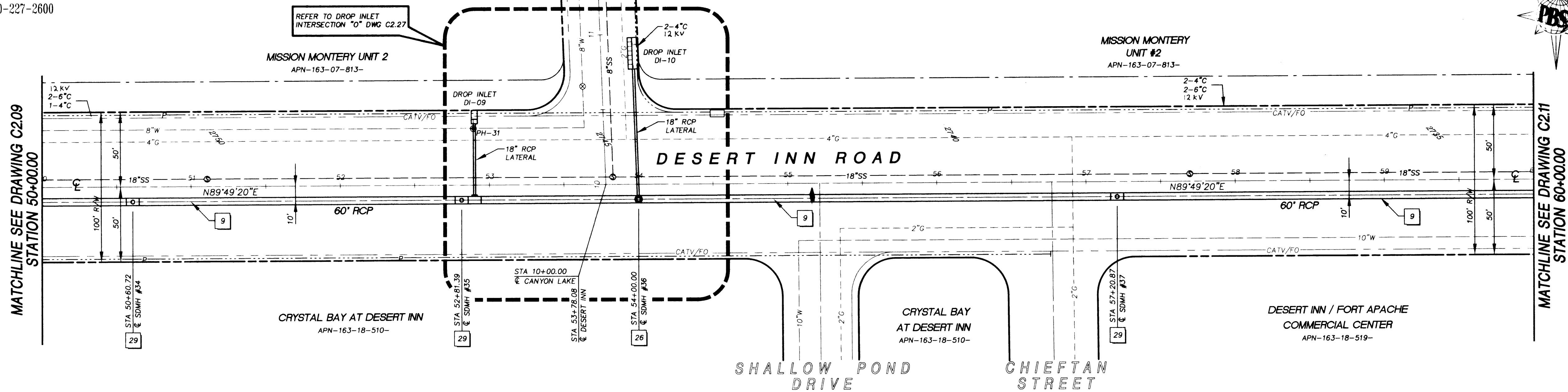

CANYON LAKE DRIVE

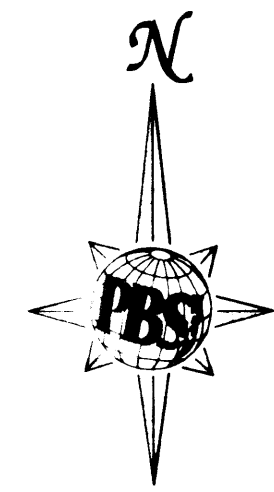

KEY NOTES

- 1 INSTALL 45"x29" HE RCP SD PER TRENCH SECTION 2 DWG C2.35
- 2 INSTALL 18" RCP SD PER TRENCH SECTION 2 DWG C2.35
- 3 INSTALL 24" RCP SD PER TRENCH SECTION 2 DWG C2.35
- 4 INSTALL 30" RCP SD PER TRENCH SECTION 2 DWG C2.35
- 5 INSTALL 36" RCP SD PER TRENCH SECTION 2 DWG C2.35
- 6 INSTALL 42" RCP SD PER TRENCH SECTION 2 DWG C2.35
- 7 INSTALL 48" RCP SD PER TRENCH SECTION 2 DWG C2.35
- 8 INSTALL 54" RCP SD PER TRENCH SECTION 2 DWG C2.35
- 9 INSTALL 60" RCP SD PER TRENCH SECTION 2 DWG C2.35
- 10 INSTALL 66" RCP SD PER TRENCH SECTION 2 DWG C2.35
- 11 INSTALL 72" RCP SD PER TRENCH SECTION 2 DWG C2.35
- 12 INSTALL 78" RCP SD PER TRENCH SECTION 2 DWG C2.35
- 13 INSTALL 84" RCP SD PER TRENCH SECTION 2 DWG C2.35
- 14 INSTALL 90" RCP SD PER TRENCH SECTION 2 DWG C2.35
- 15 INSTALL 96" RCP SD PER TRENCH SECTION 2 DWG C2.35
- 16 INSTALL 106"x68" HE RCP SD PER TRENCH SECTION 2 DWG C2.35
- 17 INSTALL 9"x6" RCB'S SD PER TRENCH SEC. 3 DWG C2.35 & SEC. C DWG S1.03
- 18 INSTALL TYPE I JUNCTION STRUCTURE PER DWG S1.02
- 19 INSTALL TYPE II JUNCTION STRUCTURE PER DWG S1.03
- 20 INSTALL TYPE III JUNCTION STRUCTURE PER DWG S1.04
- 21 INSTALL TYPE IV JUNCTION STRUCTURE PER DWG S1.05
- 22 INSTALL TYPE V JUNCTION STRUCTURE PER DWG S1.06
- 23 INSTALL TYPE VI JUNCTION STRUCTURE PER DWG S1.07
- 24 INSTALL TYPE VII JUNCTION STRUCTURE PER DWG S1.08
- 25 INSTALL TYPE I (60") SDMH PER USD #403
- 26 INSTALL TYPE II (48") SDMH PER USD #405
- 27 INSTALL TYPE III (60") SDMH PER USD #406
- 28 NOT USED
- 29 INSTALL PRECAST MANHOLE TEE W/48" RISER PER USD #407 (W/30" MIN. ACCESS)
- 30 INSTALL (48") ACCESS MANHOLE W/STEPS PER DETAIL 3 DWG S1.01 (IN EACH RCB)
- 31 INSTALL TYPE "CM" DROP INLET PER DETAIL 1 DWG C2.33
- 32 INSTALL TYPE "DM" DROP INLET PER DETAIL 2 DWG C2.33
- 33 INSTALL TYPE "A" DROP INLET PER USD #411
- 34 INSTALL MODIFIED TYPE "D" DROP INLET PER DETAIL 5 DWG C2.35
- 35 INSTALL 60"x18" PRECAST TEE
- 36 INSTALL 90"x18" PRECAST TEE
- 37 INSTALL 96"x18" PRECAST TEE
- 38 INSTALL 66" 45" PRECAST BEND & BACKFILL W/CONC. PER USD #407 (SIMILAR)
- 39 INSTALL 90" 45" PRECAST BEND & BACKFILL W/CONC. PER USD #407 (SIMILAR)
- 40 INSTALL 106"x68" 45" PRECAST BEND & BACKFILL W/CONC. PER USD #407 (SIMILAR)
- 41 INSTALL NEW RCP & PLUG EXISTING RCP PER DETAIL 5 & 6 DWG S1.01
- 42 INSTALL MODIFIED TYPE "A" DROP INLET W/SIDEWALK DRAIN PER DETAIL 3 DWG C2.33

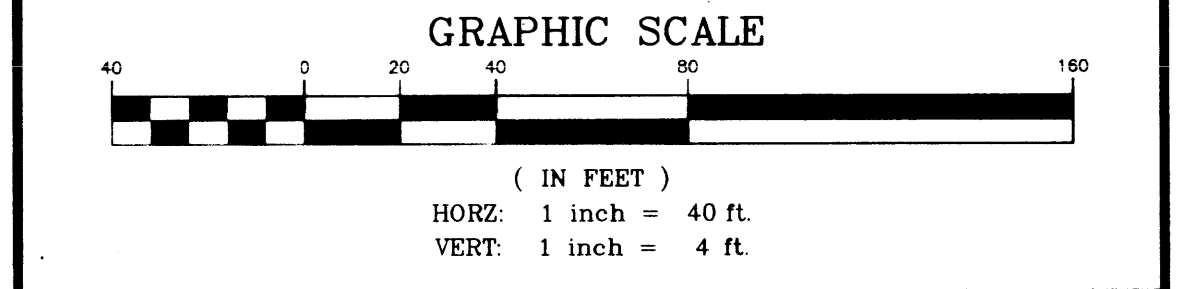
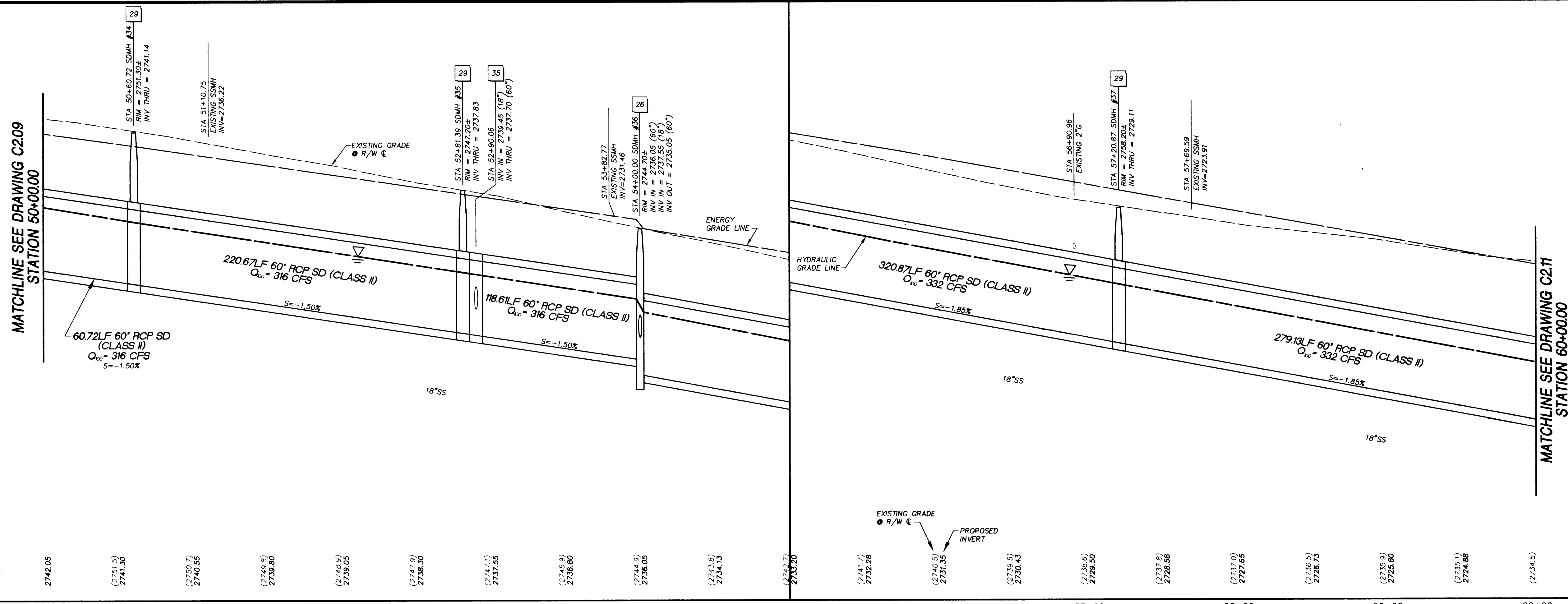

**BASIS OF BEARING**  
THE BASIS OF BEARINGS FOR THIS PROJECT IS GRID NORTH AS DEFINED BY THE NEVADA COORDINATE SYSTEM OF 1983, EAST ZONE (2701), BASED ON CLARK COUNTY GIS STATIONS 822, 838, AND 939, AS SHOWN ON A RECORD OF SURVEY ON FILE IN THE CLARK COUNTY, NEVADA RECORDER'S OFFICE, IN FILE #8 OF SURVEYS, AT PAGE 53.

**BENCHMARK**  
CLARK COUNTY BENCHMARK 7C10 21NES  
ELEVATION=747.125 METERS (2451.19 FEET) NAVD 1988  
RIVET AND SQUARE ALUMINUM PLATE IN CONCRETE FOUNDATION OF ELECTRICAL CABINET AT THE SOUTHWEST CORNER OF BUFFALO DRIVE AND FLAMINGO ROAD.

**CAUTION:**  
EXISTING UTILITIES ARE LOCATED ON THE PLANS FROM A SEARCH OF AVAILABLE RECORDS. CONTRACTOR TO VERIFY LOCATIONS AND DEPTHS PRIOR TO CONSTRUCTION.

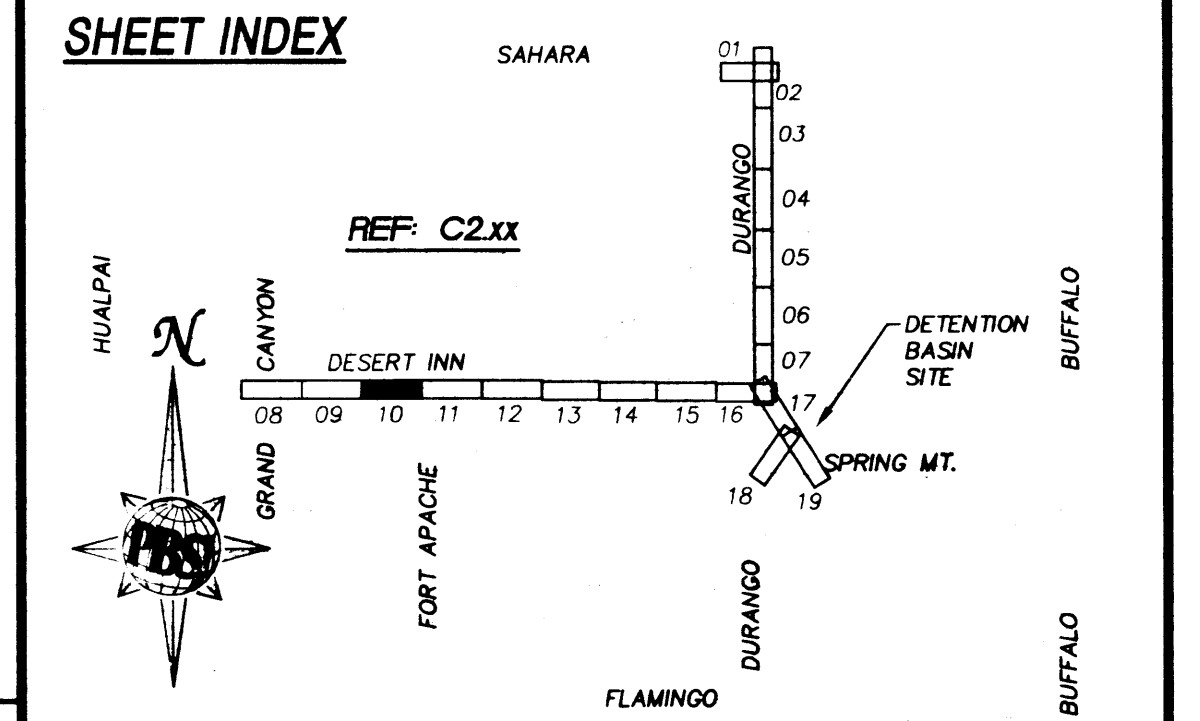

REVISIONS				
REV.	DESCRIPTION	BY	DATE	APPROVAL

DESIGNED BY:  
A. SPATA  
DRAWN BY:  
A. SPATA  
CHECKED BY:  
D. DAVIS  
DATE:  
JULY 28, 1999

JOB NO.:  
51516  
DRAWING NO.:  
516-3210  
SCALE:  
HORIZ.: 1"=40'  
VERT.: 1"=4'

901 North Green Valley Pkwy.  
Suite 100  
Henderson, Nevada 89014  
Telephone: 702/263-7275  
Fax: 702/263-7206

ENGINEERING · PLANNING · SURVEYING · CONSTRUCTION SERVICES

Department of Public Works

LAKES DETENTION BASIN & ASSOCIATED COLLECTION FACILITIES - PHASE 3

DESERT INN COLLECTION SYSTEM  
PLAN AND PROFILE STA 50+00.00 TO STA 60+00.00

L-1583

DRAWING NO. 17

C2.10