

FORT APACHE CONSTRUCTION IS REQUIRED ONLY IN THE EVENT THAT IRON Mtn. SPRING HAS NOT CONSTRUCTED FORT APACHE ROAD. OTHERWISE SEE SHEET C-28.

#19x30 ERCP was placed inside existing 2' of 36" at N.H. base

Call before you Dig.
1-800-227-2600
UNDERGROUND SERVICE (USA)

CALL BEFORE YOU DIG OVERHEAD
1-702-593-6111

No.	Delta	Radius	Tangent	Length
C1	90°00'00"	25.00'	25.00'	39.27'
C2	89°10'43"	25.00'	24.64'	38.91'
C3	87°22'49"	25.00'	16.67'	29.40'
C4	74°10'24"	25.00'	18.90'	32.36'
C5	90°39'59"	25.00'	25.29'	39.56'

NOTE:
INSTALL PIPELINE MARKER BALLS IN TRENCH ABOVE EACH HORIZONTAL ELBOW FITTING, PER MANUFACTURER'S INSTRUCTIONS.

**BRENT LANE - 'BL'
PLAN AND PROFILE**

SCALE: HORIZ. 1" = 30'
VERT. 1" = 3'

CONSTRUCTION NOTES

- CONSTRUCT COMMERCIAL DRIVEWAY, 8' WIDE VALLEY GUTTER, AND HANDICAP RAMP CASE I PER USDOCA DWG. NO. 222A, 228, & 235.
- MATCH EXISTING EDGE OF AC PAVING.
- CONSTRUCT TYPICAL STREET SECTION PER DETAIL HEREON.
- CONSTRUCT "L" TYPE CURB PER USDOCA DWG. NO. 216.
- CONSTRUCT 4" THICK SIDEWALK PER USDOCA NO. 234. SEE PLAN FOR WIDTH.
- INSTALL CUT OFF WALL PER DETAIL 7 SHEET C-19.
- INSTALL 3" TYPE "CM" DROP INLET PER DETAIL 2 SHEET C-20.
- INSTALL 18" H.D.P.E. STORM DRAIN PIPE.
- INSTALL 60" TYPE III MANHOLE PER USDOCA DWG. NO. 404 (POINT-A-MOUSSEON DUCTILE IRON LOOKING FRAME AND COVER FOR SSMH #5 AT STA: 22+81.40 "IM" ONLY).
- INSTALL BEND IN 12" WATER LINE WITH THRUST BLOCKS PER UDACS PLATE NO. 5. SEE PLAN FOR DEGREE.
- INSTALL 30" H.D.P.E. STORM DRAIN PIPE.
- INSTALL 24" H.D.P.E. STORM DRAIN PIPE.
- CONSTRUCT HANDICAP RAMP CASE I PER USDOCA DWG. NO. 235. SEE PLAN FOR A & B DIMENSIONS.
- CONSTRUCT HANDICAP RAMP CASE II PER USDOCA DWG. NO. 235.
- INSTALL 80" TYPE III MANHOLE PER USDOCA DWG. NO. 404 WITH NEENAH RIM & COVER MODEL #R-2540 OR EQUAL.
- INSTALL 12" GATE VALVE.
- INSTALL 8" PVC SANITARY SEWER.
- INSTALL 12" PVC WATER LINE.
- INSTALL 12" CAP WITH 2" BLOW OFF ASSEMBLY PER UDACS PLATE # 4.
- INSTALL STANDARD ECCENTRIC SANITARY SEWER MANHOLE PER DCSWCS DWG. SD-1.
- CONSTRUCT 21" TYPE "CM" DROP INLET PER DETAIL 2 SHEET C-20.
- REMOVE PROPOSED/EXISTING 10" SS STUB AND REPLACE WITH 8" SS.
- REMOVE CAP TO INSTALL 8" TEE W/ 8"x12" INCREASER. INSTALL 8" GATE VALVE, 10 LF=8" PVC WATERLINE STUB, AND REPLACE CAP & BLOWOFF AT END.
- INSTALL 12"x12" MECHANICAL JOINT WET TAPPING TEE WITH 12" TAPPING VALVE.
- INSTALL 24" CASING SLEEVE PER DETAIL 11 & 12 SHEET C-19.

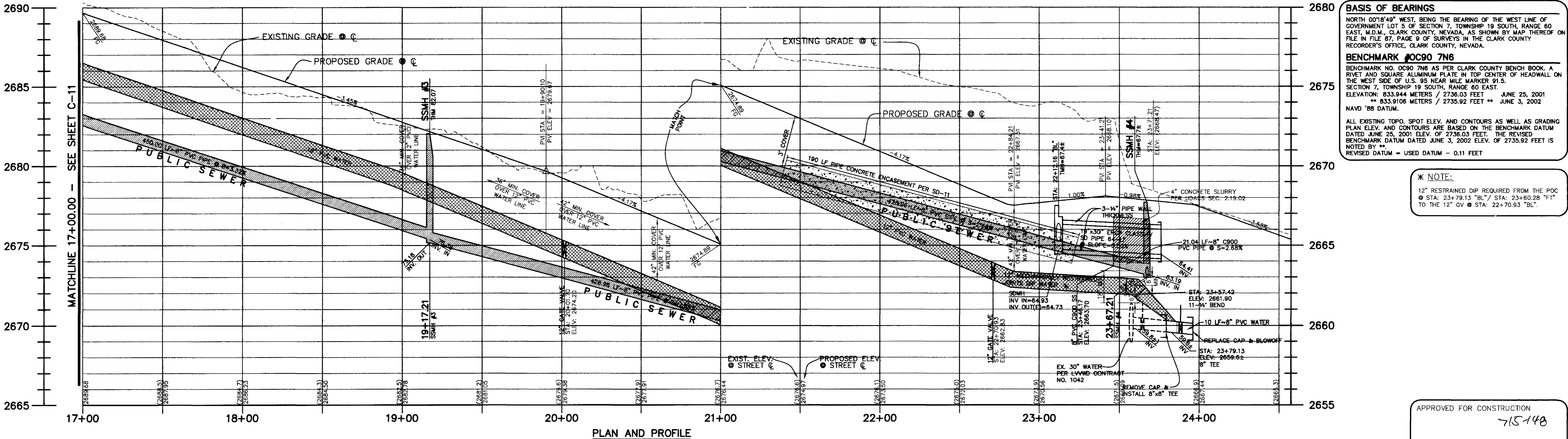
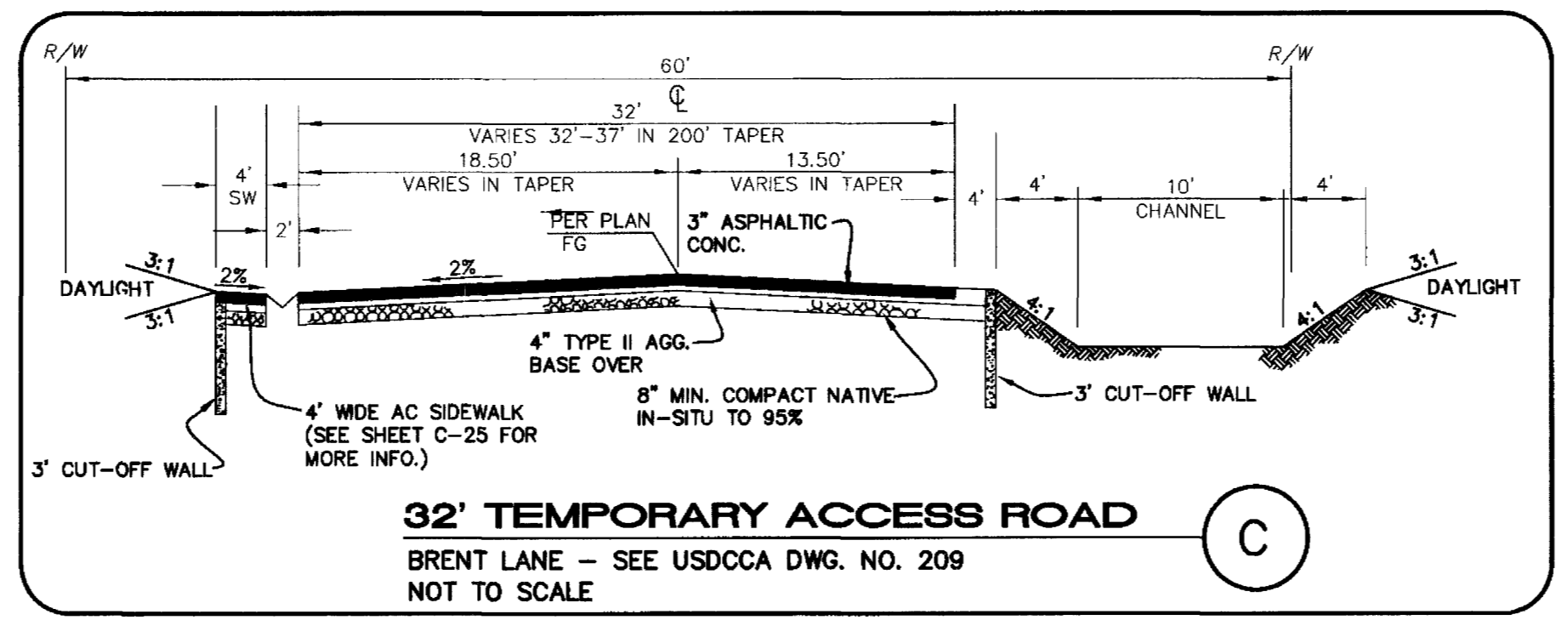
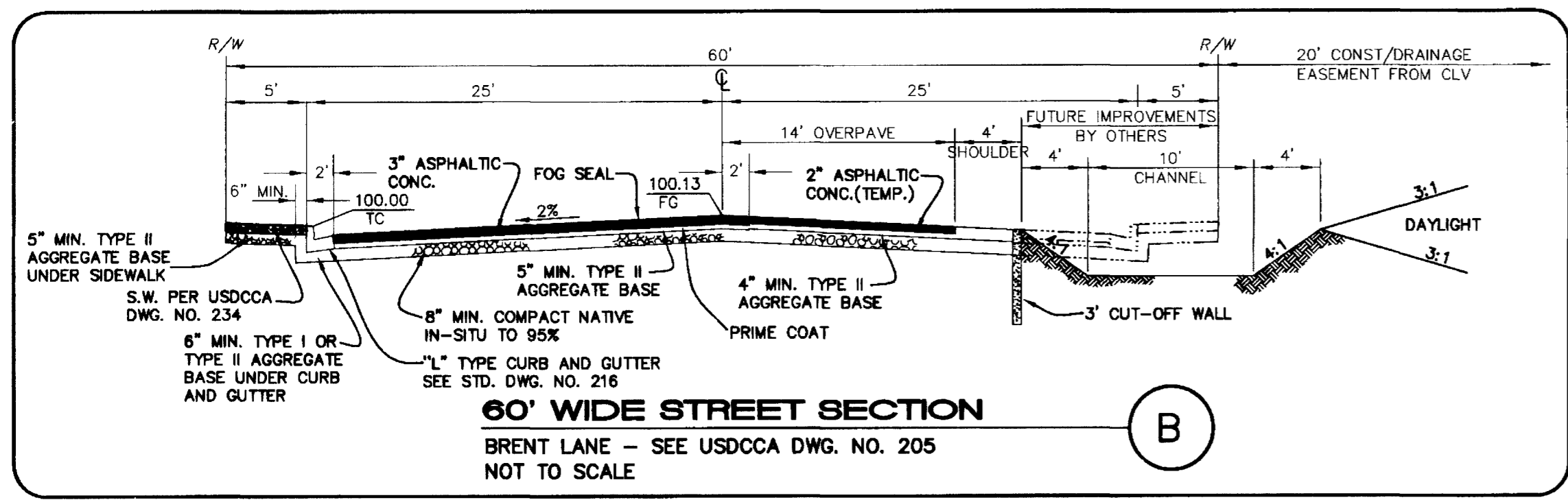

BASIS OF BEARINGS
NORTH 001°18'49" WEST, BEING THE BEARING OF THE WEST LINE OF GOVERNMENT LOT 5 OF SECTION 7, TOWNSHIP 19 SOUTH, RANGE 90 EAST, M.D.M., CLARK COUNTY, NEVADA, AS SHOWN BY MAP THEREOF ON FILE IN FILE 87, PAGE 9 OF SURVEYS IN THE CLARK COUNTY RECORDER'S OFFICE, CLARK COUNTY, NEVADA.

BENCHMARK #OC90 7N6
BENCHMARK NO. OC90 7N6 AS PER CLARK COUNTY BENCH BOOK, A RIVET AND SQUARE ALUMINUM PLATE IN TOP CENTER OF HEADWALL ON THE WEST SIDE OF U.S. 95 NEAR MILE MARKER 91.5. SECTION 7, TOWNSHIP 19 SOUTH, RANGE 90 EAST. ELEVATION: 833.944 METERS / 2736.03 FEET JUNE 25, 2001 ** 833.9106 METERS / 2735.92 FEET ** JUNE 3, 2002 NAVD '88 DATUM.

ALL EXISTING TOPO, SPOT ELEV. AND CONTOURS AS WELL AS GRADING PLAN ELEV. AND CONTOURS ARE BASED ON THE BENCHMARK DATUM DATED JUNE 25, 2001 ELEV. OF 2736.03 FEET. THE REVISED BENCHMARK DATUM DATED JUNE 3, 2002 ELEV. OF 2735.92 FEET IS NOTED BY **.

REVISED DATUM = USED DATUM - 0.11 FEET

* NOTE:
12" RESTRAINED DIP REQUIRED FROM THE POC @ STA: 23+79.13 "BL"/ STA: 23+60.28 "F" TO THE 12" GV @ STA: 22+70.93 "BL".

APPROVED FOR CONSTRUCTION
715-148
LAS VEGAS VALLEY WATER DISTRICT DATE

ISSUED FOR RECORD DRAWINGS

DESIGN: _____
DRAWN: _____
CHECK: _____
ISSUE DATE: _____
PLOT DATE: 11-10-03
PLOT TIME: 15:06:50

G. C. WALLACE, INC.
Engineers/Planners/Surveyors
1555 SOUTH RAINBOW BLVD., LAS VEGAS, NEVADA 89146
TELEPHONE: 702-799-2000 • FAX: (702) 804-2299
G:\6109-283\Draw\APACHE\BBS0212.dwg

JAMES H. BILBRAY ELEMENTARY SCHOOL
CLARK COUNTY SCHOOL DISTRICT
BRENT LANE - PLAN AND PROFILE I
STA: 17+00.00 TO 24+00.00

SHEET
C-12
13 OF 31 SHEETS