

- NOTES:
- 1) ALL COMPONENTS SHALL BE SQUARE POST, PERFORATED ON ALL FOUR SIDES.
 - 2) ATTACH ANCHOR AND SLEEVE TOGETHER PRIOR TO DRIVING INTO GROUND. LEAVE AT LEAST ONE HOLE, BUT NO MORE THAN TWO, ABOVE GROUND OR ABOVE SIDEWALK.
 - 3) FOR SIDEWALK INSTALLATION, DRILL SIDEWALK WITH A 3" HOLE, THE CENTER TO BE 6" FROM BACK OF SIDEWALK.
 - 4) ATTACH POST TO ANCHORING SYSTEM BY USING AT LEAST TWO 3/8" DIA DRIVE RIVETS.
 - 5) PROVIDE 4" MINIMUM LAP BETWEEN POST AND THE ANCHOR/SLEEVE ASSEMBLY.

A SIGN POST INSTALLATION
NOT TO SCALE

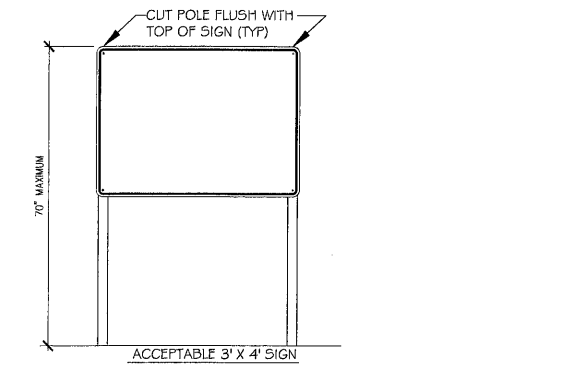
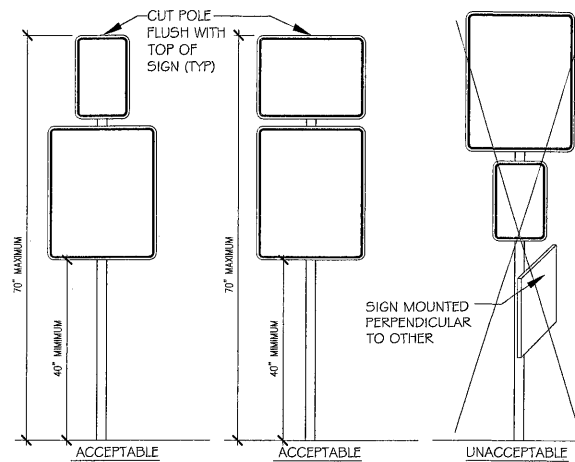

- NOTES:
- 1) SIGNS ATTACHED TO FENCE SHALL BE LEFT SIDE JUSTIFIED WITH EACH OTHER.
 - 2) SIGNS MOUNTED ON GATES SHALL BE CENTERED ON WIDTH OF GATE.
 - 3) NO POST MOUNTED SIGNS SHALL BE INSTALLED PERPENDICULAR TO EACH OTHER.
 - 4) SIGNS MOUNTED BACK TO BACK MUST BE THE SAME SIZE AND ORIENTATION.
 - 5) FENCE MOUNTED SIGNS SHOULD NOT HAVE ANY BOLTS, FASTENERS, OR OTHER SHARP EDGES ON THE FIELD SIDE OF ANY FENCE.

B TYPICAL SIGN MOUNTING
NOT TO SCALE

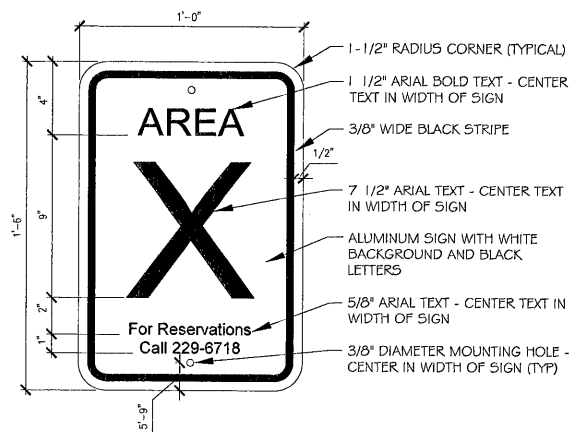

C SITE SHELTER RESERVATION SIGN
NOT TO SCALE

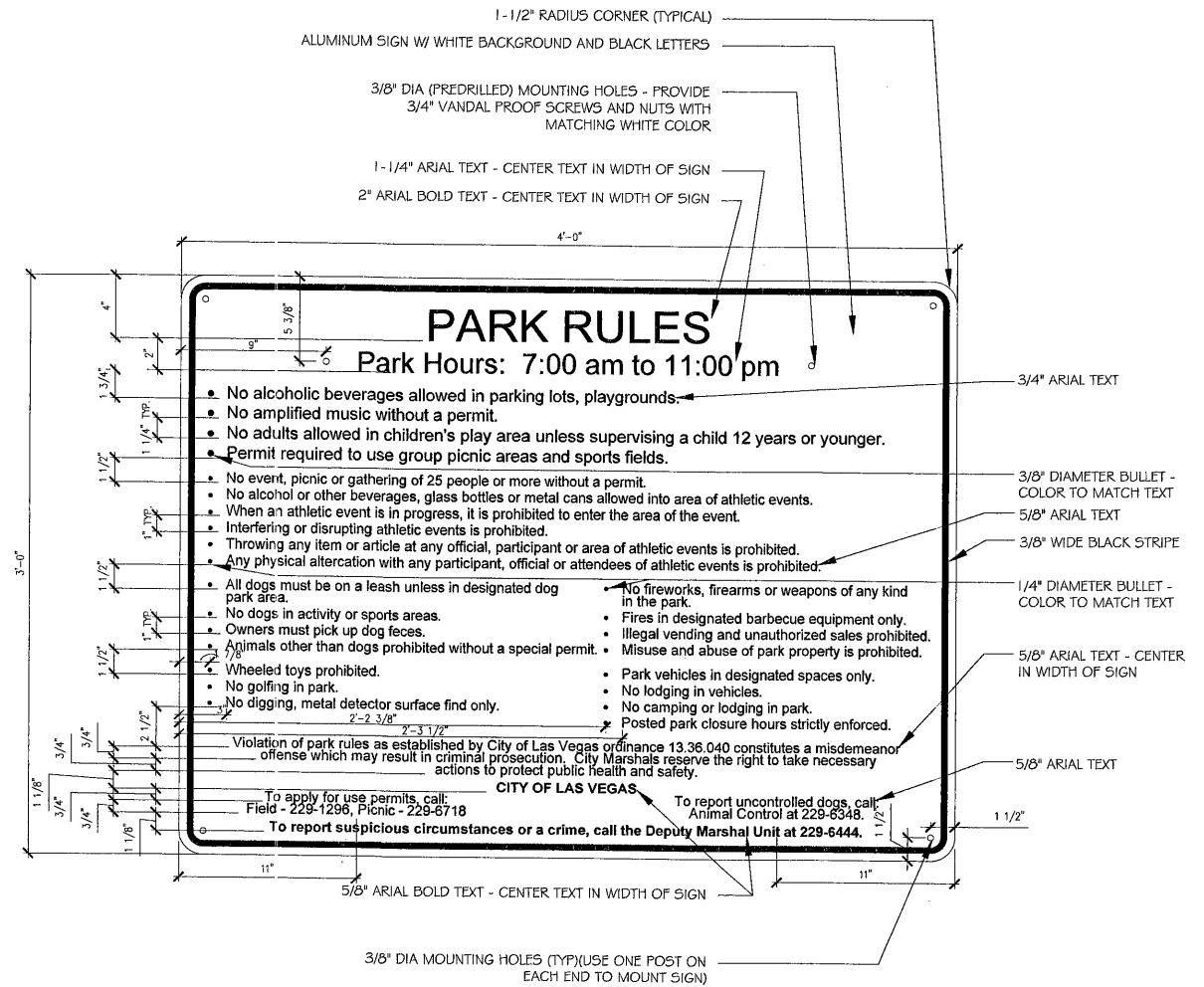

D PARK RULES SIGN
NOT TO SCALE

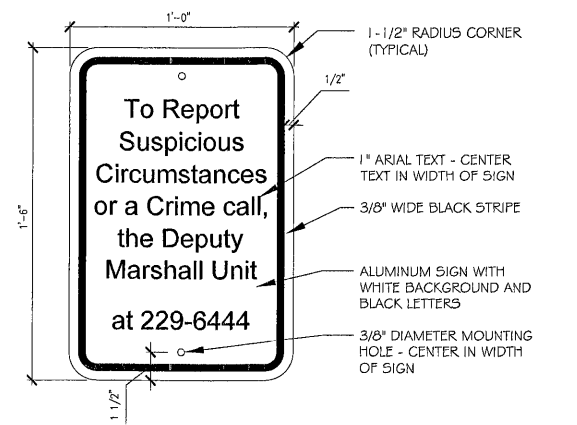

E REPORT VANDALISM SIGN
NOT TO SCALE

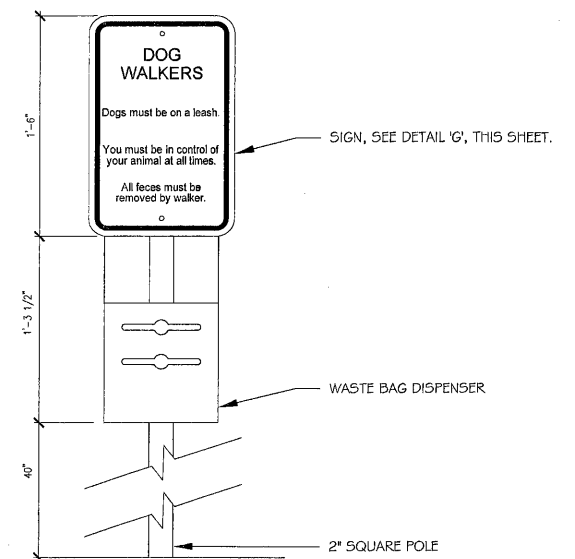

F DOG SIGN WITH BAG DISPENSER
NOT TO SCALE

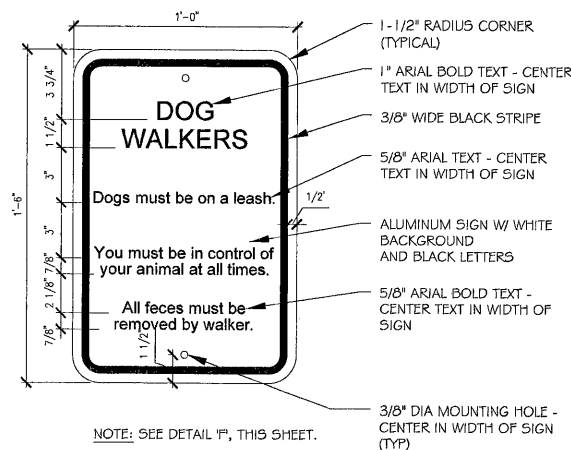

G DOG SIGN
NOT TO SCALE

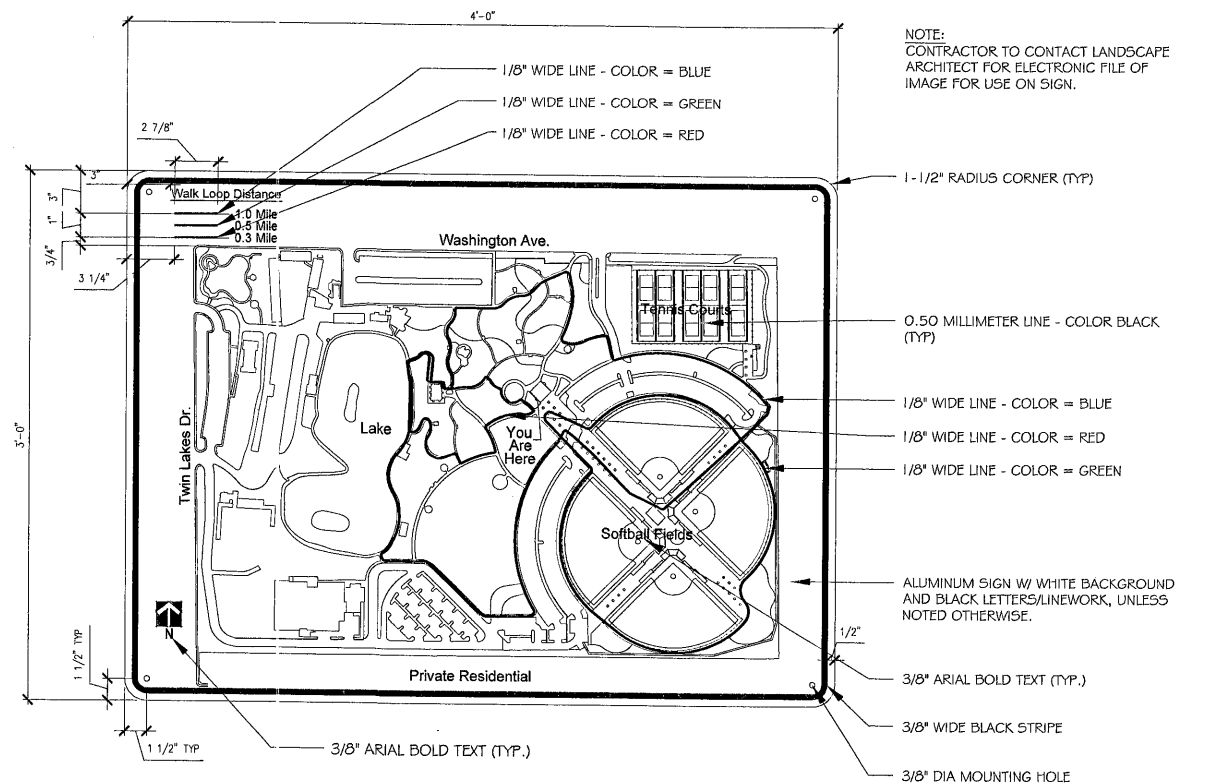

H WALK LOOP TRAIL SIGN
NOT TO SCALE

southwick LA
702.597.3108
12 Commerce Center Drive
Henderson, NV, 89014
www.southwickla.com

Lorenzi Park Renovations
Phase 1
SITE DETAILS

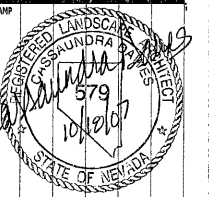

OWNER: CITY OF LAS VEGAS
DEPARTMENT OF PUBLIC WORKS
ARCHITECTURAL SERVICES

400 EAST STEWART AVENUE
LAS VEGAS, NEVADA 89103
PHONE: (702) 229-5335
FAX: (702) 388-4848
TDD: (702) 386-9108

DATE: JUNE 2007
SCALE: AS SHOWN
SHEET NO: 01B3401
DRAWING NO: 650194T

15.08