

SITE PLAN

AIA

217 GARCES LAS VEGAS

ARCHITECT WILLIAM SIMPSON

DATE: 11-16-68

SHEET

2

6820

10

TWIN LAKES DRIVE

WASHINGTON AVENUE

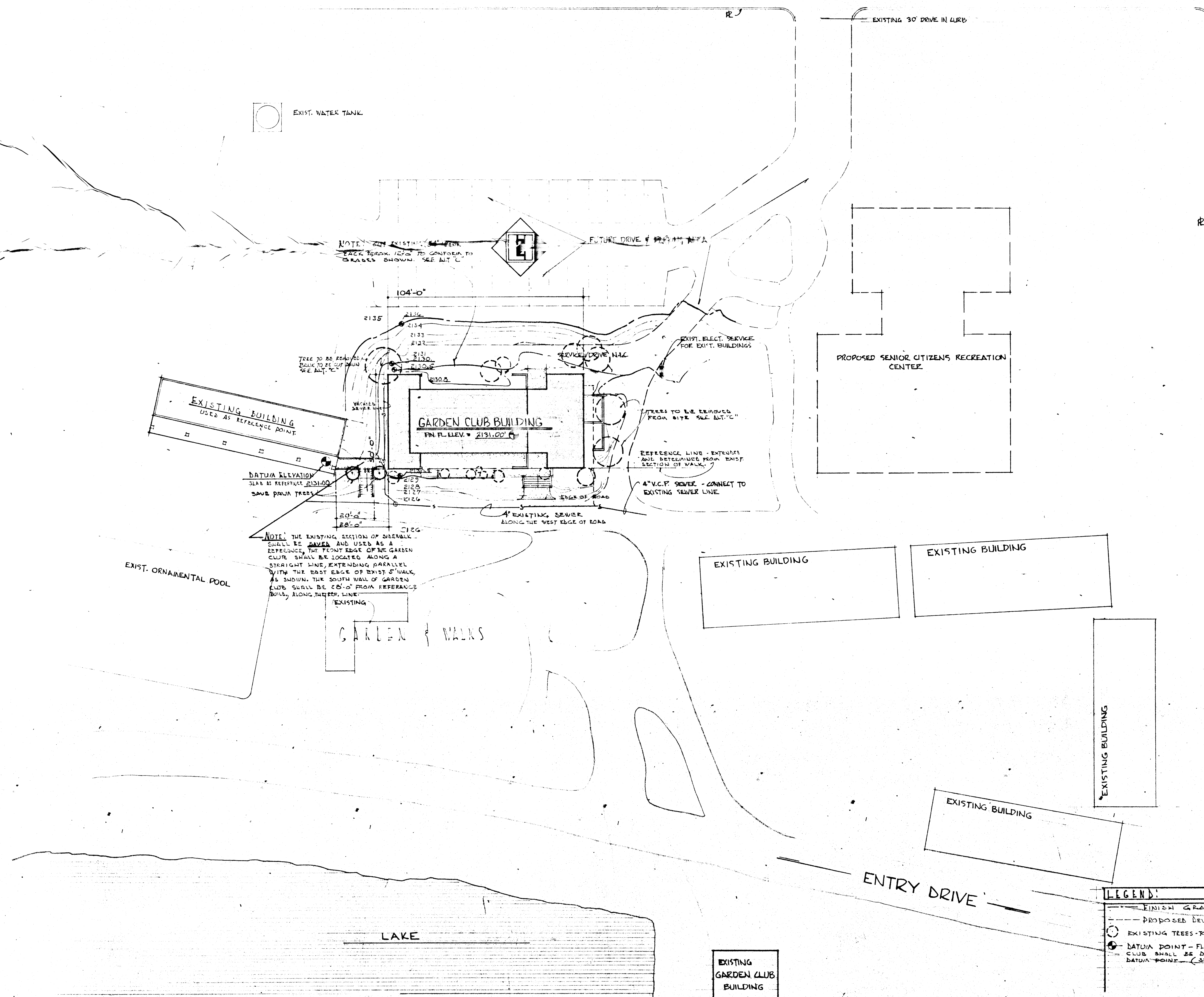

EXIST. WATER TANK

NOTE: 20' EXISTING DRIVE BACK APPROX. 120' TO CONFORM TO GRABES SHOWN. SEE AIT 'C'

FUTURE DRIVE # 199' AT 11' FA

EXISTING 30' DRIVE IN CURB

TREE TO BE REMOVED AS SHOWN TO BE CUT FROM SEE AIT 'C'

EXIST. ELECT. SERVICE FOR EXIST. BUILDINGS

SERVICE DRIVE, N.A.C.

PROPOSED SENIOR CITIZENS RECREATION CENTER

EXISTING BUILDING USED AS REFERENCE POINT

GARDEN CLUB BUILDING FIN. FL. LLEV. = 2131.00'

TREES TO BE REMOVED FROM SITE SEE AIT 'C'

REFERENCE LINE - EXTENTS AND DETERMINED FROM EXIST. SECTION OF WALK

4" V.C.P. SEWER - CONNECT TO EXISTING SEWER LINE

DATUM ELEVATION SLAB AT REFERENCE POINT 2131.00'

SAVE PRUNY TREES

EXISTING SEWER ALONG THE WEST EDGE OF ROAD

NOTE: THE EXISTING SECTION OF SIDEWALK SHALL BE SAVED AND USED AS A REFERENCE. THE FRONT EDGE OF THE GARDEN CLUB SHALL BE LOCATED ALONG A STRAIGHT LINE, EXTENDING PARALLEL WITH THE EAST EDGE OF EXIST. WALK, AS SHOWN. THE SOUTH WALL OF GARDEN CLUB SHALL BE 25'-0" FROM REFERENCE BUILD. ALONG THIS REF. LINE

EXIST. ORNAMENTAL POOL

GARDEN WALKS

EXISTING BUILDING

EXISTING BUILDING

EXISTING BUILDING

EXISTING BUILDING

ENTRY DRIVE

LAKE

EXISTING GARDEN CLUB BUILDING

LEGEND:
--- FINISH GRADYS
--- PROPOSED DEVELOPMENTS
○ EXISTING TREES - TO BE REMOVED 4" DIA.
● DATUM POINT - FLOOR SLAB OF GARDEN CLUB SHALL BE DETERMINED FROM DATUM POINT (SLAB OF EXIST. BUILDING)

SITE PLAN

1" = 20.00'

3828

AS BUILT

650-19-12 (Rott 7/6/2-3C)