

CONDUCTOR SCHEDULE										
CONDUCTOR TYPE	FUNCTION	1	2	3	4	5	6	7	8	9
#10 AWG	PHOTOELECTRIC CONTROL UNIT		3			6	3	3		6
#8 AWG	OUTLET SERVICE (WHT & BLU)	2					2	6		2
#8 AWG	NEUTRAL (GREEN)	1	1	1		2	1	3	1	1
#4 AWG	ELECTRICAL SERVICE	2	2	2		4	2	6	2	4
#3/0 AWG	ELECTRICAL SERVICE POINT CONNECTION				3					
PULLROPE	SPARE									
	CONDUIT SIZE	2"	2"	1 1/4"	2"	2"	2"	2"	2"	2"

STREETLIGHT CONDUIT ALONG 4TH STREET SHALL BE PLACED 5' MIN. BEHIND CURB. SEE SLEEVE DETAIL, SHEET E-1.

EXIST. CONDUIT. CONTRACTOR SHALL VERIFY CONDITION OF EXIST. CONDUIT PRIOR TO PERFORMING ANY WORK. CONTRACTOR SHALL REPAIR SAID CONDUIT AS NEEDED.

EXISTING CLV PAD MOUNTED SERVICE ENCLOSURE #334 TO BE REMOVED BY CLV. MAINTAIN EXISTING LIGHT FIXTURE AND CONDUIT RUNS.

DO NOT CONNECT CONDUCTORS AT EITHER END. MAINTAIN EXISTING LIGHT FIXTURE AND CONDUIT RUN.

12 EXIST. FIXT. TO CLV #349 LOCATED IN FIRST ALLEY EAST OF LAS VEGAS BLVD ON THE SOUTH SIDE OF PARK PASEO

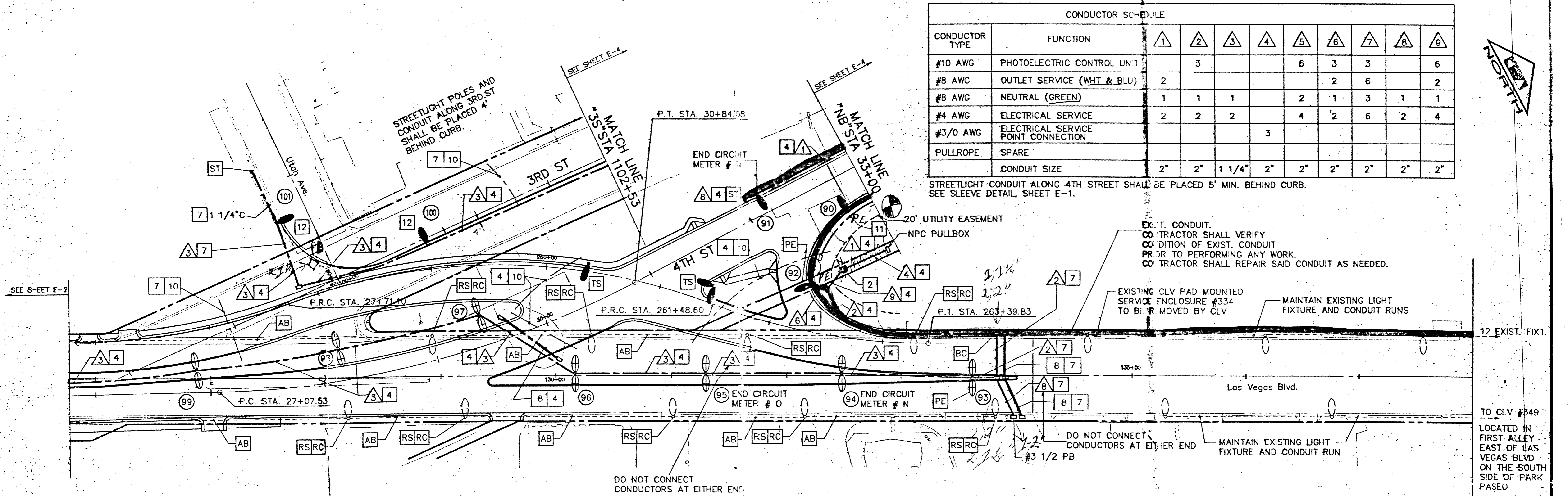

**CONSTRUCTION NOTES**

- 2 CIRCUIT #N  
INSTALL 120V/240V, SINGLE PHASE, THREE WIRE, SINGLE METERED SERVICE WITH A 200A, 240V, 2P MAIN CB IN A PAD MOUNTED NEMA TYPE 3R ENCLOSURE (REFER TO UNIFORM STD. DWG. #328). PROVIDE THE FOLLOWING:
  - TWO 60A, 240V, 2P BRANCH CB FOR STREET LIGHTING.
  - ONE 15A, 120V, 1P BRANCH CB FOR EACH LIGHTING TEST SWITCH.(ONE TEST SWITCH PER CONTACTOR)
  - TWO 60A, 2P CONTACTORS FOR STREET LIGHTING.
  - ONE 60A, 120V, 1P BRANCH CB FOR TRAFFIC.
  - ONE 30A, 120V, 1P BRANCH CB FOR TRAFFIC.
 LIGHTING CONTACTORS FOR STREET LIGHTING SHALL BE TIED INTO NEW STREET LIGHTING PEU AT POLE (92) AND (93).  
 CONTRACTOR SHALL PROVIDE ALL LABOR AND EQUIPMENT NECESSARY FOR SERVICE CONNECTION INCLUDING CONDUIT AND CONDUCTORS UP TO TRANSFORMER. PROVIDE ADDITIONAL 2" CONDUIT STUB FROM CONTROLLER FOR FUTURE USE.
- 4 TRENCH CONDUIT IN SOIL.
- 6 INSTALL 1 1/4" C AND CONNECT TO EXISTING STREET LIGHT STUB SOUTH OF OAKLEY BLVD. INSTALLED BY OTHERS.
- 7 TRENCH CONDUIT IN EXISTING PAVEMENT OR SIDEWALK.
- 8 INSTALL 2-2" & 1 1/4" PVC (SCH 40) CONDUIT WITH PULL ROPE AND # 3 1/2 PULLBOX AT EACH END. PLUG ENDS TO THE SATISFACTION OF THE ENGINEER.
- 10 INSTALL 2-4" PVC (SCH 40) IRRIGATION SLEEVES AND 2-2" PVC (SCH 40) ELECTRICAL SLEEVES WITH PULL ROPE. EXTEND SLEEVES MIN. 3' BEHIND CURB OR AS DIRECTED BY THE ENGINEER. TAPE ENDS AND MARK LOCATION ON CURB
- 11 INSTALL 2-4" NEVADA POWER CONDUITS WITH PULL ROPE AND PULLBOXES PER NEVADA POWER SPECIFICATIONS..
- 12 INSTALL STREETLIGHT STANDARD AND FOUNDATION PER STD. DWG. #S 309 AND 317 & 318 WITH LIGHTING FIXTURE AS SHOWN IN POLE SCHEDULE, SHEET E-6. INSTALL POLES 4' BEHIND CURB.

- AD ABANDON SYSTEM.
- BC INSTALL TYPE 3 1/2 PB IN EXISTING CONDUIT RUN. SPLICE AND COIL EXISTING CONDUCTORS PER UNIFORM STANDARD SPECIFICATION 623G.03.07.
- CB INSTALL PROPOSED CONDUIT INTO EXISTING PULL BOX.
- PE INSTALL NEW FIXTURE WITH PEU.
- RC EXISTING LIGHT POLE FOUNDATION TO BE CUT A MINIMUM OF 18" BELOW GRADE AND THE ANCHOR BOLTS BURNED OFF AT THE SAME 18" DEPTH.
- RS REMOVE AND SALVAGE LIGHT POLE, MAST ARM, FIXTURE AND EXISTING CONDUCTORS TO CLV ELECTRIC YARD.
- SN SPLICE NEW CONDUCTORS.
- ST STUB AND CAP CONDUIT.
- TS TRAFFIC SIGNAL LUMINAIRE; NOT A PART OF STREET LIGHT CIRCUITS.

SERVICE ENCLOSURE # N (PROPOSED)  
120/240V, SINGLE PHASE, THREE WIRE, SINGLE METER SERVICE  
200A, 240V, 2P MAIN CIRCUIT BREAKER

POSITION	BRANCH CIRCUIT BREAKER			FUNCTION	CURRENT	# OF POLES	ADDITIONAL COMPONENTS		STREET LIGHT LOAD (VA)	TREE PIT LIGHT LOAD (VA)	NEW ELEMENTS CONNECTED TO CIRCUIT
	CURRENT	VOLTAGE	# OF POLES				STATUS	FUNCTION			
1	60A	240V	2	STREET LIGHTING	60A	2	NORMALLY OPEN	CONTACTOR	6000	-	93, 94, AND 12 EX. LIGHTS ON WEST SIDE OF LAS VEGAS BLVD
2	-	-	-	STREET LIGHTING	-	-	-	-	-	-	-
3	15A	120V	1	LIGHTING TEST SWITCH	-	-	-	-	-	-	ACTIVATES CONTACTORS FOR STREET LIGHTS.
4	60A	240V	2	STREET LIGHTING	60A	2	NORMALLY OPEN	CONTACTOR	6240	-	80, 81, 82, 83, 84, 85, 86, 90, 91, 92
5	-	-	-	STREET LIGHTING	-	-	-	-	-	-	-
6	60A	120V	1	TO BE DETERMINED	-	-	-	-	-	-	FOR OTHER APPLICATIONS AS REQUESTED BY CLV
7	30A	120V	1	TO BE DETERMINED	-	-	-	-	-	-	FOR OTHER APPLICATIONS AS REQUESTED BY CLV
8	20A	120V	1	OUTLET	20A	1	-	-	-	-	MAX LOAD PER OUTLET = 0.47 A (GIVEN #8 AWG CONDUCTORS)

**ELECTRIC LOAD TABLE**

Avoid cutting underground utility lines. It's costly.  
**Call before you Dig.**  
1-800-227-2600  
UNDERGROUND SERVICE MAP (USM)

NO. 45763	REVISIONS	DATE	BY			DESIGNED BY RKS		DOWNTOWN CORRIDOR IMPROVEMENTS CITY OF LAS VEGAS DEPT. OF PUBLIC WORKS LAS VEGAS, NEVADA	CONTRACT 2 - 4TH STREET OAKLEY BLVD. TO CHARLESTON BLVD.	DATE 6/96  SCALE 1"=40'	DWG. NO. 107-V-2288B FILE NO. 9903.02 SHEET 43 OF 46 <b>E-3</b>
						DRAWN BY CPT/PPG					