

"ER" 25+28.04, 9.18' RT TO "ER" 25+28.81, 50' LT
 LATERAL "A"

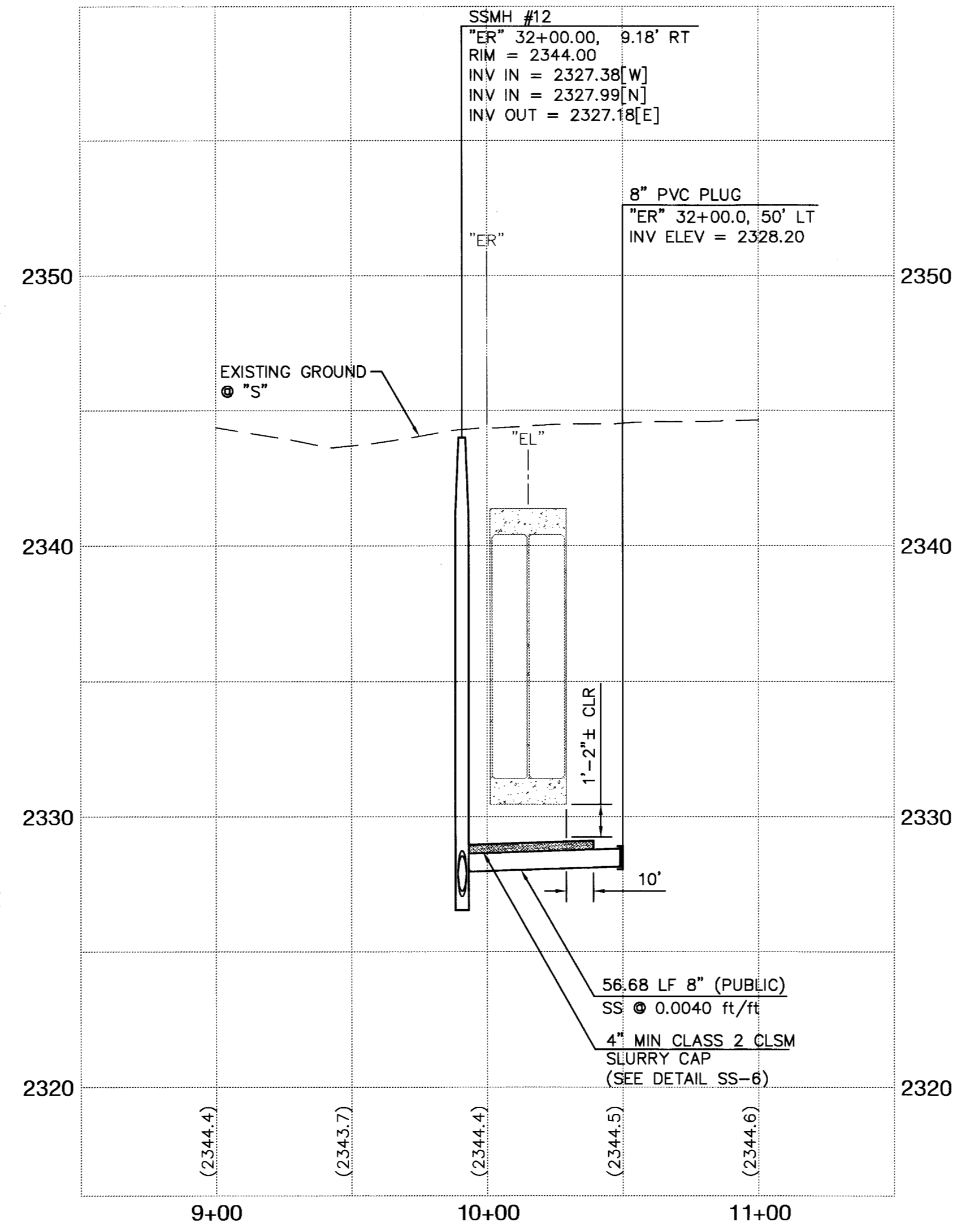

"ER" 32+00.00, 9.18' RT TO "ER" 32+00.00, 50' LT
 LATERAL "B"

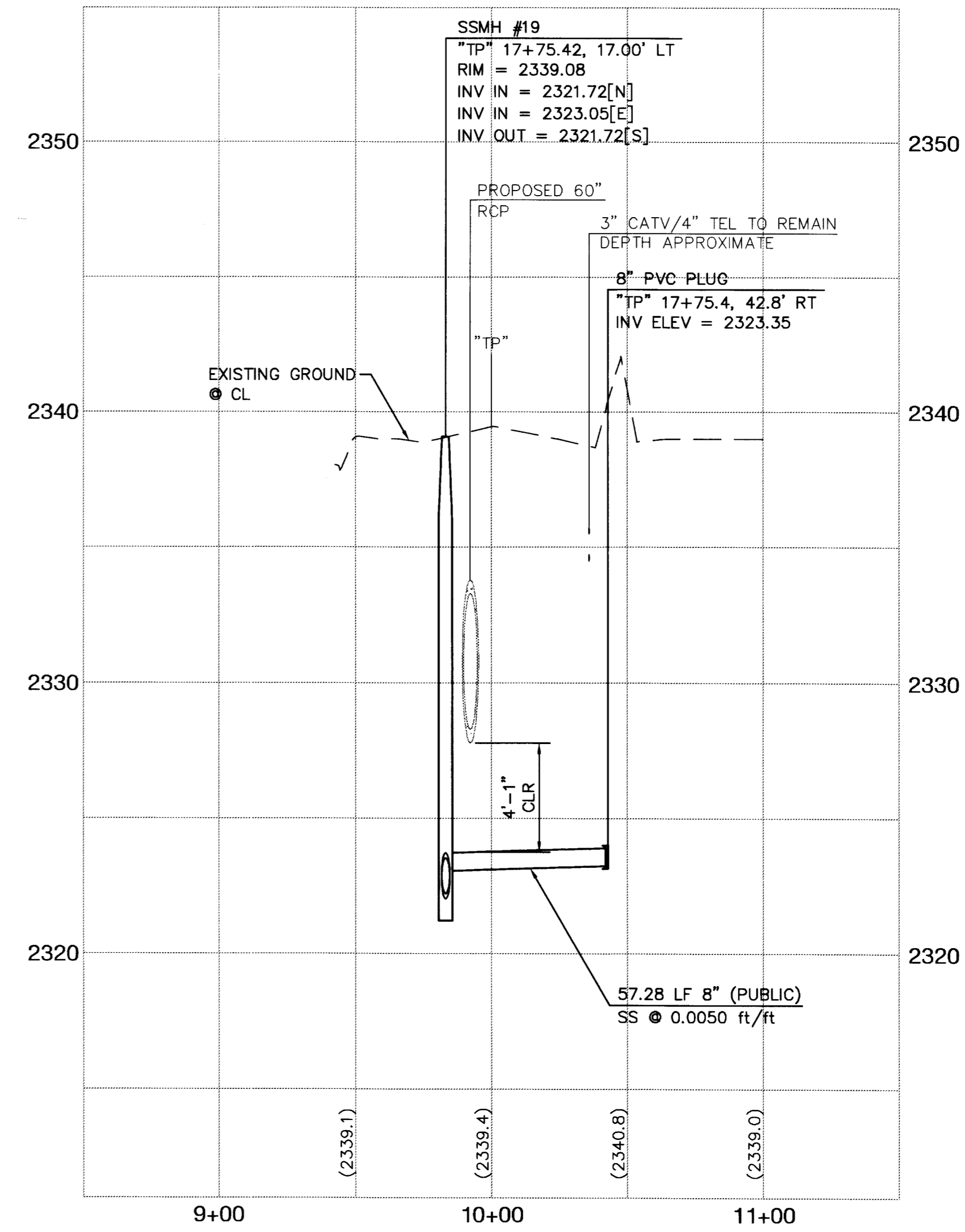

"TP" 17+75.42, 17.00' LT TO "TP" 17+75.42, 42.78' RT
 LATERAL "C"

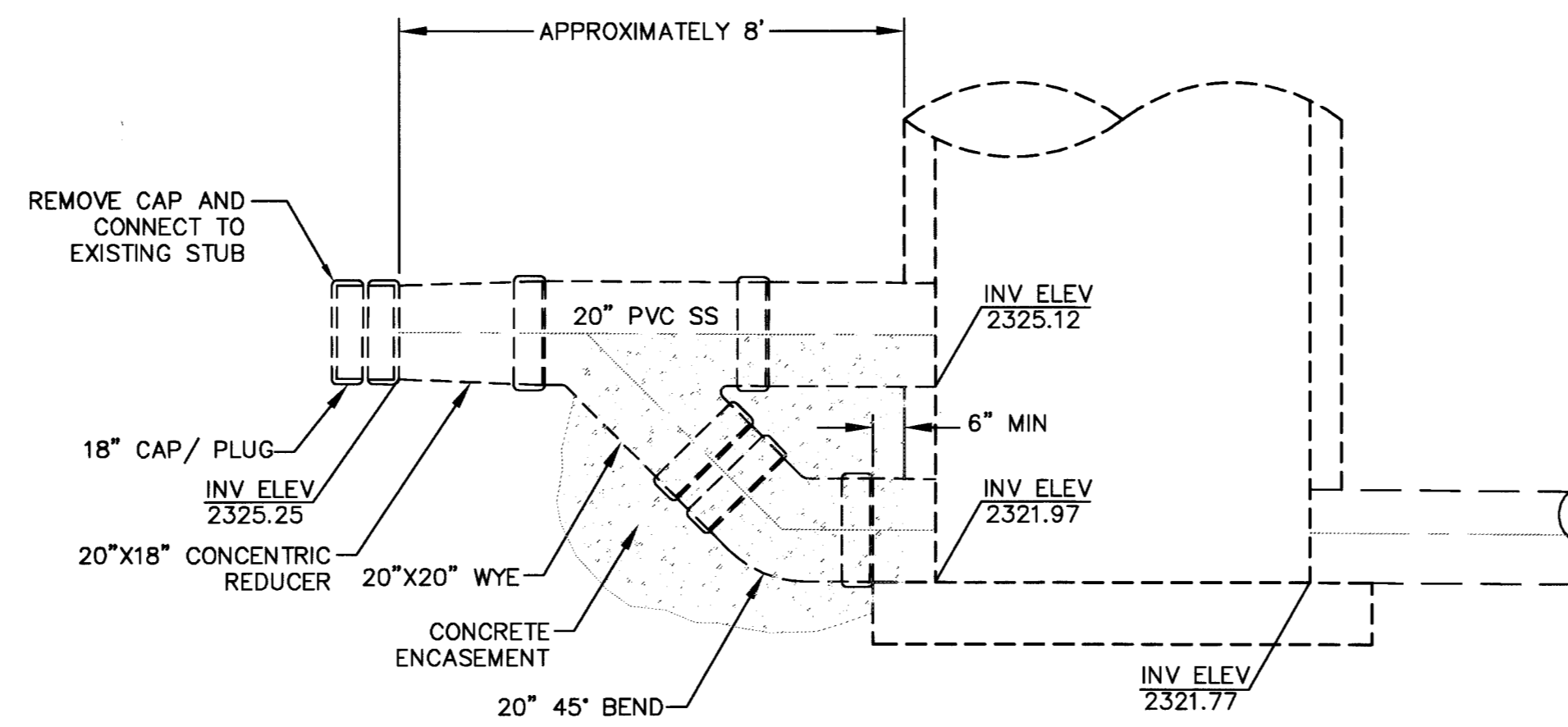

EXISTING DEEP 72" DIA SSMH 15

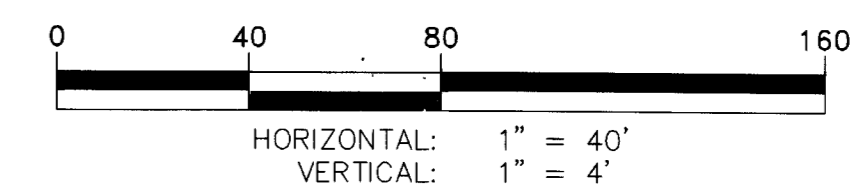

NO DATE REVISION APPROVED

SCALE (H): AS SHOWN SCALE (V): AS SHOWN WA # DATE: 10/15/2007 DESIGN BY: FKR

FIELD BOOK #

THE Louis Berger Group, INC.
 500 E. Amigo Court, Suite 100 Voice: 702-736-6632
 Las Vegas, Nevada 89119 Fax: 702-736-0704

CITY OF LAS VEGAS NEVADA

DEPARTMENT OF PUBLIC WORKS

PROJECT: LAS VEGAS WASH MIDDLE BRANCH ELKHORN STORM DRAIN RAINBOW BOULEVARD TO TORREY PINES DRIVE

SHEET: 8" SANITARY SEWER LATERAL PROFILES

PROFESSIONAL ENGINEER STATE OF NEVADA
 SYNDU KIPPIN DUNN
 11070 W. LAS VEGAS BLVD. SUITE 100
 LAS VEGAS, NV 89135
 501367

SHEET: SS-8
 31 OF 41
 CLV DRAWING NO: 327V275

LAS VEGAS WASH - MIDDLE BRANCH ELKHORN STORM DRAIN