

**OFFSITE SEWER - PLAN**

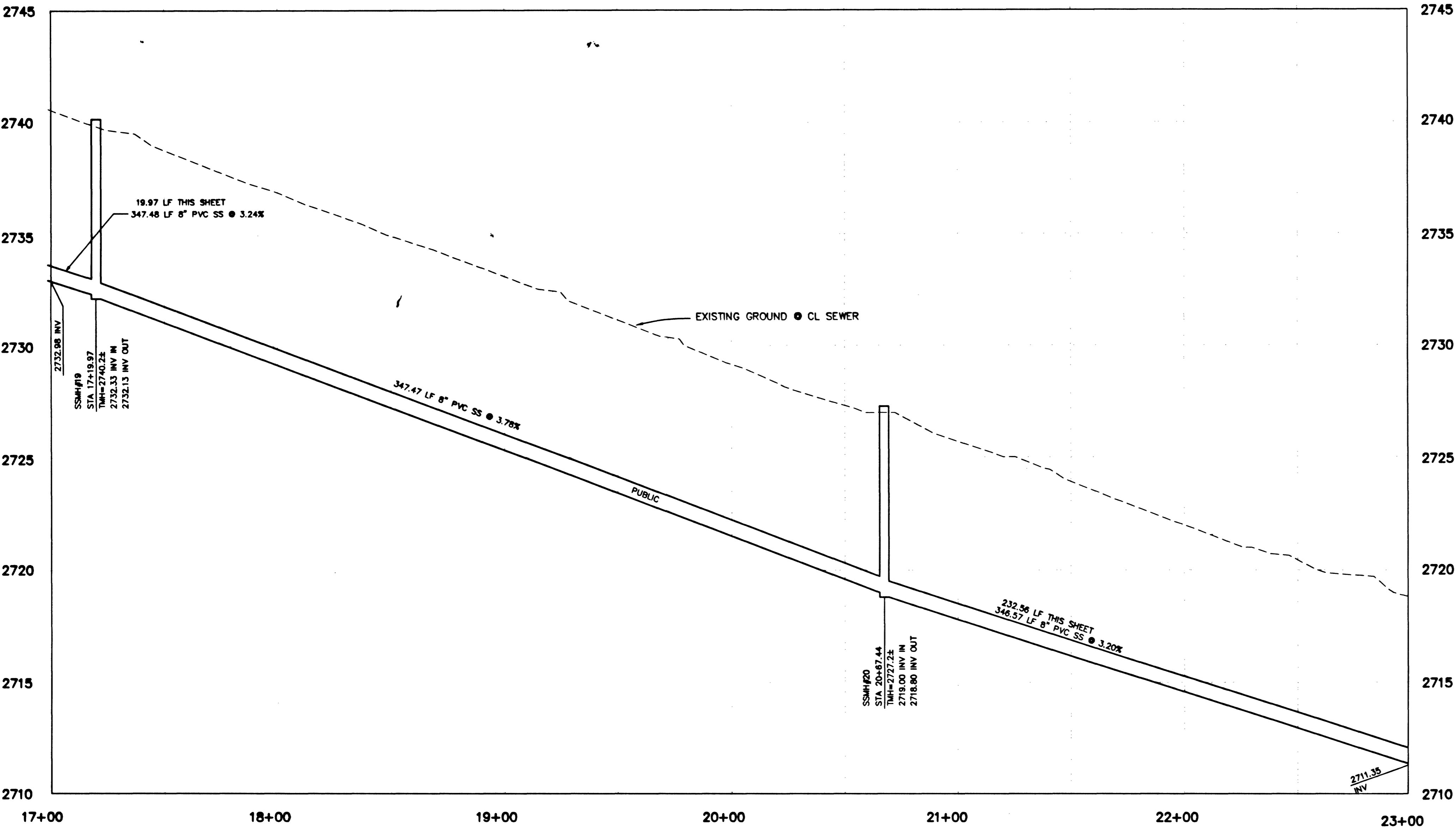

**OFFSITE SEWER - PROFILE**

SCALE: HORIZ. 1" = 30'  
VERT. 1" = 3'

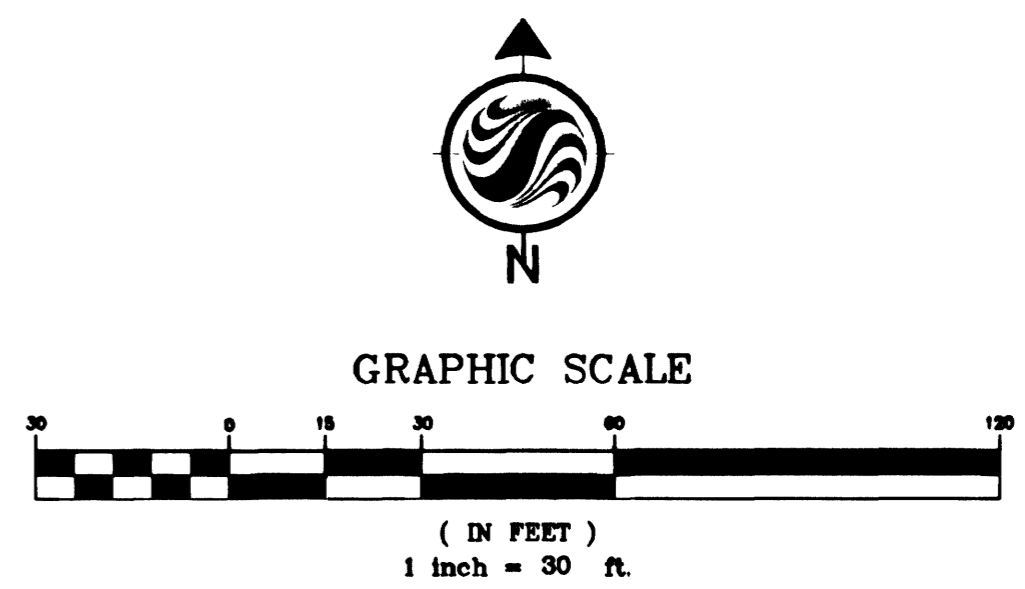
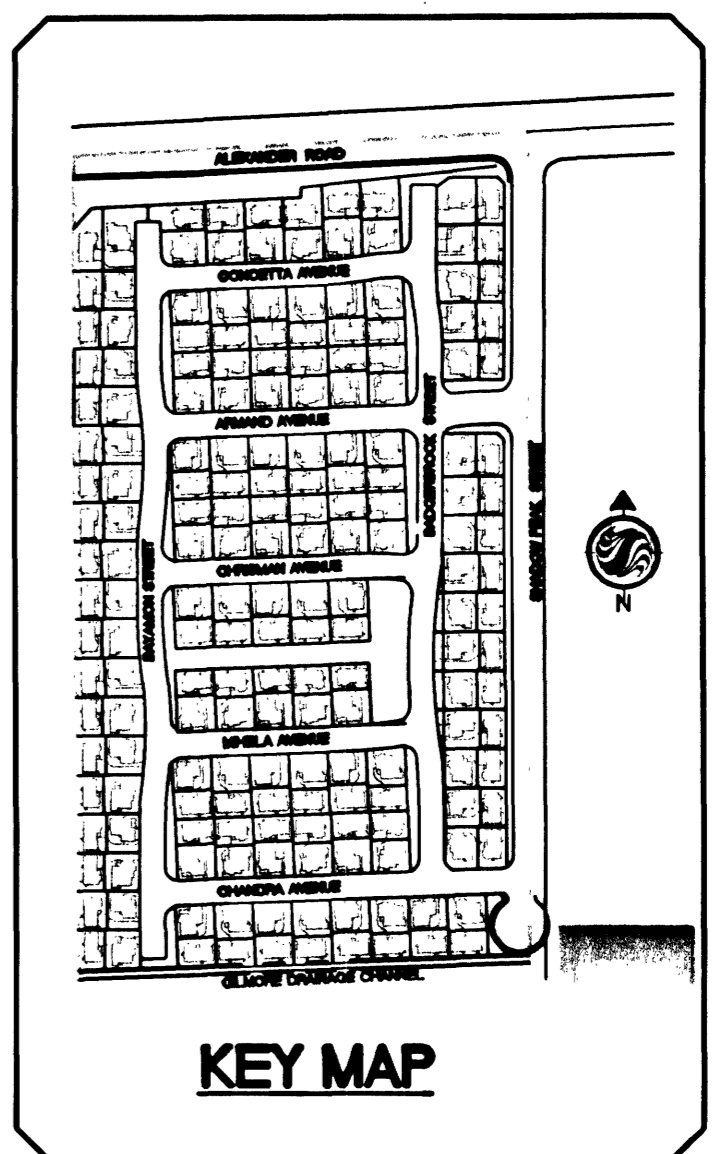

**Call before you do Overhead**  
1-702-593-6111

**Call before you Dig**  
1-800-227-2600

**BENCHMARK**  
CITY OF LAS VEGAS BENCHMARK BLV08 1NEE8  
RIVET AND 2-INCH DIAMETER ALUMINUM PLATE IN 6-INCH DIAMETER CONCRETE CYLINDER AT THE NORTHWEST CORNER OF HUALAPAI AND RED COACH.  
ELEVATION = 822.0732 METERS, 2697.09 FEET (NAVD'88)

**BASIS OF BEARING**  
NORTH 01°09'30" WEST, BEING THE BEARING OF THE WEST LINE OF THE NORTHWEST QUARTER (NW 1/4) OF THE NORTHWEST QUARTER (NW 1/4) OF SECTION 12, TOWNSHIP 20 SOUTH, RANGE 59 EAST, M.D.M., CLARK COUNTY, NEVADA AS SHOWN ON THAT CERTAIN MAP ON FILE IN THE CLARK COUNTY RECORDER'S OFFICE IN FILE 88, PAGE 08 OF SURVEYS.

DATE:	10/14/2002
PN:	S.A.
DRAWN BY:	
DESIGNED BY:	
CHECKED BY:	
ADA CHECKED:	
JOB NO.:	88170002
SCALE:	1" = 30'
APP'D:	
DATE:	

**Stanlec Consulting Inc.**  
7251 W. Charleston Blvd.  
Las Vegas NV U.S.A. 89117  
Tel. 702.258.0115  
Fax. 702.258.4956  
www.stanlec.com

**RICHMOND AMERICAN HOMES**  
Richmond American Homes  
of Nevada, Inc.  
7230 West Peak Drive, Suite 212  
Las Vegas, NV 89128  
(702) 240-5600

**RICHMOND AMERICAN HOMES OF NEVADA, INC**  
LONE MOUNTAIN TERRACES  
OFF-SITE SEWER  
STA 17+00 TO STA 23+00

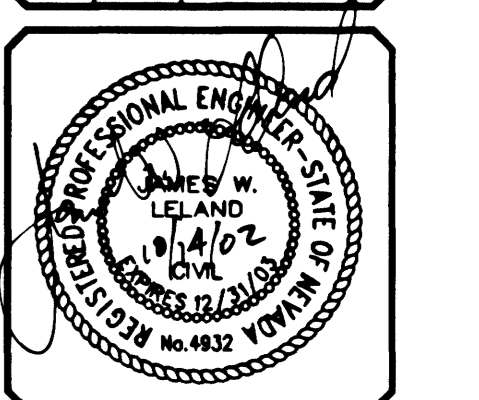

z:\active\88170002\Drawings\mplan\25\_LFS-002.dwg dmlthead Mon, 14 Oct 2002 - 12:05pm

46124