

ENGINEER DISCLAIMER NOTE:
 UTILITY LOCATIONS SHOWN HERON ARE APPROXIMATE ONLY. IT SHALL BE THE CONTRACTOR'S RESPONSIBILITY TO DETERMINE THE EXACT HORIZONTAL AND VERTICAL LOCATION OF ALL EXISTING UNDERGROUND AND OVERHEAD UTILITIES AND NOTIFY THE DESIGN ENGINEER IMMEDIATELY OF ANY DISCREPANCIES PRIOR TO COMMENCING CONSTRUCTION.
 NO REPRESENTATION IS MADE THAT ALL EXISTING UTILITIES ARE SHOWN HEREON. THE ENGINEER ASSUMES NO RESPONSIBILITY FOR UTILITIES NOT SHOWN OR UTILITIES NOT SHOWN IN THEIR PROPER LOCATION.

PRIVATE STREET NOTE:
 ALL PRIVATE STREETS ARE P.U.E.'S, PUBLIC SEWER EASEMENT AND PUBLIC DRAINAGE EASEMENTS TO BE PRIVATELY MAINTAINED BY H.O.A.

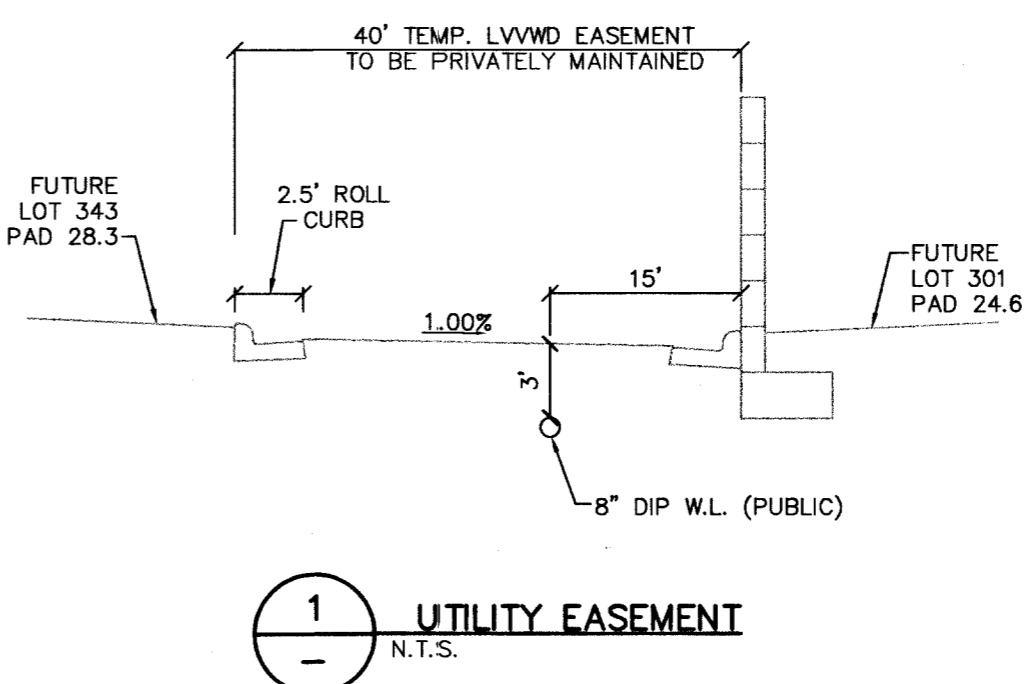

ESTIMATE OF QUANTITIES LEGEND

WATER	PUBLIC	PRIVATE
① FIRE HYDRANT ASSEMBLY, INCLUDING: 8"x6" TEE, 6" GV (PER UDACS PLATE No. 7)	3 EA.	0 EA.
② 8" TEE	3 EA.	0 EA.
③ 8" GATE VALVE	2 EA.	0 EA.
④ 1/2" 90° ELBOW	1 EA.	0 EA.
⑤ 1/4" 8" 22.5° ELBOW	2 EA.	0 EA.
⑥ CAP W/2" B.O. ASSEMBLY (PER UDACS PLATE No. 4)	2 EA.	0 EA.
⑦ 10" GATE VALVE	1 EA.	0 EA.
⑧ 10"x8" REDUCER	1 EA.	0 EA.
⑨ 8"x6" REDUCER	2 EA.	0 EA.
W/ 5/8" METER	39 EA.	0 EA.
1" METER W/ 1" RPPA (PER UDACS PLATE 10 & 11A)	0 EA.	0 EA.
TOTAL SERVICES INSTALLED WITH THIS UNIT	39 EA.	

6" PVC WATER MAIN(PUBLIC)	163 LF.	0 LF.
8" PVC WATER MAIN(PUBLIC)	1,517 LF.	0 LF.
8" DIP WATER MAIN(PUBLIC)	71 LF.	0 LF.
10" PVC WATER MAIN(PUBLIC)	218 LF.	0 LF.

SEWER

STANDARD MANHOLE PUBLIC	6 EA.	0 EA.
4" SEWER LATERALS(PRIVATE)	0 LF.	1,491 LF.
4" SEWER WYES (PRIVATE)	0 LF.	44 EA.
8" SEWER MAIN(PUBLIC)	1,122 LF.	0 LF.
BACKWATER VALVES(PRIVATE)	0 EA.	27 EA.

SEWER CONTRIBUTION (BASED ON 39 LOTS)
 AVERAGE DAILY FLOW = 0.00975 MGD.
 PEAK FLOW (PF=3.5) = 0.034125 MGD.

TRAFFIC

	PUBLIC	PRIVATE
(A) R1-1 "STOP" SIGN & (2) D3 "STREET NAME" SIGNS	0 EA.	0 EA.
(B) (2) D3 "STREET NAME SIGNS	0 EA.	3 EA.

DRIVEWAY LOCATION (SCHEMATIC ONLY) 39 EA.
 POINT OF CONNECTION (UTILITIES)

SIGHT VISIBILITY EASEMENT
 SEE SHEETS TS1 & TS2 FOR TRAFFIC / STREETLIGHTING

APPROVAL:
 LAS VEGAS VALLEY WATER DISTRICT 1-3,5 DATE
 CITY OF LAS VEGAS FIRE MARSHAL DATE

LAS VEGAS FIRE DEPARTMENT
 FIRE FLOW REQUIREMENT IS 1,500 GALLONS/MIN. AT 20 LBS./SQ.IN. RESIDUAL.
 BASED ON:
 SQUARE FOOTAGE: 2600
 LARGEST AREA BETWEEN SEPARATION WALLS:
 HEIGHT: 2 STORY
 TYPE OF CONSTRUCTION:
 EXPOSURES: 10' MIN.
 SPRINKLER SYSTEM: NONE
 OCCUPANCY: SINGLE FAMILY RESIDENCE
 ROOF CONSTRUCTION: CONCRETE TILE
 REVIEWED BY:

NEVADA POWER COMPANY DATE
 NEVADA POWER COMPANY APPROVAL IS ONLY FOR THE PLACEMENT AND CLEARANCE OF STREET LIGHT AND SIGNAL LIGHT INSTALLATION.
 NEVADA POWER COMPANY ACKNOWLEDGES THAT WE HAVE RECEIVED YOUR PLANS AND WILL PROVIDE SERVICE TO ALL ELECTRICAL NEEDS ASSOCIATED WITH THIS PROJECT. NEVADA POWER COMPANY RESERVES THE RIGHT TO ADDRESS ANY EXISTING OR FUTURE CONFLICTS ONCE THE FINAL DESIGN IS COMPLETED. THE NEW SERVICE AND THE RESOLUTION OF ANY CONFLICTS WILL BE ACCOMPLISHED PURSUANT TO THE NEVADA PUBLIC UTILITY COMMISSION'S RULES AND REGULATIONS.

BENCHMARK
 PROJECT VERTICAL DATUM: NAVD88
 CITY OF LAS VEGAS BENCHMARK 1LV00-45E5
 NAVD88 ELEV: 713.8077 METERS (2341.88 FEET)
 RIVET AND PLATE IN TOP OF CURB, NORTHWEST RETURN OF ALEXANDER ROAD AND BUFFALO DRIVE
 PROJECT IS TO BE CONSTRUCTED WITH 1992 DATUM.
 REFERENCE: (ELEV: 713.8077+ .042=713.8497 METERS 2341.88+ .14=2342.02 FEET)
BASIS OF BEARINGS: 65795
 SOUTH 01° 42' 30" WEST, BEING THE CENTERLINE OF VEGAS VISTA TRAIL, NORTH OF ITS INTERSECTION WITH ALEXANDER ROAD, AS SHOWN ON THAT PLAN OF "LONE MOUNTAIN HEIGHTS - UNIT 1", ON FILE IN THE OFFICE OF THE COUNTY RECORDER, CLARK COUNTY, NEVADA, IN BOOK 96 OF PLATS, AT PAGE 81.

Call before you Dig
 1-800-227-2600

Call before you Overhead
 1-702-593-6111

SEWER NOTE
 MANHOLE STATIONING IS BASED ON SEWER LENGTHS FROM MANHOLE TO TO MANHOLE. ALL MANHOLES ARE 48" SIZED MANHOLES PER STD.DWG# SD-1. MANHOLES TEN (10) FEET OR DEEPER ARE REQUIRED TO HAVE LOCKING MANHOLE COVERS.

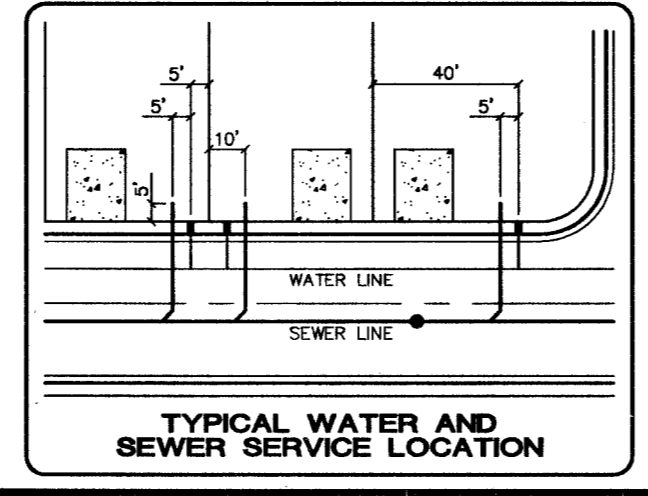

FOR ALL UTILITY NOTES, SEE GENERAL NOTE SHEET # C3.

CITY OF LAS VEGAS
 2727 SOUTH RAINBOW BOULEVARD LAS VEGAS, NEVADA 89146-5148
 PH: (702) 973-7550 FAX (702) 362-2597
 nevada CONSULTING ENGINEERS • PLANNERS • LAND SURVEYORS

KB HOME
 750 PILOT ROAD, SUITE F
 LAS VEGAS, NEVADA 89119
 (702) 812-2530

SEWER AS-BUILT

LONE MOUNTAIN RIDGES UNIT 7

DRAWN BY: 03/02/04
 DESIGNED BY:
 CHECKED BY:
 PROJECT NO: 6058-7
 SCALE: 1"=40' HORIZ. N/A VERT.

SHEET 1
 1 OF 1 SHEETS
 DRAWING NO. 307Y-4728-7