

PROJECT NAME: Lone Mountain Ridges Unit 6  
 This project complies with the Las Vegas Valley Water District's technical requirements. However, this water plan is NOT APPROVED FOR CONSTRUCTION at this time and this signature does not provide or imply a water commitment.

L.V.W.D. #52 DATE: 9-27-02

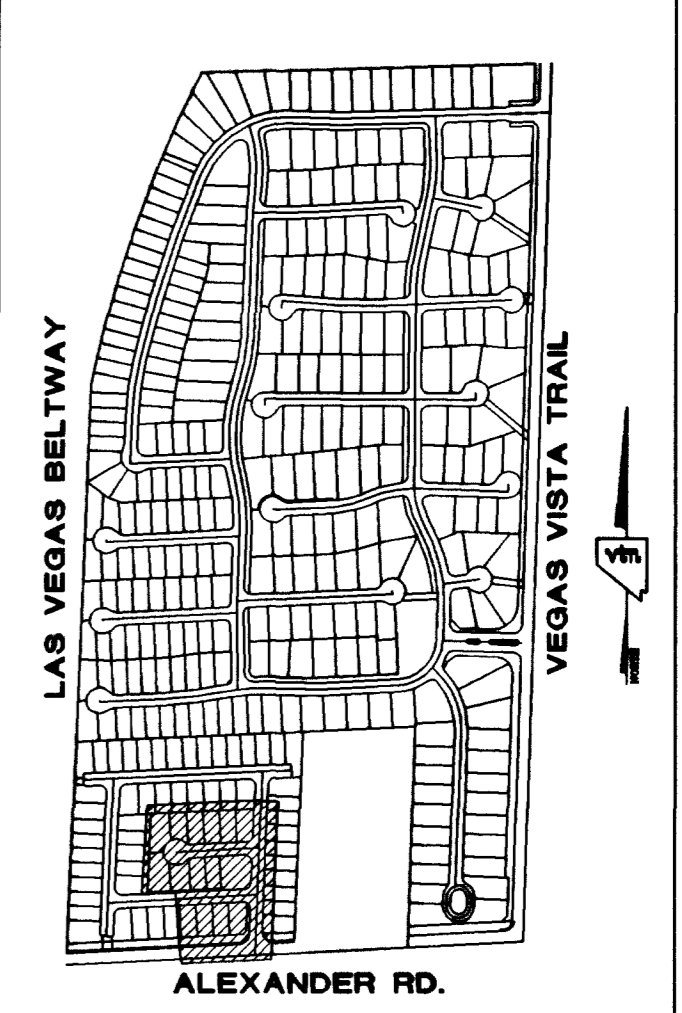

VICINITY MAP  
NOT TO SCALE

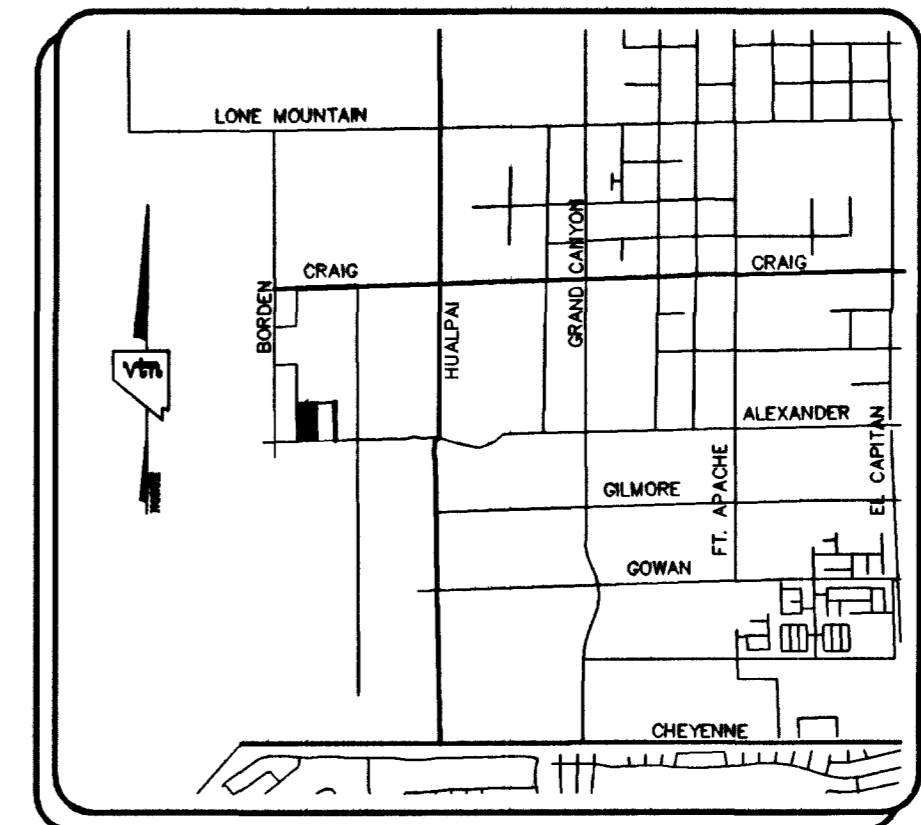
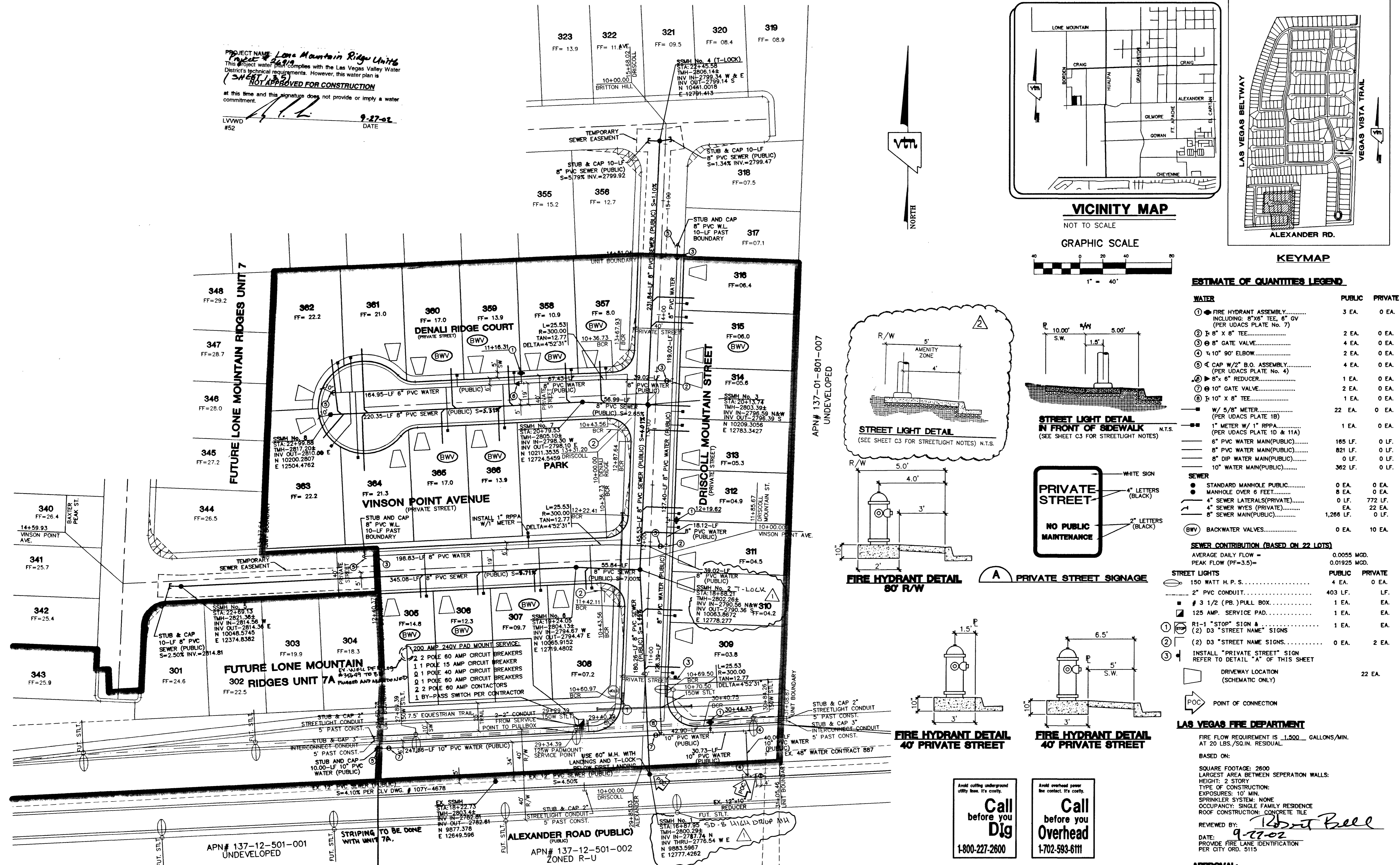
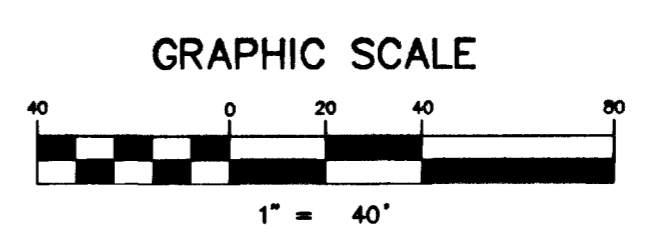

**ESTIMATE OF QUANTITIES LEGEND**

	WATER	PUBLIC	PRIVATE
① FIRE HYDRANT ASSEMBLY.....		3 EA.	0 EA.
② 8" x 8" TEE.....		2 EA.	0 EA.
③ 8" GATE VALVE.....		4 EA.	0 EA.
④ 90° ELBOW.....		2 EA.	0 EA.
⑤ CAP W/2" B.O. ASSEMBLY.....		4 EA.	0 EA.
⑥ 8" x 6" REDUCER.....		1 EA.	0 EA.
⑦ 10" GATE VALVE.....		2 EA.	0 EA.
⑧ 10" x 8" TEE.....		1 EA.	0 EA.
W/ 5/8" METER.....		22 EA.	0 EA.
1" METER W/ 1" RPPA.....		1 EA.	0 EA.
6" PVC WATER MAIN(PUBLIC).....		165 LF.	0 LF.
8" PVC WATER MAIN(PUBLIC).....		821 LF.	0 LF.
8" DIP WATER MAIN(PUBLIC).....		0 LF.	0 LF.
10" WATER MAIN(PUBLIC).....		362 LF.	0 LF.
STANDARD MANHOLE PUBLIC.....		0 EA.	0 EA.
MANHOLE OVER 6 FEET.....		8 EA.	0 EA.
SEWER LATERALS(PRIVATE).....		0 LF.	772 LF.
SEWER WYES (PRIVATE).....		EA.	22 EA.
SEWER MAIN(PUBLIC).....		1,266 LF.	0 LF.
BACKWATER VALVES.....		0 EA.	10 EA.

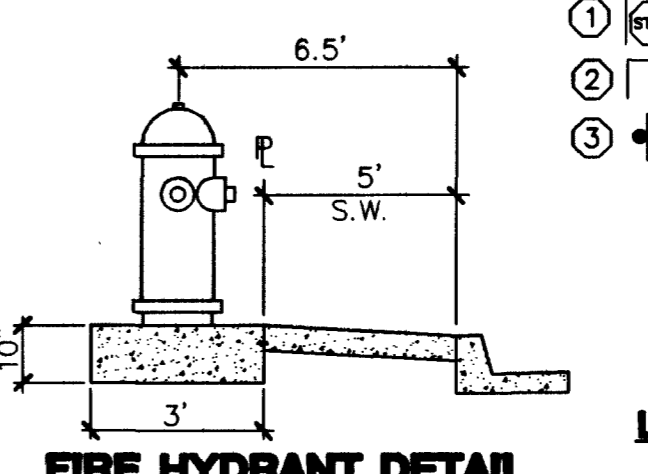
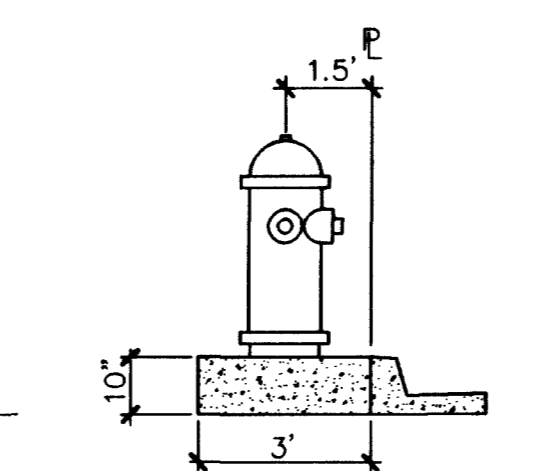
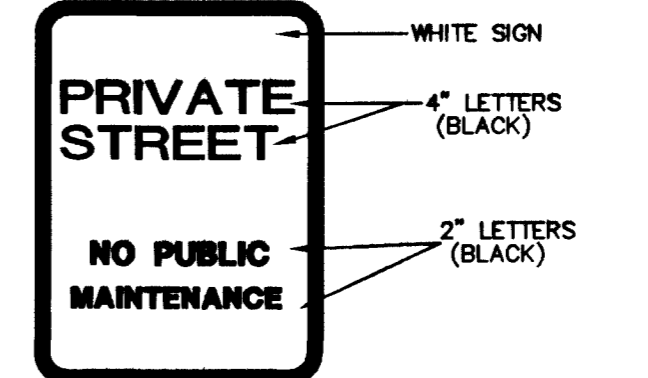
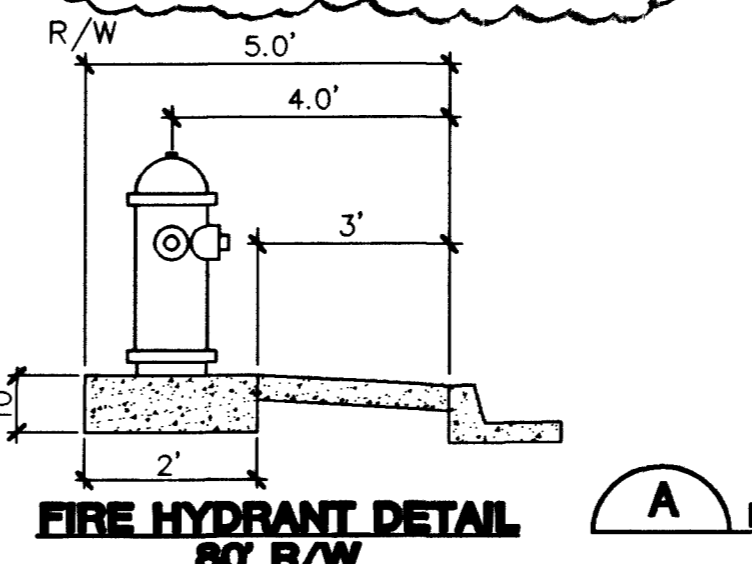
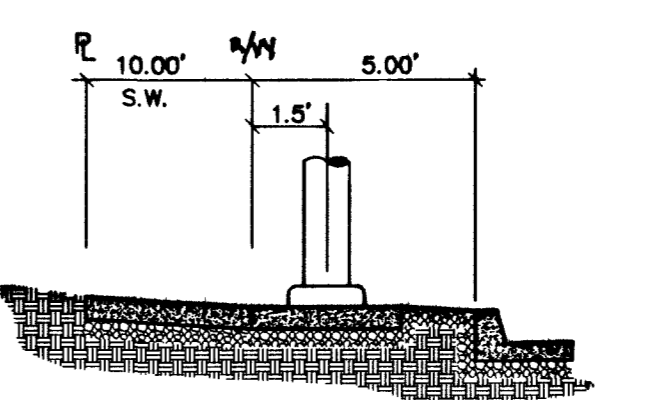
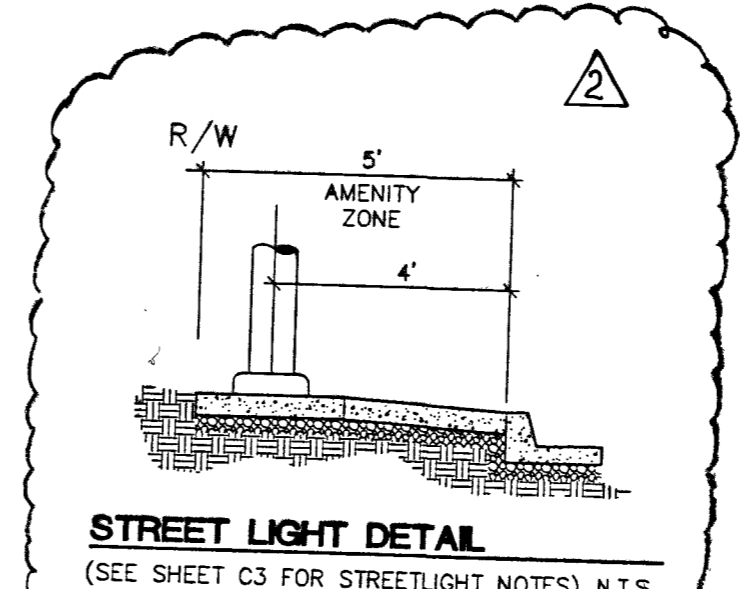

Call before you Dig  
1-800-227-2600

Call before you Overhead  
1-702-593-5111

**BENCHMARK**  
 PROJECT VERTICAL DATUM: NAVD88  
 CITY OF LAS VEGAS BENCHMARK 1LV00-45ES  
 NAVD88 ELEV: 713.8077 METERS (2341.88 FEET)  
 RIVET AND PLATE IN TOP OF CURB, NORTHWEST RETURN OF ALEXANDER ROAD AND BUFFALO DRIVE  
 PROJECT IS TO BE CONSTRUCTED WITH 1992 DATUM.  
 REFERENCE: (ELEV: 713.8077+042=713.8497 METERS 2341.88+14=2342.02 FEET)

**BASIS OF BEARINGS:**  
 SOUTH 01° 42' 30" WEST, BEING THE CENTERLINE OF VEGAS VISTA TRAIL, NORTH OF ITS INTERSECTION WITH ALEXANDER ROAD, AS SHOWN ON THAT PLAN OF "LONE MOUNTAIN RIDGES - UNIT 1", ON FILE IN THE OFFICE OF THE COUNTY RECORDER, CLARK COUNTY, NEVADA, IN BOOK 96 OF PLATS, AT PAGE 81.

ALL PRIVATE STREETS ARE P.U.E.A. CLV PUBLIC SEWER EASEMENTS AND PUBLIC DRAINAGE EASEMENTS TO BE PRIVATELY MAINTAINED

**REDUCED PRESSURE PRINCIPLE ASSEMBLY (RPPA)**  
 APPROVED REDUCED PRESSURE PRINCIPLE ASSEMBLY(S) SHALL BE INSTALLED PER THE UDACS PLATE NO. 11A. NO WATER SHALL BE TAKEN FROM A SERVICE REQUIRING BACKFLOW PREVENTION UNTIL THE REDUCED PRESSURE PRINCIPLE ASSEMBLY HAS BEEN SUCCESSFULLY TESTED BY THE LVWD. ANY BLOCK WALL OR OTHER FENCE MATERIAL SHALL BE DESIGNED AND CONSTRUCTED AROUND THE OUTSIDE OF THE EASEMENT(S) TO ALLOW THE DIRECT ACCESS FROM THE ADJACENT RIGHT-OF-WAY.

NOTE: N/A  
 MANHOLES TEN (10') FEET OR DEEPER ARE REQUIRED TO HAVE LOCKING MANHOLE COVERS.

NOTE:  
 ALL MH STATIONING IS BASED ON SEWER LENGTHS FROM MANHOLE TO MANHOLE.  
 ALL MANHOLES ARE 48" SIZE MANHOLES PER STD.DWG# SD-1.

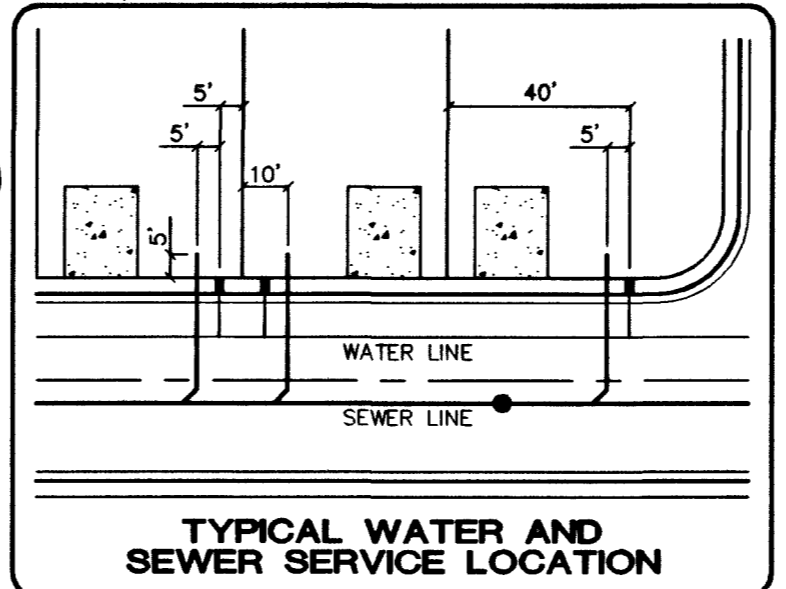

**DISCLAIMER NOTE**  
 UTILITY LOCATIONS SHOWN HEREON ARE APPROXIMATE ONLY. IT SHALL BE THE CONTRACTOR'S RESPONSIBILITY TO DETERMINE THE EXACT HORIZONTAL AND VERTICAL LOCATION OF ALL EXISTING UNDERGROUND AND OVERHEAD UTILITIES PRIOR TO COMMENCING CONSTRUCTION. NO REPRESENTATION IS MADE THAT ALL EXISTING UTILITIES ARE SHOWN HEREON. THE ENGINEER ASSUMES NO RESPONSIBILITY FOR UTILITIES NOT SHOWN OR UTILITIES NOT SHOWN IN THEIR PROPER LOCATION.

**SEWER CONTRIBUTION (BASED ON 22 LOTS)**

	AVERAGE DAILY FLOW =	PUBLIC	PRIVATE
	PEAK FLOW (PF=3.5)=	0.0055 MGD.	0.01925 MGD.

**STREET LIGHTS**

	PUBLIC	PRIVATE
150 WATT H.P.S.....	4 EA.	0 EA.
2" PVC CONDUIT.....	403 LF.	0 LF.
# 3 1/2" (PB.) PULL BOX.....	1 EA.	EA.
125 AMP. SERVICE PAD.....	1 EA.	EA.
R1-1 "STOP" SIGN &.....	1 EA.	EA.
(2) D3 "STREET NAME" SIGNS.....	0 EA.	2 EA.
INSTALL "PRIVATE STREET" SIGN REFER TO DETAIL "A" OF THIS SHEET.....		
DRIVEWAY LOCATION (SCHEMATIC ONLY).....		22 EA.

**LAS VEGAS FIRE DEPARTMENT**  
 FIRE FLOW REQUIREMENT IS 1,500 GALLONS/MIN. AT 20 LBS./SQ.IN. RESIDUAL.  
 BASED ON:  
 SQUARE FOOTAGE: 2800  
 LARGEST AREA BETWEEN SEPERATION WALLS:  
 HEIGHT: 2 STORY  
 TYPE OF CONSTRUCTION:  
 EXPOSURES: 10' MIN.  
 SPRINKLER SYSTEM: NONE  
 OCCUPANCY: SINGLE FAMILY RESIDENCE  
 ROOF CONSTRUCTION: CONCRETE TILE  
 REVIEWED BY: Robert Bell  
 DATE: 9-27-02  
 PROVIDE FIRE LANE IDENTIFICATION PER CITY ORD. 5115

**APPROVAL:**  
 LAS VEGAS VALLEY WATER DISTRICT  
 LAS VEGAS FIRE MARSHAL  
 NEVADA POWER COMPANY

**CITY OF LAS VEGAS**  
**KB HOME**  
 750 PILOT ROAD, SUITE F  
 LAS VEGAS, NEVADA 89119  
 (702) 614-2500

**MASTER UTILITY AND STREET LIGHTING PLAN**  
**LONE MOUNTAIN RIDGES UNIT 6**

APRIL 2002  
 MAY 2002  
 MAY 2002

SCALE: 1"=40' HORIZ. VERT. N/A

PROJECT NO: 6095-6

EXPIRES 12-31-03

SHEET 5 OF 13 SHEETS  
 DRAWING NO. 30-Y-4728-6