

These plans and the design criteria contained within these plans are based upon the information presently known by the engineer and intended solely as a general guideline for construction. All construction shall be in conformance with all applicable local, state and federal statutes, laws, codes, regulations and ordinances, including but not limited to the Federal Fair Housing Amendments Act, Americans With Disabilities Act, the Architectural Barriers Act and any applicable uniform standards, specifications or drawings. The person or entity performing the construction shall be solely responsible to make sure construction is in conformance with all local, state and federal statutes, laws, codes, regulations, standards, guidelines and ordinances and further, is in conformance with any applicable design criteria, including but not limited to soils reports, traffic studies, geotechnical reports, architectural plans and specifications, drainage plans or studies and any other criteria, standards or requirements listed in the plans or the general notes related to these plans or provided by anyone in reference to this project.

**INSTALLATION OF METER AND VAULT (2) 6" X 3" FMCT METERS**  
 THE METER(S) AND VAULT(S) WITH NON-TRAFFIC BEARING COVER(S) SHALL BE INSTALLED IN ACCORDANCE WITH THE UDACS PLATE NO. 21D AND WITH STANDARD VAULT DRAWING C-475, LATEST REVISION.

ANY BLOCK WALL OR OTHER FENCE MATERIAL SHALL BE DESIGNED AND CONSTRUCTED AROUND THE OUTSIDE OF THE EASEMENT(S) TO ALLOW THE DISTRICT DIRECT ACCESS TO THE ADJACENT RIGHT-OF-WAY. EASEMENTS SHALL BE CLEARLY MARKED OR STAKED PRIOR TO THE START OF CONSTRUCTION.

**METERS**  
 METERS MUST BE SET IN A HORIZONTAL POSITION AT LEAST EIGHT (8) DIAMETERS OF STRAIGHT PIPE ARE REQUIRED AT THE INLET END. ESN:022

ALL SEWER LOCATED OUTSIDE OF ANY PUBLIC RIGHT-OF-WAY AND ANY PUBLIC SEWER EASEMENT IS PRIVATE SEWER PER UPC.

FOR ALL WATER MAINS/LATERALS THAT CROSS UNDER SEWER MAINS/LATERALS, OR WITH LESS THAN 18" ABOVE NEED TO BE BUILT PER UDACS# 2.19.02b.5a.

**REDUCED PRESSURE PRINCIPLE ASSEMBLY (2) 8"**  
 APPROVED REDUCED PRESSURE PRINCIPLE ASSEMBLY(S) SHALL BE INSTALLED PER THE UDACS PLATE NO. 11B. NO WATER SHALL BE TAKEN FROM A SERVICE REQUIRING BACKFLOW PREVENTION UNTIL THE REDUCED PRESSURE PRINCIPLE ASSEMBLY HAS BEEN SUCCESSFULLY TESTED BY THE LVVWD.

NOTE: CONTRACTOR SHALL VERIFY HORIZONTAL AND VERTICAL LOCATION OF EXISTING UTILITIES AND NOTIFY THE DESIGN ENGINEER IMMEDIATELY OF ANY DISCREPANCIES PRIOR TO CONSTRUCTION.

**FIRE FLOW DATA**  
 THE FIRE FLOW REQUIREMENTS IS 1750 GPM AT 20 PSI RESIDUAL PRESSURE.  
 BASED ON: GEORGE F. TIBSHERANY ARCHITECTURE PLANS  
 SQUARE FOOTAGE: 17,712 SF  
 LARGEST AREA BETWEEN 4-HOUR AREA SEPARATION WALLS: N/A  
 BUILDING HEIGHT: 35 FEET  
 NUMBER OF STORES: 2 FLOORS  
 TYPE OF CONSTRUCTION: V-1  
 OCCUPANCY: R1  
 FULL AUTOMATIC FIRE SPRINKLER SYSTEM: N/A

**ESTIMATE OF QUANTITIES/LEGEND**

WATER	PRIVATE	PUBLIC	SEWER QUANTITIES	PRIVATE	PUBLIC
① FIRE HYDRANT ASSEMBLY (PER UDACS PLATE NO. 7)	21 EA.	0 EA.	● 8" PVC SEWER MAIN	0 EA.	7 EA.
② 10" GATE VALVE	23 EA.	0 EA.	● 8" DIP SEWER MAIN	529 LF.	0 LF.
③ 10" x 8" TEE	3 EA.	0 EA.	● 10" PVC SEWER MAIN	0 LF.	0 LF.
④ 4" 90° ELBOW	4 EA.	0 EA.	● 10" DIP SEWER MAIN	0 LF.	0 LF.
⑤ 4" 45° BEND	7 EA.	0 EA.	● STANDARD MANHOLE	0 EA.	26 EA.
⑥ 4" 90° BEND	0 EA.	0 EA.	● CLEAN OUTS	6 EA.	0 EA.
⑦ 4" 10" 22.5° ELBOW	2 EA.	0 EA.	● 4" SEWER LATERALS	2007 LF.	0 LF.
⑧ 8" GATE VALVE	0 EA.	0 EA.	● BACKWATER VALVES	0 EA.	0 EA.
⑨ 10" 11 1/4" BEND	2 EA.	0 EA.	● 8" GATE VALVE	1 EA.	
⑩ 10" TEE	9 EA.	0 EA.	● 12" 22.5° ELBOW	2 EA.	
⑪ 6" x 3" FMCT (PER UDACS PLATE NO. 21-D)	0 EA.	2 EA.	<b>SEWER CONTRIBUTION</b>		
⑫ RPPA (PER UDACS PLATE NO. 11-B)	0 EA.	2 EA.	AVERAGE DAILY FLOW =	0.035175 MGD.	
⑬ 3" CAP W/ 2" B.O (PER UDACS PLATE NO. 4)	3 EA.	EA.	PEAK FLOW (PF=3.5) =	0.1231125 MGD.	
⑭ 12" x 10" TEE	0 EA.	3 EA.	<b>STREET LIGHTS/ STREET MARKINGS</b>		
⑮ 12" GATE VALVE	0 EA.	2 EA.	① R1-1 "STOP" SIGN	0 EA.	
⑯ 2" IRRIGATION LATERAL PER	0 EA.	0 EA.	② (2) D3 "STREET NAME" SIGNS	0 EA.	
⑰ 4" 10" X 8" REDUCER	0 EA.	2 EA.	③ 250W STL.	6 EA.	
⑱ 6" X 8" REDUCER	0 EA.	2 EA.	④ 2" STL. CONDUIT	1715-LF	
⑲ 4" 10" X 8" REDUCER	0 EA.	2 EA.			
⑳ 3" WATER LATERALS (PRIVATE)	1911 LF.		⑤ POINT OF CONNECTION (UTILITIES)		
㉑ 4" SEWER LATERALS (PRIVATE)	2424 LF.		⑥ COVERED PARKING STALLS		
㉒ 6" WATER MAIN (PUBLIC)	0 LF.		⑦ HANDICAP PATH		
㉓ 6" WATER MAIN (PRIVATE)	\$68.00 LF.		⑧ UTILITY EASEMENT		
㉔ 10" WATER MAIN (PRIVATE)	\$448.00 LF.				
㉕ 12" WATER MAIN (PUBLIC)	\$65.00 LF.				
㉖ 18" C-900 WATER QUALITY SEWER	20.00 LF.				
㉗ 12" DIP WATER MAIN	40.00 LF.				

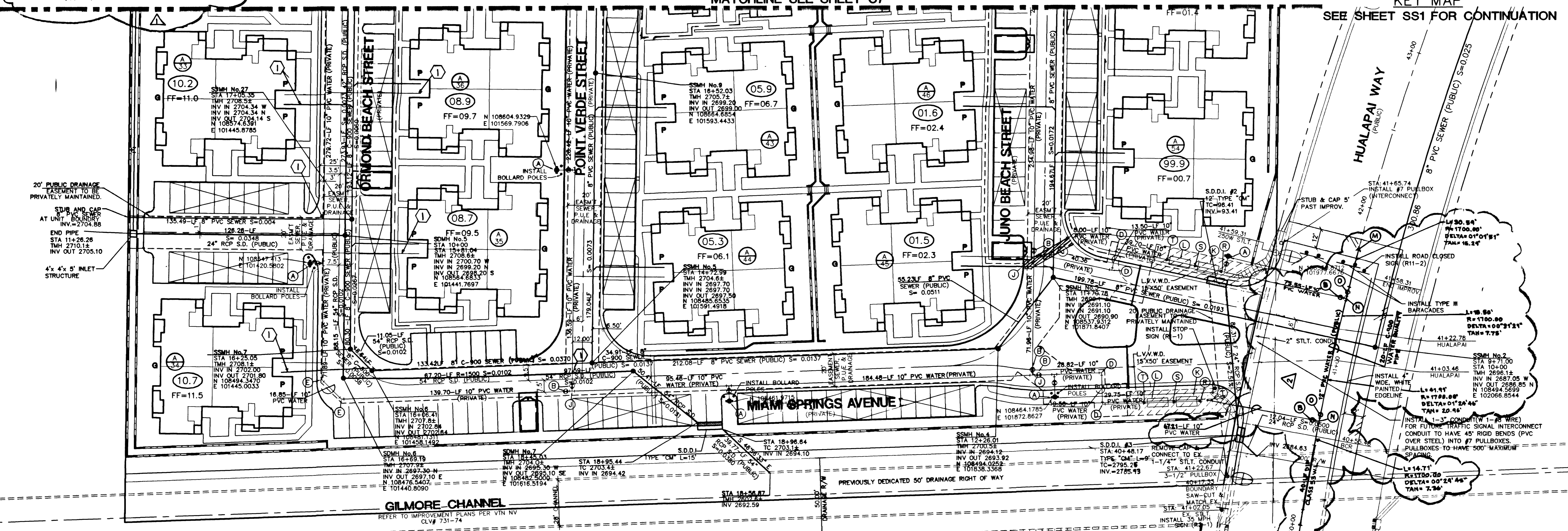
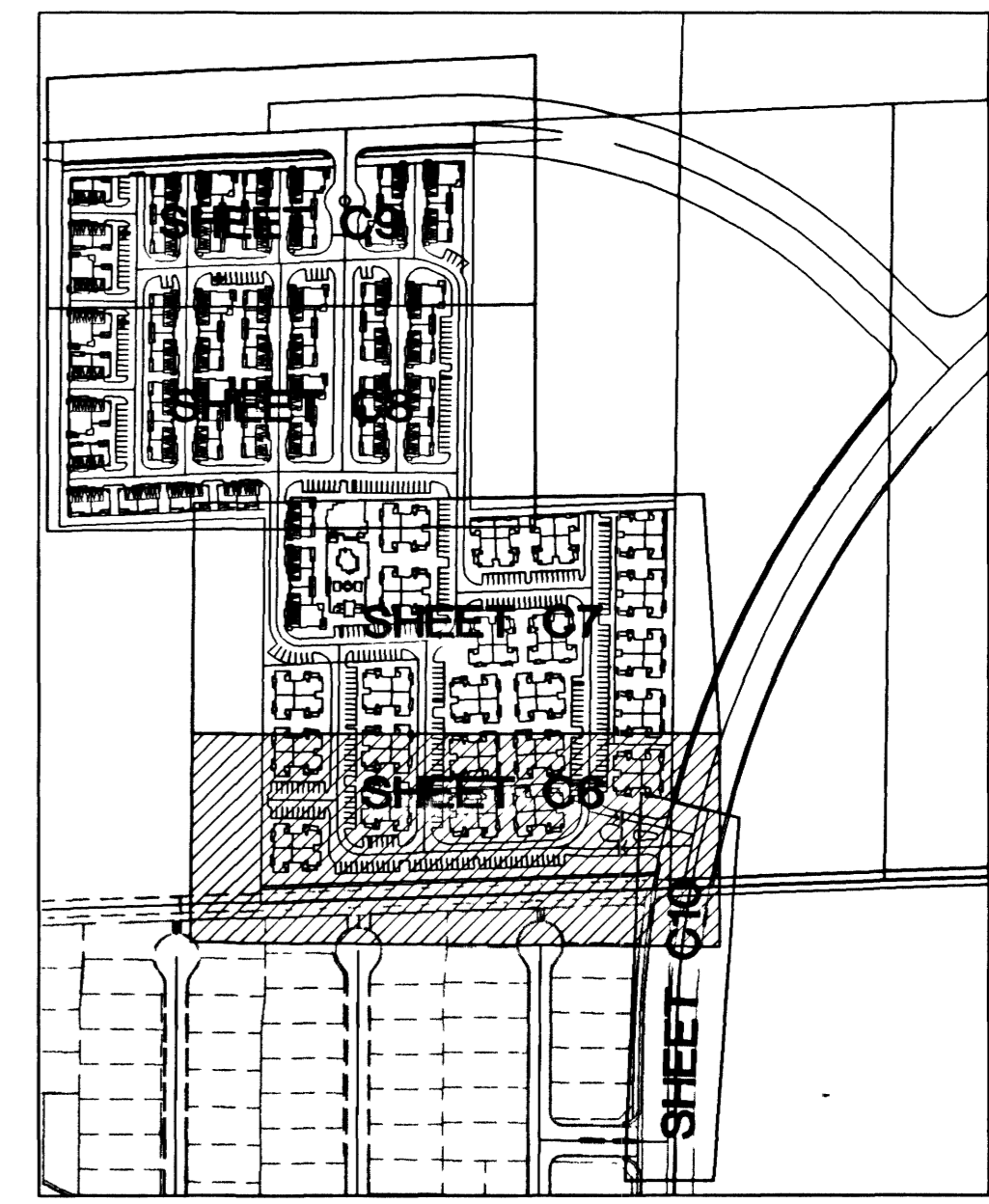
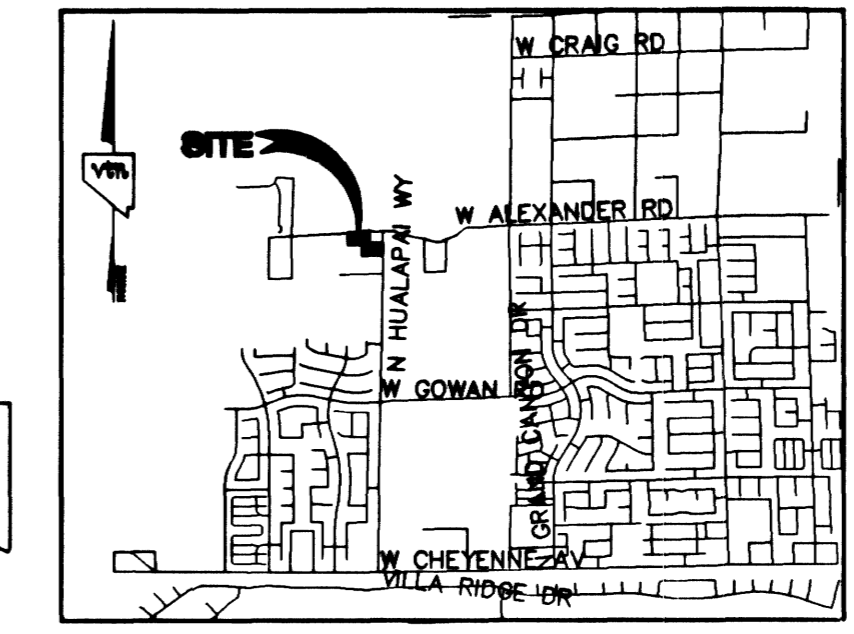

**BENCHMARK**  
 PROJECT VERTICAL DATUM: NAVD88  
 CLARK COUNTY BENCHMARK # 1000-654  
 NAVD88 ELEV: 792.992 METERS (2601.67 FEET)  
 (CONVERSION FACTOR 39.37/1200 = US SURVEY FEET)  
 DESCRIPTION:  
 RIVET AND SQUARE ALUMINUM IN A CONCRETE MONUMENT 50 FEET NORTH AND 25 FEET WEST OF GRAND CANYON DRIVE AND ALEXANDER ROAD.

**Call before you OVERHEAD**  
 1-702-593-6111

**Call before you Dig**  
 1-800-227-2600

**NOTE: SEE PAGE C3 FOR NOTES**

**EASEMENT WITH FENCE OR BLOCK WALL**  
 ANY BLOCK WALL OR OTHER FENCE MATERIALS SHALL BE DESIGNED AND CONSTRUCTED AROUND THE OUTSIDE OF THE EASEMENT(S), SO AS TO ALLOW THE DISTRICT DIRECT ACCESS TO THE FACILITY FROM THE ADJACENT RIGHT-OF-WAY.

**APPROVAL:**  
 LAS VEGAS VALLEY WATER DISTRICT  
 CITY OF LAS VEGAS FIRE MARSHAL

**STREET LIGHT NOTE:**  
 ALL HAND HOLES COVERS MUST BE INSTALLED. POLE CAPS Poured AND PULL BOX LIDS BOLTED DOWN PRIOR TO ENERGIZING CIRCUIT. ALL WIRE MUST HAVE THW INSULATION.

**STREET LIGHT DETAIL**

**PROJECT NAME: Lone Mountain Condominiums**  
 This project water plan complies with the Las Vegas Valley Water District's technical requirements. However, this water plan is NOT APPROVED FOR CONSTRUCTION at this time and this signature does not provide or imply a water commitment.

**APPROVAL:**  
 LAS VEGAS VALLEY WATER DISTRICT  
 NEVADA POWER COMPANY  
 DATE: 1/17/02  
 DATE: 1/11/02

**SCALE: 1" = 30'**

**PROFESSIONAL ENGINEER**  
 KENNETH R. NICHOLSON  
 LICENSE NO. 10639  
 DATE: 1/11/02

**SHEET C6**  
 6 OF 29 SHEETS  
 DRAWING NO. 3078-4690

**WARMINGTON HOMES**  
 6787 WEST TROPICANA #120A  
 LAS VEGAS, NV 89103  
 (702)-248-4430

**LONE MOUNTAIN CONDUMINIUMS**

**MASTER UTILITY & STREET LIGHTING PLAN**

**CITY OF LAS VEGAS**

**REVISION**

NO.	DATE	BY
1	2-13-02	MKD
2	2-20-02	WTA
3	2-20-02	WTA
4	2-20-02	WTA
7		

**DRAWN BY:** MAY '01  
**DESIGNED BY:** R.M.S.  
**CHECKED BY:** MAY '01  
**PROJECT NO.:** 5929  
**SCALE:** 1" = 30' HORZ. VERT. NA  
**DATE:** 1/11/02