

43929 36813

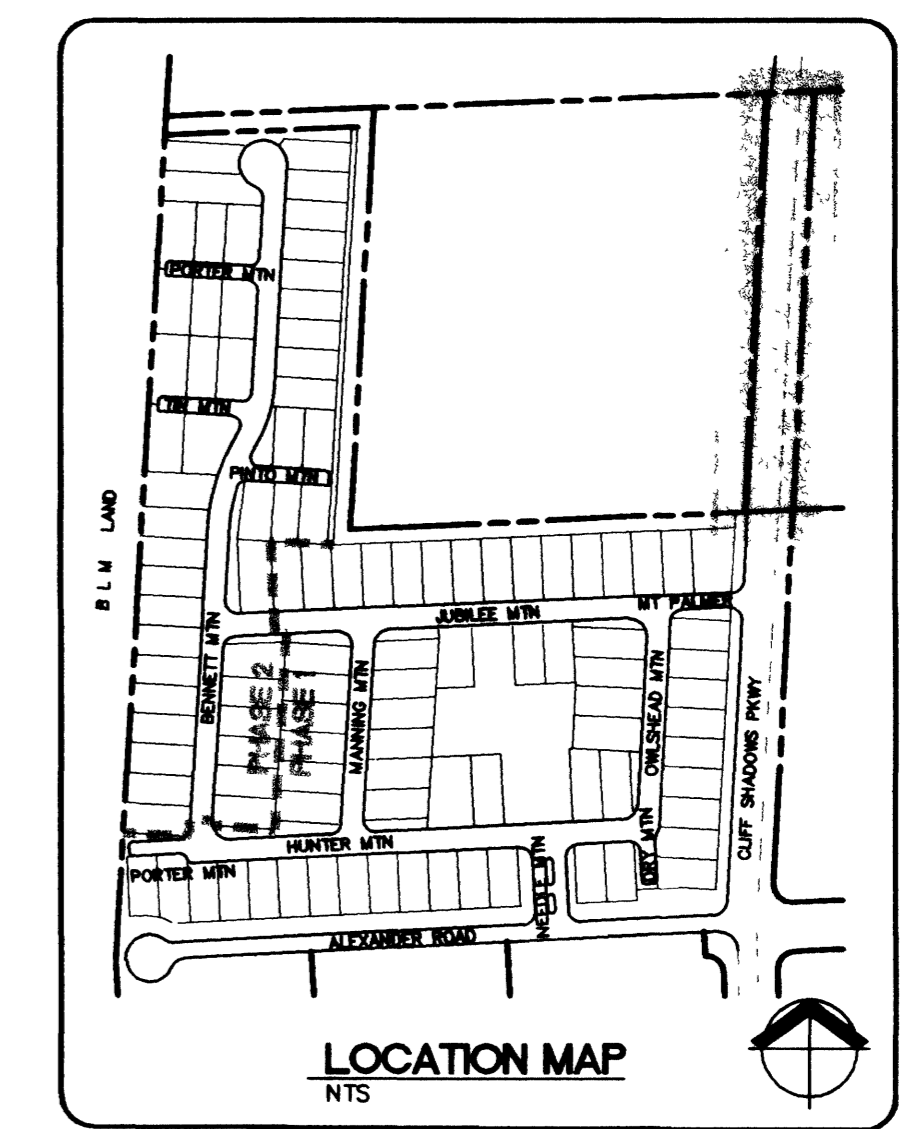

LEGEND

---	SITE BOUNDARY LINE
---	EXISTING R/W LINE
---	"L" TYPE CURB AND GUTTER
---	"A" TYPE CURB
---	PROPOSED FLOW LINE
---	PROPOSED GRADE BREAK
(130.50)	EXISTING TOP OF CURB ELEVATION
(130.50)	PROPOSED TOP OF CURB ELEVATION
-1.0%	PROPOSED GROUND SLOPE

- SEWER CONSTRUCTION NOTES**
- INSTALL 48" SANITARY SEWER MANHOLE PER SOUTHERN NEVADA DESIGN AND CONSTRUCTION STANDARDS FOR WASTEWATER COLLECTION SYSTEMS, 1997, SD-1.
 - INSTALL 8" PVC SEWER MAIN

BENCHMARK
 CLARK COUNTY VERTICAL CONTROL, CLARK COUNTY SURVEYOR T205, RISE, SW QUARTER REFERENCE NUMBER 3 BENCHMARK NAME 10004WB
 A RIVET AND SQUARE ALUMINUM PLATE, STAMPED BM NO. 10004WB, IN AN ELECTRICAL TRANSFORMER PAD, 175 FEET WEST OF AL GARRISON STREET, ON THE SOUTH SIDE OF CRAIG ROAD.
 ELEVATION = 726.815 METERS (NAVD '88)
 ELEVATION = 2384.56 FEET (NAVD '88)

BASIS OF BEARING
 NORTH 87°08'54" EAST, BEING THE SOUTH LINE OF THE SOUTHWEST QUARTER OF THE SOUTHWEST QUARTER OF SECTION 1, TOWNSHIP 20 SOUTH, RANGE 59 EAST, M.D.M., CLARK COUNTY, NEVADA AND BEING THE CENTERLINE OF ALEXANDER ROAD, AS SHOWN BY MAP ON FILE IN BOOK 89 OF SURVEYS, PAGE 03 OF OFFICIAL RECORDS, CLARK COUNTY, NEVADA RECORDS.

DRAINAGE / EASEMENT NOTE
 ALL DRAINAGE EASEMENTS ARE TO BE PRIVATELY MAINTAINED BY HOA.

SCALE: 1" = 40'

Call before you Dig. 1-800-227-2600

Call before you OVERHEAD. 1-702-593-6111

KIMBALL HILL HOMES • LONE MOUNTAIN WEST UNIT 1
CLIFF SHADOWS PKWY (N) - PLAN AND PROFILE
 CITY OF LAS VEGAS
 PORTION OF SECTION 1, TOWNSHIP 20 SOUTH, RANGE 59 EAST
 M.D.M., CLARK COUNTY, NEVADA

DATE: 9/26/01
 DESIGNED: B. JONES
 ENGINEER: J. HITCHEN
 CHECKED: J. HITCHEN
 SCALE: 1" = 40' HORIZ
 WRG PROJECT NO: KHH1003

9/26/01

SHEET TITLE: PLAN & PROFILE
 SHEET NUMBER: PP2
C11 OF 20
 CLV DRAWING NO. 307Y-4678-1

APR 137-01-301-003 USA BLM LAND
 APR 137-01-301-010 USA BLM LAND

KIMBALL HILL HOMES
 2280 Corporate Circle, Ste 430 Henderson, NV 89014
 702.990-9300 FAX: 702.990-9305
 PLANNERS • ENGINEERS • LANDSCAPE ARCHITECTS • SURVEYORS

DESIGNING
 W R G

REVISED: 9/26/01
 REV DATE: 9/26/01
 REV BY: JH