

DATE	9/26/01
DESIGNED BY	B. JONES
ENGINEER	J. HITCHEN
CHECKED	
SCALE	1" = 40' HORIZ
W R G PROJECT NO.	KH1003
REV	DATE BY
1	
2	
3	
4	
5	
6	
7	
8	
9	
10	
11	
12	
13	
14	
15	
16	
17	
18	
19	
20	
21	
22	
23	
24	
25	
26	
27	
28	
29	
30	
31	
32	
33	
34	
35	
36	
37	
38	
39	
40	
41	
42	
43	
44	
45	
46	
47	
48	
49	
50	
51	
52	
53	
54	
55	
56	
57	
58	
59	
60	
61	
62	
63	
64	
65	
66	
67	
68	
69	
70	
71	
72	
73	
74	
75	
76	
77	
78	
79	
80	
81	
82	
83	
84	
85	
86	
87	
88	
89	
90	
91	
92	
93	
94	
95	
96	
97	
98	
99	
100	
101	
102	
103	
104	
105	
106	
107	
108	
109	
110	
111	
112	
113	
114	
115	
116	
117	
118	
119	
120	
121	
122	
123	
124	
125	
126	
127	
128	
129	
130	
131	
132	
133	
134	
135	
136	
137	
138	
139	
140	
141	
142	
143	
144	
145	
146	
147	
148	
149	
150	
151	
152	
153	
154	
155	
156	
157	
158	
159	
160	
161	
162	
163	
164	
165	
166	
167	
168	
169	
170	
171	
172	
173	
174	
175	
176	
177	
178	
179	
180	
181	
182	
183	
184	
185	
186	
187	
188	
189	
190	
191	
192	
193	
194	
195	
196	
197	
198	
199	
200	

CURVE	LENGTH	RADIUS	TANGENT
C25	29.48	20.00	18.15
C26	33.35	20.00	22.03
C40	36.72	25.00	22.57

- LEGEND**
- SITE BOUNDARY LINE
 - EXISTING R/W LINE
 - "L" TYPE CURB AND GUTTER
 - "A" TYPE CURB
 - PROPOSED FLOW LINE
 - PROPOSED GRADE BREAK
 - EXISTING TOP OF CURB ELEVATION
 - PROPOSED TOP OF CURB ELEVATION
 - PROPOSED GROUND SLOPE

- SEWER CONSTRUCTION NOTES**
1. INSTALL 48" SANITARY SEWER MANHOLE PER SOUTHERN NEVADA DESIGN AND CONSTRUCTION STANDARDS FOR WASTEWATER COLLECTION SYSTEMS, 1997, SD-1.
 2. INSTALL 8" PVC SEWER MAIN
 3. REMOVE CAP AND CONNECT TO EXISTING SEWER

BENCHMARK
 CLARK COUNTY VERTICAL CONTROL, CLARK COUNTY SURVEYOR T205, R60E, SW QUARTER REFERENCE NUMBER 3 BENCHMARK NAME 10004W6
 A RIVET AND SQUARE ALUMINUM PLATE, STAMPED BM NO. 10004W6, IN AN ELECTRICAL TRANSFORMER PAD, 175 FEET WEST OF AL GARRISON STREET, ON THE SOUTH SIDE OF CRAIG ROAD.
 ELEVATION = 726.815 METERS (NAVD '88)
 ELEVATION = 2384.56 FEET (NAVD '88)

BASIS OF BEARING
 NORTH 87°08'54" EAST, BEING THE SOUTH LINE OF THE SOUTHWEST QUARTER OF THE SOUTHWEST QUARTER OF SECTION 1, TOWNSHIP 20 SOUTH, RANGE 59 EAST, M.D.M., CLARK COUNTY, NEVADA AND BEING THE CENTERLINE OF ALEXANDER ROAD, AS SHOWN BY MAP ON FILE IN BOOK 89 OF SURVEYS, PAGE 03 OF OFFICIAL RECORDS, CLARK COUNTY, NEVADA RECORDS.

DRAINAGE / EASEMENT NOTE
 ALL DRAINAGE EASEMENTS ARE TO BE PRIVATELY MAINTAINED BY HOA.

Call before you Dig.
 1-800-227-2600
 (HOODSOUND SERVICE ALERT 24/7)

Call before you OVERHEAD
 1-702-593-6111
 (NEVADA POWER DIVISION AND UTILITY SERVICE DEPARTMENT)

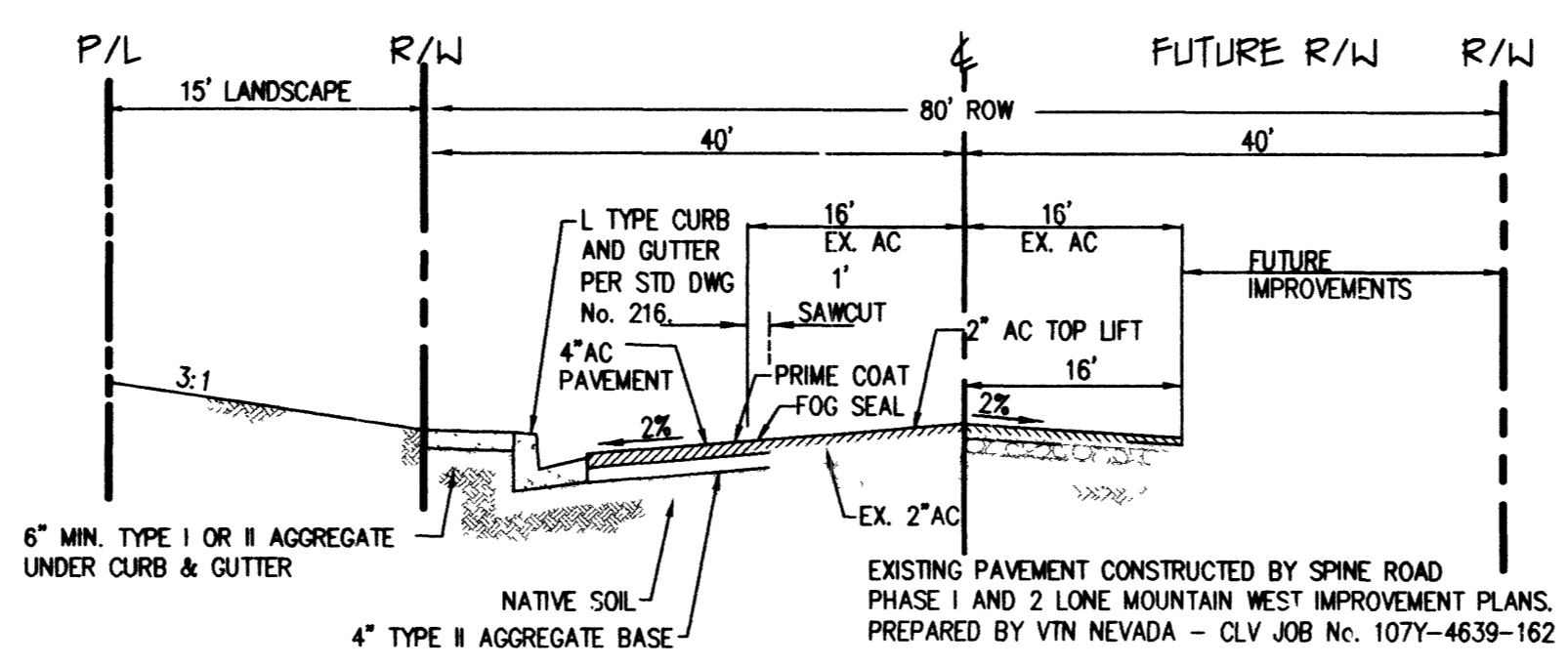
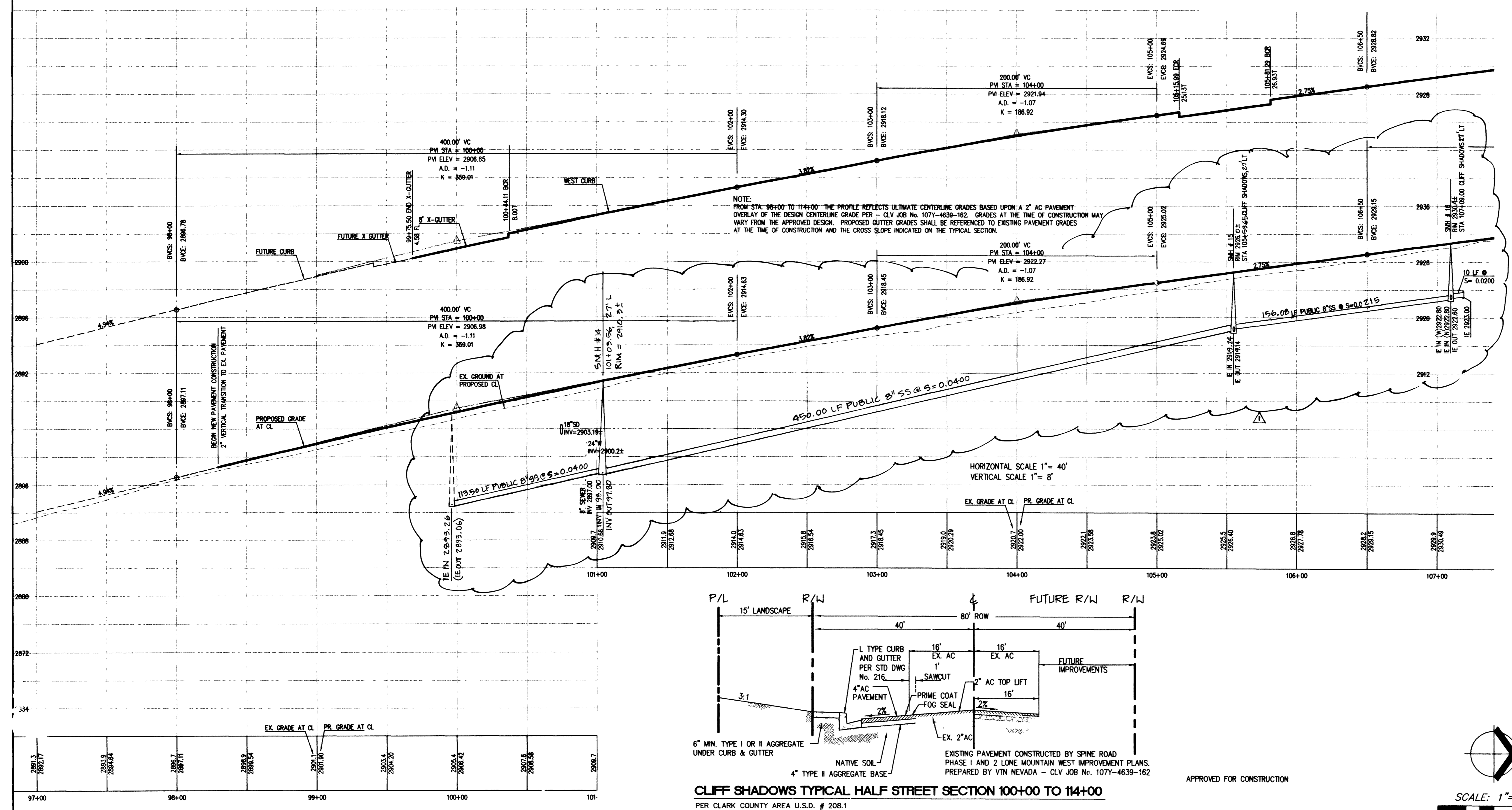

CLIFF SHADOWS TYPICAL HALF STREET SECTION 100+00 TO 114+00
 PER CLARK COUNTY AREA U.S.D. # 208.1

APPROVED FOR CONSTRUCTION
 LAS VEGAS VALLEY WATER DISTRICT
 DATE

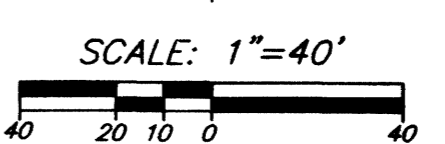

43928 56812

KIMBALL HILL HOMES • LONE MOUNTAIN WEST UNIT 1
CLIFF SHADOWS PKWY (S) - PLAN AND PROFILE
 CITY OF LAS VEGAS
 PORTION OF SECTION 1, TOWNSHIP 20 SOUTH, RANGE 59 EAST
 M.D.M., CLARK COUNTY, NEVADA

DATE 9/26/01
 DESIGNED BY B. JONES
 ENGINEER J. HITCHEN
 CHECKED
 SCALE 1" = 40' HORIZ
 W R G PROJECT NO. KH1003

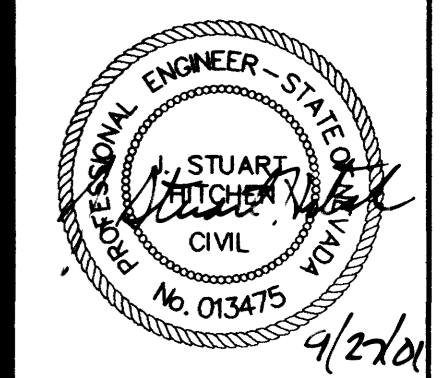

SHEET TITLE **PLAN & PROFILE**
 SHEET NUMBER **PP1**
C10 OF 20
 CLV DRAWING NO. 307Y-4678-1

DATE	9/26/01
DESIGNED BY	B. JONES
ENGINEER	J. HITCHEN
CHECKED	
SCALE	1" = 40' HORIZ
W R G PROJECT NO.	KH1003
REV	DATE BY
1	
2	
3	
4	
5	
6	
7	
8	
9	
10	
11	
12	
13	
14	
15	
16	
17	
18	
19	
20	
21	
22	
23	
24	
25	
26	
27	
28	
29	
30	
31	
32	
33	
34	
35	
36	
37	
38	
39	
40	
41	
42	
43	
44	
45	
46	
47	
48	
49	
50	
51	
52	
53	
54	
55	
56	
57	
58	
59	
60	
61	
62	
63	
64	
65	
66	
67	
68	
69	
70	
71	
72	
73	
74	
75	
76	
77	
78	
79	
80	
81	
82	
83	
84	
85	
86	
87	
88	
89	
90	
91	
92	
93	
94	
95	
96	
97	
98	
99	
100	

KIMBALL HILL HOMES
 3091 PASEO MOUNTAIN AVE.
 HENDERSON, NV 89014
 (702) 887-0213

DESIGN INC
 2260 Corporate Circle, Ste 430 Henderson, NV 89014
 (702) 1980-9300 FAX: 702 1980-9305
 PLANNERS • ENGINEERS • LANDSCAPE ARCHITECTS • SURVEYORS