

- INSPECTIONS ARE REQUIRED. CALL 24 HOURS IN ADVANCE, 455-4810.
- PROPER SIGNS, BARRIERS, BARRICADES AND LIGHTS SHALL BE PLACED AND MAINTAINED IN ACCORDANCE WITH THE LATEST MANUAL ON UNIFORM TRAFFIC CONTROL DEVICES FOR STREETS AND HIGHWAYS AS PUBLISHED BY THE U.S. DEPARTMENT OF COMMERCE.
- THIS PLAN DOES NOT AUTHORIZE CLOSURE OF ANY ROAD OR STREET.
- TRAFFIC SCHOOL OR STREET SIGNS OF ANY KIND ARE NOT TO BE MOVED FOR ANY REASON WITHOUT FIRST OBTAINING PERMISSION FROM THE DEPARTMENT OF PUBLIC WORKS, TRAFFIC MANAGEMENT DIVISION.
- ALL WORK AUTHORIZED BY THIS PLAN SHALL CONFORM TO THE "UNIFORM STANDARD SPECIFICATIONS AND STANDARD DRAWINGS, CLARK COUNTY AREA, NEVADA" AND "CLARK COUNTY SUPPLEMENT TO UNIFORM STANDARD DRAWINGS AND SPECIFICATIONS", LATEST REVISION.
- NO OPEN TRENCH SHALL BE ALLOWED ACROSS ANY STREET OR WITHIN TEN FEET (10') OF ANY TRAVEL-WAY, EXCEPT WHEN WORK IS IN ACTUAL PROGRESS. AREAS COVERED BY ACCEPTABLE STEEL PLATES ARE NOT TO BE CONSIDERED AS A TRENCH. NO OPEN TRENCH PERMITTED IN EXCESS OF 500 FEET OR LENGTH NECESSARY TO ACCOMMODATE PIPE INSTALLATION IN A SINGLE DAY, WHICHEVER IS GREATER.
- A TEMPORARY PATCH IS TO BE IN PLACE AT THE END OF EACH WORK DAY WHERE THE BACKFILL IN THE TRENCH HAS BEEN COMPLETED AND PRIOR TO OPENING THE WORK AREA BACK TO THE TRAFFIC AND IS TO BE MAINTAINED BY THE PERMITTEE. A PERMANENT PATCH IS TO BE IN PLACE WITHIN THIRTY (30) DAYS AFTER THE INSTALLATION OF THE TEMPORARY PATCH.
- COMPACTION TESTS ARE REQUIRED.
- YOUR PERMIT, APPROVED PLANS, AND BARRICADE PLANS FOR THIS WORK MUST BE ON THE JOB SITE AT ALL TIMES.
- ALL TRENCH CROSSINGS AND BACKFILL SHALL MEET THE STANDARD SPECIFICATION UNLESS OTHERWISE STATED.

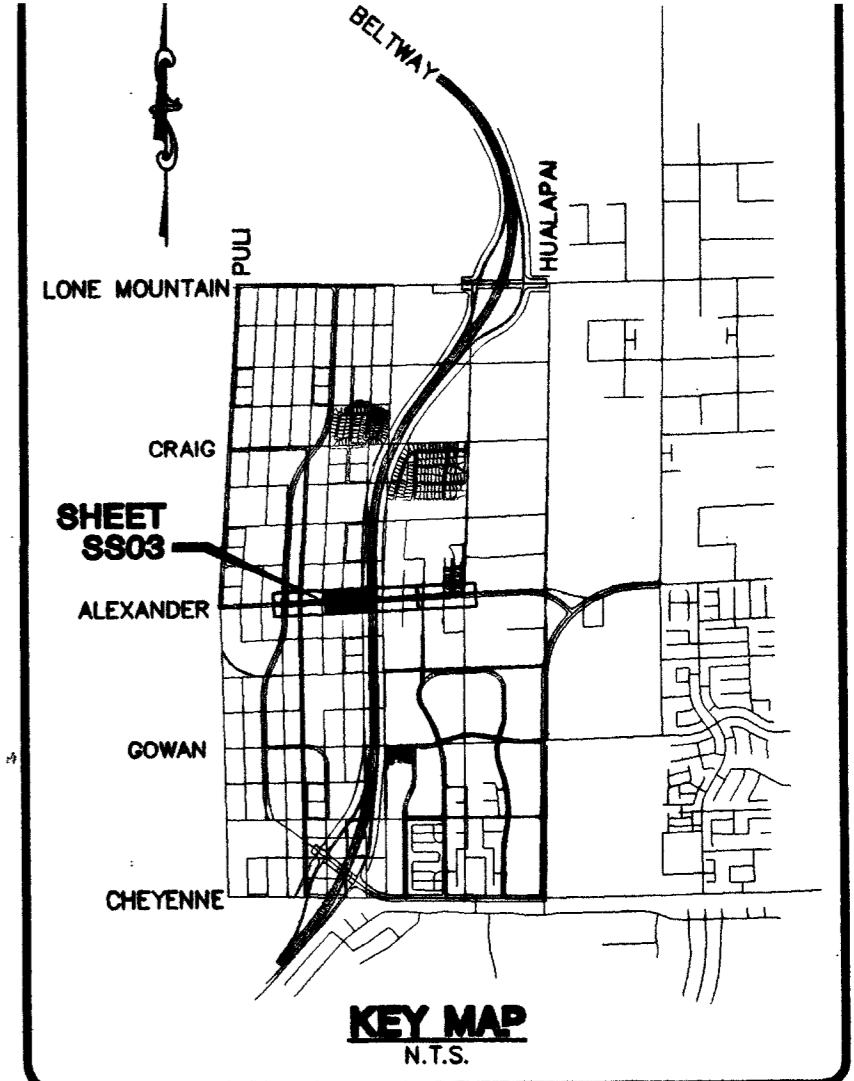

ALEXANDER ROAD (PUBLIC)

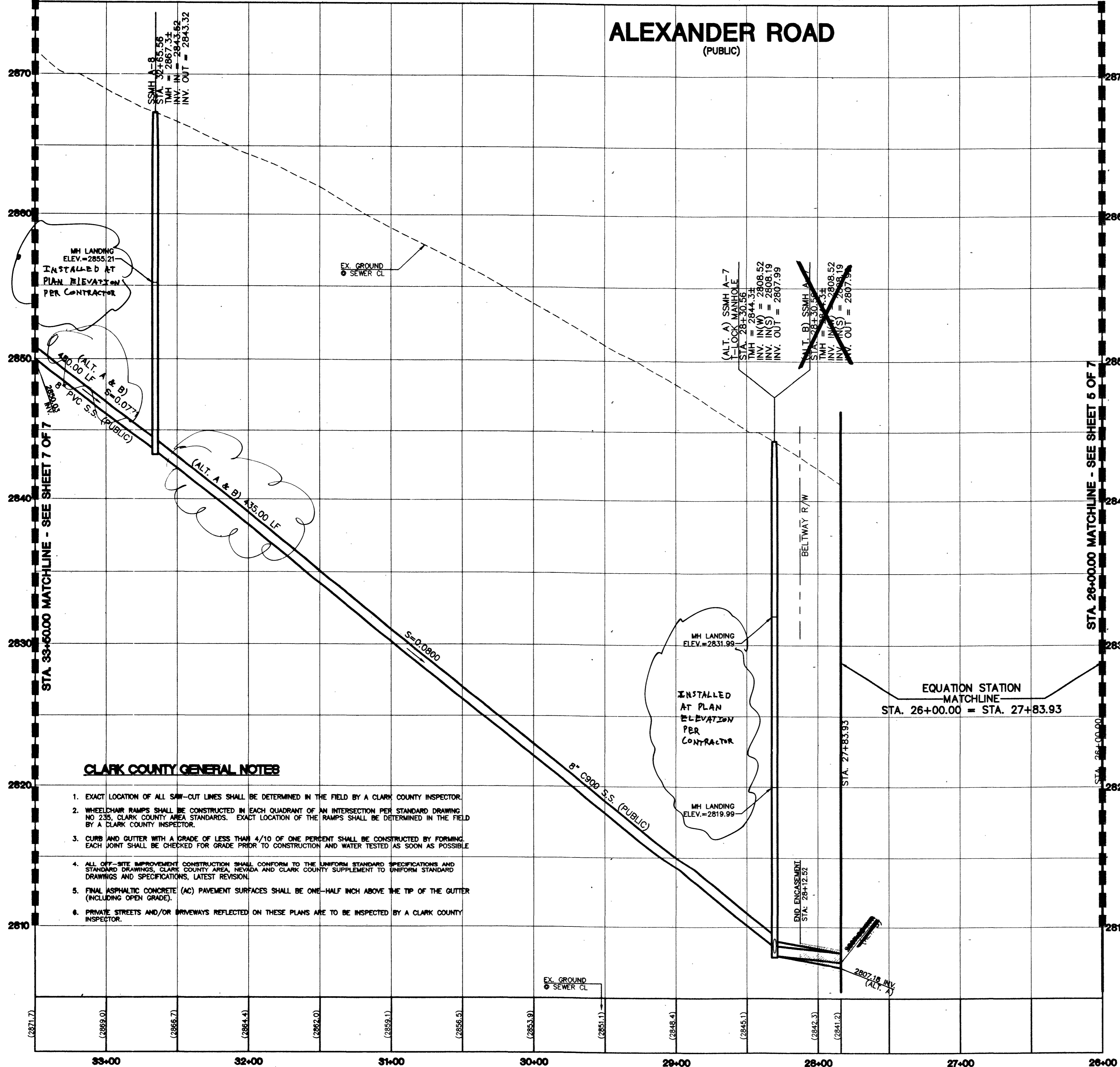

BENCHMARK
PROJECT VERTICAL DATUM: NAVD88
CITY OF LAS VEGAS BENCHMARK 1LV00-45ES
NAVD88 ELEV: 713.8497 METERS (2342.02 FEET)
RIVET AND PLATE IN TOP OF CURB, NORTHWEST RETURN OF ALEXANDER ROAD AND BUFFALO DRIVE.

BASIS OF BEARINGS
THE BASIS OF BEARINGS FOR THIS PROJECT IS GRID NORTH AS DEFINED BY THE NEVADA COORDINATE SYSTEM OF 1983 (NCS83), EAST ZONE, (2701), DETERMINED BY CLARK COUNTY GIS CONTROL POINTS 808, 819, AND 877, AS SHOWN ON A RECORD OF SURVEY ON FILE IN THE CLARK COUNTY, NEVADA, RECORDER'S OFFICE, IN BOOK 88 OF SURVEYS, AT PAGE 53.

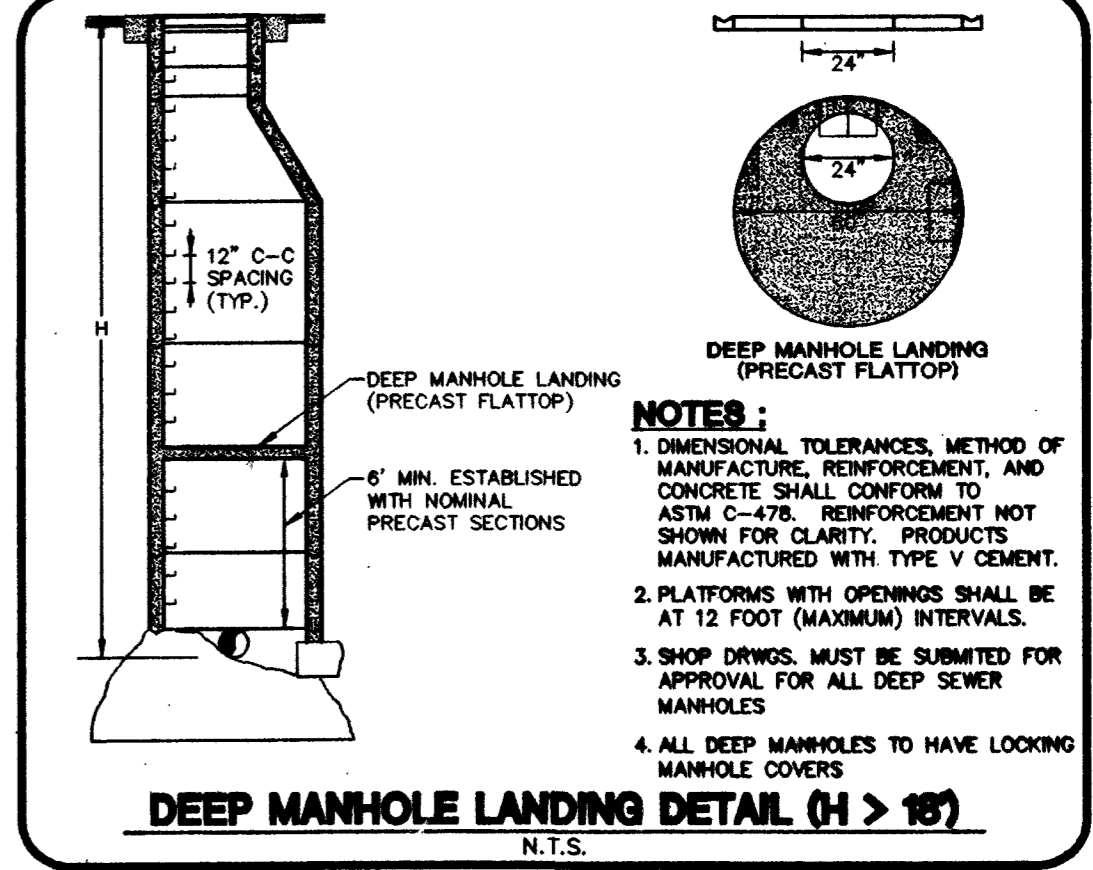

- NOTES:**
- CONTRACTOR SHALL VERIFY HORIZONTAL AND VERTICAL LOCATION OF EXISTING UTILITIES AND NOTIFY THE DESIGN ENGINEER IMMEDIATELY OF ANY DISCREPANCIES PRIOR TO CONSTRUCTION.
 - ALTERNATE "B" DESIGN IS FOR BIDDING PURPOSES ONLY, NOT FOR CONSTRUCTION.
 - THE DEPTH OF THE PROPOSED SANITARY SEWER IS REQUIRED TO SERVICE THE PROPERTIES WEST OF THE OF THE FUTURE BELTWAY SOUTH OF ALEXANDER ROAD.
 - C900 PIPE SHALL BE USED FOR ALL SEWER WITH DEPTHS GREATER THAN 25'.
 - STEEL CASING TO BE CONSTRUCTED PER "DESIGN AND CONSTRUCTION STANDARDS FOR WASTEWATER COLLECTION SYSTEMS - 1997" STD. DWG. NO. SD-22. 12" ALT. "A" - 24" STEEL CASING (THICKNESS=0.25") 8" ALT. "B" - 16" STEEL CASING (THICKNESS=0.25") (NOTE: REDWOOD SKIDS NOT ALLOWED. SHOP DRAWINGS FOR SKIDS SHALL BE SUBMITTED AND APPROVED PRIOR TO CONSTRUCTION.)
 - ANY OBLITERATED PAVEMENT MARKINGS ARE TO BE REPLACED WITH CLARK COUNTY APPROVED EQUIVALENT.

*All manholes are Clean Break
All Pipes is 5-M manufacturing*

*DOW Industries
As-Built
4/5/03 m.m.*

- CLARK COUNTY GENERAL NOTES**
- EXACT LOCATION OF ALL SAW-CUT LINES SHALL BE DETERMINED IN THE FIELD BY A CLARK COUNTY INSPECTOR.
 - WHEELCHAIR RAMPS SHALL BE CONSTRUCTED IN EACH QUADRANT OF AN INTERSECTION PER STANDARD DRAWING NO 235, CLARK COUNTY AREA STANDARDS. EXACT LOCATION OF THE RAMPS SHALL BE DETERMINED IN THE FIELD BY A CLARK COUNTY INSPECTOR.
 - CURB AND GUTTER WITH A GRADE OF LESS THAN 4/10 OF ONE PERCENT SHALL BE CONSTRUCTED BY FORMING. EACH JOINT SHALL BE CHECKED FOR GRADE PRIOR TO CONSTRUCTION AND WATER TESTED AS SOON AS POSSIBLE.
 - ALL OFF-SITE IMPROVEMENT CONSTRUCTION SHALL CONFORM TO THE UNIFORM STANDARD SPECIFICATIONS AND STANDARD DRAWINGS, CLARK COUNTY AREA, NEVADA AND CLARK COUNTY SUPPLEMENT TO UNIFORM STANDARD DRAWINGS AND SPECIFICATIONS, LATEST REVISION.
 - FINAL ASPHALTIC CONCRETE (AC) PAVEMENT SURFACES SHALL BE ONE-HALF INCH ABOVE THE TIP OF THE GUTTER (INCLUDING OPEN GRADE).
 - PRIVATE STREETS AND/OR DRIVEWAYS REFLECTED ON THESE PLANS ARE TO BE INSPECTED BY A CLARK COUNTY INSPECTOR.

CLARK COUNTY
DEPARTMENT OF PUBLIC WORKS
FOR CLARK COUNTY PORTION
Accepted as prepared by
Jack Blumson
Approval of these plans for
they shall not be construed
to be a permit for or an approval
of any violation of any of the
provisions of the state or county
laws and/or specifications. Clark
County shall be held free from
damages which may result from the
construction of the improvements
from the engineering design
depicted herein.
NOTE: Power poles and/or other
existing facilities not in proper
location based on proposed improve-
ments shown herein will be re-
located at no expense to Clark
County.

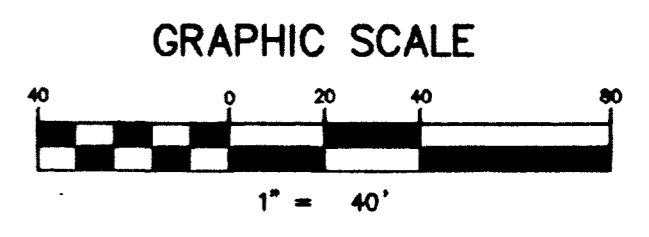

Call before you Dig
1-800-227-2600

Call before you Overhead
1-702-593-6111

STANPARK HOMES
3320 N. BUFFALO DRIVE, SUITE 207
LAS VEGAS, NEVADA 89129
PHONE (702)398-3887

novada CONSULTING ENGINEERS • PLANNERS • LAND SURVEYORS

SEWER PLAN AND PROFILE
STA 26+00.00 TO STA 33+50.00

LONE MOUNTAIN WEST
ALEXANDER ROAD
OFFSITE SEWER

2727 SOUTH RAILROAD BOULEVARD LAS VEGAS, NEVADA 89146-5148
PH. (702) 873-7550 FAX (702) 362-2597

DRAWN BY:	01-01	01-01	01-01
DESIGNED BY:	AL/268/2/06		
CHECKED BY:	CRG		
PROJECT NO.:	5545-05-A		
SCALE:	1"=40'	HORIZ.	1"=4' VERT.

DATE: 7/22/06

SHEET
SS03
6 OF 7 SHEETS
DRAWING NO.
3071-4678