

**BENCHMARK**  
 PROJECT VERTICAL DATUM: NAVD88  
 CITY OF LAS VEGAS BENCHMARK 1LV00-4SES  
 NAVD88 ELEV: 713.8497 METERS (2342.02 FEET)

RIVET AND PLATE IN TOP OF CURB, NORTHWEST RETURN OF ALEXANDER ROAD AND BUFFALO DRIVE

**BASIS OF BEARINGS:**  
 NORTH 87°08'14" BEING THE BEARING OF THE SOUTH LINE OF THE SOUTHEAST QUARTER (SE 1/4) OF THE SOUTHWEST QUARTER (SE 1/4) OF SECTION 1, TOWNSHIP 20 SOUTH, RANGE 59 EAST, AS SHOWN ON A RECORD OF SURVEY ON FILE IN THE CLARK COUNTY, NEVADA, RECORDER'S OFFICE, IN FILE 89 OF SURVEYS, AT PAGE 3.

NOTE: CONTRACTOR SHALL VERIFY HORIZONTAL AND VERTICAL LOCATION OF EXISTING UTILITIES AND NOTIFY THE DESIGN ENGINEER IMMEDIATELY OF ANY DISCREPANCIES PRIOR TO CONSTRUCTION.

Call before you dig  
 1-702-593-6111

Call before you dig  
 1-800-227-2800

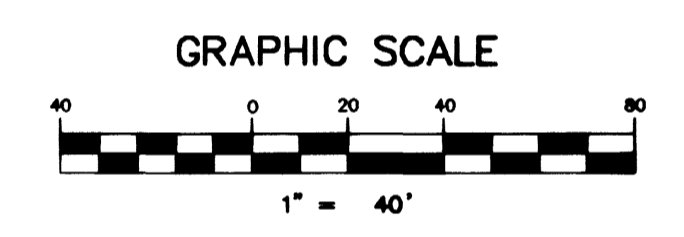

NOTE:  
 ALL MH STATIONING IS BASED ON SEWER LENGTHS FROM MANHOLE TO MANHOLE. ALL MANHOLES ARE 48" SIZE MANHOLES PER STD.DWG# SD-1.

**WELLINGTON MANOR DRIVE**  
 (PRIVATE STREET, P.U.E. AND CLV SEWER EASEMENT AND PUBLIC DRAINAGE EASEMENT TO BE PRIVATELY MAINTAINED)

**PROFILE**  
 SCALE: 1"=40' HORIZ.  
 1"=4' VERT.

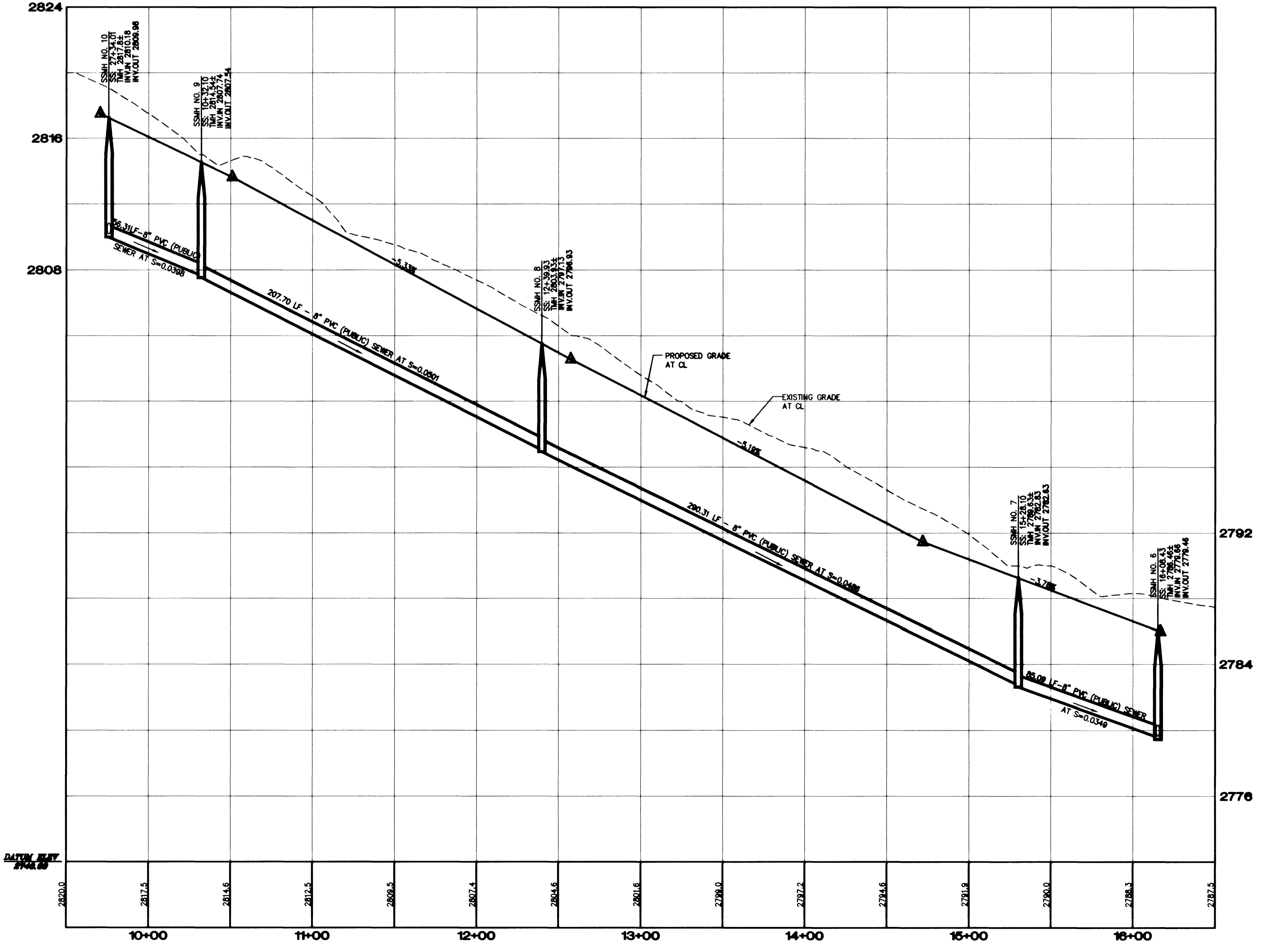

UNDEVELOPED NOT A PART  
 APN: 137-01-801-002

**KAUFMAN AND BROAD**  
 750 W. FLORISSA AVE., SUITE 80119  
 LAS VEGAS, NEVADA 89119  
 (702) 614-2500

2727 SOUTH RAINBOW BOULEVARD LAS VEGAS, NEVADA 89146-5148  
 PH. (702) 873-7550 FAX (702) 862-2597

**vtm nevada** CONSULTING ENGINEERS • LAND SURVEYORS

SHEET  
**SEWER PLAN AND PROFILE**  
**WELLINGTON MANOR DRIVE**

TITLE  
**LONE MOUNTAIN HEIGHTS**  
**UNIT 1**

DRAWN BY: B-29-00  
 DESIGNED BY: B-29-00  
 CHECKED BY: B-29-00  
 PROJECT NO: 5778

SCALE: 1"=40' HORIZ.  
 1"=4' VERT.

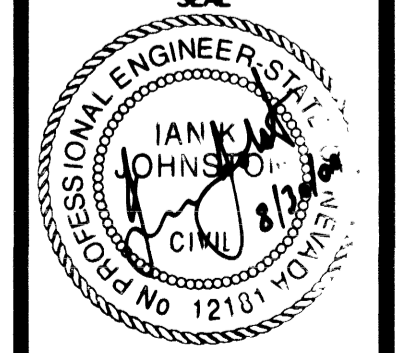

SHEET  
**552**  
 10 OF 21 SHEETS  
 DRAWING NO.  
 307Y-4646-1

25575