

**REDUCED PRESSURE PRINCIPLE ASSEMBLY (1)**

Approved Reduced Pressure Principle Assembly(s) shall be installed per the UDACS Plate No. 11A. No water shall be taken from a service requiring backflow prevention until the reduced pressure principle assembly has been successfully tested by the LVVWD.

Any block wall or other fence material shall be designed and constructed around the outside of the easement(s) to allow the District direct access from the adjacent right-of-way.

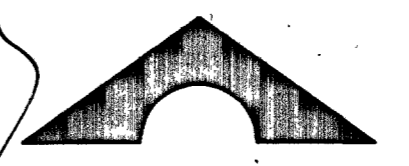

NORTH 1" = 40'

NOTE: PRIVATE STREETS ARE P.U.E.'S, PUBLIC SEWER EASEMENTS, AND PUBLIC DRAINAGE EASEMENTS TO BE PRIVATELY MAINTAINED BY HOME OWNERS ASSOCIATION

**FIRE FLOW**

TYPE OF CONSTRUCTION - V NON RATED  
 REQUIRED FIRE FLOW = 1500 G.P.M.  
 NON SPRINKLERED BUILDINGS  
 SQUARE FOOTAGE FROM 1800 SF TO 3000 SF

**FIRE HYDRANT AND LATERAL ABANDONMENT**  
 (Existing Lateral to be Abandoned)

WHERE SHOWN ON THE DRAWING(S), THE CONTRACTOR SHALL ABANDON THE EXISTING FIRE HYDRANT(S) BY REMOVING BOTH THE UPPER AND LOWER BARRELS OF THE FIRE HYDRANT SO THAT NO PORTION OF THE REMAINING FIRE HYDRANT ASSEMBLY IS CLOSER THAN TWO (2) FEET TO THE EXISTING GRADE. THE EXISTING VALVE SHALL BE ABANDONED IN A CLOSED POSITION AND A MINIMUM OF THE TOP 12 INCHES OF THE VALVE BOX REMOVED. THE REMAINING PORTION OF THE VALVE BOX SHALL BE FILLED WITH CONCRETE HAVING A COMPRESSIVE STRENGTH OF AT LEAST 2,000 PSI. THE LATERAL SHALL BE CUT AND CAPPED WHERE INDICATED. WHERE A JOINT OR COUPLING IN THE EXISTING PIPE IS UNCOVERED AT THE CUT AND CAP LOCATION, THE INSTALLATION OF A PLUG MAY BE PERMITTED, WITH THE DISTRICT APPROVAL. A CONCRETE THRUST BLOCK SHALL BE INSTALLED AT ALL CUT AND CAP LOCATIONS IN ACCORDANCE WITH THE PROVISIONS OF UDACS PLATE NO. 5. THE EXISTING CONCRETE FIRE HYDRANT PAD SHALL BE REMOVED.

SERVICE LATERALS FOR LOTS: 229, 284, 285, 286 WILL BE TAPPED ON EXISTING MAIN BY OWNER'S CONTRACTOR UNDER DIRECTION OF THE LVVWD.

NOTE: FOR SANITARY REWER MANHOLE TABLE, PLEASE REFER TO SHEET CL.

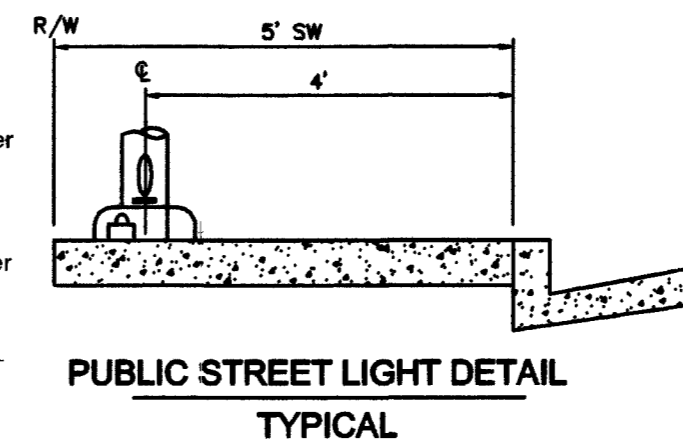
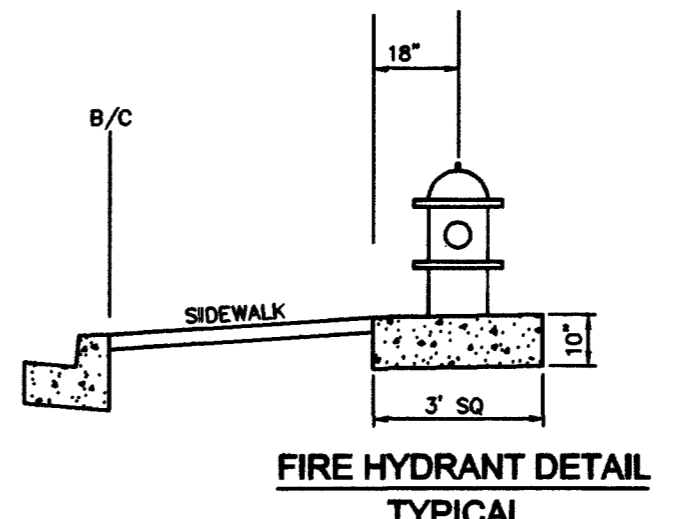

**CONSTRUCTION NOTES**

- 1 8" TEE - PUBLIC
- 2 8" GATE VALVE - PUBLIC
- 3 8" 90° ELBOW - PUBLIC
- 4 CAP AND 2" BLOW OFF VALVE (UDACS 4) - PUBLIC
- 5 FIRE HYDRANT ASSEMBLY INCLUDING 8" x 6" TEE AND 6" G.V. IN ACCORDANCE WITH (UDACS PLATE #7) - PUBLIC
- 6 5/8" METER (UDACS 1-B) - PUBLIC
- 7 4" PVC CONDUIT (IRRIGATION XINGS) - PRIVATE
- 8 1" METER WITH RPPA (PER UDACS 1B+12.A) - PUBLIC
- 9 8" CROSS - PUBLIC
- 10 RELOCATE EXISTING FIRE HYDRANT ABANDON EXISTING F.H. LATERAL PER NOTE. INSTALL F.H. AT NEW LOCATION PER UDACS PLATE #7. INSTALL 8" x 6" TEE, 6" G.V. IN EXISTING 8" WATER LINE.
- 11 8" x 6" REDUCER
- 12 4" x 6" TEE - PUBLIC
- 13 FIRE HYDRANT ASSEMBLY INCLUDING 8" x 6" TEE, 6" G.V. IN ACCORDANCE WITH (UDACS PLATE #7) - PUBLIC

**LEGEND**

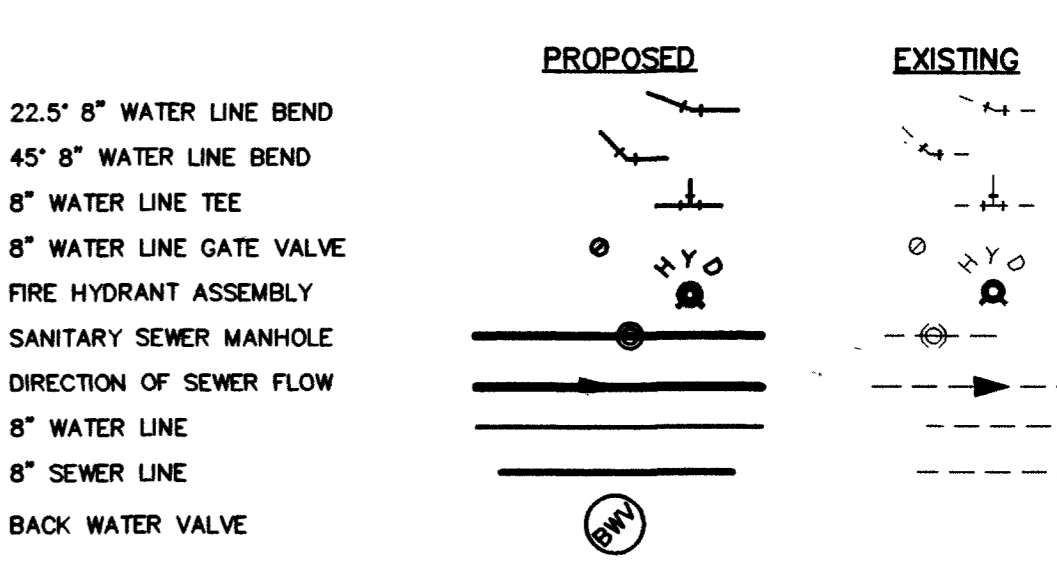

**VICINITY MAP**

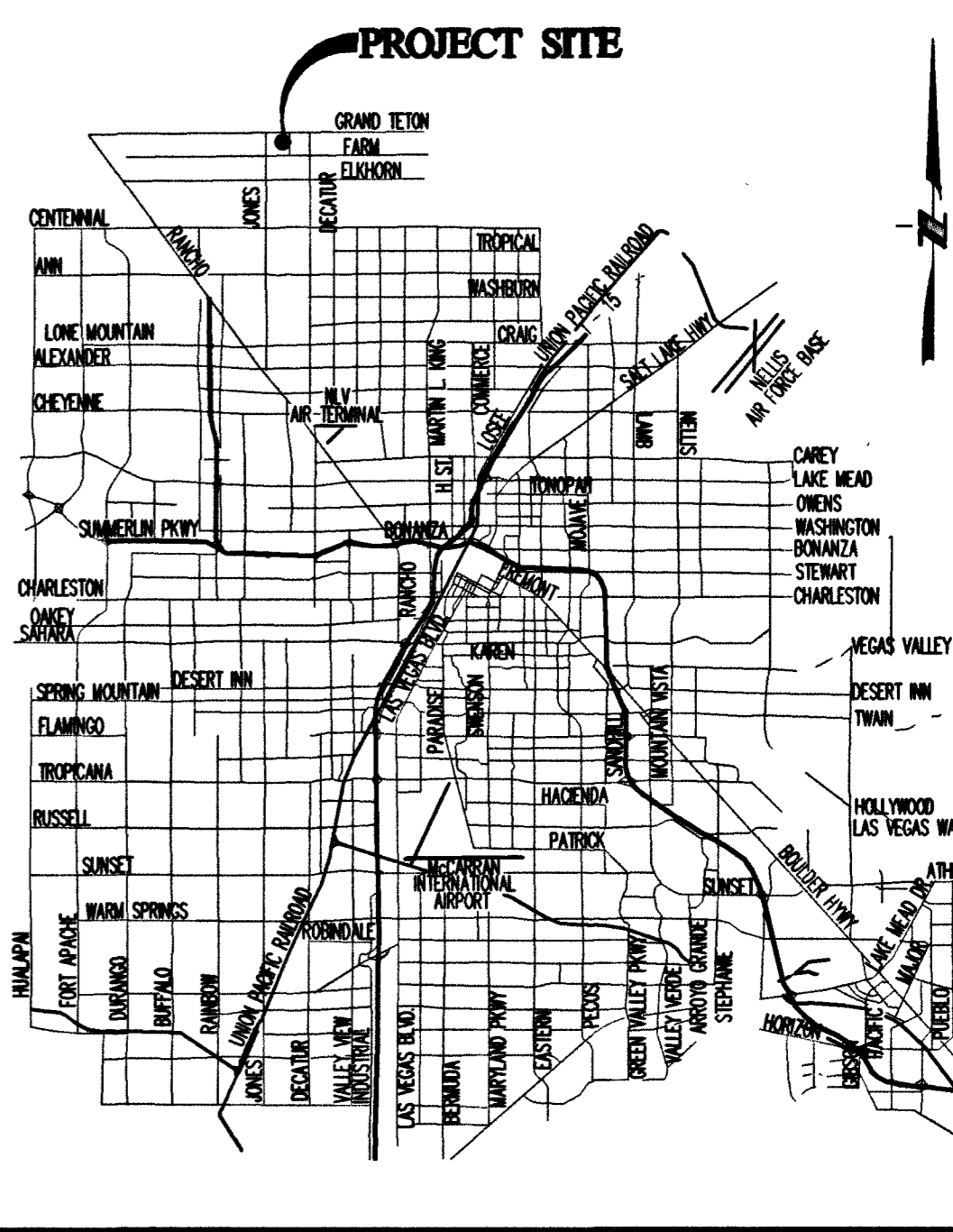

**ABBREVIATIONS**

AC	ASPHALTIC CONCRETE	RT	RIGHT-OF-WAY
BC	BACK OF CURB	SA	SANITARY SEWER
BVC	BEGINNING OF VERTICAL CURVE	SD	STORM DRAIN
BM	BENCH MARK	STD	STANDARD
CATV	CABLE TELEVISION	ST	STREET LIGHT
CL	CENTERLINE	TC	TOP OF CURB
CC	CITY OF CLARK COUNTY	TD	TOP OF DRAIN
CO	CLEAN OUT	VB	VERTICAL
CV	CUBIC YARD	VC	VERTICAL CURVE
DI	DROP INLET	VG	VERTICAL GUTTER
DG	DESIGN GRADE	VW	VITRIFIED CLAY PIPE
EP	EDGE OF PAVEMENT	W	WATER
EC	END OF CURVE	WM	WATER METER
EVC	END OF VERTICAL CURVE		
EX	EXISTING		
FG	FINISH GRADE		
FF	FINISH FLOOR ELEVATION		
FT	FEE		
FL	FIRE HYDRANT		
FB	FLOW LINE		
GB	GRADE BREAK		
GP	HIGH POINT		
HP	INVERT		
INV	LOWER FINISH FLOOR ELEVATION		
LF	LINEAR FEET		
LVVWD	LAS VEGAS VALLEY WATER DISTRICT		
MH	MANHOLE		
MIN	MINIMUM		
NIS	NOT TO SCALE		
OC	ON CENTER		
PI	POINT OF INTERSECTION		
PRC	POINT OF REVERSE CURVE		
PC	POINT OF CURVE		
PT	POINT OF TANGENCY		
PTO	PROP. TOP OF CURB (BY OTHERS)		
PTG	PROP. FINISH GRADE (BY OTHERS)		
PL	PROPERTY LINE		
PB	PULL BOX		
R	RADIUS		
RCB	REINFORCED CONCRETE BOX		
RCP	REINFORCED CONCRETE PIPE		

**SCALE**

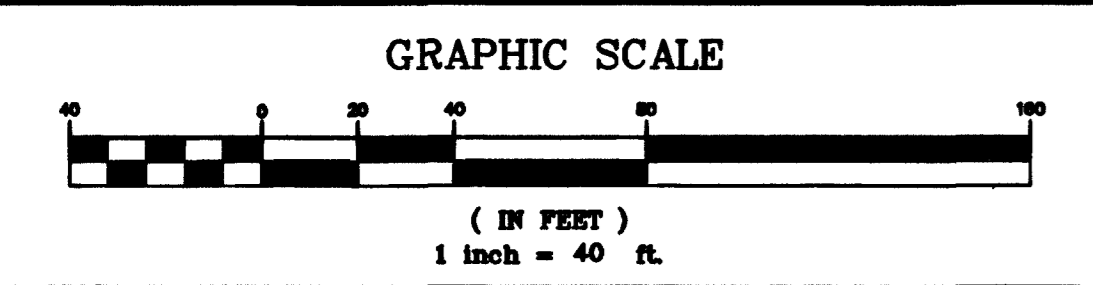

**BENCHMARK**

CITY OF LAS VEGAS BENCH MARK - 8LV80-16C4 RIVET AND PLATE IN TOP OF CURB AT SW CORNER OF FARM AND CIMARRON  
 NAVD88 ELEVATION = 754.2098 METERS (2474.44 FT)

**LEGAL DESCRIPTION**

THE SOUTH HALF (S1/2) OF THE SOUTH HALF (S1/2) OF THE NORTHWEST QUARTER (NW1/4) OF THE NORTHWEST QUARTER (NW1/4) OF SECTION 16, TOWNSHIP 19 SOUTH, RANGE 60 EAST, M.D.M., CLARK COUNTY, NEVADA.

**BASIS OF BEARING**

N001°37'34"E - BEING THE WEST LINE OF THE NORTHWEST QUARTER OF THE NORTHEAST QUARTER OF SECTION 16, TOWNSHIP 19 SOUTH, RANGE 60 EAST, M.D.M., COUNTY OF CLARK STATE OF NEVADA. AS SHOWN ON THE FINAL MAP OF LAMPLIGHT VILLAGE AT CENTENNIAL SPRINGS UNIT 2 RECORDED IN BOOK 88 ON PAGE 63, OFFICIAL RECORDS OF SAID COUNTY.

**KEY MAP**

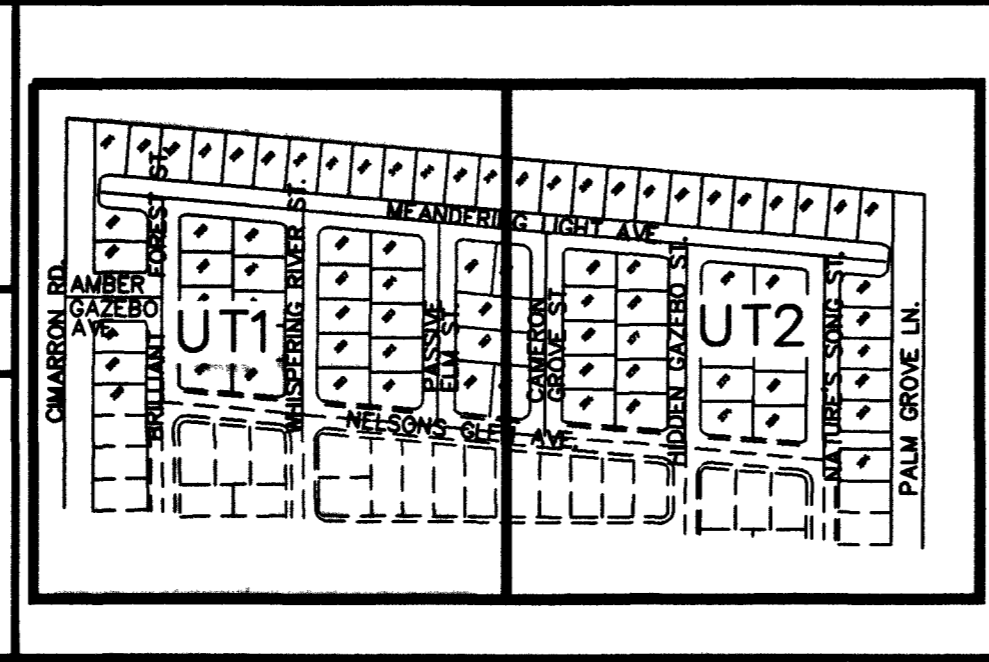

AVERAGE DAILY SEWER FLOW = 8250 G.P.D.  
 PEAK SEWER FLOW = 32,375 G.P.D.

Call Two Working Days Before You Dig!

Dig Safely. Dig Safely  
 1-800-227-2600

PROJECT NAME: Lamplight Village Unit 5  
 This project water plan complies with the Las Vegas Valley Water District's technical requirements. However, this water plan is NOT APPROVED FOR CONSTRUCTION at this time and this signature does not provide or imply a water commitment.  
 LVVWD #52  
 DATE: 9-2-02  
 DATE: 8.30.02

APPROVAL  
 LAS VEGAS VALLEY WATER DISTRICT  
 DATE: 10/30/02

NO.	DESCRIPTION	DATE	BY	APPR.

**CARINA CORPORATION**  
 2881 BUSINESS COURT, SUITE 210  
 LAS VEGAS, NEVADA 89128  
 (702) 228-6376 FAX: (702) 228-6002

**TANEY ENGINEERING**  
 4445 S. JONES BLVD., SUITE #1  
 LAS VEGAS, NV 89103  
 (702) 362-8844 FAX: (702) 362-5233

**LAMPLIGHT VILLAGE UNIT FIVE AT CENTENNIAL SPRINGS**

**UTILITY PLAN WEST**

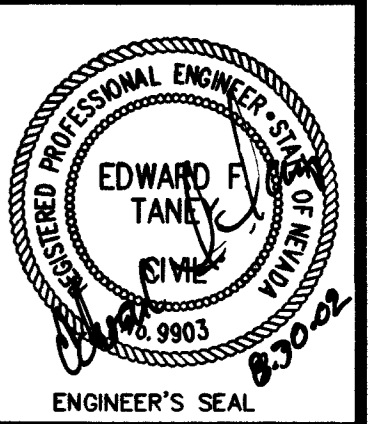

ENGINEER'S SEAL

DATE: 12-01  
 SCALE: 1" = 40'  
 JOB NO: CRN-00-001  
 DESIGNED BY: EFT  
 DRAWN BY: EFT/OGS  
 SHEET NAME: UT1  
 SHEET: 301Y-4642-5  
 6 OF 18