

CONSTRUCTION NOTES

- 1 8" TEE - PUBLIC
- 2 8" GATE VALVE - PUBLIC
- 3 8" 90° ELBOW - PUBLIC
- 4 CAP AND 2" BLOW OFF VALVE (UDACS 4) - PUBLIC
- 5 FIRE HYDRANT ASSEMBLY INCLUDING 8" X 6" TEE AND 6" G.V. IN ACCORDANCE WITH (UDACS PLATE #7) - PUBLIC
- 6 5/8" METER (UDACS 1-B) - PUBLIC
- 7 4" PVC CONDUIT (IRRIGATION XINGS) - PRIVATE
- 8 1" METER WITH RPPA (UDACS 1-C OR 1-D) - PUBLIC
- 9 8" CROSS - PUBLIC
- 10 RELOCATE EXISTING FIRE HYDRANT ABANDON EXISTING F.H. LATERAL PER NOTE. INSTALL F.H. AT NEW LOCATION PER UDACS PLATE #7. INSTALL 8" X 6" TEE, 6" G.V. IN EXISTING 8" WATER LINE.
- 11 8" X 6" REDUCER
- 12 10" X 8" TEE - PUBLIC
- 13 FIRE HYDRANT ASSEMBLY INCLUDING 10" X 6" TEE AND 6" G.V. IN ACCORDANCE WITH (UDACS PLATE #7) - PUBLIC

LEGEND

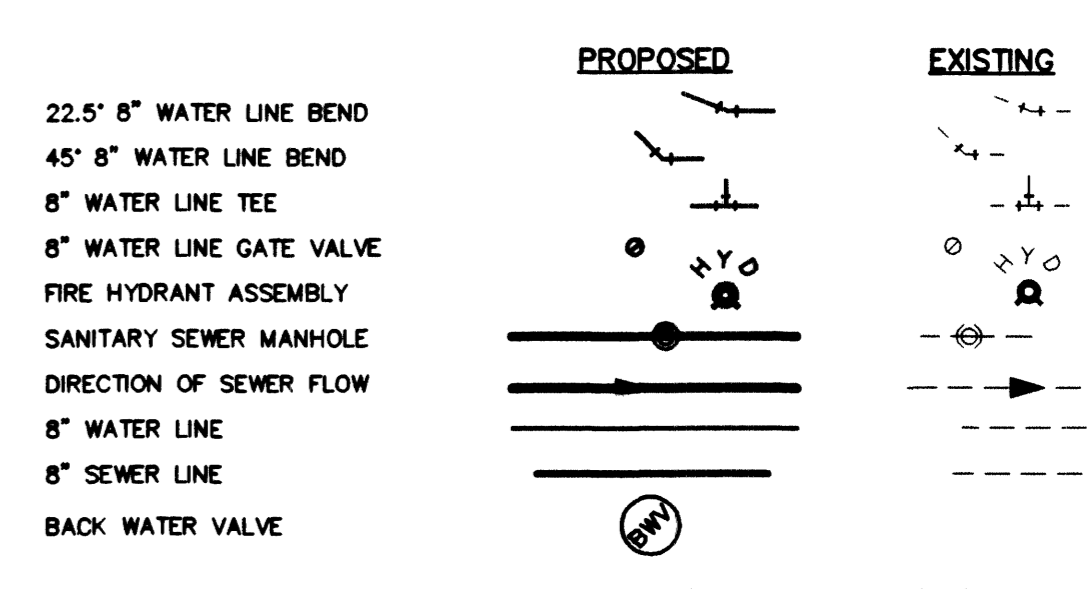

VICINITY MAP

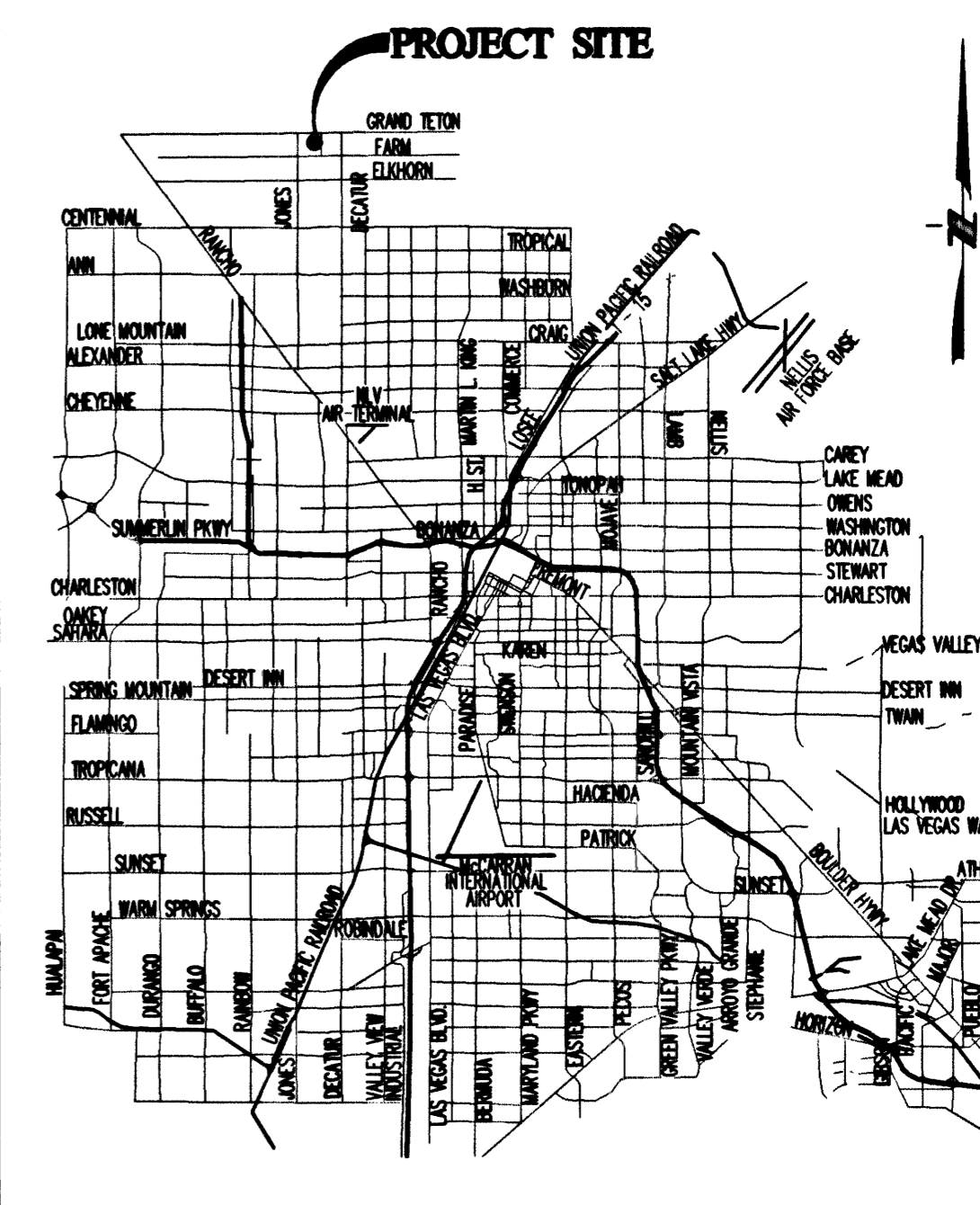

ABBREVIATIONS

AC	ASPHALTIC CONCRETE	RT	RIGHT-OF-WAY
BC	BACK OF CURB	R/W	RIGHT-OF-WAY
BVC	BACK OF CURB RADIUS	SW	SANITARY SEWER
BM	BEGINNING OF VERTICAL CURVE	ST	STATION
CA	CABLE TELEVISION	SD	STANDARD
CL	CENTERLINE	STD	STANDARD
CC	CITY OF BOULDER CITY	STL	STREET LIGHT
CC	CLARK COUNTY	ST	STREET LIGHT
CO	CLEAN OUT	ST	STREET LIGHT
CO	CUBIC YARD	ST	STREET LIGHT
DI	DROP INLET	ST	STREET LIGHT
DG	DESIGN GRADE	ST	STREET LIGHT
EG	EDGE OF PAVEMENT	ST	STREET LIGHT
EVC	END OF CURVE	ST	STREET LIGHT
EVC	END OF VERTICAL CURVE	ST	STREET LIGHT
FC	FINISH GRADE	ST	STREET LIGHT
FG	FINISH FLOOR ELEVATION	ST	STREET LIGHT
FF	FIRE HYDRANT	ST	STREET LIGHT
FL	FIRE HYDRANT	ST	STREET LIGHT
FB	FIRE HYDRANT	ST	STREET LIGHT
HP	HIGH POINT	ST	STREET LIGHT
IN	INVERT	ST	STREET LIGHT
LF	LOWER FINISH FLOOR ELEVATION	ST	STREET LIGHT
LF	LINEAR FEET	ST	STREET LIGHT
LWWD	LAS VEGAS VALLEY WATER DISTRICT	ST	STREET LIGHT
MH	MANHOLE	ST	STREET LIGHT
MAX	MAXIMUM	ST	STREET LIGHT
MIN	MINIMUM	ST	STREET LIGHT
NTS	NOT TO SCALE	ST	STREET LIGHT
OC	ON CENTER	ST	STREET LIGHT
PRC	POINT OF INTERSECTION	ST	STREET LIGHT
PTC	POINT OF CURVE	ST	STREET LIGHT
PT	POINT OF TANGENCY	ST	STREET LIGHT
PTC	PROP. TOP OF CURB (BY OTHERS)	ST	STREET LIGHT
PFG	PROP. FINISH GRADE (BY OTHERS)	ST	STREET LIGHT
PL	PROPERTY LINE	ST	STREET LIGHT
PB	PULL BOX	ST	STREET LIGHT
R	RADIUS	ST	STREET LIGHT
RCB	REINFORCED CONCRETE BOX	ST	STREET LIGHT
RCP	REINFORCED CONCRETE PIPE	ST	STREET LIGHT

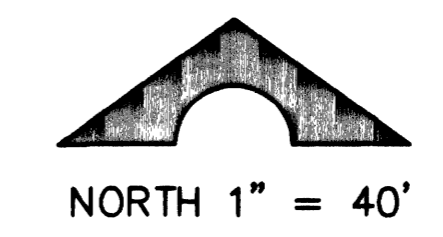

NOTE: PRIVATE STREETS ARE P.U.E.'S, PUBLIC SEWER EASEMENTS, AND PUBLIC DRAINAGE EASEMENTS TO BE PRIVATELY MAINTAINED BY HOME OWNERS ASSOCIATION

FIRE FLOW

TYPE OF CONSTRUCTION - V NON RATED
 REQUIRED FIRE FLOW = 1500 G.P.M.
 NON SPRINKLERED BUILDINGS
 SQUARE FOOTAGE FROM 1800 SF TO 3000 SF

FIRE HYDRANT AND LATERAL ABANDONMENT
 (Existing Lateral to be Abandoned)

WHERE SHOWN ON THE DRAWING(S), THE CONTRACTOR SHALL ABANDON THE EXISTING FIRE HYDRANT(S) BY REMOVING BOTH THE UPPER AND LOWER BARRELS OF THE FIRE HYDRANT SO THAT NO PORTION OF THE REMAINING FIRE HYDRANT ASSEMBLY IS CLOSER THAN TWO (2) FEET TO THE EXISTING GRADE. THE EXISTING VALVE SHALL BE ABANDONED IN A CLOSED POSITION AND A MINIMUM OF THE TOP 12 INCHES OF THE VALVE BOX REMOVED. THE REMAINING PORTION OF THE VALVE BOX SHALL BE FILLED WITH CONCRETE HAVING A COMPRESSIVE STRENGTH OF AT LEAST 2,000 P.S.I. THE LATERAL SHALL BE CUT AND CAPPED WHERE INDICATED. WHERE A JOINT OR COUPLING IN THE EXISTING PIPE IS UNCOVERED AT THE CUT AND CAP LOCATION, THE INSTALLATION OF A PLUG MAY BE PERMITTED, WITH THE DISTRICT APPROVAL. A CONCRETE THRUST BLOCK SHALL BE INSTALLED AT ALL CUT AND CAP LOCATIONS IN ACCORDANCE WITH THE PROVISIONS OF UDACS PLATE NO. 5. THE EXISTING CONCRETE FIRE HYDRANT PAD SHALL BE REMOVED.

SERVICE LATERALS FOR LOTS: 228, 284, 285, 286 WILL BE TAPPED ON EXISTING MAIN BY OWNER'S CONTRACTOR UNDER DIRECTION OF THE LWWD.

NOTE: FOR SANITARY SEWER MANHOLE TABLE PLEASE REFER TO SHEET Q1.

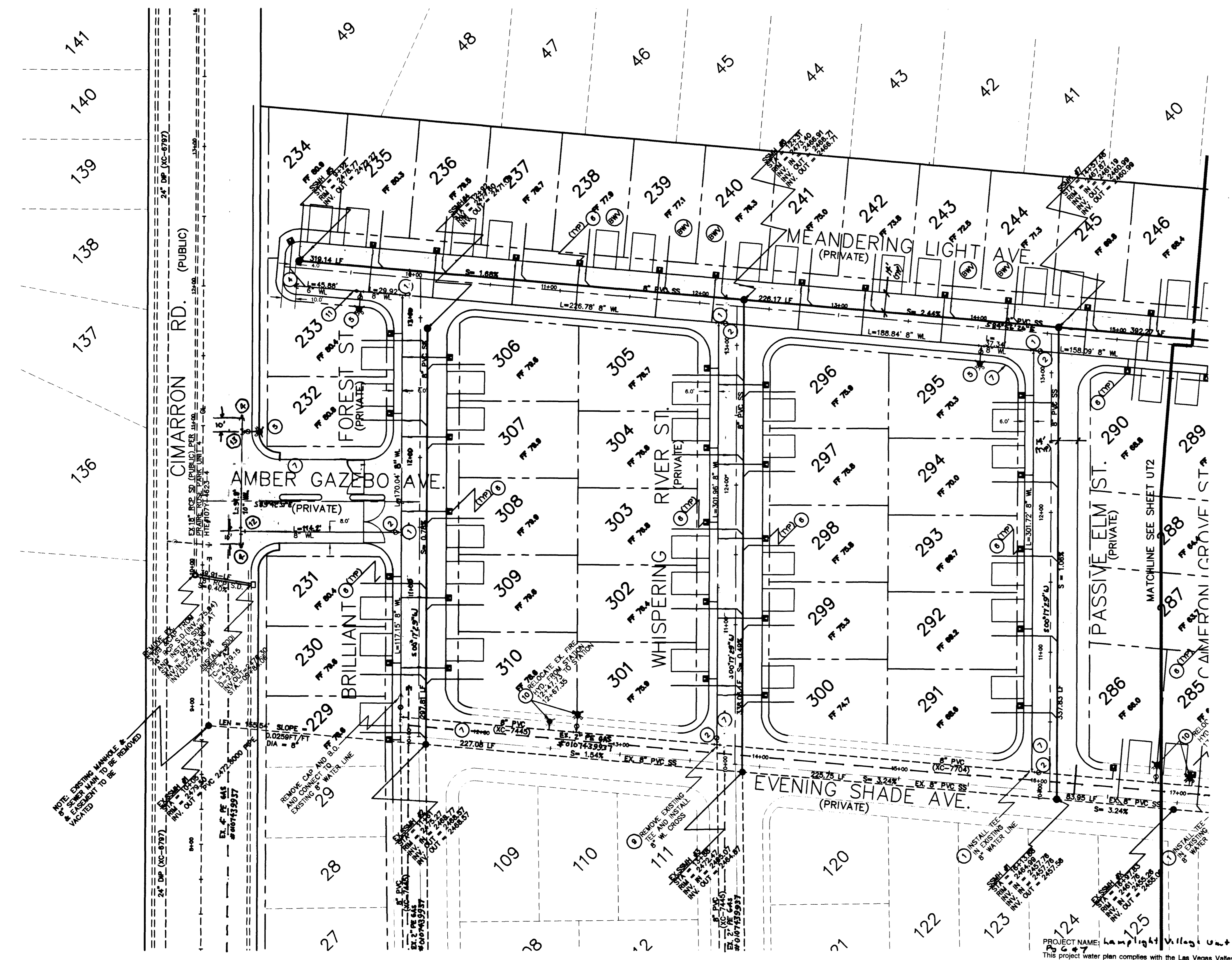
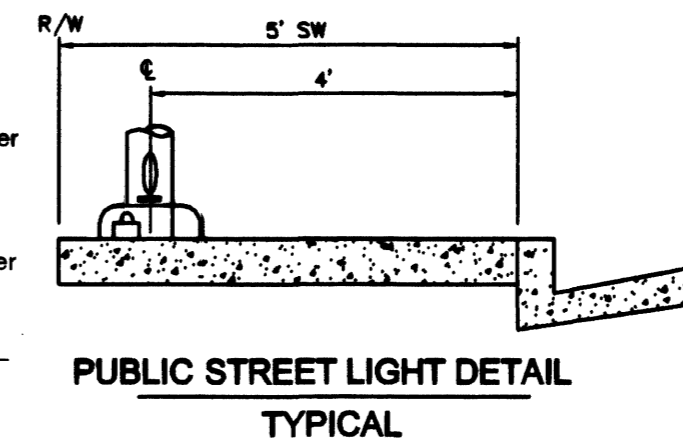
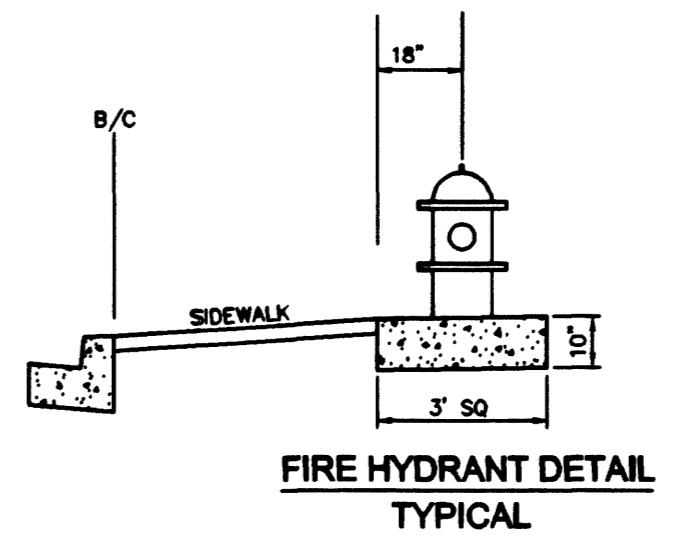

SCALE

GRAPHIC SCALE

(IN FEET)
1 inch = 40 ft.

LEGAL DESCRIPTION

THE SOUTH HALF (S1/2) OF THE SOUTH HALF (S1/2) OF THE NORTHWEST QUARTER (NW1/4) OF THE NORTHWEST QUARTER (NE1/4) OF SECTION 16, TOWNSHIP 19 SOUTH, RANGE 60 EAST, M.D.M., CLARK COUNTY, NEVADA.

BENCHMARK

CITY OF LAS VEGAS BENCH MARK - BLV90-18C4
 RIVET AND PLATE IN TOP OF CURB AT SW CORNER OF FARM AND CIMARRON

NAVD88 ELEVATION = 754.2088 METERS (2474.44 FT)

BASIS OF BEARING

N00°13'34"E - BEING THE WEST LINE OF THE NORTHWEST QUARTER OF THE NORTHWEST QUARTER OF SECTION 16, TOWNSHIP 19 SOUTH, RANGE 60 EAST, M.D.M., COUNTY OF CLARK, STATE OF NEVADA, AS SHOWN ON THE FINAL MAP OF LAMPLIGHT VILLAGE AT CENTENNIAL SPRINGS UNIT 2 RECORDED IN BOOK 98 ON PAGE 63, OFFICIAL RECORDS OF SAID COUNTY.

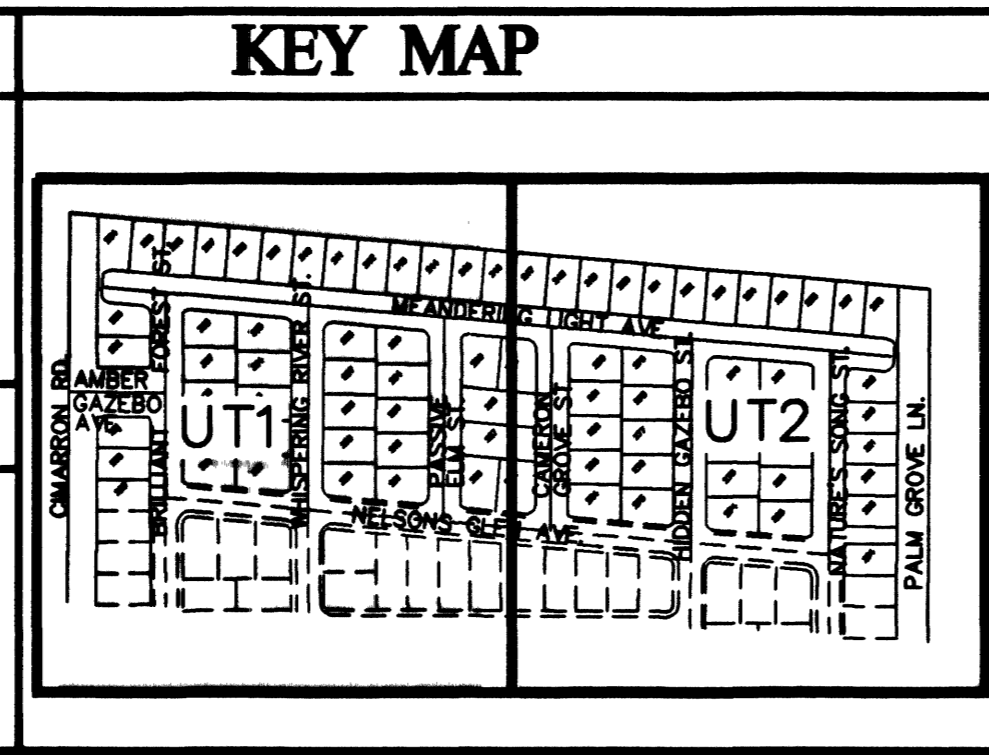

AVERAGE DAILY SEWER FLOW = 9250 G.P.D.
 PEAK SEWER FLOW = 32,375 G.P.D.

Call Two Working Days Before You Dig!

Dig Safely. Dig Safely
 1-800-227-2600

PROJECT NAME: Lamplight Village Unit 5
 This project water plan complies with the Las Vegas Valley Water District's technical requirements. However, this water plan is NOT APPROVED FOR CONSTRUCTION at this time and this signature does not provide or imply a water commitment.

LWWD #52 DATE: 7-2-02

APPROVAL: [Signature] DATE: 8-30-02

LAS VEGAS VALLEY WATER DISTRICT DATE:

REVISIONS

NO.	DESCRIPTION	BY	DATE

CARRA CORPORATION
 2881 BUSINESS COURT, SUITE 210
 LAS VEGAS, NEVADA 89126
 (702) 228-6376 FAX: (702) 228-6002

TANEY ENGINEERING
 4445 S. JONES BLVD., SUITE #1
 LAS VEGAS, NV 89103
 (702) 362-8844 FAX: (702) 362-5233

LAMPLIGHT VILLAGE UNIT FIVE AT CENTENNIAL SPRINGS

UTILITY PLAN WEST

EDWARD F. TANEY
 PROFESSIONAL ENGINEER STATE OF NEVADA
 LICENSE NO. 9903

ENGINEER'S SEAL

DATE: 12-01
 SCALE: 1" = 40'
 JOB NO: CRN-00-001
 DESIGNED BY: EFT
 DRAWN BY: EFT/OGS
 SHEET NAME: UT1
 SHEET: 307Y-4612-5
 6 OF 18