

NOTE: PRIVATE STREETS ARE P.U.E.'S, PUBLIC SEWER EASEMENTS, AND PUBLIC DRAINAGE EASEMENTS TO BE PRIVATELY MAINTAINED BY HOME OWNERS ASSOCIATION

FIRE FLOW

TYPE OF CONSTRUCTION - V NON RATED
 REQUIRED FIRE FLOW = 1500 G.P.M.
 NON SPRINKLERED BUILDINGS
 SQUARE FOOTAGE FROM 1800 SF TO 3000 SF

FIRE HYDRANT AND LATERAL ABANDONMENT

(Existing Lateral to be Abandoned)
 WHERE SHOWN ON THE DRAWING(S), THE CONTRACTOR SHALL ABANDON THE EXISTING FIRE HYDRANT(S) BY REMOVING BOTH THE UPPER AND LOWER BARRELS OF THE FIRE HYDRANT SO THAT NO PORTION OF THE REMAINING FIRE HYDRANT ASSEMBLY IS CLOSER THAN TWO (2) FEET TO THE EXISTING GRADE. THE EXISTING VALVE SHALL BE ABANDONED IN A CLOSED POSITION AND A MINIMUM OF THE TOP 12 INCHES OF THE VALVE BOX REMOVED. THE REMAINING PORTION OF THE VALVE BOX SHALL BE FILLED WITH CONCRETE HAVING A COMPRESSIVE STRENGTH OF AT LEAST 2,000 P.S.I. THE LATERAL SHALL BE CUT AND CAPPED WHERE INDICATED. WHERE A JOINT OR COUPLING IN THE EXISTING PIPE IS UNCOVERED AT THE CUT AND CAP LOCATION, THE INSTALLATION OF A PLUG MAY BE PERMITTED, WITH THE DISTRICT APPROVAL. A CONCRETE THRUST BLOCK SHALL BE INSTALLED AT ALL CUT AND CAP LOCATIONS IN ACCORDANCE WITH THE PROVISIONS OF UDACS PLATE NO. 5. THE EXISTING CONCRETE FIRE HYDRANT PAD SHALL BE REMOVED.

SERVICE LATERALS FOR LOTS: 228, 264, 285, 286
 WILL BE TAPPED ON EXISTING MAIN BY OWNER'S CONTRACTOR UNDER DIRECTION OF THE LVWD.

NOTE:
 FOR SANITARY SEWER MANHOLE TABLE, PLEASE REFER TO SHEET C1.

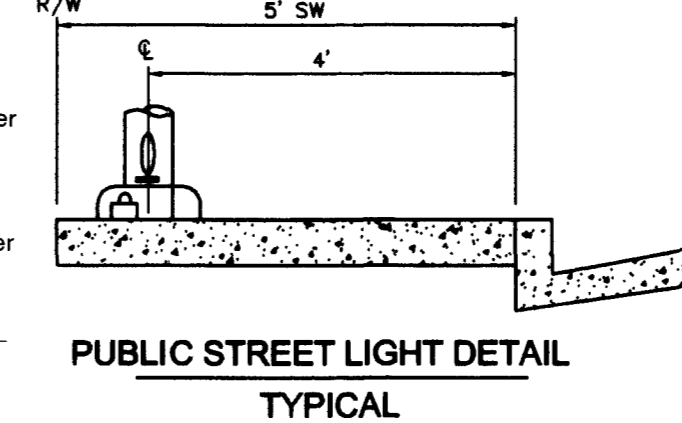
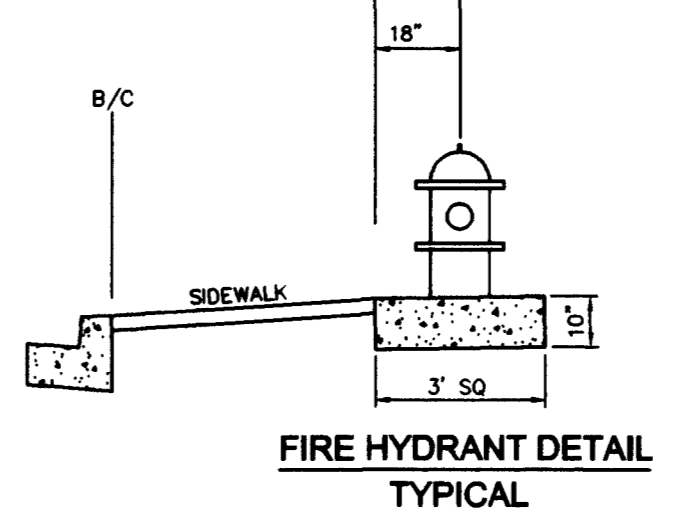

CONSTRUCTION NOTES

- 1 8" TEE - PUBLIC
- 2 8" GATE VALVE - PUBLIC
- 3 8" 90° ELBOW - PUBLIC
- 4 CAP AND 2" BLOW OFF VALVE (UDACS 4) - PUBLIC
- 5 FIRE HYDRANT ASSEMBLY INCLUDING 8" x 6" TEE AND 6" G.V. IN ACCORDANCE WITH (UDACS PLATE #7) - PUBLIC
- 6 5/8" METER (UDACS 1-B) - PUBLIC
- 7 4" PVC CONDUIT (RRRACG XINGS) - PRIVATE
- 8 1" METER WITH RPRA (UDACS 1-C OR 1-D) - PUBLIC
- 9 8" CROSS - PUBLIC
- 10 RELOCATE EXISTING FIRE HYDRANT ABANDON EXISTING F.H. LATERAL PER NOTE. INSTALL F.H. AT NEW LOCATION PER UDACS PLATE #7. INSTALL 8" x 6" TEE, 6" G.V. IN EXISTING 8" WATER LINE.
- 11 8" x 6" REDUCER
- 12 10" x 6" TEE - PUBLIC
- 13 FIRE HYDRANT ASSEMBLY INCLUDING 8" x 6" TEE, 6" G.V. IN ACCORDANCE WITH (UDACS PLATE #7) - PUBLIC

LEGEND

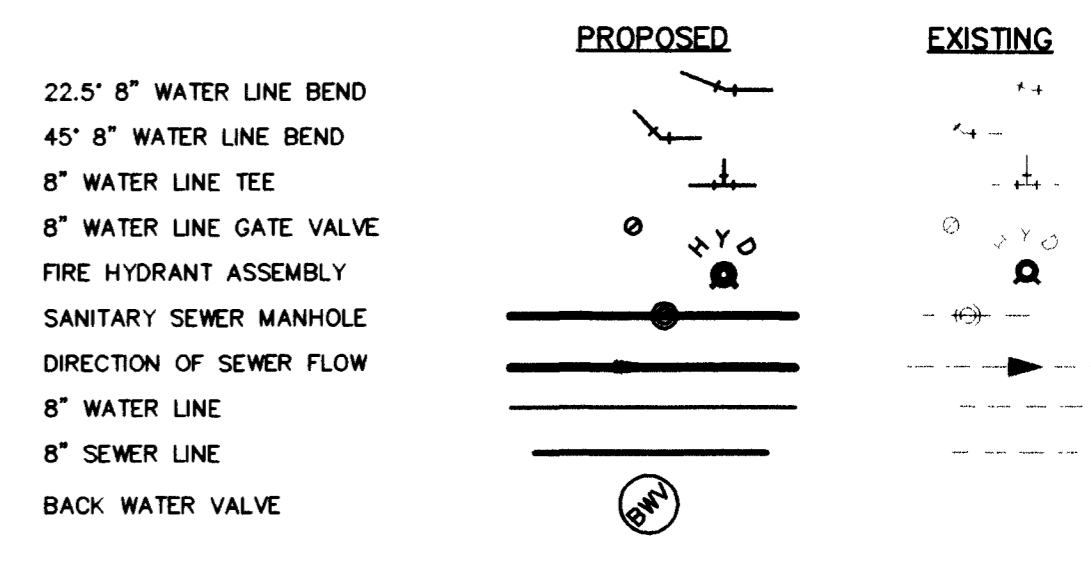

VICINITY MAP

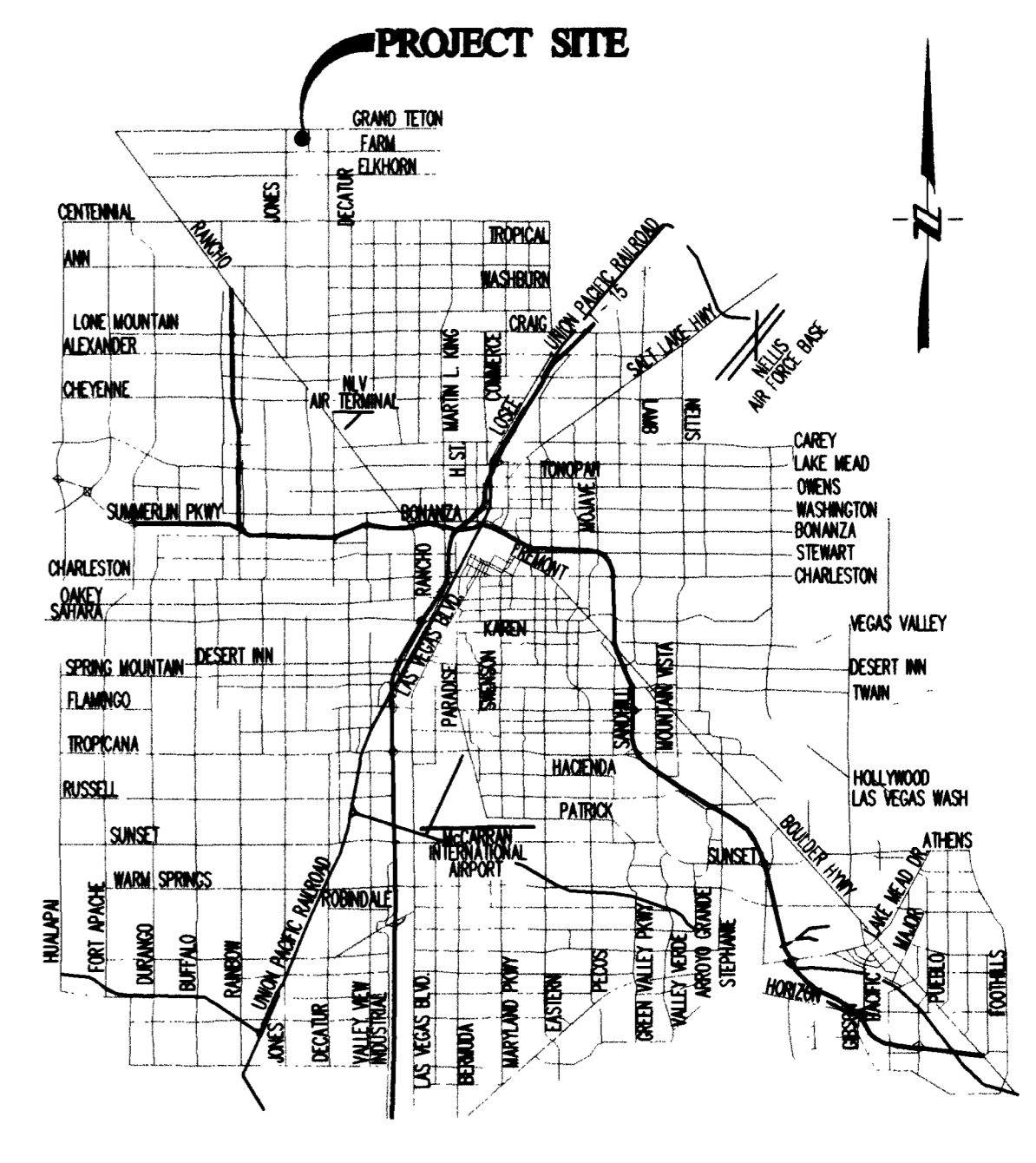

ABBREVIATIONS

AC	ASPHALTIC CONCRETE	RT	RIGHT-OF-WAY
BC	BACK OF CURB	R/W	RIGHT-OF-WAY
BVC	BACK OF CURB RADIUS BEGINNING OF VERTICAL CURVE	SW	SANITARY SEWER
BM	BENCH MARK	SD	STORM DRAIN
CA	CABLE TELEVISION	SDA	STORM DRAIN ALTERNATE
CL	CENTERLINE	STD	STANDARD
CCBL	CITY OF BOULDER CITY CLARK COUNTY	TC	TOP OF CURB
CCO	CLEAN OUT	TOB	TOP OF BERM
CCY	CUBIC YARD	TY	TYPICAL
DI	DROP INLET	VERT	VERTICAL
DG	DESIGN GRADE	VFC	VERTICAL CURVE
ED	EDGE OF PAVEMENT	VG	VALLEY GUTTER
EC	END OF CURVE	VCP	VERTIFIED CLAY PIPE
EVC	END OF VERTICAL CURVE	W	WATER
EX	EXISTING	WM	WATER METER
FC	FINISH GRADE		
FE	FINISH FLOOR ELEVATION		
FI	FIRE HYDRANT		
FL	FLOW LINE		
GB	GRADE BREAK		
HP	HIGH POINT		
INV	INVERT		
LFF	LOWER FINISH FLOOR ELEVATION		
LF	LINEAR FEET		
LVVWD	LAS VEGAS VALLEY WATER DISTRICT		
MH	MANHOLE		
MAX	MAXIMUM		
MIN	MINIMUM		
NTS	NOT TO SCALE		
OC	ON CENTER		
PI	POINT OF INTERSECTION		
PRC	POINT OF REVERSE CURVE		
PC	POINT OF CURVE		
PT	POINT OF TANGENCY		
PTC	PROP TOP OF CURB (BY OTHERS)		
PTG	PROP FINISH GRADE (BY OTHERS)		
PL	PROPERTY LINE		
PB	PULL BOX		
R	RADIUS		
RCB	REINFORCED CONCRETE BOX		
RCP	REINFORCED CONCRETE PIPE		

SCALE

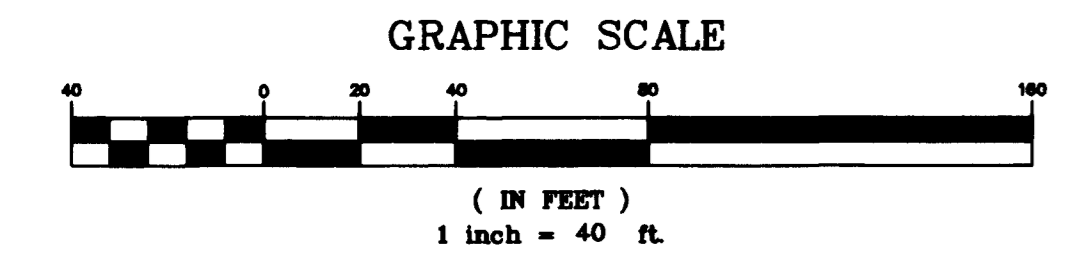

BENCHMARK

CITY OF LAS VEGAS BENCH MARK - 8LV90-16C4
 RIVET AND PLATE IN TOP OF CURB AT SW CORNER OF FARM AND CIMARRON
 NAVD88 ELEVATION = 754.2098 METERS (2474.44 FT)

KEY MAP

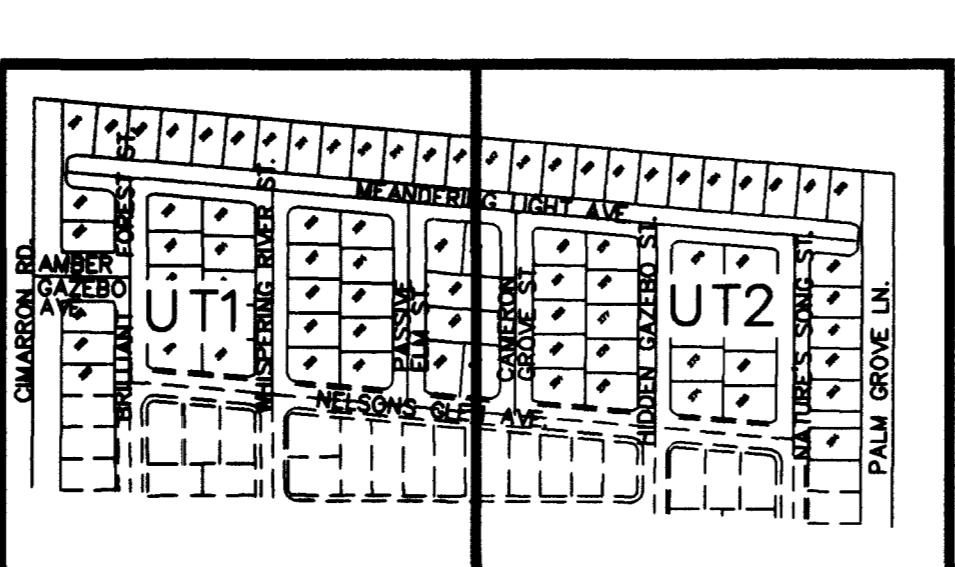

AVERAGE DAILY SEWER FLOW = 9250 G.P.D.
 PEAK SEWER FLOW = 32,375 G.P.D.

Call Two Working Days Before You Dig!

Dig Safely. Dig Safely
 1-800-227-2600

PROJECT NAME: Lamplight Village Unit 5
 This project water plan complies with the Las Vegas Valley Water District's technical requirements. However, this water plan is NOT APPROVED FOR CONSTRUCTION at this time and this signature does not provide or imply a water commitment.

LVVWD #52
 DATE: 8/30/02
 DATE: 8/30/02

APPROVAL

Las Vegas Valley Water District
 DATE: 10/30/02

NO.	REVISIONS	DATE	APPR.

CARINA CORPORATION
 2881 BUSINESS COURT, SUITE 210
 LAS VEGAS, NEVADA 89128
 (702) 228-6376 FAX: (702) 228-6002

TANEY ENGINEERING
 4446 S. JONES BLVD., SUITE #1
 LAS VEGAS, NEVADA 89121
 (702) 362-8844 FAX: (702) 362-5233

LAMPLIGHT VILLAGE UNIT FIVE
 AT CENTENNIAL SPRINGS

UTILITY PLAN
 WEST

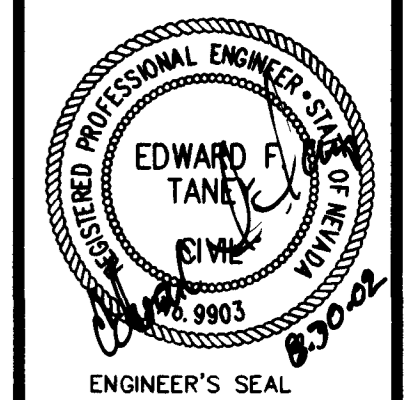

ENGINEER'S SEAL
 DATE: 12-01
 SCALE: 1" = 40'
 JOB NO: CRN-00-001
 DESIGNED BY: EFT
 DRAWN BY: EFT/OGS
 SHEET NAME: UTI
 SHEET: 3017.4612-5
 6 OF 18

FILE NAME: CRN00001IMP

75153 46269