

FILE NAME:
S21102IMP.dwg
VIEW NAME:
4PB

33577

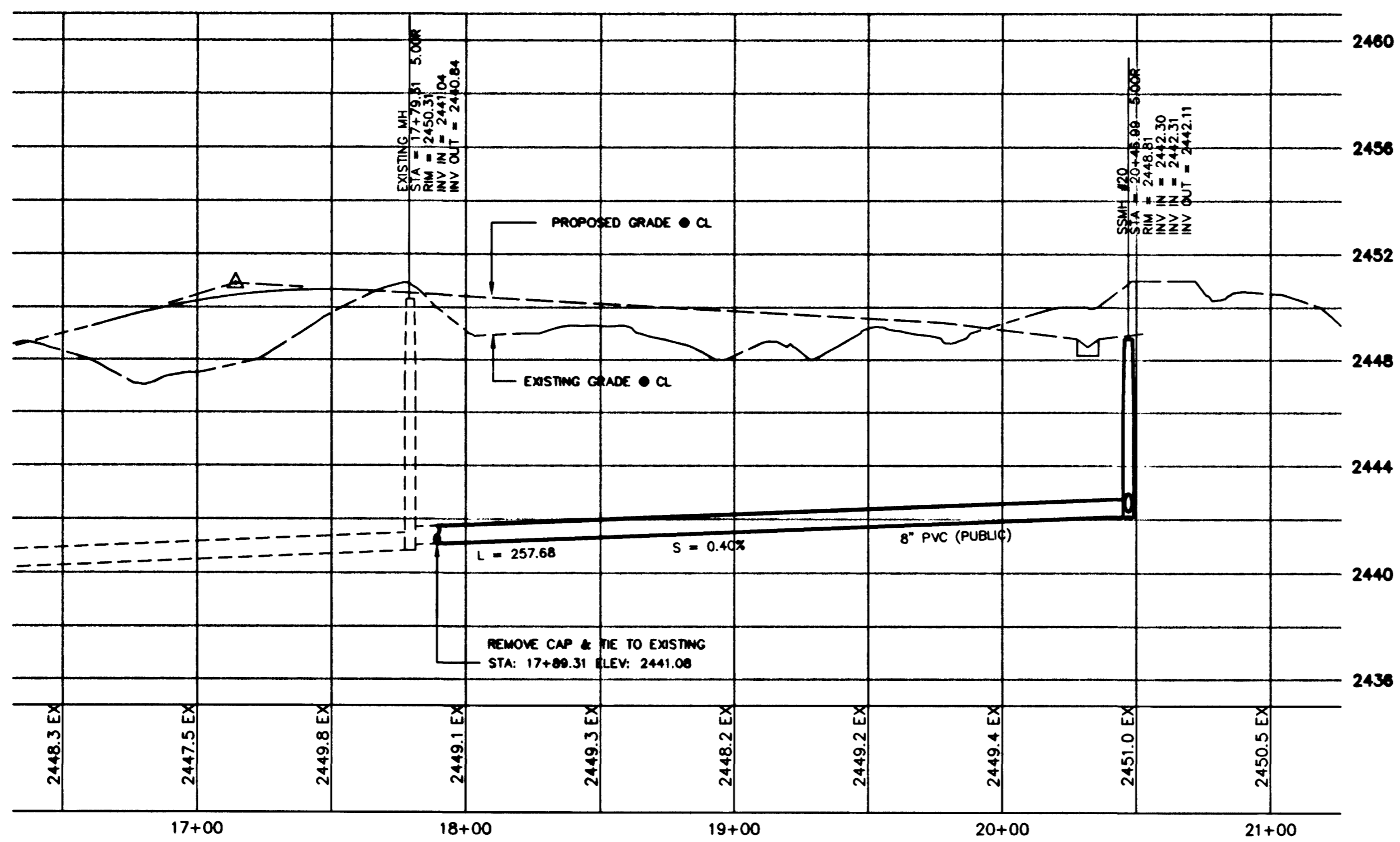

NATURES SONG STREET (SEWER EXTENSION) - PROFILE VIEW

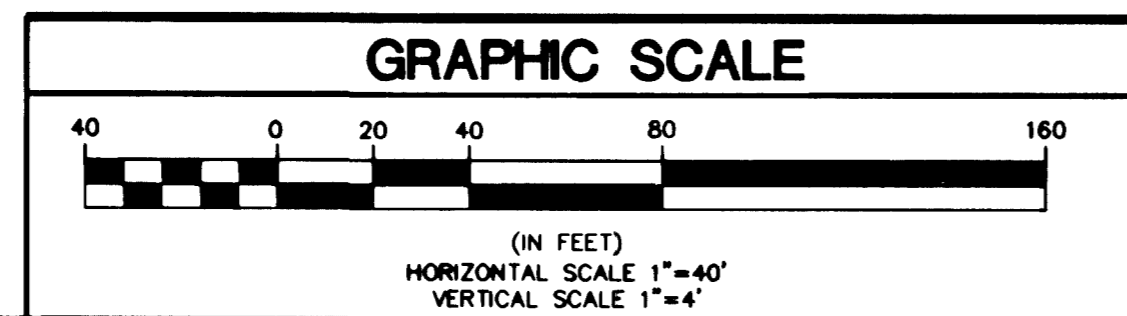

BASIS OF BEARINGS

THE BASIS OF BEARINGS FOR THIS SURVEY IS THE EAST LINE OF THE NORTHEAST ONE-QUARTER OF SECTION 16, TOWNSHIP 19 SOUTH, RANGE 80 EAST, M.D.M. WHICH BEARS NORTH 00°19'37" EAST AS SHOWN IN THE OFFICE OF THE CLARK COUNTY, NEVADA RECORDER IN BOOK 79 OF PLATS ON PAGE 50.

BENCHMARK

CITY OF LAS VEGAS BENCHMARK No. 5 STATION 1LV90-18NW6 USC AND GS BM # U109 764.7181 METERS (NAVD 88) 764.7181 x (3937/1200) = 2508.913 FEET (NAVD 88)

NATURES SONG STREET (SEWER EXTENSION) - PLAN VIEW
PUBLIC UTILITY EASEMENT, CLV PUBLIC SEWER EASEMENT AND PUBLIC DRAINAGE EASEMENT TO BE PRIVATELY MAINTAINED

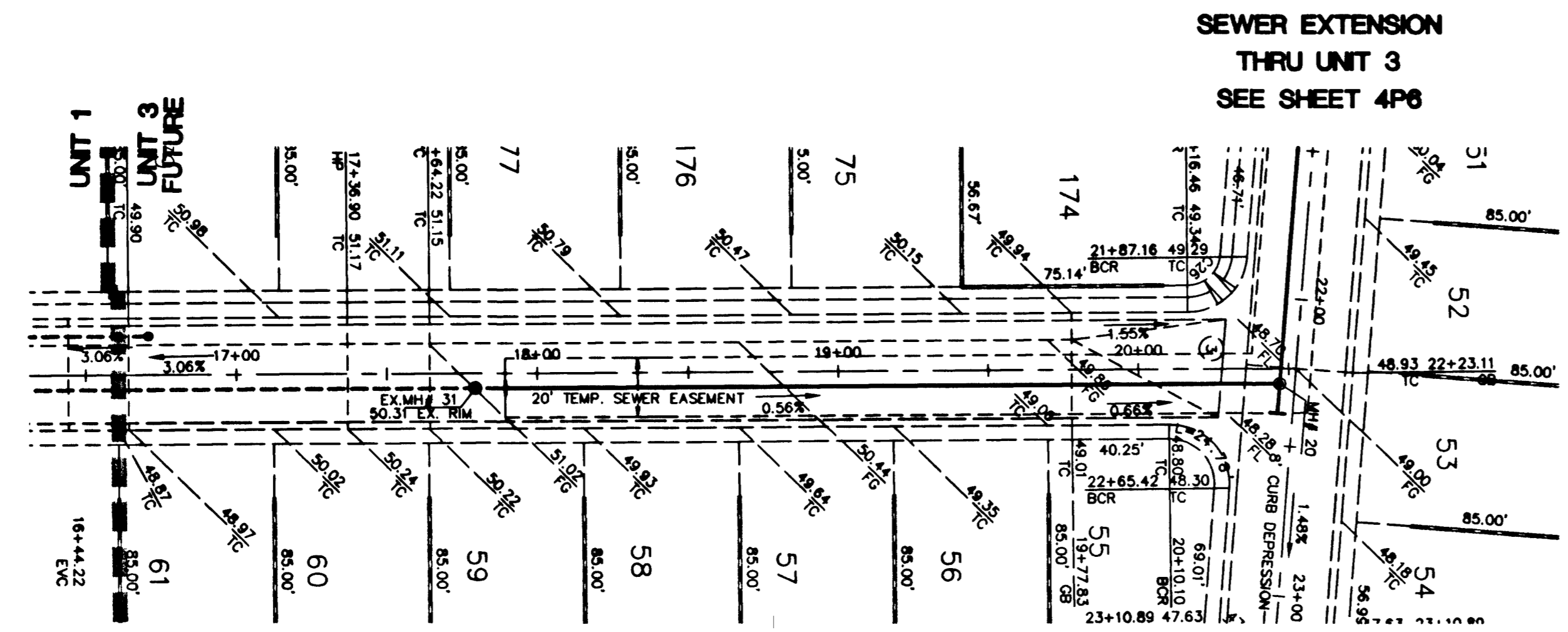

FUTURE UNIT THREE

CURVE DATA				
Curve Table				
No.	Radius	Delta	Length	Tangent
C1	15.00	90°00'00"	23.56	15.00
C2	19.00	08°27'44"	3.12	2.37
C3	31.00	05°27'44"	5.12	3.82
C4	19.00	27°15'31"	9.04	4.61
C5	31.00	14°05'10"	7.59	3.82
C6	19.00	14°05'10"	4.65	2.37
C7	11.00	84°15'30"	16.18	9.95
C8	11.00	95°44'30"	18.38	12.16
C9	15.00	89°03'09"	23.31	14.79
C10	15.00	90°56'51"	23.81	15.25
C11	15.00	48°06'51"	12.60	6.70
C12	11.00	89°03'09"	17.10	10.82
C13	15.00	46°13'09"	12.10	6.40
C14	11.00	90°56'51"	17.46	11.18
C15	15.00	41°25'29"	10.84	5.67
C16	25.00	35°50'19"	16.09	8.33
C17	15.00	84°23'50"	22.10	13.60
C18	11.00	95°36'10"	18.35	12.13
C19	11.00	84°23'50"	16.20	9.37
C20	15.00	52°46'10"	13.81	7.44
C21	11.00	94°47'39"	18.20	11.96
C22	15.00	4°17'03"	12.35	6.55
C23	11.00	90°00'00"	17.28	11.00
C24	15.00	42°22'20"	11.09	5.81
C25	15.00	85°12'21"	22.31	13.79
C26	11.00	85°20'41"	16.39	10.14
C27	15.00	51°49'19"	13.57	7.29
C28	14.00	25°22'25"	6.20	3.15

LINE DATA		
Bearing Table		
No.	Bearing	Distance
L1	N 04°56'00" E	9.00
L2	N 84°55'39" W	10.03
L3	S 85°04'00" E	11.60
L4	S 85°16'23" E	16.35
L5	S 85°04'00" E	11.00
L6	N 84°55'39" W	10.04
L7	S 85°04'00" E	6.58

- CONSTRUCTION NOTES
- ① "L" TYPE CURB (UDS#216)
 - ② "A" TYPE ISLAND CURB (UDS#219)
 - ③ VALLEY GUTTER (UDS#228)
 - ④ SIDEWALK UNDERDRAIN (UDS#236)
 - ⑤ SIDEWALK RAMP (UDS#235)

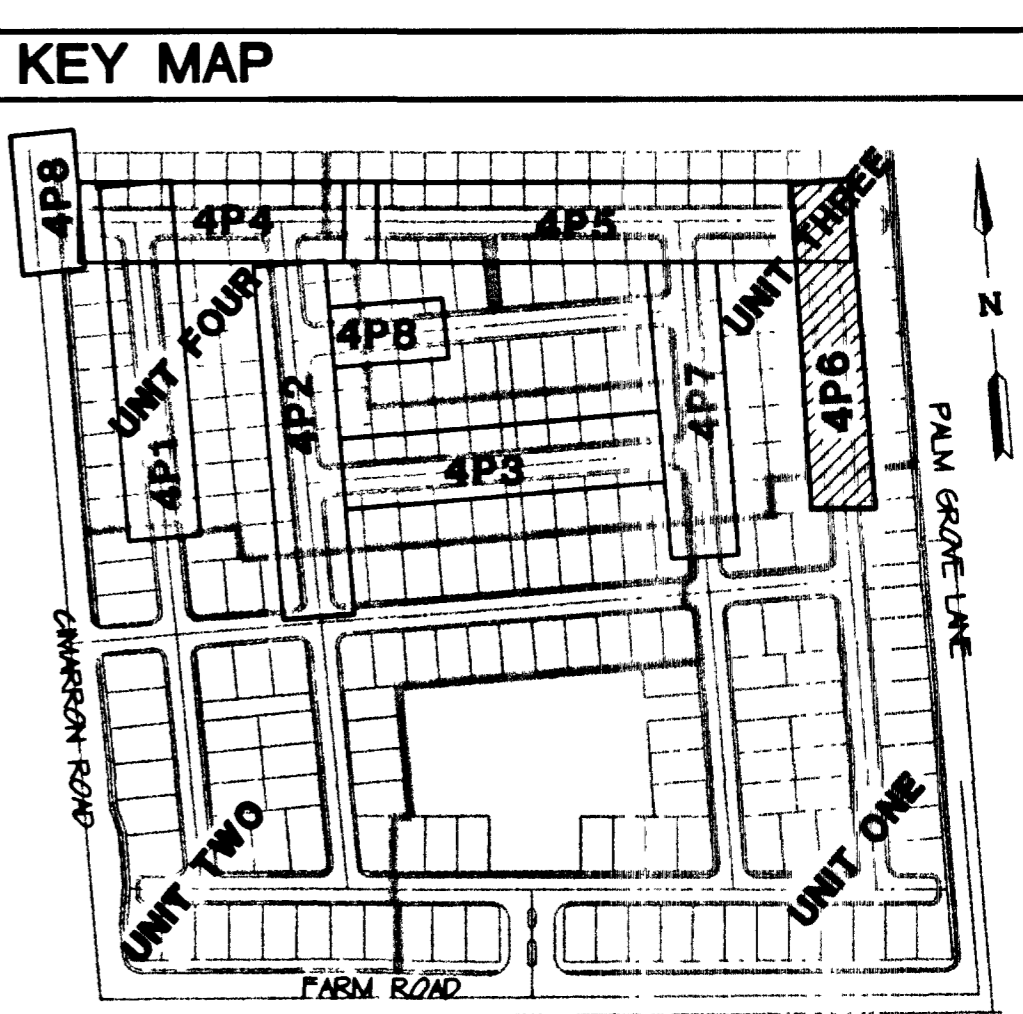
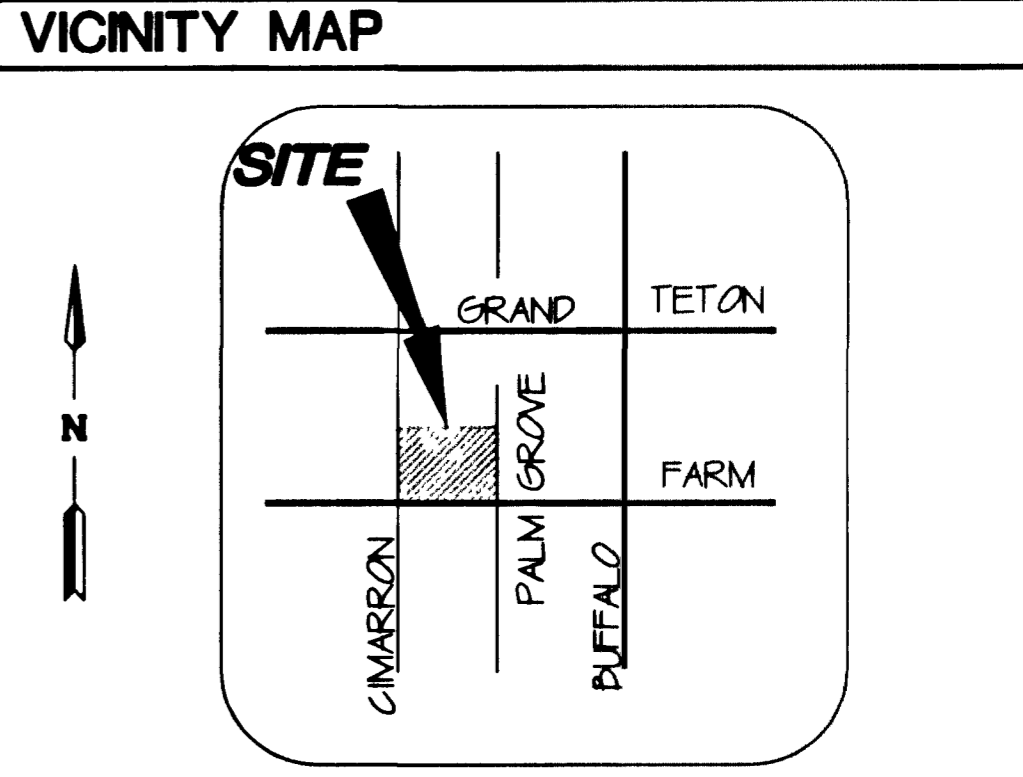

NOTICE!

EXISTING UTILITIES ARE SHOWN ON PLANS FOR THE CONVIENIENCE OF THE CONTRACTOR ONLY. THE CONTRACTOR IS RESPONSIBLE FOR THE PROTECTION OF ALL UTILITIES. THE ENGINEER BEARS NO RESPONSIBILITY FOR UTILITIES NOT SHOWN OR SHOWN INCORRECTLY.

AVOID CUTTING UNDERGROUND UTILITIES. IT'S COSTLY!

Call Djs BEFORE YOU

1-800-227-2600
UNDERGROUND SERVICE (USA)

SHEET 07.05.01 OF 17 SHEETS
DRAWN BY: RDF
DESIGNED BY: RDF
CHECKED BY: SEC
PROJECT NO: 9211-02
SCALE: 1"=40'

TITLE
PLAN & PROFILE NATURES SONG STREET SEWER EXTENSION THRU UNIT 3 AT CENTENNIAL SPRINGS UNIT 4

CARINA CORPORATION
2880 BUSINESS PARK COURT, SUITE 210
LAS VEGAS, NEVADA 89128
(702) 158-6376

ENGINEERING COMPANY
50 So. Jones #202, Las Vegas, NV, 89107
Telephone: (702) 877-1300

ALPHA & ENGINEERING

REVISION

PROFESSIONAL ENGINEER
STATE OF NEVADA
No. 15689
07-10-11

SHEET 4P6
DRAWING NO. 3074-4642-4