

EXISTING PARADISE MEADOWS  
125-24-501-001  
(BY SOUTHWEST ENGINEERING)  
CLV # 107Y-4651-1

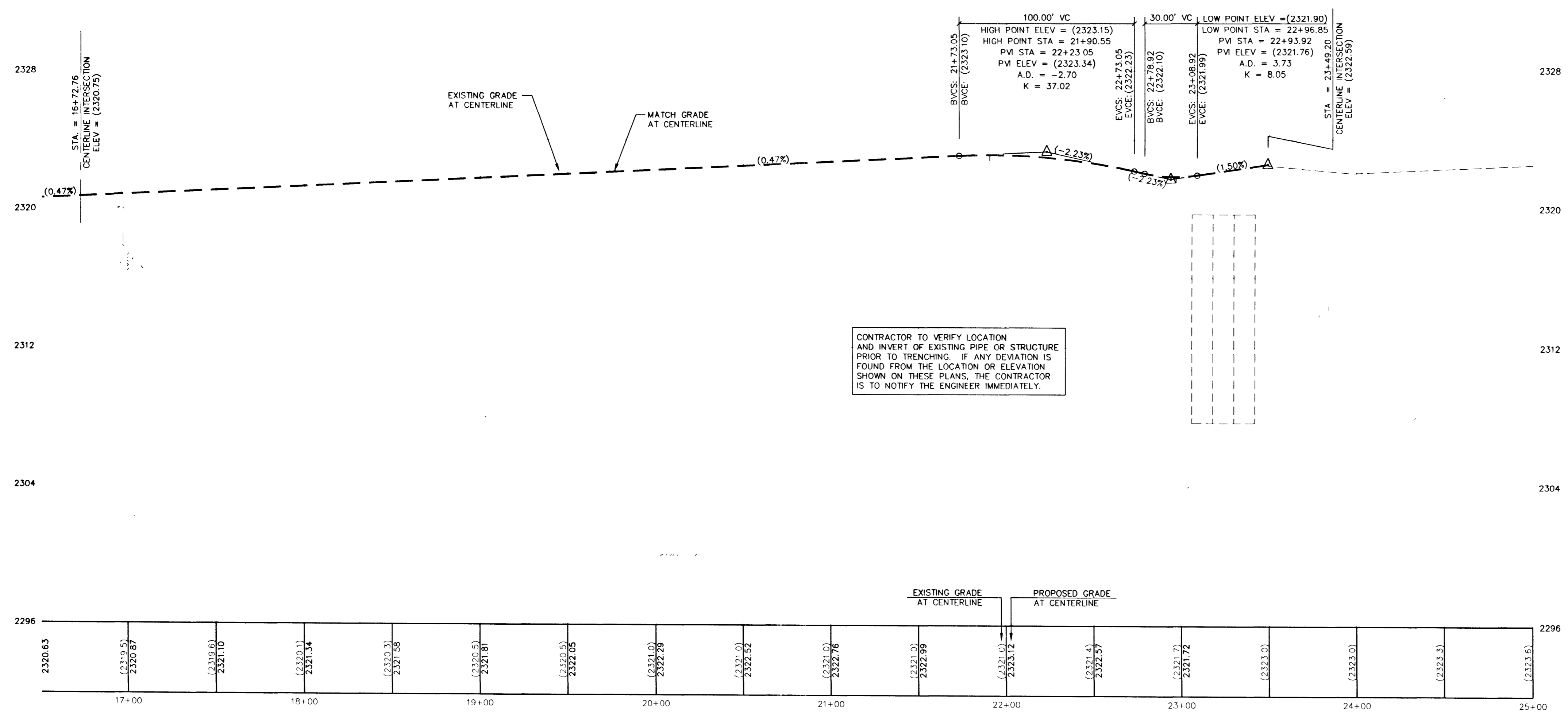

CONTRACTOR TO VERIFY LOCATION AND INVERT OF EXISTING PIPE OR STRUCTURE PRIOR TO TRENCHING. IF ANY DEVIATION IS FOUND FROM THE LOCATION OR ELEVATION SHOWN ON THESE PLANS, THE CONTRACTOR IS TO NOTIFY THE ENGINEER IMMEDIATELY.

**WATER CONSTRUCTION NOTES**

- 1 STD FIRE HYD W/ASSY PER UDACS PLATE 7
- 2 8"x8"x8" TEE PER UDACS PLATE 5
- 3 6" GATE VALVE PER UDACS PLATE 8
- 4 8" GATE VALVE PER UDACS PLATE 8
- 5 8"x6" REDUCER
- 6 8" 90° BEND PER UDACS PLATE 5
- 7 8" 45° BEND PER UDACS PLATE 5
- 8 2" BLOW OFF ASSEMBLY PER UDACS PLATE 4
- 9 12"x8" TAPPING SLEEVE AND VALVE PER UDACS PLATE 22
- 10 1" TYPE 'K' COPPER SERVICE PER UDACS PLATE 1B WITH 3/4" METER
- 11 1" TYPE 'K' COPPER SERVICE PER UDACS PLATE 1D WITH 3/4" METER
- 12 1" RPPA PER UDACS PLATE 11A

**BRADLEY ROAD**  
PUBLIC STREET

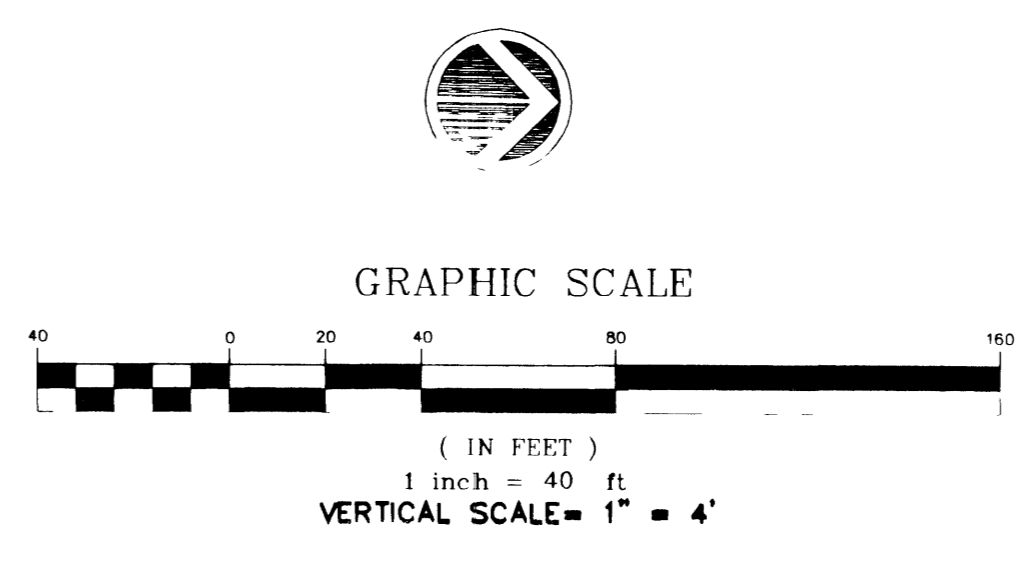

**NOTE**  
ALL PRIVATE STREETS ARE CLV SEWER & PUBLIC DRAINAGE EASEMENTS TO BE PRIVATELY MAINTAINED

**BENCHMARK**  
CITY OF LAS VEGAS VERTICAL CONTROL  
ONLY BM #519118, SW COR OF WATER DISTRICT FENCE, DECATUR BLVD & DEER SPRINGS WAY  
STATION 1LV90  
24E4  
ELEVATION= 701.4396 METERS (NAVD88)  
2301.306 FEET

**NOTICE TO CONTRACTOR !**  
EXISTING UTILITY LOCATIONS SHOWN HEREON ARE APPROXIMATE ONLY. IT SHALL BE THE CONTRACTOR'S RESPONSIBILITY TO DETERMINE THE EXACT VERTICAL AND HORIZONTAL LOCATION OF ALL EXISTING UNDERGROUND UTILITIES PRIOR TO COMMENCING CONSTRUCTION. NO REPRESENTATION IS MADE THAT ALL EXISTING UTILITIES ARE SHOWN HEREON. THE ENGINEER ASSUMES NO RESPONSIBILITY FOR UTILITIES NOT SHOWN OR UTILITIES NOT SHOWN IN THEIR PROPER LOCATION.

AVOID CUTTING UNDERGROUND UTILITIES. IT'S COSTLY.

**CALL before you Dig**  
1-800-227-2600  
UNDERGROUND SERVICE (USA)

AVOID HITTING OVERHEAD POWER LINES. IT'S DANGEROUS.

**CALL BEFORE YOU DIG OVERHEAD**  
CALL 1-702-593-6111

NO.	DATE	BY	APP'D	REVISION DESCRIPTION

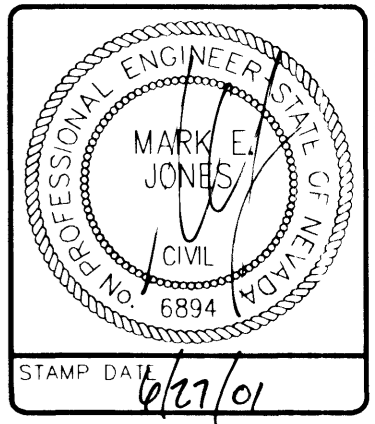

3610 North Rancho Drive  
Las Vegas, Nevada 89130  
Telephone: (702) 646-9700  
Fax: (702) 646-1143

**SOUTHWEST ENGINEERING**  
LAND PLANNING • SURVEYING • DEVELOPMENT

**UTILITY PLAN & PROFILE**  
BRADLEY ROAD

**PARADISE MEADOWS - WEST**  
D. R. HORTON

CITY OF LAS VEGAS

TITLE: PROJECT: CITY OF LAS VEGAS

WORK ORDER NO: 000612

DESIGN BY: SJW

DATE: 10/10/00

SCALE: 1"=40'

CADFILE: pmwpp2

SHEET 25 OF 32 SHEETS

DWG NO: 107Y-4651-W