

Revisions	Date

Scale 1" = 20'
 Date 8/21/81
 W.U. no. 7018
 Design by [Signature]
 Approved by Supervisor of Traffic [Signature]
 Approved by the City Engineer [Signature]

Department of Public Services • Traffic Engineering Division
 LAS VEGAS BLVD.
 AT CASHMAN FIELD

TRAFFIC SIGNAL
 & DELINEATION

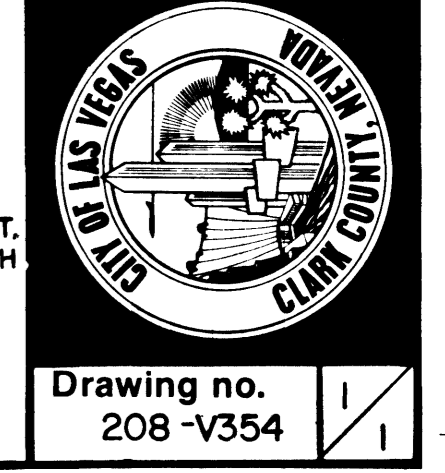

Drawing no. 208-V354

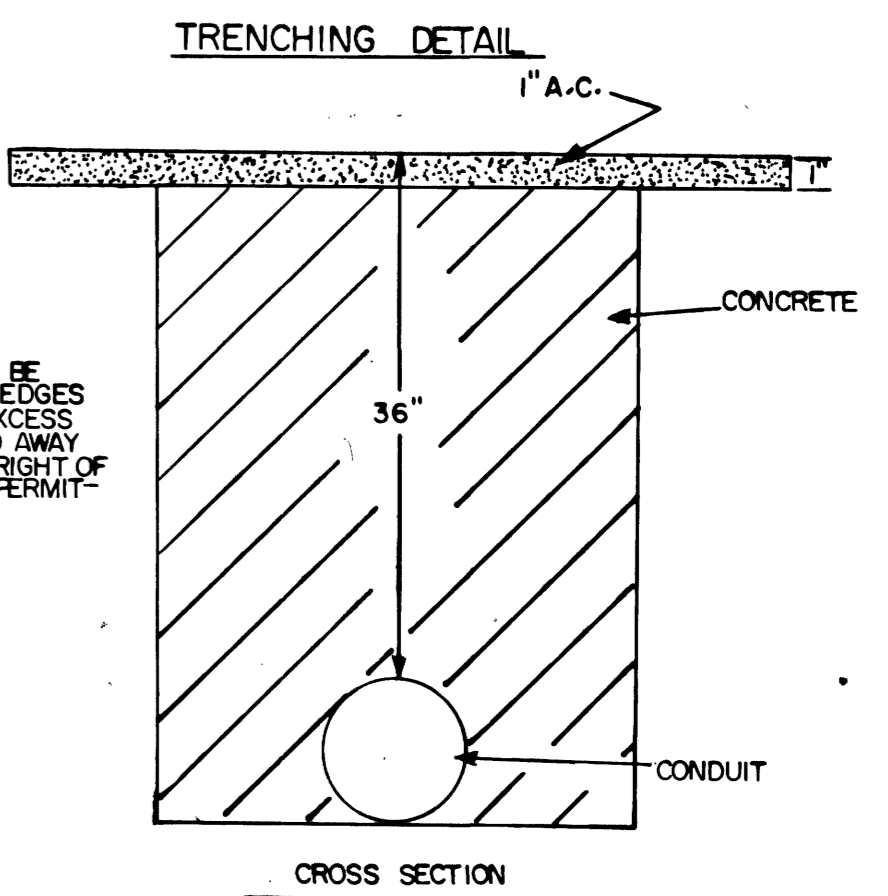
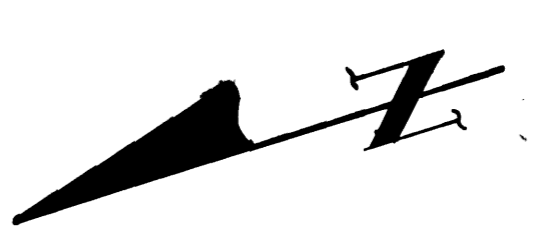
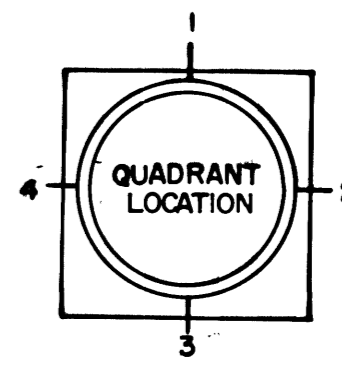

NOTE:
 EDGES OF PATCH TO BE STRAIGHT AND UNIFORM (EDGES TO BE SAW CUT). ALL EXCESS MATERIAL TO BE HAULED AWAY AND DISPOSED OFF THE RIGHT OF WAY UNLESS OTHERWISE PERMITTED BY THE ENGINEER.

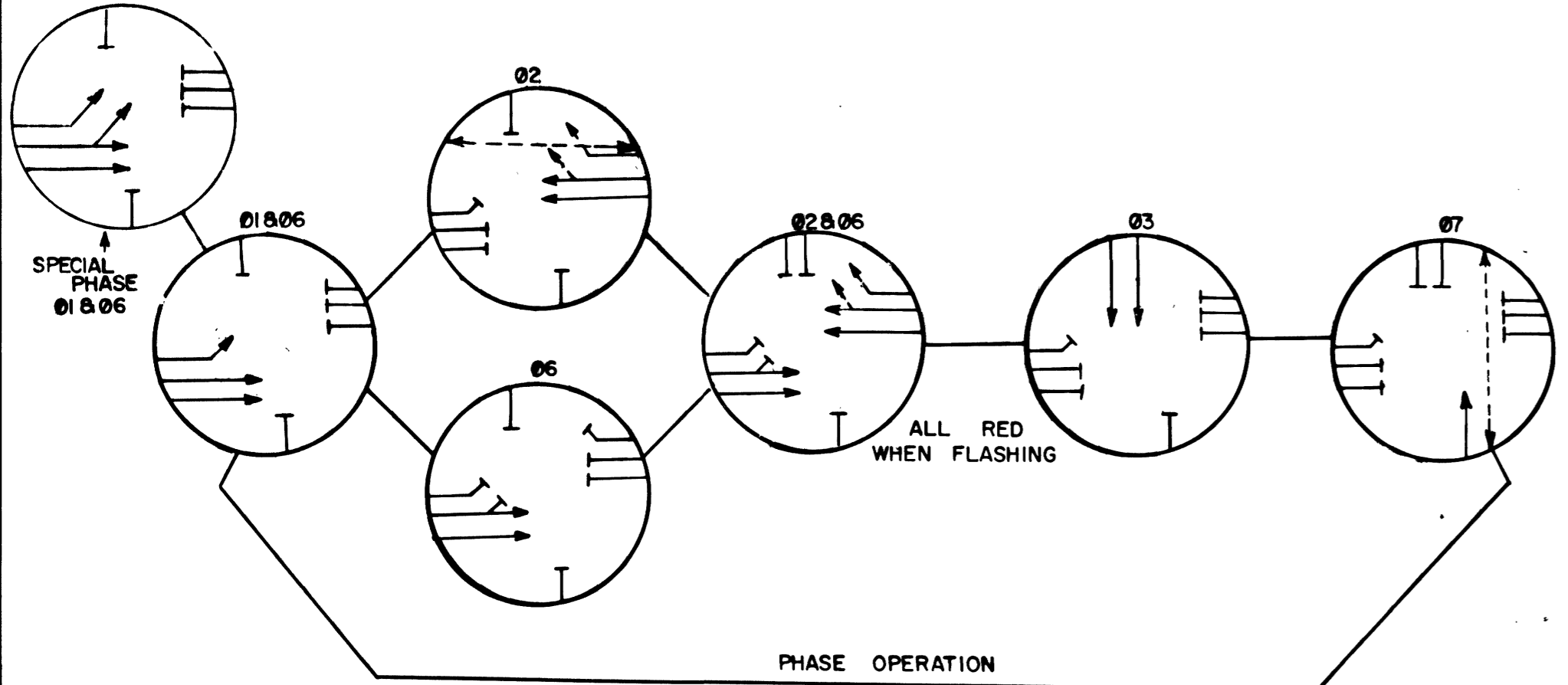
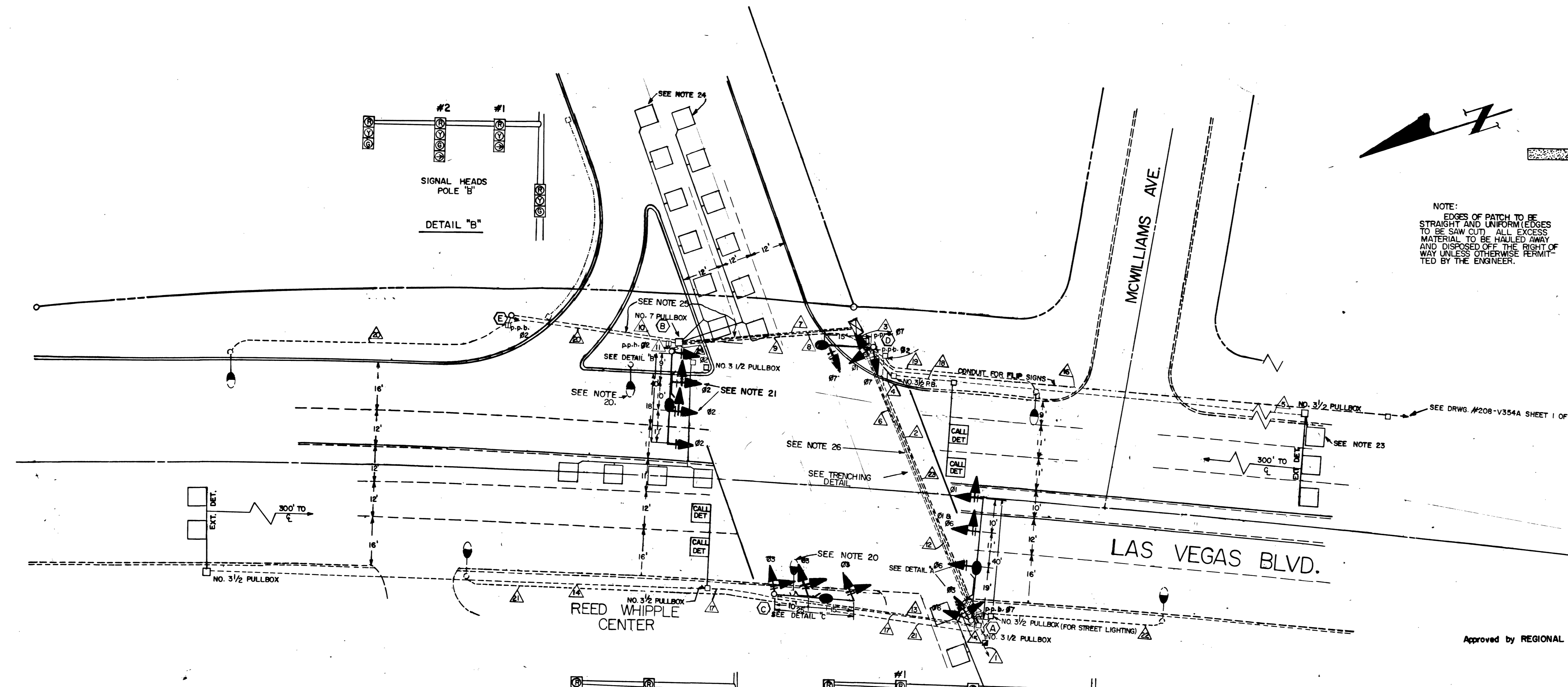

POLE SCHEDULE													
NO.	STATION	GA.	TYPE	SIGNAL ARM QUAD.		LUM. ARM QUAD.		SIGNALS (VEH)		SIGNAL (PED)		PED. PUSH BUTTON	
				LENGTH	QUAD.	LENGTH	QUAD.	QUADRANT	TYPE	QUADRANT	MOUNTING	QUADRANT	ARROW
A			XX	1	4d	1	15'	MA	M-3A, M-2	3	W-OT	2	RT
B			XX	3	3d	3	15'	MA	M-3A, M-2	1	W-3T	1	LT & RT
C			XX	2	2s	2	15'	MA	M-2(2)	2	W-3T	4	LT
D			XX	4	1s	4	15'	MA	M-2	2	W-3T	2	LT
E			IA					Z	B-3T		W-IT	3	RT

- NOTES:
- CHECK CONDUIT & CABLE SCHEDULE FOR CONDUIT, CABLE, & WIRE SIZE.
 - LINE SIDE OF METER TO BE WIRED WITH THREE #2. LOAD SIDE SHALL BE WIRED WITH FOUR #4 A.W.G. (THREE BLACK & ONE WHITE).
 - THE ROUTING AND TERMINATION OF CONDUITS AND THE PLACING OF POLES AND CABINETS SHALL BE AS INDICATED ON PLANS. ALL CHANGES SHALL BE APPROVED BY THE TRAFFIC ENGINEER.
 - SIGNAL SHALL BE A 10 B 20 CONDUCTOR #14 A.W.G. CABLE I.M.S.A. SPEC 20-1.
 - LOOP CABLE SHALL BE ONE TWISTED PAIR OF #12 A.W.G. CABLE I.M.S.A. SPEC. 19-2.
 - ALL SIGNAL LENSE SHALL BE 12".
 - CALL DETECTORS TO BE CONNECTED DURING PHASE RED FOR ONE DETECTION AND THEN DISCONNECTED.
 - CONTROLLER SHALL BE HOUSED IN A TYPE "R" CABINET WITH EXHAUST FAN AND THERMOSTAT CONTROL.
 - ALL CABLE AND WIRING SHALL BE INSTALLED TERMINAL TO TERMINAL, NO SPLICES ALLOWED.
 - CABINET SHALL BE PAINTED WHITE INSIDE AND OUT.
 - EACH LOOP DETECTOR LEAD-IN REPRESENTS A SEPARATE AMPLIFIER UNIT REQUIRED. (8 REQUIRED)
 - ALL NECESSARY AMPLIFIER UNITS, MODULES, LIGHT CONTROL UNITS, SWITCHES, FLASHERS, ETC. SHALL BE WIRED IN CABINET TO ACTIVATE FIVE PHASE OPERATION AS SHOWN IN DIAGRAM.
 - SERVICE SHALL HAVE 1-60 AMP SINGLE POLE BREAKER FOR SIGNAL AND 2-40 AMP SINGLE POLE BREAKERS FOR STREET LIGHTS. SERVICE SHALL BE A 100 AMP PADMOUNT.
 - EACH STREETLIGHT LUMINAIRE SHALL BE FUSED IN CABINET USING IN-LINE FUSEHOLDERS.
 - ALL PEDESTRIAN PUSH BUTTON SIGNS SHALL BE 9"X12" WITH FULL MOUNTING BRACKET.
 - ALL CABLE AND WIRING SHALL BE INSTALLED TERMINAL TO TERMINAL, NO SPLICES ALLOWED.
 - POLES "A", "B", & "C" SHALL HAVE INTERNALLY ILLUMINATED STREET NAME SIGNS INSTALLED. THE SIGNS SHALL BE WIRED TO THE LUMINAIRE PHOTO CELL FOR CONTROL.
 - STREET NAME SIGNS ON POLES "A" & "B" SHALL READ "CASHMAN FIELD", ON POLE "C" NAME SIGNS SHALL READ "LAS VEGAS BLVD."
 - ALL SIGNAL POLES SHALL CONFORM TO C.L.V. STANDARD SPEC. 404.402 & 404.406.
 - LOOP DETECTORS TO BE LOCATED BY C.L.V. IN THE FIELD.
 - REMOVE EXISTING POLE AND LUMINAIRE, RETURN TO CHIEF OF ELECTRICAL SERVICES (GEORGE FERRIS) 300 EAST BONANZA.
 - DEAD END THIS CONDUIT RUN IN PULLBOX.

RUN NO.	FROM	TO	CONDUIT SIZE	SIGNAL CABLE					INTERCONNECT	SERVICE
				14 AWG	14 AWG	300Ω	2 CON	10 AWG		
1	SERVICE	PADMOUNT	2"							X
2	PADMOUNT	CONTROLLER	2"							X
3	CONTROLLER	POLE "D"	2"	X				X		
4	CONTROLLER	PULLBOX	2"					XXX		
5	PULLBOX	PULLBOX	1"					XX		
6	PULLBOX	PULLBOX	2"					X	X	
7	CONTROLLER	PULLBOX (EXISTING)	2"	X				XX		
8	CONTROLLER	PULLBOX (EXISTING)	2"					X	X	
9	PULLBOX	PULLBOX	2"					2 #4, 1 # 8 (GREEN)		STREETLIGHT
10	PULLBOX	POLE "E" (EXISTING)	2"	X						
11	PULLBOX	POLE "B"	2"					X		
12	CONTROLLER	PULLBOX	2"	X				XX	X	
13	PULLBOX	POLE "C"	2"					X		
14	PULLBOX	PULLBOX	1"					X		
15	PULLBOX	POLE "A"	2"					X		
16	PULLBOX	PULLBOX	2"					X		
17	PULLBOX	PULLBOX	2"						XX	
18	PULLBOX	PULLBOX	2"						XXX	
19	POLE	PULLBOX	1 1/4"							
20	PULLBOX	POLE	1 1/4"							
21	POLE	PULLBOX	1 1/4"							
22	PULLBOX	POLE	1 1/4"							
23	PULLBOX	PULLBOX	2"							STREETLIGHT
24	PULLBOX	PULLBOX	1"					X		

- NOTES: (CONTINUED)
- SIGNAL HEAD #1 ON POLE "B" AND THE RIGHT TURN ARROW ON SIGNAL HEAD #2 ON POLE "B" SHALL BE ILLUMINATED BY COMPUTER COMMAND DURING INBOUND TRAFFIC, OR BY A SWITCH LOCATED IN THE CONTROLLER CABINET.
 - SIGNAL HEAD #1 ON POLE "A" SHALL HAVE THE LEFT TURN ARROW ILLUMINATED BY COMPUTER COMMAND DURING INBOUND TRAFFIC, OR BY A SWITCH LOCATED IN THE CONTROLLER CABINET.
 - LOOP DETECTORS IN THIS LANE WILL BE ACTIVATED FOR INBOUND TRAFFIC ONLY, BY COMPUTER COMMAND, OR BY SWITCH IN CABINET.
 - LOOP DETECTORS IN THIS LANE SHALL BE DISCONNECTED DURING INBOUND TRAFFIC BY COMPUTER COMMAND, OR BY A SWITCH LOCATED IN THE CONTROLLER CABINET.
 - CONDUIT RUNS 1, 2, 3, 4, 5, 6, 7, 8, 9, 10, 11, 12, 13, 14, 15, 16, 17, 18, 19, 20, 21, 22, 23, 24, 25, 26 ARE EXISTING.
 - CONDUIT RUNS 27, 28, 29, 30 ARE STUBBED OUT.

46031