

BENCHMARK
CITY OF LAS VEGAS VERTICAL CONTROL
CITY OF LAS VEGAS SM #18V0044
1/4 CORNER, ELM 1990 D MOCCASIN
AND CIMMARON
ELEVATION: 758.870 METERS (MAY08)
2483.01 FEET

BASIS OF BEARINGS
NORTH 00°28'28" WEST BEING THE BEARING
OF THE WEST LINE OF THE NORTHWEST
QUARTER (NW1/4) OF SECTION 4, TOWNSHIP
19 SOUTH, RANGE 80 EAST, M.D.M. CITY OF
LAS VEGAS, CLARK COUNTY, NEVADA, AS
SHOWN BY MAP THEREOF ON FILE IN FILE
105, PAGE 09 OF PARCEL MAPS IN THE
CLARK COUNTY RECORDER'S OFFICE, CLARK
COUNTY, NEVADA.

FIRE FLOW CALCULATIONS

FIRE FLOW REQUIREMENT IS: 1500 GPM
AT 20 PSI RESIDUAL PRESSURE

BASED ON:
SQUARE FOOTAGE: 2,350 SF
LARGEST AREA BETWEEN
4-HOUR AREA SEPARATION
WALLS: 2,350 SF

BUILDING HEIGHT: 24'-4" FEET
NUMBER OF STORIES: 2 FLOOR
TYPE OF CONSTRUCTION: V-N
OCCUPANCY: R-3
FULL AUTOMATIC FIRE
SPRINKLER SYSTEM: NO

Reviewed By: _____
Date: _____

*NOTE: ON-SITE SUBMITTAL REQUIRED WITH BUILDING DETAIL APPROVAL IS FOR
ON-SITE CONSTRUCTION FIRE PROTECTION OF 1500 GPM ON-SITE 1500 GPM OFF-SITE.

- WATER UTILITY NOTES**
- REMOVE CAP AND BLOW OFF PER UDACS PLATE No. 4A, Note No. 1, AND
CONNECT TO EXISTING MAIN.
 - INSTALL CAP & 2" BLOW-OFF ASSEMBLY PER UDACS PLATE 4A.
 - INSTALL 8" GATE VALVE.
 - INSTALL 8" TEE.
 - INSTALL 8"x6" TEE.
 - INSTALL 8"-9" BEND, SPECIFIED FITTING - RESTRAINED ON EACH END.
 - INSTALL 8"-11.25' BEND.
 - INSTALL 8"-22.50' BEND.
 - INSTALL IRRIGATION SLEEVES 1'-6", 3'-4" SCH. 40 PVC (VERIFY ALL IRRIGATION
CROSSINGS WITH LANDSCAPE PLANS)
 - INSTALL 8"-45' BEND.
 - INSTALL 8"-90' BEND.
 - INSTALL FIRE HYDRANT ASSEMBLY PER UDACS PLATE No. 7,
(INCLUDING 6" GATE VALVE)
 - INSTALL PVC WATER LINE. SEE PLAN FOR SIZE
 - INSTALL WATER AND SEWER CLEARANCES PER UDACS SECTION 2.18.01,
SUB-SECTION B
 - INSTALL 5/8" WATER METER PER UDACS PL. #18
 - INSTALL IRRIGATION SLEEVES 2'-4" SCH. 40 PVC (VERIFY ALL IRRIGATION
CROSSINGS WITH LANDSCAPE PLANS)
 - INSTALL 8" GATE VALVE.
 - INSTALL 3/4" WATER METER PER UDACS PL. #10
 - INSTALL 8"x6" REDUCER.

- SEWER CONSTRUCTION NOTES**
- INSTALL 8" SEWER MAIN, TRENCH SECTION BACKFILL PER
CONVD DWG. S016
 - INSTALL 48" SANITARY SEWER MANHOLE PER CONVD DWG. S01
 - REMOVE CAP & CONNECT TO EX. 8" SUB. CONTRACTOR TO VERIFY
EXISTING LOCATION AND ELEVATION PRIOR TO CONSTRUCTION.
 - INSTALL 4" SEWER LATERAL W/ 4" WYE PER CONVD DWG S017.
LOCATE PER LATERAL DETAIL UNLESS OTHERWISE NOTED.
 - INSTALL 8" CAP

SEWER MANHOLE TABLE

SMH#	RIM	INV. IN	INV. OUT	NORTHING	EASTING
MH1	2517.84	-	2511.99	4916.48	10532.60
MH2	2518.44	2510.97	2510.77	4858.49	10532.11
MH3	2521.84	2509.84	2508.64	4627.16	10530.15
MH4	2520.44	2509.15	2508.95	4507.30	10562.48
MH5	2517.14	2507.82	2507.62	4251.84	10680.19
MH6	2516.54	2507.31	2507.11	4173.16	10679.52
MH7	2523.74	2517.18	2516.98	4175.10	10452.21
MH8	2524.02	-	2524.63	4178.13	10495.48
MH9	2521.64	2515.00	2514.80	4479.79	10481.78
MH10	2525.64	2518.22	2518.02	4475.42	10297.52
MH11	2528.74	2521.80	2521.60	4438.06	10142.62
MH12	2534.74	2523.30	2523.10	4346.25	9845.34
MH13	2535.84	2523.89	2523.69	4327.94	9748.64
MH14	-	-	-	-	-

SEWER MANHOLE TABLE

SMH#	RIM	INV. IN	INV. OUT	NORTHING	EASTING
MH15	2534.24	-	2524.97	2524.77	4326.12
MH16	2532.34	-	2526.52	4067.68	9530.94
MH17	2533.94	-	2527.20	4563.75	9526.83
MH18	2534.94	-	2528.21	4297.97	9853.88
MH19	2533.84	2527.13	2526.93	4591.07	9544.64
MH20	2532.04	2525.53	2525.33	4413.95	1743.55
MH21	2530.14	2523.59	2523.39	4915.30	10672.10
MH22	2527.74	2521.24	2521.04	5119.79	10673.84
MH23	2527.74	2520.06	2519.86	4743.43	10153.26
MH24	2527.34	-	2520.82	4859.08	10462.32
MH25	2527.14	2519.06	2518.86	4813.95	9743.55
MH26	2526.04	2518.56	2518.36	4591.07	9564.89
MH27	2518.94	-	2512.25	4859.08	10462.32
MH28	2531.54	-	2525.24	4065.78	9851.91
MH29	2534.04	2523.85	2523.65	4297.97	9853.88

ASBUILT

ESTIMATED SEWER CONTRIBUTION

103 UNITS * 250 GPD/UNIT = 25,750 GPD
TOTAL AVERAGE CONTRIBUTION = 25,750 GPD = 0.02575 MGD
TOTAL PEAK FLOW = 0.02575 MGD * 3.2 (PEAK FACTOR) = 0.0824 MGD

THE DISTRICT WILL NOT GUARANTEE A WATER-TIGHT SHUTDOWN WHERE CONNECTIONS OR REPAIRS
TO EXISTING FACILITIES ARE REQUIRED. THE CONTRACTOR SHALL ENSURE ALL LABOR AND
EQUIPMENT IS AVAILABLE AT ALL TIMES TO REMOVE FUGITIVE WATER WHICH IMPEDES THE
CONTRACTOR'S PERFORMANCE IS AVAILABLE AT ALL TIMES. CONTRACTOR TO INSTALL TEMPORARY
SERVICE TO ENSURE PROPER SHUTDOWN IN THE EVENT NO OTHER APPURTENANCES ARE
AVAILABLE.

ALL LOTS MAY HAVE WATER PRESSURE IN EXCESS OF 80 PSI. THE UNIFORM PLUMBING CODE
REQUIRES THAT INDIVIDUAL, ON-SITE (PRIVATE), PRESSURE REDUCING VALVES BE INSTALLED
WHENEVER THE PRESSURE EXCEEDS 80 PSI. PRV'S ARE THE DEVELOPER'S RESPONSIBILITY AND
WILL NOT BE INSPECTED OR INCLUDED IN THE ACCEPTANCE OF LVWD FACILITIES.

NOTE:
INSTALL PIPELINE MARKER BALLS IN TRENCH ABOVE EACH HORIZONTAL ELBOW FITTING, PER UDACS
PLATE No. 27, ESN 062
ALL SEWER/STORM DRAINS CROSSING WATER LINES MUST CONFORM TO SECTION 2.19 OF THE
UNIFORM DESIGN AND CONSTRUCTION STANDARDS FOR POTABLE WATER SYSTEMS (UDACS) FOR
WATER AND STORM MAIN CROSSING AND CLEARANCES, ESN 064

NOTE:
ALL PRIVATE STREETS & DRIVES ARE PUBLIC SEWER EASEMENTS, PUBLIC UTILITY
EASEMENTS AND PUBLIC DRAINAGE EASEMENTS TO BE PRIVATELY MAINTAINED.

NOTICE
G.C. WALLACE, INC. ASSUME NO RESPONSIBILITY FOR EXISTING UTILITY SHOWN OR NOT SHOWN. THE
UTILITIES SHOWN ON THIS DRAWING HAVE BEEN PLOTTED FROM RECORD INFORMATION AND ARE
FOR THE CONVENIENCE OF THE CONTRACTOR ONLY. IT IS THE CONTRACTOR'S RESPONSIBILITY TO
FIELD VERIFY THE LOCATION AND DEPTH OF ALL RELEVANT UTILITIES PRIOR TO COMMENCEMENT OF
CONSTRUCTION. IF A CONFLICT OR DISCREPANCY IS DISCOVERED, THE CONTRACTOR SHALL NOTIFY
THE ENGINEER IN WRITING IMMEDIATELY.

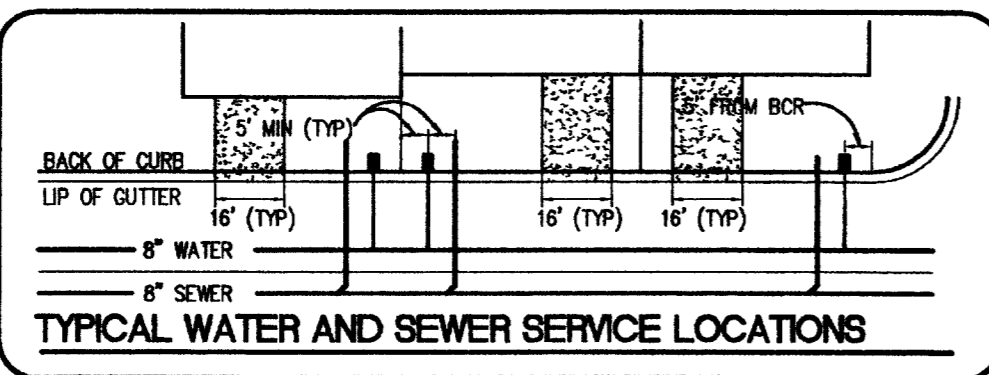

CORP STOP	JONES	J1935
AMS	JONES	J1975
GATE VALVE	MULDER	A2360-06 -08

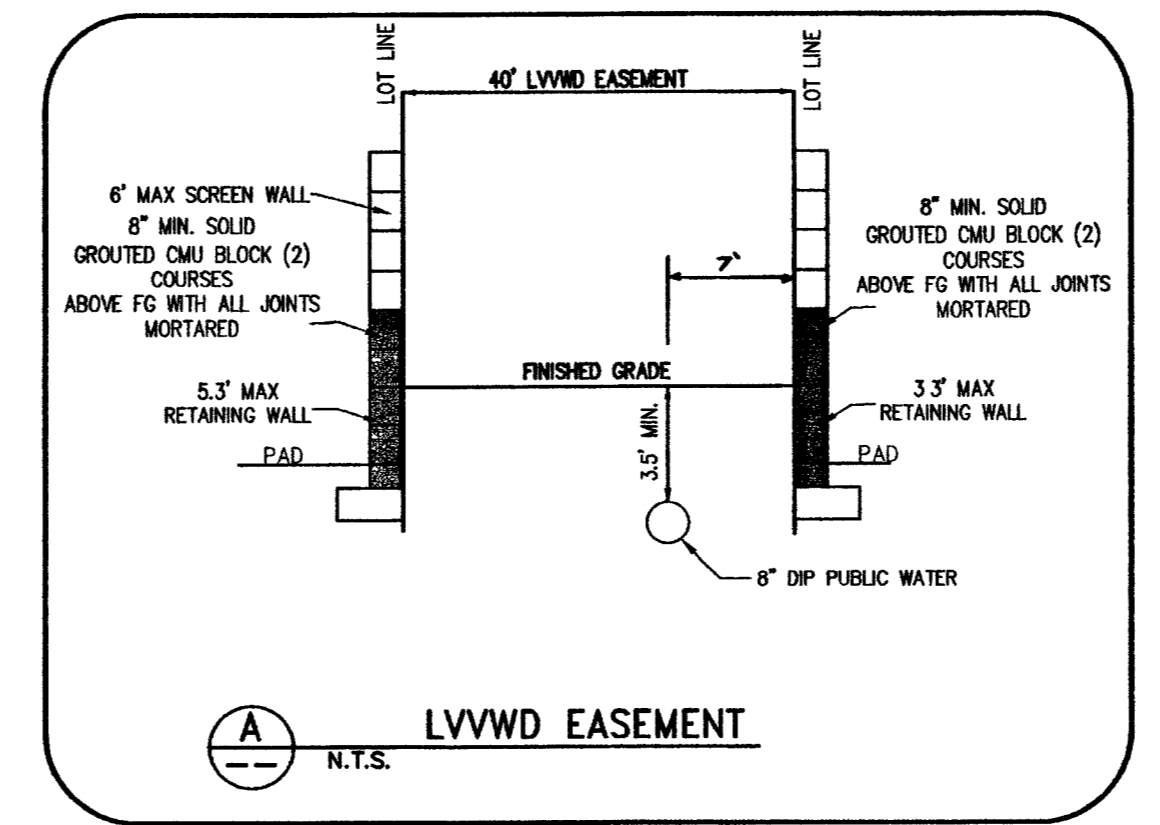
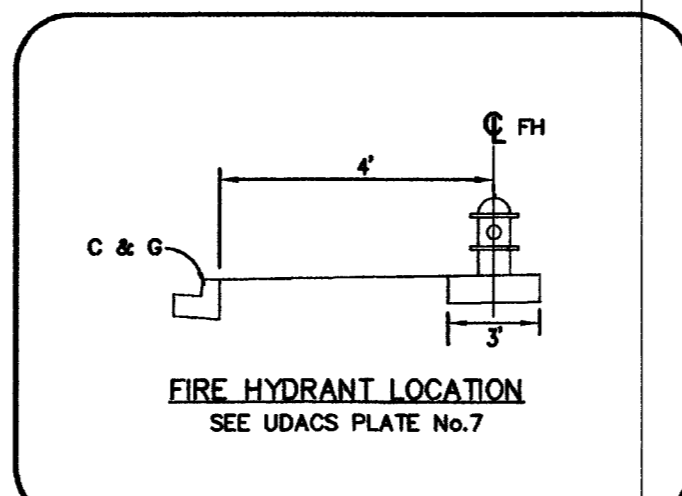

Call before you Dig
1-702-455-7511
CLARK COUNTY TRAFFIC OPERATIONS
1-702-229-6611
LAS VEGAS AREA COMPUTERIZED TRAFFIC SYSTEM

Call before you Dig
1-800-227-2600
UNDERGROUND SERVICE (USA)

APPROVED FOR CONSTRUCTION
[Signature]
LAS VEGAS VALLEY WATER DISTRICT
(PROJECT #1100442)

APPROVED FOR CONSTRUCTION
[Signature]
AS Built
2300
CITY OF LAS VEGAS FIRE DEPARTMENT

STATE OF NEVADA
JOHN C. WIESE
REGISTERED PROFESSIONAL ENGINEER
No. 18380
3/30/05

DATE: 3/30/05
DRAWN: _____
CHECK: _____
ISSUE DATE: 03-30-05
PLOT DATE: 03-30-05
PLOT TIME: 08:45:03

G. C. WALLACE, INC.
Engineers/Planners/Surveyors
1555 SOUTH RAINBOW BLVD., LAS VEGAS, NEVADA 89146
TELEPHONE: (702) 904-2000 • FAX: (702) 804-2299

LOG CABIN FRANCH - UNIT 2
DR. HORTON, INC.
UTILITY PLAN 1

SHEET
U-1
13 OF 30 SHTS

8047 22 81988 104022

1074834-2

RECEIVED