

20' EASEMENT
(PUBLIC)

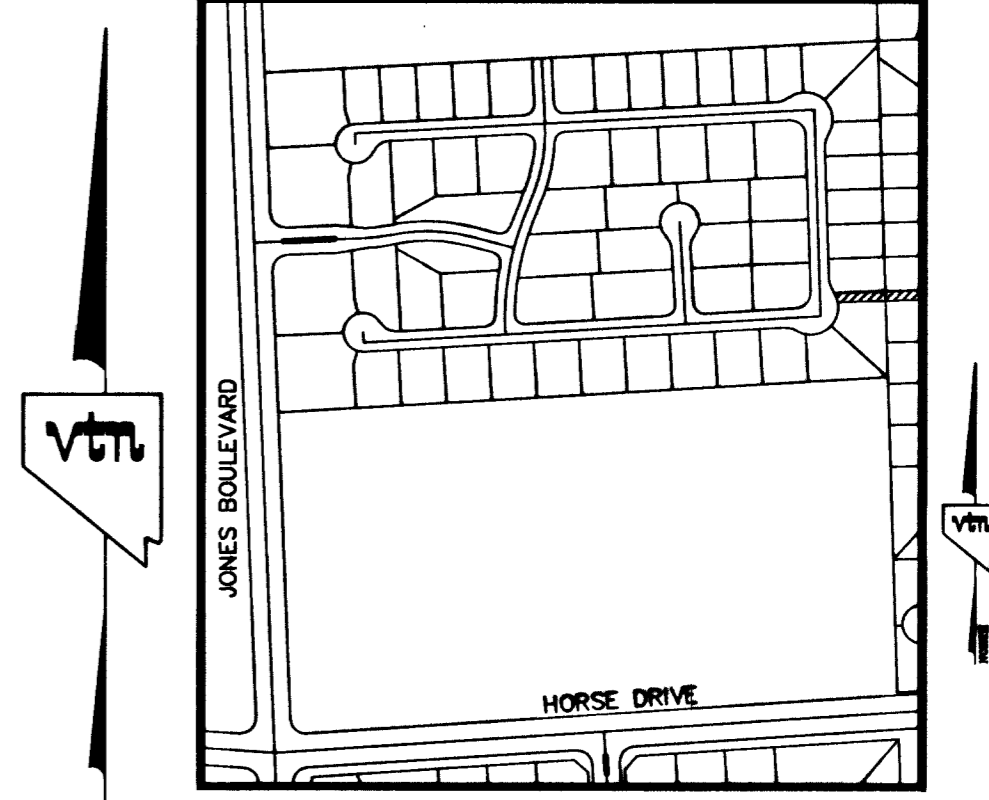

KEY MAP
N.T.S.

GRAPHIC SCALE

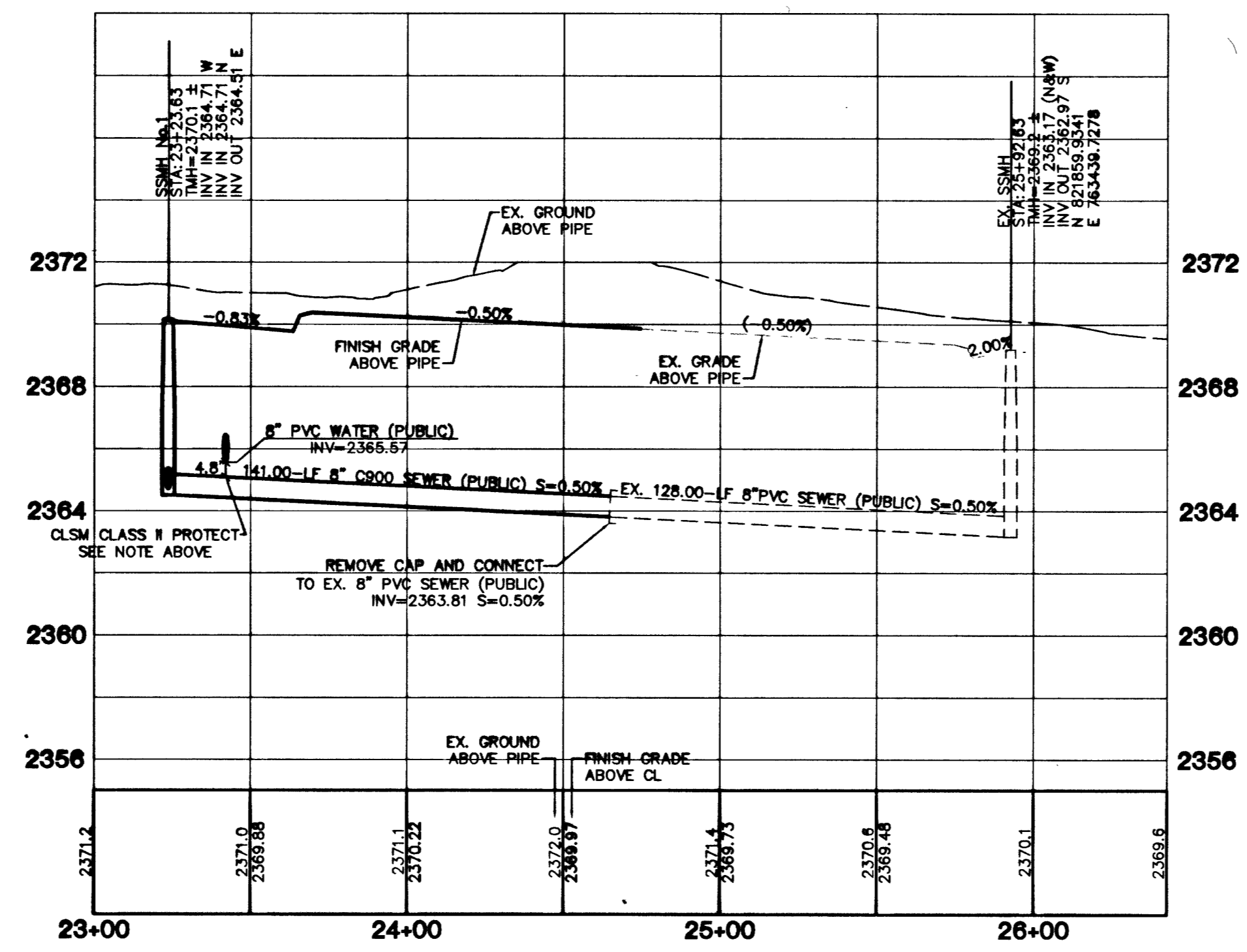
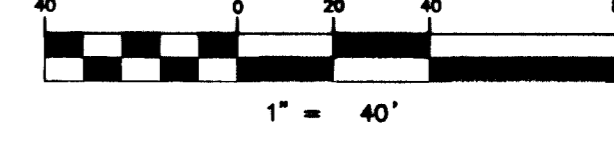

PROFILE SCALES:
HORZ. = 1"=40'
VERT. = 1"=4'

CONTROLLED LOW STRENGTH MATERIAL (CLSM)

PROTECT WATERLINES IN PLACE. WHEREVER A WATERLINE IS ABOVE A STORM DRAIN OR SEWER WHERE COMPACTION REQUIREMENTS UNDER A WATERLINE CANNOT BE MET, BACKFILL TRENCH WITH CLASS II CONTROLLED LOW STRENGTH MATERIAL (CLSM) TO THE SPRINGLINE OF THE WATERLINE. THIS REQUIREMENT IS FOR STRUCTURAL SUPPORT ONLY. ADDITIONAL HEALTH REGULATIONS MAY APPLY PER UDACS 2.19.
ESN.042

NOTE:

ALL MH STATIONING IS BASED ON SEWER LENGTHS FROM MANHOLE TO MANHOLE. ALL MANHOLES ARE 48" SIZE MANHOLES PER STD. DWG #SD-1. UNLESS OTHERWISE SPECIFIED.

CONTRACTOR NOTE:

CONTRACTOR SHALL VERIFY HORIZONTAL AND VERTICAL LOCATION OF EXISTING UTILITIES AND NOTIFY THE DESIGN ENGINEER IMMEDIATELY OF ANY DISCREPANCIES PRIOR TO CONSTRUCTION.

SEWER CONNECTION NOTE:
A SEGMENT OF THE DOWNSTREAM SEWER SYSTEM THAT WILL SERVE THIS PROJECT HAS NOT BEEN COMPLETED AND/OR ACCEPTED FOR MAINTENANCE BY THE CITY OF LAS VEGAS. ANY WORK DONE ON THIS PROJECT PRIOR TO THE COMPLETION AND/OR ACCEPTANCE OF THE DOWNSTREAM SEWER SYSTEM(S) SHALL BE DONE AT THE DEVELOPER'S OWN RISK. THE CITY OF LAS VEGAS RESERVES THE RIGHT TO PREVENT THE PHYSICAL CONNECTION OF THIS PROJECT INTO THE DOWNSTREAM SEWER SYSTEM UNTIL ALL SEGMENTS HAVE BEEN COMPLETED AND ACCEPTED FOR MAINTENANCE, OR UNTIL SUCH TIME AS THEY HAVE BEEN DEEMED AVAILABLE FOR SERVICE.

Avoid cutting underground utility lines. It's costly.
Call before you Dig
1-800-227-2600

Avoid overhead power. Be contact. It's costly.
Call before you Overhead
1-702-227-2929

LEGAL DESCRIPTION

A PORTION OF THE NORTH HALF (N 1/2) OF WEST HALF (W 1/2) OF SOUTH HALF (S 1/2) OF THE NORTHWEST QUARTER (NW 1/4) OF SECTION 12, TOWNSHIP 19 SOUTH, RANGE 60 EAST, M.D.M., CITY OF LAS VEGAS, CLARK COUNTY, NEVADA.

BENCHMARK

PROJECT DATUM: NAVD88
CITY OF LAS VEGAS BENCHMARK 1LV90-13NES
NAVD88 ELEVATION: 710.9608 METERS (2332.54 FEET)

ONLY BM 413148, NAVD 88 ELEV=710.953 METERS (2332.52 FEET) 1" DIAMETER CONCRETE MONUMENT 77 FEET SOUTH & 54 FEET WEST OF N.E. CORNER SEC. 13T19R60E 10' EAST OF LARGE POWER POLE.

BASIS OF BEARINGS

THE BASIS OF BEARINGS FOR THIS PROJECT IS GRID NORTH AS DEFINED BY THE NEVADA COORDINATE SYSTEM OF 1983 (NCS83), EAST ZONE, (2701), DETERMINED BY CLARK COUNTY GIS CONTROL POINTS 802, 803, 804, AND 805, AS SHOWN ON A RECORD OF SURVEY ON FILE IN THE CLARK COUNTY, NEVADA, RECORDER'S OFFICE, IN BOOK 88 OF SURVEYS, AT PAGE 53.

| | | | | | | | | |
|--|---|---|---|---|---|---|------|---|
| 7 | 6 | 5 | 4 | 3 | 2 | 1 | DATE | BY |
| | | | | | | | | |
| <p>U.S. HOME 3765 E. SUNSET #61 LAS VEGAS, NEVADA 89120 (702) 458-7700</p> | | | | | | | | <p>U.S. HOME 3765 E. SUNSET #61 LAS VEGAS, NEVADA 89120 (702) 458-7700</p> |
| <p>SEWER PLAN AND PROFILE 20' EASEMENT</p> | | | | | | | | <p>JONES/HORSE AT IRON MOUNTAIN RANCH</p> |
| <p>DRAWN BY: MKD JUL 03</p> | | | | | | | | <p>SHEET SS5 24 of 26 SHEETS</p> |
| <p>DESIGNED BY: MKD JUL 03</p> | | | | | | | | <p>DRAWING NO. 1074 4771</p> |
| <p>CHECKED BY: D&P JUL 03</p> | | | | | | | | <p>DATE</p> |
| <p>PROJECT NO: 5121</p> | | | | | | | | <p>REVISION</p> |
| <p>SCALE: 1"=40' HORZ. N/A VERT.</p> | | | | | | | | <p>PLANNERS • LAND SURVEYORS</p> |
| <p>PROFESSIONAL ENGINEER STATE OF NEVADA No. 15816 Civil 2/20/03</p> | | | | | | | | <p>EXPIRES 12-31-03</p> |
| <p>THE BASIS OF BEARINGS FOR THIS PROJECT IS GRID NORTH AS DEFINED BY THE NEVADA COORDINATE SYSTEM OF 1983 (NCS83), EAST ZONE, (2701), DETERMINED BY CLARK COUNTY GIS CONTROL POINTS 802, 803, 804, AND 805, AS SHOWN ON A RECORD OF SURVEY ON FILE IN THE CLARK COUNTY, NEVADA, RECORDER'S OFFICE, IN BOOK 88 OF SURVEYS, AT PAGE 53.</p> | | | | | | | | <p>PLANNERS • LAND SURVEYORS</p> |

56965

HT:\0121\0121SS-01.dwg (SS5)