

LAKE MEAD BOULEVARD

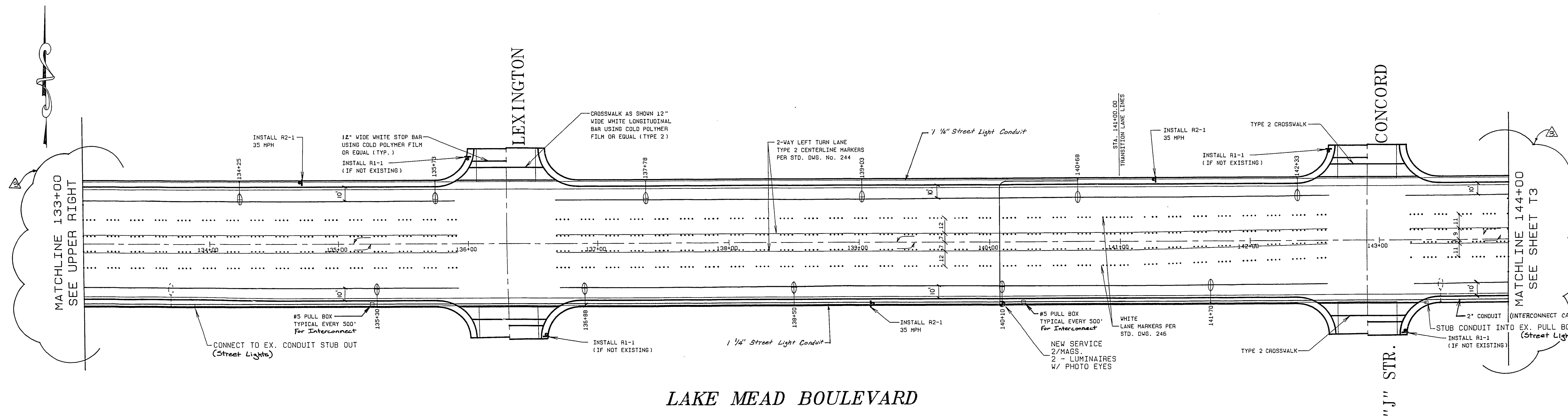

LAKE MEAD BOULEVARD

CITY OF LAS VEGAS,  
LAS VEGAS, NEVADA

REVISION  
 BY DATE  
 MGB 10-14-90  
 DWE 10-17-90  
 T.M.M. 01/21/91  
 T.M.M. 02/14/91

REVISION  
 REVIS. ST. LT. L&L BACK TO ORIGINAL  
 REV. STREET LIGHT LOCATIONS & REV. 2 LANES TO 4 LANES  
 Added Existing Interconnect on Hanni & King  
 Also. Revisions per A.L.L. Report, Etc.

CONSULTING ENGINEERS - PLANNERS  
 2300 PASEO DEL PRADO BUILDING A SUITE 100  
 LAS VEGAS, NEVADA 89102 PHONE (702) 873-7550

City of Las Vegas logo

TITLE  
 STA. 122+00 TO STA. 144+00  
 TRAFFIC & STREET LIGHT PLAN

PROJECT  
 LAKE MEAD BOULEVARD  
 TONOPAH TO INTERSTATE 15

WG NO. 3661  
 BY JT/RKB  
 DATE 2/14/90  
 SCALE HOR: 1"=40'

SHEET  
 T2  
 OF 29 SHEETS



10911-101