

NOTE:
ALL ON-SITE STREETS ARE PUBLIC STREETS

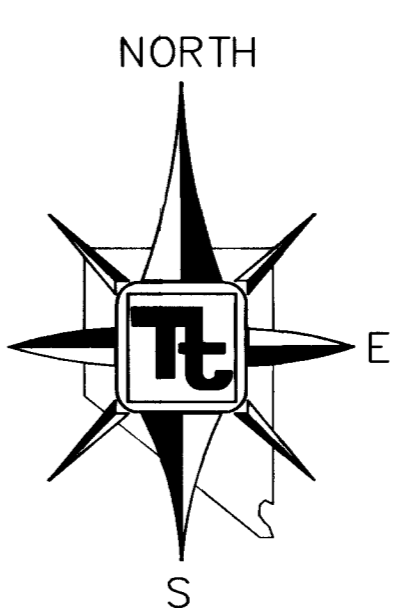

CLARK COUNTY DEPARTMENT OF DEVELOPMENT SERVICES
Acceptance of plans for filing
By *Jacob L. ...* 2-4-03
Acceptance of these plans for filing shall not be construed to be a permit for or an approval of any violation of any of the provisions of the state or county laws and/or specifications. Clark County shall be held free from damages which may result from the construction of the improvements from the engineering design depicted herein.

NOTE: Power poles and/or other existing facilities not in proper location based on proposed improvements shown herein will be relocated at no expense to County.

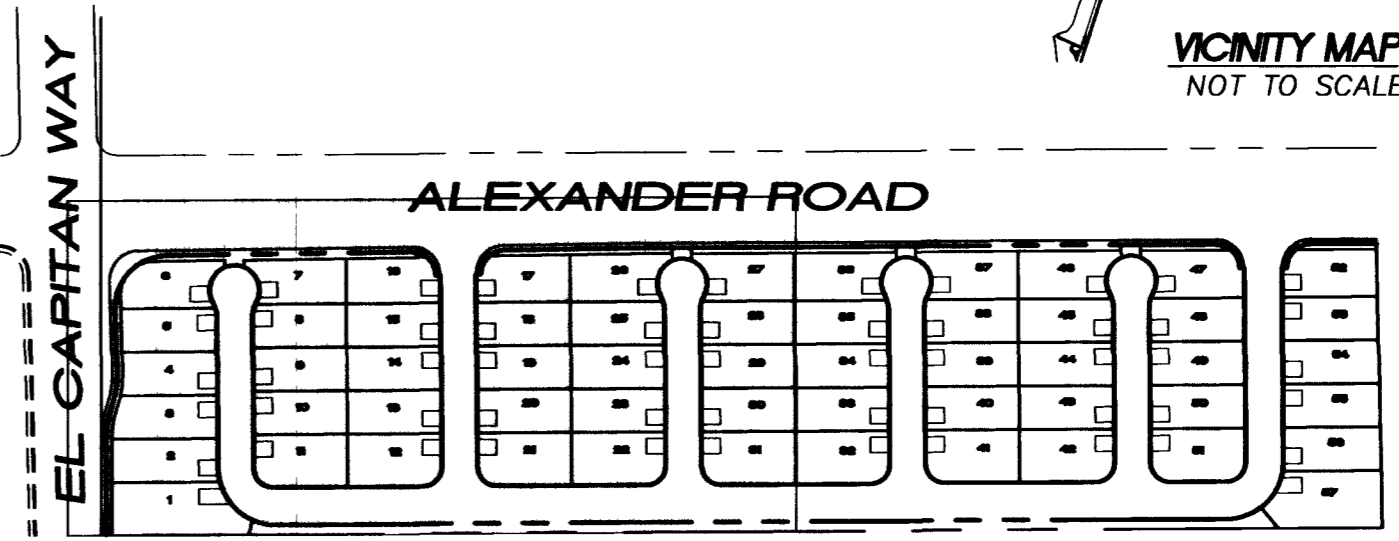
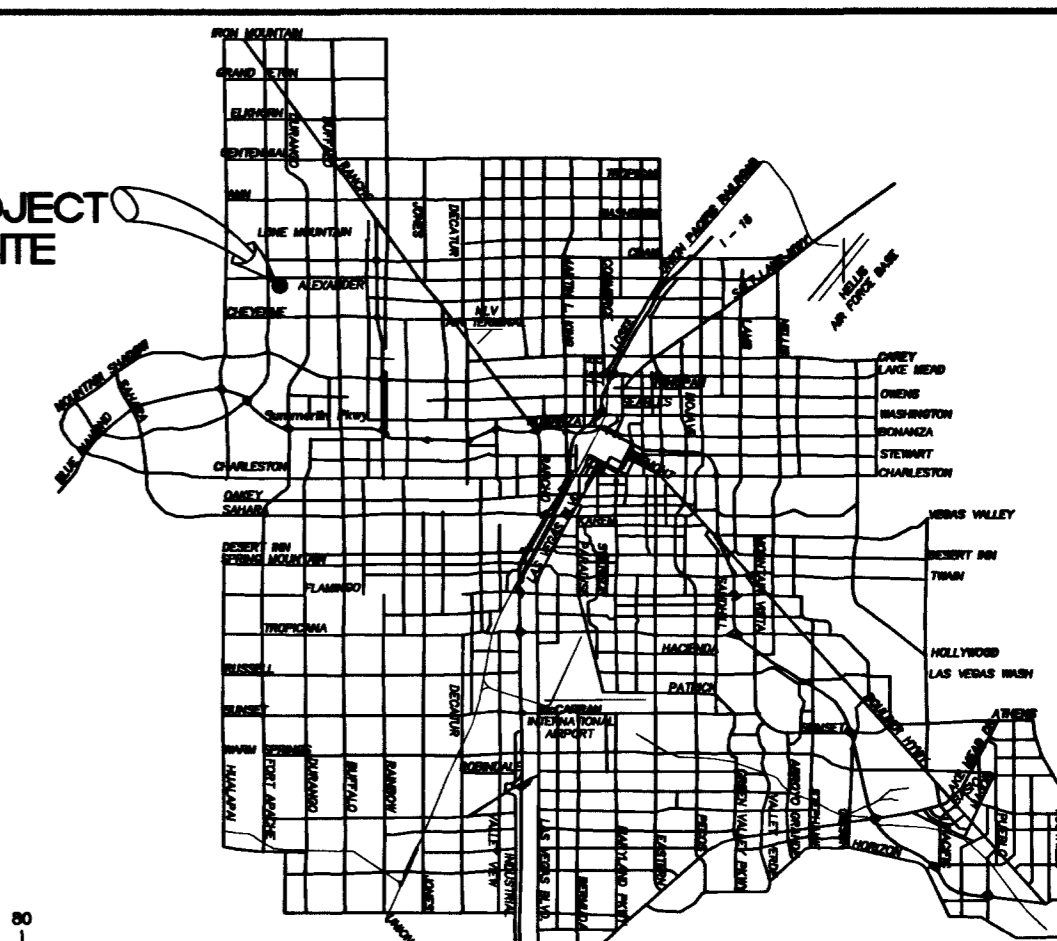

CURVE TABLE

CURVE	LENGTH	RADIUS	TANGENT	DELTA
C1	34.77	105.00	17.54	18°58'19"
C2	33.81	95.00	17.08	20°23'22"
C3	47.37	30.00	30.25	90°28'30"
C4	47.40	30.00	30.28	90°31'42"
C5	46.85	30.00	29.72	89°28'18"
C6	47.13	30.00	30.01	90°00'39"
C7	47.12	30.00	29.99	89°59'28"
C8	94.25	60.00	60.00	89°59'59"
C9	94.25	60.00	60.00	90°00'01"
C10	15.71	30.00	8.04	29°59'41"
C11	108.90	26.00	45.04	239°59'22"
C12	15.71	30.00	8.04	29°59'41"
C13	31.42	20.00	20.00	90°00'01"
C14	31.42	20.00	20.00	89°59'59"
C15	31.42	20.00	20.00	90°00'01"
C16	31.42	20.00	20.00	89°59'59"
C17	15.71	30.00	8.04	29°59'41"
C18	108.90	26.00	45.04	239°59'22"
C19	15.71	30.00	8.04	29°59'41"
C20	31.42	20.00	20.00	90°00'01"
C21	31.42	20.00	20.00	89°59'59"
C22	15.71	30.00	8.04	29°59'41"
C23	108.90	26.00	45.04	239°59'22"
C24	15.71	30.00	8.04	29°59'41"
C25	31.42	20.00	20.00	90°00'01"
C26	31.42	20.00	20.00	89°59'59"
C27	15.71	30.00	8.04	29°59'41"
C28	108.90	26.00	45.04	239°59'22"
C29	15.71	30.00	8.04	29°59'41"
C30	31.42	20.00	20.00	90°00'01"
C31	31.42	20.00	20.00	89°59'59"

KEYMAP
SCALE: 1"=200'

LEGEND

- PROPERTY LINE / RIGHT-OF-WAY
- "L" TYPE CURB AND GUTTER
- "A" TYPE CURB
- EXISTING CURB AND GUTTER
- PROPOSED WATER LINE (SIZE AS SHOWN)
- PROPOSED SEWER LINE (SIZE AS SHOWN)
- EXISTING UTILITY (AS SHOWN)
- CROSS GUTTER
- WHEELCHAIR RAMP
- CUT OR FILL SLOPE
- PROPOSED PAVEMENT AREA
- PROPOSED ELEVATION (DESCRIPTION AS SHOWN)
- EXISTING ELEVATION (DESCRIPTION AS SHOWN)
- EXISTING DESIGN ELEVATION (DESCRIPTION AS SHOWN)
- DETAIL OR SECTION NUMBER SHEET DETAIL IS SHOWN
- BLOCK WALL
- RETAINING WALL
- RETAINING WALL W/ 2' WROUGHT IRON
- STEM WALL
- LOT NUMBER
- PAD ELEVATION
- FINISHED FLOOR ELEVATION
- EXISTING EDGE OF PAVEMENT
- AREA OF INUNDATION

BENCHMARK
CITY OF LAS VEGAS BENCHMARK - NO.18 1LV00-45E
RIVET AND SQUARE ALUMINUM PLATE IN TOP OF CURB, NORTHWEST RETURN OF ALEXANDER ROAD AND BUFFALO DRIVE
ELEVATION = 713.8077 METERS (NAV8088)
ELEVATION = 2344.188 FEET (NAV8088)

SOILS REPORT
GEOTECHNICAL & ENVIRONMENTAL SERVICES, INC.
7560 WEST SAHARA AVENUE, SUITE 101
LAS VEGAS, NEVADA 89117
TEL. (702) 365-1001
PROJECT NUMBER:
ELEVATION = 713.8077 METERS (NAV8088)
ELEVATION = 2344.188 FEET (NAV8088)

GRADING NOTES

- TETRA TECH SHALL BE NOTIFIED IMMEDIATELY OF ANY DISCREPANCIES IN THE PLANS OR CONDITIONS IN THE FIELD.
- ALL WORK TO BE PERFORMED OUTSIDE OF THE PROJECT BOUNDARY AND ON PRIVATE PROPERTY SHALL NOT BE PERFORMED UNTIL WRITTEN PERMISSION AND EASEMENT HAVE BEEN OBTAINED FROM THE OFFSITE OWNER AND GIVEN TO CITY LAS VEGAS PUBLIC WORKS.
- FOR AREAS THAT ARE FLATTER THAN 2:1 SLOPE, OR LESS THAN 1' ELEVATION DIFFERENCE, SCARPS ARE NOT SHOWN ON PLAN FOR CLARITY PURPOSES.
- ALL SLOPE AREAS SHALL HAVE A MINIMUM ONE FOOT SHOULDER NEXT TO WALL PRIOR TO STARTING SLOPE.
- PAD SECTION SHOWN ON PLANS IS FOR REFERENCE ONLY. FOR ACTUAL SECTION, REFER TO GEOTECHNICAL REPORT FOR SOILS ENGINEER'S RECOMMENDATION.
- ALL SIDEWALK INSTALLATIONS SHALL CONFORM TO ADA REQUIREMENTS.

CONSTRUCTION NOTES

- CONSTRUCT 3" AC PAVING OVER 10" TYPE II PER STD. DWG. 207
- SAWCUT TO CLEAN EDGE, MATCH EXISTING
- CONSTRUCT 5" AC PAVING OVER 5.5" TYPE II ON 9" TYPE I BASE PER STD. DWG. 203
- CONSTRUCT SIDEWALK RAMP PER STD. DWG. 235
- CONSTRUCT "L" TYPE CURB AND GUTTER PER STD. DWG. 216
- CONSTRUCT CONCRETE SIDEWALK PER STD. DWG. 234
- CONSTRUCT 8" CROSS GUTTER PER STD. DWG. 228
- CONSTRUCT 4" AC PAVING OVER 4.5" TYPE II ON 9" TYPE I BASE PER STD. DWG. 205
- CONSTRUCT DEPRESSED CURB PER DETAIL N. SHEET DT1

RETAINING WALL CONVERSION TABLE

Δ	HEIGHT
Δ1	0.67'
Δ2	1.33'
Δ3	2.00'
Δ4	2.67'
Δ5	3.33'
Δ6	4.00'
Δ7	4.67'
Δ8	5.34'
Δ9	6.00'

ESTIMATED FLOOD CONTROL QUANTITIES

ITEM #	DESCRIPTION	QUANTITY	
		PUBLIC	PRIVATE
1	36" GROUTED PERIMETER WALL	1308 LF	
2	48" BUBBLER MANHOLE	2 EA	
3	SDMH, TYPE II	1 EA	
4	TYPE CM MODIFIED DROP INLET (L=25', GRATES=8)	1 EA	
5	TYPE CM MODIFIED DROP INLET (L=15', GRATES=5)	1 EA	
6	12" PERFORATED PVC	200 LF	
7	18" RCP	6 LF	
8	24" RCP	86 LF	
9	42" RCP	194 LF	
10	24" STEM WALL		1500 LF

BASIS OF BEARING
S 89°41'26" W BEING THE NORTH LINE OF THE NORTHWEST QUARTER (NW 1/4) OF THE NORTHWEST QUARTER (NW 1/4) OF SECTION 9, TOWNSHIP 20 SOUTH, RANGE 80 EAST, M.D.M., CITY OF LAS VEGAS, CLARK COUNTY, NEVADA AS SHOWN IN BOOK 89, PAGE 68 OF PLATS IN THE CLARK COUNTY RECORDER'S OFFICE, CLARK COUNTY, NEVADA.

H.C. RAMP DATA
PER STANDARD DRAWING. 235

NO.	"A"	"B"	CASE
A	8.00	8.00	I
B	9.50	4.50	I
C	15.00	4.50	I
D	4.50	9.50	I
E	12.00	4.50	I

STORM DRAIN NOTE:
1. BRICK AND MORTAR ELLIPTICAL OUTFLOW LATERAL ONLY. TO BE REMOVED WITH ALEXANDER SPECIAL IMPROVEMENT DISTRICT.

Avoid overhead power line contact.
Call before you Overhead
1-702-593-6111
NEVADA POWER ENVIRONMENT SAFETY SERVICES DEPARTMENT

Avoid cutting underground utility lines. It's costly.
Call before you Dig
1-800-227-2600
UNDERGROUND SERVICE (USA)

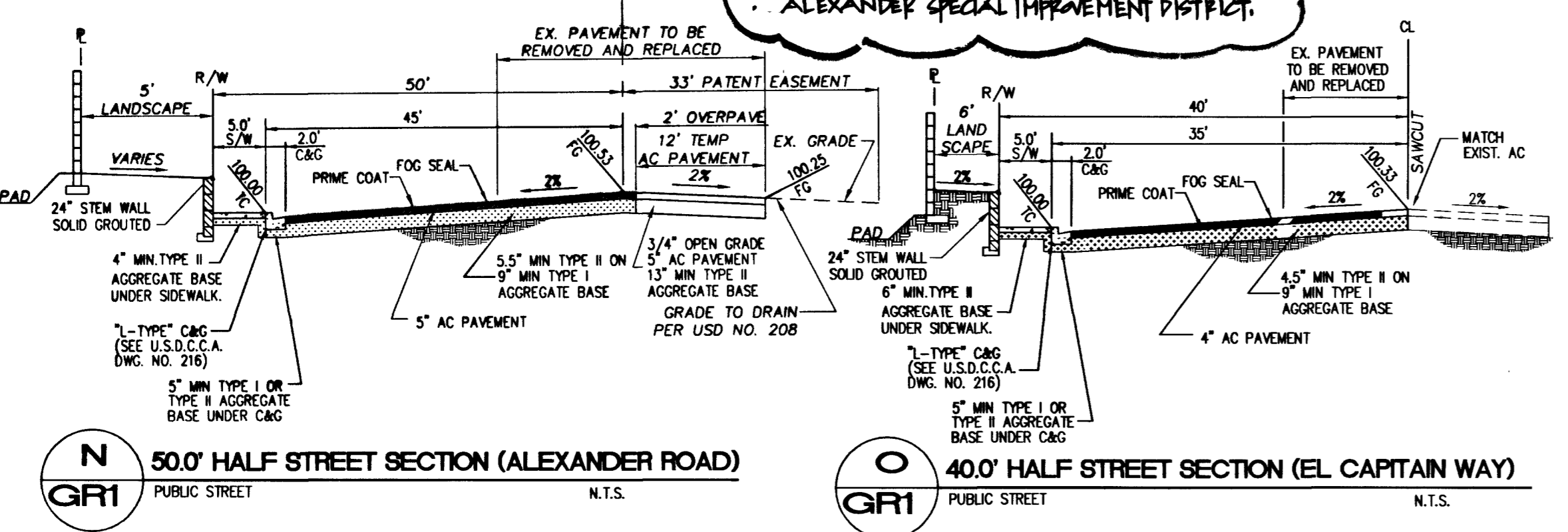

EARTHWORK QUANTITIES

TOTAL CUT = 30,854 CY
TOTAL FILL = 14,745 CY
THESE FIGURES ARE FOR PERMIT PURPOSES ONLY AND ARE NOT INTENDED FOR BIDDING OR CONTRACT AMOUNTS. NUMBERS ARE RAW AND UNADJUSTED.

CERTIFICATION

I HEREBY CERTIFY THAT THE GRADING PLAN IS IN CONFORMANCE WITH THE APPROVED DRAINAGE STUDY ON FILE WITH THE CITY OF LAS VEGAS PUBLIC WORKS FOR THIS PROJECT.

GARY S. KAZDO, P.E. #14970
DATE: 02/20/02

KB HOME NEVADA, INC.
750 PILOT ROAD, SUITE F
LAS VEGAS, NEVADA 89119
(702) 614-2500

TETRA TECH, INC.
INFRASTRUCTURE SERVICES GROUP
401 N. BURLEIGH DR. SUITE 100, LAS VEGAS, NEVADA 89105
(702) 648-1500

GRADING PLAN

LONE MOUNTAIN SPRINGS
CITY OF LAS VEGAS, NEVADA

SHEET: **GR1**
6 OF 20
DRAWING NO: 1074-4717

PROJECT NO: P08042-0029

SCALE: 1"=40'
1"=4'

QUALITY CONTROL BY: [Signature]
DESIGNED BY: [Signature]
CHECKED BY: [Signature]

REVISIONS:

NO.	DATE	BY	REVISION
1	1-9-02	AM	REVISED LOT DIMENSIONS
2	1-9-02	AM	REVISED TYPE DIA./DEPTH
3	1-9-02	AM	REVISED ST. SPACES/FF/HP/AS BLDG
4	1-9-02	AM	REVISED SPACING/FF/HP/AS BLDG
5	1-9-02	AM	REVISED SPACING/FF/HP/AS BLDG
6	1-9-02	AM	REVISED SPACING/FF/HP/AS BLDG
7	2-4-03	AM	ADD PATENT EASEMENT DOC. NO. 1034
8	2-4-03	AM	REVISED SPACING/FF/HP/AS BLDG
9	2-4-03	AM	REVISED SPACING/FF/HP/AS BLDG
10	2-4-03	AM	REVISED SPACING/FF/HP/AS BLDG