

BENCHMARK

PROJECT VERTICAL DATUM: NAVD88
CITY OF LAS VEGAS BENCHMARK 1LV00-4SES
NAVD88 ELEV: 713.6497 METERS (2342.02 FEET)

RIVET AND PLATE IN TOP OF CURB, NORTHWEST RETURN OF ALEXANDER ROAD AND BUFFALO DRIVE

BASIS OF BEARINGS:

SOUTH 01° 42' 30" WEST, BEING THE CENTERLINE OF VEGAS VISTA TRAIL, NORTH OF ITS INTERSECTION WITH ALEXANDER ROAD, AS SHOWN ON THAT PLAT OF "LONE MOUNTAIN HEIGHTS - UNIT 1", ON FILE IN THE OFFICE OF THE COUNTY RECORDER, CLARK COUNTY, NEVADA, IN BOOK 98 OF PLATS, AT PAGE 81.

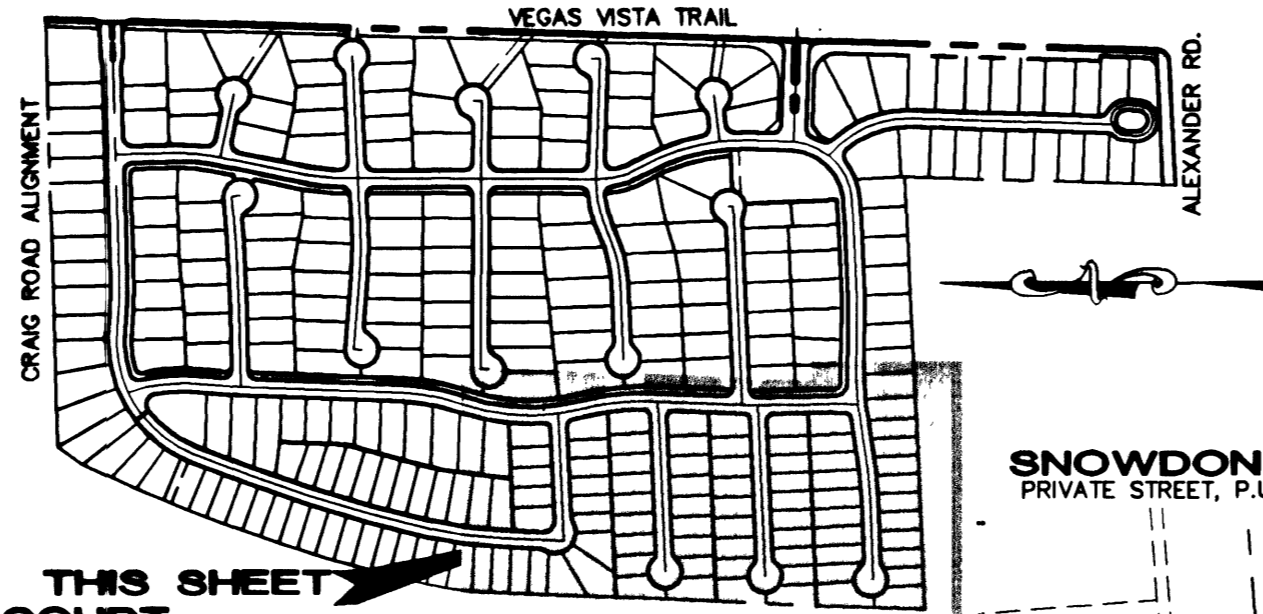
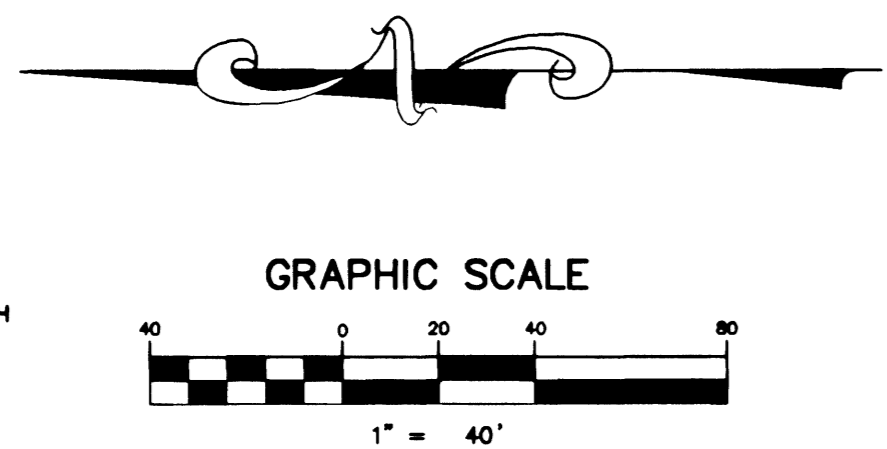

- LEGEND**
- ◆◆◆ END OF ROAD MARKERS1 EA.
 - ⊠ R1-1 "STOP" SIGN &3 EA.
 - (2) D3 "STREET NAME" SIGNS
 - ⊠ (2) D3 "STREET NAME" SIGNS.....1 EA.

Call before you OVERHEAD 1-702-593-6111
Call before you Dig 1-800-227-2600

CADES COVE COURT PRIVATE STREET, P.U.E., CLV SEWER EASEMENT

SMOKEMONT COURT PRIVATE STREET, P.U.E., CLV SEWER EASEMENT

SNOWDON FLAT COURT PRIVATE STREET, P.U.E., CLV SEWER EASEMENT

EXISTING UNIT 1 (CLV. DWG. 207Y-4646-1) WELLINGTON MANOR DRIVE PRIVATE STREET, P.U.E., CLV SEWER EASEMENT

