

NOTES:

1. CONDUIT FILL SHOWN HERE DOES NOT INCLUDE GROUND CONDUCTOR, SUCH CONDUCTOR IS REQUIRED FOR 120/2-10V. CIRCUITS IN NON METALLIC DUCT.
2. 3/4" T.M. WIRING SHOWN PROVIDES 3 SPARE PAIR.
3. NEVADA POWER CO. SERVICE CONDUIT AND FACILITIES TO BE INSTALLED IN ACCORDANCE WITH NEVADA POWER CO. REQUIREMENTS AS SHOWN ON N.P.C. DRAWING 432-3460 SHEETS 1 & 2 OF 2.
4. FOR INSTALLATION OF STREET LIGHTS STANDARDS REFERENCE SMT. C-B.

REV	DATE	BY	DESCRIPTION
2-95	Δ.B.	REVISION FOR 5HP SUMP PUMP (JAT)	
8-95	Δ.B.	REVISIONS OF OFFSITE CONDUIT PER N.P.C.	
11-04	Δ.B.	ADD MOV. POWER, STATUS & CONTROLS (CLV)	
11-04	Δ.B.	CHANGE STREET LIGHT WIRING & CONDUIT (CLV)	

SCALE: 1"=30'	DESIGNED: B. LATCH	SUBMITTED: <i>Shirley C. Alcorn</i> 4920 6-20-84
	DRAWN: D. GILBRETH	R.P.E. NO. DATE
	CHECKED: S. RINSWORTH	RECOMMENDED: <i>Richard J. Helms</i> 2315 6/27/84
		R.P.E. NO. DATE

JAMES M. MONTGOMERY CONSULTING ENGINEERS, INC.
 100 EAST SARAH AVENUE, LAS VEGAS, NEVADA 89104

APPROVED: _____	DATE _____
APPROVED: <i>Charm J. Walker</i> 4412 6-28-84	DATE _____
R.P.E. NO.	DATE

LAS VEGAS VALLEY WATER DISTRICT		SHEET
2300 ZONE NORTH RESERVOIR		E1
ELECTRICAL PLAN		OF 39 SHEETS

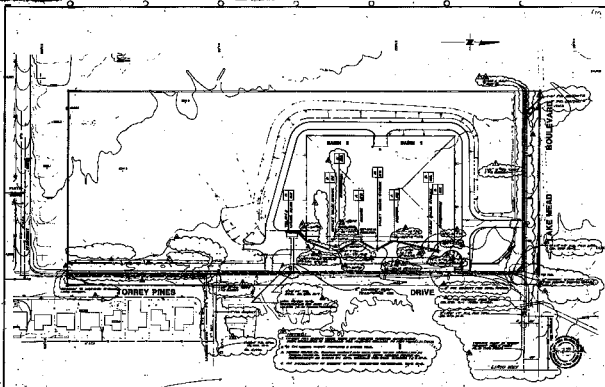

ALL RIGHTS RESERVED
 BY THE ENGINEER OR ARCHITECT OR OTHER PROFESSIONAL PERSON
 WHOSE NAME IS PRINTED ON THIS PLAN OR DRAWING.
 NO PART OF THIS PLAN OR DRAWING IS TO BE REPRODUCED OR
 TRANSMITTED IN ANY FORM OR BY ANY MEANS, ELECTRONIC OR MECHANICAL,
 INCLUDING PHOTOCOPYING, RECORDING, OR BY ANY INFORMATION STORAGE
 AND RETRIEVAL SYSTEM, WITHOUT PERMISSION IN WRITING FROM THE
 ENGINEER OR ARCHITECT OR OTHER PROFESSIONAL PERSON.

PROJECT NO. _____ SHEET NO. _____ DATE _____	DRAWN BY _____ CHECKED BY _____ DATE _____	JAMES H. MORTONSMY CONSULTING ENGINEER INC. 1011 W. 10TH ST. LAS VEGAS, NV 89102	SCALE _____ TITLE _____	LAS VEGAS VALLEY WATER DISTRICT 2200 JOHN NORTH AVENUE LAS VEGAS, NV 89102 ELECTRICAL PLAN SHEET E-1
--	--	---	----------------------------	---